

GOVERNMENT CORNER RESTORATION FORM

FILED

TOWNSHIP 26S RANGE 3W SEC. 535 PLSS # 540120

Date: 10/7/25 By: KL
This survey consists of:

DOUGLAS COUNTY OREGON

DATE 9/25/25

Map: _____
Narrative: _____
Corner Rpt: CS 67161-28

DOUGLAS COUNTY
SURVEYOR

Corner Designation

SE 1/4 535

Monument(s) Found: (Condition and Source)

BLM 3/4" BRASS CAP
ON IRON POST Proj.
6"

- Condition report
- Not Found
- Renewed
- Unrecorded
- Surveyed In

Previous Renewals

Established by BLM
Resurvey 1981 Vol 45
pg 17443

MONUMENT DETAIL

SE 1/4
535
1981

Accessories Found

39" FIR N 68°E 32.0 FT (REC N 70°E
48 1/2 LKS)

DOWN 28" CEDAR N 55°W 10.6 FT (REC 16 LKS)
TO ROOT HOLE

New Accessories

6" W. FIR S 52° E 3.0 FT Scribed "X"
CS BT ON HIGH-LOW BLAZE

Sketch of Monument, Accessories, and General Area

Location & Comments

TRIMBLE GEO XT POSITION
43° 15' 28.073" N.
123° 00' 53.748" W.

AREA BURNED
9-2020

Comp. Decline. 14' 14" E
Agency DCSO
Party Chief S. F. AUSE
Note keeper
Witnesses J. LORSUM

CS 67/61-28

092/3

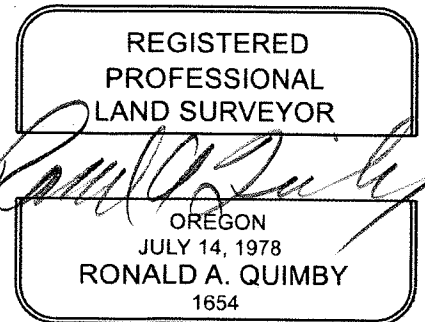

EXPIRES: 12/31/2026

County Surveyor's Record, Douglas County, Oregon

17443

Vol 45

Subdivision of Sec. 35,
T. 26 S., R. 3 W., Willamette Meridian, Oregon

CHAINS

- Ascend 110 ft. over SW. slope, through heavy timber and dense undergrowth.
- 2.65 Gravelled road, 25 lks. wide, bears N. 75° E. and S. 75° W.
- 6.25 Spur, slopes S. 80° W.; desc. 25 ft. over NW. slope.
- 6.60 Gravelled road, 25 lks. wide, bears N. 35° E. and S. 35° E., in curve.
- 12.85 Ravine, drains S. 60° W.; asc. 95 ft. over broken SE. slope.
- 19.85 Point for the SE 1/16 sec. cor. of sec. 35, at intersection with the E. and W. center line of the SE 1/4.

Set an iron post, 28 ins. long, 2 1/2 ins. diam., 22 ins. in the ground, with brass cap mkd.

TRIMBLE GEO XT POSITION
43° 15' 38.073" N
123° 00' 53.748" W

3 1/4" BC, SE 1/16 S 35° ✓ PROT. 6" 1981

from which

39" P A fir, ~~26~~ ins. diam., bears N. ~~70°~~ ^{68°} E., ~~48 1/2~~ ^{32 01 ✓} lks. dist., mkd. SE 1/16 S35 BT.

FALLEN 28" A cedar, 19 ins. diam., bears N. 55° W., ^{10 56 ✓} 16 lks. *GOOD FOR ROOT HOLE* dist., mkd. SE 1/16 S35 BT.

Ascend 70 ft. over SE. slope

NEW REF. 6" W. FIR "X" CS BT ON HIGH-LOW BLAZE BEARS S52° E, 30 FT, DIS

- 24.00 Gravelled road, 25 lks. wide, bears N. 60° W. and S. 75° E.
- 27.80 Spur, slopes SW.; desc. 55 ft. over NW. slope.
- 31.35 Head of ravine, drains N. 80° W.; asc. 15 ft. over broken SW. slope.
- 32.30 Power transmission line, bears N. 75° W. and S. 75° E.
- 35.10 Spur, slopes N. 25° W.; desc. 25 ft. over NE. slope.
- 39.71 The center E 1/16 sec. cor. of sec. 35.

CS 67161-28

pg 3/3

From the S 1/16 sec. cor. of secs. 35 and 36.

N. 89° 54' W., on the E. and W. center line of the SE 1/4 of sec. 35.