

TOWNSHIP 27S RANGE 4W SEC. 15 PLSS # 400440

Date: 8/25/25 By: KE
This survey consists of:

DOUGLAS COUNTY OREGON

DATE 8-11-25

Map: _____
Narrative: _____
Corner Rpt: CS 67161-10

Corner Designation

DOUGLAS COUNTY
SURVEYOR

Monument(s) Found: (Condition and Source)

- Condition report
- Not Found
- Renewed
- Unrecorded
- Surveyed In

Good sound under cold
patch (Rec 3/4" I. Rod in
low, collar with steel cap

Previous Renewals

Irving 1934 CS 37/179
DCSD 1981 CS 61/24-34
Bentz 1992 M 115-51
Collier 1993 P.P. 1994-0004

MONUMENT DETAIL

Accessories Found

50" B. OAK S2°E 29 FT (DIST TO FACE)
healed blaze

3/4" Iron Pipe N65°E 49.6 FT protruding
2.3 FT firmly set

P. Pole w/tag marked PPL B 6267 PPL
S75 1/2°W 65.1 FT

6" Sycamore N52°W 98.7 FT (not tagged)

P. Pole cop 2 60 334 N3°W 17.9 FT

Monument Set (Procedure and Description)

MONUMENT DETAIL

New Accessories

Sketch of Monument, Accessories, and General Area

Location & Comments

OCRS Cottage Grove
Canyonville Zone
43° 13' 17.46181 N
123° 24' 24.82195 W

MON approx 2ft
North of center
line 30' south
of fence cor.
FENCES North &
East

Comp. Decline. 14 1/4° E
Agency DCBO
Party Chief J Corsung
Note keeper
Witnesses

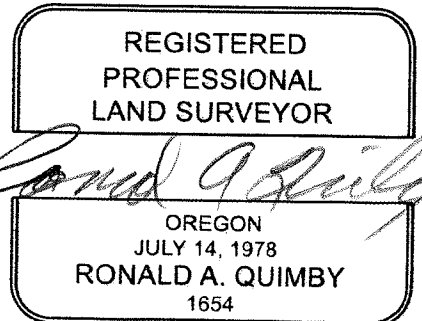

EXPIRES: 12/31/2026

CS 67161-10 pg 2/4

8-11-25

TOWNSHIP 27 RANGE 06 POINT IDENTIFIER # 400440

PRIMARY CORNER DESCRIPTION 1/4 Cor. for Secs. 15 & 16

Alias_____	Description_____
Alias_____	Description_____
Alias_____	Description_____
Alias_____	Description_____

Original - Elder & Gile, Contract #31 dated April, 1853

Set 1/4 Sec. post, from which
 A Y. Oak, 30" dia. bears S.51°E., 31 lks.
 A W. Oak, 15" dia. bears N.52 1/4°W., 352 lks.

B.B. Irving - Davenport Gravel Bar & H. Moore
 Oct. 31, 1934 - C.S. File 37/179

Location determined from deed description ties & location of County Rd. as given in old recorded surveys.
 Set in 1" Iron pipe driven 6" under ground in center line of County Road at terminus there of.
 Black Oak, 30" dia. bears S.2°E., 29 ft. blazed & scribed S 15 - 16 C.S. B.T.

Douglas Co. Surveyors Office - Stephen Flause; Debbie Stewart
 June 16, 1981 - C.S. File 61/24-34

Found - 3/4" I.R. firmly set approx. 2" below paved surface at the centerline of Calkins Rd. #144; This is an unrecorded monument.
 Search for, did not find any evidence of 1" I.P. & the orig. monument.
 The above fd. I.R. was set directly below a nail and ribbon as recorded in Co. Survey record M83-3.
 Orig. BTs searched for, not found
 50" -42" B.Oak, orig. 30", bears S.2°E., 29 ft. measured to the face. Tree has evidence of a healed blaze - no scribing visible.

Set - The 3/4" I.R. is accepted as corner location. We add a collar consisting of an 8" length of 6" dia. steel pipe. Collar is topped with an 8" dia. cast iron cap set flush with the paved road surface and marked "WATER".
 COLLAR COVERED OVER WITH COLD PATCH

New Accessories:
 3/4" I.P. firmly set & protruding 2.3 ft. from ground bears N.65°E., 49.6 ft.
 GONE -6" unmarked Shore Pine bears S.54°W., 102.9 ft.
 -Power Pole w/tag mkd. PPL B6267 PPL bears S.75 1/2°W. 65.1"
 NOT TAGGED -5" Sycamore, bark scribed 1/4 S16 CS BT bears N.52°W. 98.7"
 -Power Pole mkd. "cop 2 Co 334, bears N.3°W., 17.9 ft.

CS 67/61-10 pg 3/4 1

TOWNSHIP 27 RANGE 06 POINT IDENTIFIER # 400440

PRIMARY CORNER DESCRIPTION 1/4 Corner for Secs. 15 and 16

Alias _____ Description _____

Alias _____ Description _____

Alias _____ Description _____

Alias _____ Description _____

Fd. strong reading - monument under pavement. Fd. 48" Oak and other references per record. - Don Bentz, July 1992, M 115-51

Found OK, Nov. 1993 by D. Collier. Partition Plat 1994-0004

- GCRS COTTAGE GROVE: $43^{\circ} 13' 17.46181''$ N
 $123^{\circ} 24' 24.82195''$ W

- Approx 2 FT NORTH OF CENTER LINE,
30 FT SOUTH OF A FENCE CORNER
WITH FENCES RUNNING NORTH + EAST.