

TOWNSHIP 265 RANGE 4W SEC. 15

PLSS # 940400 Date: 7/8/25 By: ke
This survey consists of:

DOUGLAS COUNTY OREGON

DATE 6-25-25

Map: _____

Narrative: _____

Corner Rpt: CS 07/00-51

Corner Designation

1/4 COR S15
S22

DOUGLAS COUNTY
SURVEYOR

Monument(s) Found: (Condition and Source)

2 1/2" DCSD BRASS CAP
Proj 9"

___ Condition report

___ Not Found

___ Renewed

___ Unrecorded

___ Surveyed In

Previous Renewals

DCSD 1961 CS 49/125-8

DCSD 1977 CS 59/38-12

DCSD 1980 CS 61/11-4

De Groot 1997 M 127-16

DCSD 2001 CS 66/21-23

Hibbs 2019 RP 2019-0034 A-B

MONUMENT DETAIL

COUNTY SURVEYORS
OFFICE

1/4 S15
S22

Accessories Found

1/2" Iron Rod N 27 1/2° W 74.0 FT (1947)

3/4" Iron Rod West 14.0 FT up 2' (1977)

1/2" Iron Pipe North 51.9 FT Down 8"

Monument Set (Procedure and Description)

MONUMENT DETAIL

Blank lines for Monument Set description.

New Accessories

5/8" x 30" Iron Rod S71°E 7.2 FT with DCSO Plastic Cap

Blank lines for New Accessories description.

Sketch of Monument, Accessories, and General Area

Location & Comments

OCRS COORDINATES
Cottage Grove - Canyonville
Zone

COR. 15 25'± West
OF Gravel Drive
AND 20 FT± South
OF Wild River
Drive

N 146 408.826
E 210 567.780

Comp. Decline 145°E
Agency DCSO
Party Chief J. Loring
Note keeper
Witnesses

CS 67/60-51
pg 2/4

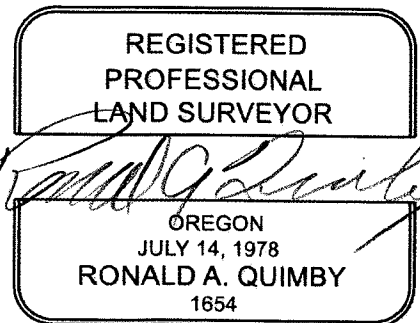

EXPIRES: 12/31/2026

TOWNSHIP 26 RANGE 04 POINT IDENTIFIER # 440400

PRIMARY CORNER DESCRIPTION 1/4 Cor. for Secs 15 and 22

Alias _____	Description _____
Alias _____	Description _____
Alias _____	Description _____
Alias _____	Description _____

<p>Original - Addison R. Flint, Contract #56 dated March, 1855 (DCSO Records, Volume 11 Page 4443)</p> <p>-----</p> <p>Set ¼ sec. post, from which An Ash 12" dia. bears N.84½°E., 990 lks. dist. A B.Oak 15" dia. bears S.53°W., 782 lks. dist.</p>
<p>James W. Byron, Deputy Surveyor - Clete Putnam - June 30, 1961 C.S. File 49/125-8</p> <p>-----</p> <p>Found - Brass cap (bent) at corner. We straighten & reset cap at same location. This corner was renewed by B.B. Irving, 1947 but not recorded. We find ½" iron rod 74.0 ft. N.27°40'W., as shown in B.B.I. notes. Set - We set ¾" iron rod South 7.0 ft. in South fence line of old County Road. No bearing trees near. Tie to Iron Rod shown in C.S. File 39/88.</p>
<p>Doug. Co. Surveyors Office - R.B. Kimberling; P.L. Earle August 2, 1977 - C.S. File 59/38-12</p> <p>-----</p> <p>Found - A 1" Iron pipe with brass cap 8" above ground, mkd: "County Surveyors Office" T 26 S R 4 W S 15 S 22</p> <p>No trace of bearing trees but passed several 150 year old Oak trees in SW quadrant closer than 500 ft. A ½" square iron rod bears N.27½°W., 74.0 ft. A ¾" x 30" iron rod laying down & buried 0.5 ft. approx. bears South 7.0 ft., 1.0 ft. South of fence line of Co. Rd.</p> <p>New Accessory: Reset ¾" x 30" iron rod 26" in ground, bears due West 14.0 ft. 1.5 ft. East of Co. R/W corner post, 0.8 ft. North of fence line.</p>
<p>Fd. OK, Co. Surveyors Off. L. Monrean, 6/19/1980 C.S 61/11-4 Fd. OK, K.DeGroot, June 1997 - M 127-16</p>
<p>continued next page</p>

CS 67/60-51 pg 3/4

TOWNSHIP 26 RANGE 04 POINT IDENTIFIER # 440400

PRIMARY CORNER DESCRIPTION 1/4 Cor. Secs. 15 & 22

Alias _____	Description _____
Alias _____	Description _____
Alias _____	Description _____
Alias _____	Description _____

Douglas Co. Surveyors Office - Randall W. Smith, Deputy -
 Stephen J. Flause - 5/31/2001 - C.S. File 66/21-23

Found - 1947 DCS0 brass cap iron pipe protrudes 9" above
 ground. COUNTY SURVEYOR OFFICE

T26S R4W

1/4 S

S 15

S 22

✓ 1/2" Iron rod bears N.27 1/2°W., 74.0 ft. (1947)

1961 3/4" iron rod not found.

✓ 3/4" iron rod protrudes 2' above ground bears West
 14.0 ft. (1977)

New - ✓ Fd. 1/2" iron pipe 8" below ground bears North 51.9 ft
~~Power pole.~~

Compass decl. 17 3/4°E.

Note - A search of records in CS 39/88 indicates 1/4 cor. set
 at mid point between section corners see call
 sheet dated 7/28/47

Fd. BC 10/2019 - by N. Hibbs - 2019-0034A&B

OCRS - N-146408.826, E-210567.780

5/8 x 30" IR, 7 1/2 FT, S 71° E

CORNER LIES 25 FT WEST OF GRAVEL
 DRIVEWAY, 20 FT SOUTH OF WILD RIVER
 DRIVE.