

GOVERNMENT CORNER RESTORATION FORM

FILED

TOWNSHIP 27S RANGE 3W SEC. 9

PLSS # 400540

Date: 7/8/2018 By: IC  
This survey consists of:

Map: \_\_\_\_\_

DOUGLAS COUNTY OREGON

DATE 2-8-19

Narrative: \_\_\_\_\_  
Corner Rpt: CS 67/10-46

Corner Designation

1/4 59/510

DOUGLAS COUNTY  
SURVEYOR

Monument(s) Found: (Condition and Source)

2 1/2" DCSO 1969 BRASS

CAP Proj 6"

\_\_\_ Condition report

\_\_\_ Not Found

\_\_\_ Renewed

\_\_\_ Unrecorded

\_\_\_ Surveyed In

Previous Renewals

DCSO 1969 CS 64/40

EDWARDS 2007 M 153-3

BLM RESURVEY 2008 Vol 56

pg 21832

MONUMENT DETAIL

COUNTY SURVEYORS  
OFFICE

T27S

1/4 59/510 R3W

1969

Accessories Found

16" X 30 FT Barkless Cedar Spay

N 69°W 10.6 FT

5 TRUNK 3 FT TALL SAWED MAPLE STUMP

N 35°19' E 27.2 FT HEATED BLAZE

3/4" IRON ROD N 45°1/2' W 28.0 FT (Rec  
N 42°W)

10" D. Fir N 44°W 14.1 FT Fully Heated  
Double BLAZE

Monument Set (Procedure and Description)

MONUMENT DETAIL

New Accessories

33" D. FIR S 57 1/2° E 86.7 FT Scribed  
1/4 510 CS BT Tree on south side  
of Jim Creek Road

16" D. FIR S 21 1/2° W 20.6 FT Scribed  
X BT ON HIGH LOW BLAZE

Sketch of Monument, Accessories, and General Area

Location & Comments

Comp. Decline. 14<sup>3</sup>/14<sup>6</sup>  
Agency \_\_\_\_\_  
Party Chief S. F. HAUSE  
Note keeper \_\_\_\_\_  
Witnesses J. LORSUNG

REGISTERED  
PROFESSIONAL  
LAND SURVEYOR

OREGON  
JULY 14, 1978  
RONALD A. QUIMBY  
1654

EXPIRES: 12/31/2026

CS 67160-46 pg 2/6

T27 R 03 S9

PLSS: 400540

DATE: 2/8/19

CREW: <sup>V4</sup> 59/510

MONUMENT FOUND:

2 1/2" DIA. B.C. ON 1" I.R. I.P. FROM 1969 DCSO  
MARKED AS DESCRIBED

PLUMB  
PROJ: 6"

ACC FOUND:

O.B.T: 16" X 30 FT. BARKLESS CEDAR SNAG  
AS DESCRIBED, BEARS N 69° W, 10<sup>6</sup> FT. DIST.

'69 BT 5 TRUN: 3 FT TALL SAWN MAPLE STUMP HEALED  
BLZ. BEARS N 35 3/4° E, 27<sup>2</sup> FT. DIST.

'69 BEARING OBJ. 3/4" I.R. FLUSH WITH GRND.

NEW: BEARS N 45 1/2° W, 28<sup>2</sup> FT. DIST

(SEE OVER FOR MORE)

33" D. FIR SCRIBED "1/4 S 10" CSBT BEARS S 57 1/2° E, 86<sup>2</sup> FT.  
(TREE IS ON SOUTH EDGE OF SOUTH SHOULDER  
OF JIM CREEK RD.)

16" D. FIR SCRIBED "X" BT ON LOW DOUBLE BLZ.

BEARS S 21 1/2° W, 20<sup>6</sup> FT. DISTANT.

(BASE OF TREE VERY PISTOL BUTT)

CS 67140-96

pg 314

SKETCH:

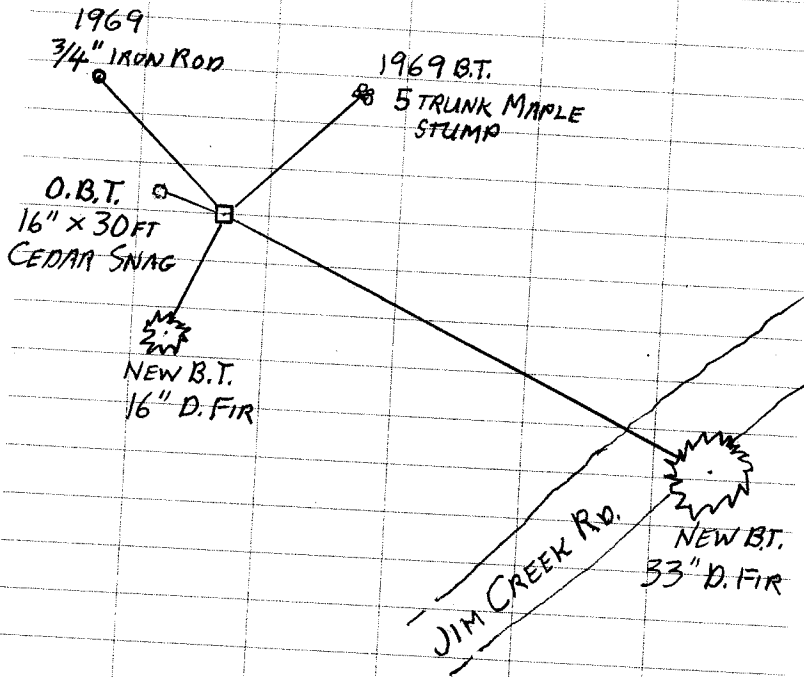

CS 67/60-46  
pg 4/6

DECLINATION:  
14 3/4° E

TOWNSHIP 27 RANGE 03 POINT IDENTIFIER # 400540

PRIMARY CORNER DESCRIPTION 1/4 Cor. Secs. 9 & 10

Alias \_\_\_\_\_ Description \_\_\_\_\_  
Alias \_\_\_\_\_ Description \_\_\_\_\_  
Alias \_\_\_\_\_ Description \_\_\_\_\_  
Alias \_\_\_\_\_ Description \_\_\_\_\_

GLO Survey by Sam C. Flint, Under Contract #454, dated June 19, 1882 (DCSO Records Vol. 12 Page(s) 5008)

-----  
Set maple post, 3 ft. long, 3" sq., firmly in the ground for 1/4 sec. cor. mkd 1/4 S on E & W faces, from which  
A fir, 28" dia., bears S.5°E., 16 lks., mkd: 1/4 S BT.  
A cedar, 8" dia., bears N.69°W., 16 lks., mkd: 1/4 S BT.

Douglas Co. Surveyors Office - Vernon "Ray" Tracy - Jack Heritage - V. Perron - June 20, 1969 - C.S. File 54/40

-----  
Found - O.B.T. as follows:  
Orig. 8" now 24" Cedar N.69°W. 10.6 ft. now 25 ft. hi snag, Previously opened, possible scribe mrk. on upper blaze. Chop out lower blaze & find "BT" scribe & Reverse. No trace other OBT except probable stump hole in ground at bearing & dist. at Cor. point.  
Set - 1" I.P. & Brass cap mrk: County Surveyors T27S Office, 1969 1/4 S9|S10 R3W  
6" Maple N.37°E. 27.2 ft. mkd: 1/4 S10 CS BT.  
8" Hemlock N.73°W. 16.2 ft. mkd. 1/4 S10 CS BT.  
Also - As reference monument, Set 3/4" x 36" Iron Rod N.42°W., 29.0 ft. on South shoulder of access Road. Jim Creek access Road bears south approx. 100 ft. 1/4 Cor. lies on steep S.W. slope between roads.

David Edwards - 5/2007 - M153-3

-----  
Found - Brass Cap - 1969  
13" Maple N.37°E., 27.2'  
10" Hemlock snag N.73°W., 16.2'  
Both with healed blaze.  
New - 8" fir N.53°W., 15.3'  
6' steel post, 2' north.

BLM Dependent resurvey by A Bert Skeesick Cadastral Surveyor, and Robert H. Browning, Surveying Tech. Group No. 2300 surveyed March/April 2008 - (DCSO records Vol. 56 Pg 21832)

-----  
The 1/4 sec. cor. of secs. 9 and 10, perpetuated by the Douglas County Surveyors Office in 1969, further perpetuated by Edwards, in 2007, monumented with an iron post, 1 1/4" dia., firmly set, projecting 4" above the ground, with brass cap (properly) mkd.  
from which the remains of an original bearing tree  
A cedar snag, 16" dia., bears N. 69° W., 10.6 ft., with no marks visible. continued next page

CS 6/16/00-46  
pg 516

TOWNSHIP 27 RANGE 03 POINT IDENTIFIER # 400540

PRIMARY CORNER DESCRIPTION 1/4 Cor. Secs. 9 & 10

Alias \_\_\_\_\_ Description \_\_\_\_\_

Alias \_\_\_\_\_ Description \_\_\_\_\_

Alias \_\_\_\_\_ Description \_\_\_\_\_

Alias \_\_\_\_\_ Description \_\_\_\_\_

and accessories mkd. by the Douglas County Surveyors Office  
A maple, 13" dia., bears N.35 $\frac{3}{4}$ °E., 26.0 ft., with a healed  
double blaze.

An iron rod, 5/8" dia., firmly set, flush with the ground,  
bears N.45°27'38" W., 28.0 ft., with no marks visible.  
and bearing tree mkd. by Edwards

A fir, 9" dia., bears N.47 $\frac{1}{2}$ °W., 14.1 ft., with scribe  
marks T27S R3 S9 BT visible on an open blaze.

Corner is located 2.0 ft. south of a steel fence post, firmly  
set, projecting 4 ft. above the ground.

(See plat for bearings & distances of the lines)

CS 67160-46 pg 4/6