

GOVERNMENT CORNER RESTORATION FORM

FILED

TOWNSHIP 32S RANGE 9W SEC. 9

PLSS # 40540

Date: 5/14/25 By: KL  
This survey consists of:

DOUGLAS COUNTY OREGON

DATE 5/8/25

Map: \_\_\_\_\_

Narrative: \_\_\_\_\_

Corner Rpt: CS 67/00-30

Corner Designation

DOUGLAS COUNTY  
SURVEYOR

Monument(s) Found: (Condition and Source)

2 1/2" GLD BRASS CAP  
UP 6"

\_\_\_ Condition report

\_\_\_ Not Found

Renewed

\_\_\_ Unrecorded

\_\_\_ Surveyed In

Previous Renewals

DCSO 1967 CS 54/44-7

MONUMENT DETAIL

1/4  
59/510  
1917

Accessories Found

28" CHINGUAPIW N 87°W 17.8 FT Fully  
Healed Single BLAZE ADD 3 1/2" MAG  
NAIL RIGHT Side Center

29" CHINGUAPIW S 31°W 29.4 FT Scribes  
59 CS BT VISIBLE ON PORTION OF  
BLAZE EXPOSED BY LIGHTNING SCAR  
ADD 3 1/2" MAG NAIL RIGHT Side Center

New Accessories

10" D. FIR N141°E 18.2 FT Scribed  
1/4 SID BT ON Double BLAZE 3 1/2" MAG  
NAIL RIGHT SIDE CENTER

4" D. FIR S33°E 2.2 FT Scribed  
"X" BT ON Double BLAZE 3 1/2" MAG  
NAIL RIGHT SIDE CENTER

Sketch of Monument, Accessories, and General Area

Location & Comments

Late Dep.

42° 48' 16.60636 N

123° 45' 20.66944 W

MON. ON moderate EAST  
Slope in old regrowth  
FOREST

MON IS APPROX  
150' E. EAST OF  
Stockpile PAD  
WHICH IS NORTH  
OF GRAVEL ROAD

Comp. Decline. 14 1/2° E  
Agency DCSO  
Party Chief S. FIAUSE  
Note keeper  
Witnesses J. Lorusney

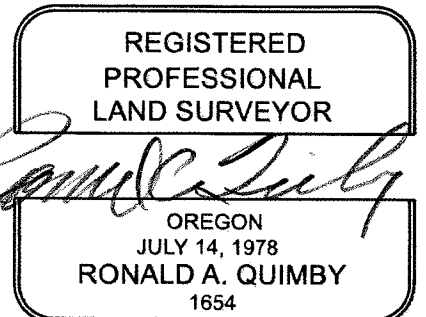

CS 67/60-30

pg 2/3

EXPIRES: 12/31/2026

TOWNSHIP 32 RANGE 09 POINT IDENTIFIER # 400540

PRIMARY CORNER DESCRIPTION 1/4 Cor. Secs. 9 & 10

Alias \_\_\_\_\_ Description 42° 48' 16.60636" N  
 Alias \_\_\_\_\_ Description 123° 45' 20.66944" W  
 Alias \_\_\_\_\_ Description \_\_\_\_\_  
 Alias \_\_\_\_\_ Description GEO XT POSITION

MINI GIS  
42.80461  
123.75572

GLO Dependent survey by Fred Mensch & Gerald A. Sorrels, Dep. Surveyors under special instructions dated Dec. 22, 1916 - (DCSO records Vol. 21 Page(s) 8901)

Set an iron post, 3 ft. long, 1" dia., 26" in the ground, for 1/4 sec. cor., with brass cap marked

2 1/2" GLO CAP S 9 1/4 S 10 1917

PROT. 6"

from which

A yew, 7" dia., bears N.30°E., 20 lks., mkd: 1/4 S10 BT.  
A chinquapin, 12" dia. bears N.87°W., 27 lks. mkd: 1/4 S9 BT

RENEWED 5/8/25

Douglas Co. Surveyors Office - John M. Powell - Frank Jones & J. Brady - May 1967 - C.S. File 54/44-7

Found - GLO Brass Cap at corner, properly marked in 1917. ~~NO EVIDENCE~~ <sup>SEE ABOVE</sup>  
7", now 8" Yew, N.30°E., 13.2 ft., tree rotted, scribe marks not legible.

~~NO EVIDENCE~~ 28" - 12", now 15" Chinquapin N.87°W 17.8 ft., rotten face, "4 39" visible. FHSB

New BTs - ~~9" Chinquapin N.62°E., 3.8 ft. mkd. 1/4 S10 CS BT~~  
29" - 14" Chinquapin S.31°W, 24.4 ft. mkd. 1/4 S9 CS BT.

"S9 CS BT" VISIBLE

DECLINATION 14 1/2° E ADD 3 1/2" MAG NAIL R SC TO FOUND B.T.'s

ON PORTION OF BLAZE EXPOSED BY LIGHTNING SCAR

NEW REFS

10" D. FIR SCRIBED " 1/4 S10 " BT " ON A DOUBLE BLAZE N41°E, 18 1/2 FT.

4" D. FIR SCRIBED " X " BT " ON HIGH-LOW BLZ. S 38°E, 2 1/2 FT.

MONUMENT ON MODERATE EAST SLOPE IN OLD REGROWTH FOREST.

MONUMENT IS APPROX 150 FT. EAST FROM STOCKPILE PAD WHICH LAYS NORTH OF A GRAVEL RD.