

TOWNSHIP 32S RANGE 7W SEC. 30

PLSS # 100200

Date: 5/5/25 By: ke
This survey consists of:

DOUGLAS COUNTY OREGON

DATE 4-24-25

Map: _____
Narrative: _____
Corner Rpt: CS 67160-22

Corner Designation

Sec Cor $\frac{25}{30}$
 $\frac{36}{31}$

DOUGLAS COUNTY
SURVEYOR

Monument(s) Found: (Condition and Source)

2 1/2" DCSO BRASS CAP
IN MOUND OF STONE

- Condition report
- Not Found
- Renewed
- Unrecorded
- Surveyed In

Previous Renewals

GLD 1883 Vol 21 pg 8782
DCSO 1967 CS 54/36-93
DCSO 1968 CS 54/36-157
DCSO 1992 CS 64/35-4
Shaver 1996 M 123-17

MONUMENT DETAIL

COUNTY SURVEYORS
OFFICE

R T 32S R
S $\frac{525}{530}$ 7
W $\frac{536}{531}$ W
1967

Accessories Found

17" D. Fir S 85 1/2 E 13.4 FT Fully healed
Double BLAZE ADD 3 1/2" MAG NAIL RIGHT
Side Center
10" X 9' Rotted D. Fir SWAG S 78 E 15.0 FT
Almost healed Double BLAZE ADD 3 1/2" MAG
NAIL RIGHT Side Center
17" D. Fir N 34 W 3.5 FT Fully Healed
Double BLAZE ADD 3 1/2" MAG NAIL
RIGHT Side Center
11" MADRONE S 40 W 23.9 FT (Rec 24.1 FT)
Scribes Visible on upper BLAZE
32S RBW S 36 CS Lower BLAZE Healed
ADD 3 1/2" MAG NAIL Left Side Center

Monument Set (Procedure and Description)

MONUMENT DETAIL

Blank lines for Monument Set description.

New Accessories

Blank lines for New Accessories.

Sketch of Monument, Accessories, and General Area

Location & Comments

MON ON Rocky N.E Slope
old Regrowth oak fir madrone

MON IS APPROX.
400 FT SOUTH OF
FIRST SWITCHBACK
ON SKULL CREEK
ROAD

GED XT GPS POSITION

LAT 42° 75414 N
LONG 123° 58342 W

Comp. Decline. 14 1/2° E
Agency DCSO
Party Chief S. F. HAUSE
Note keeper
Witnesses J. LORSUNG

CS 67/60-22

pg 2/4

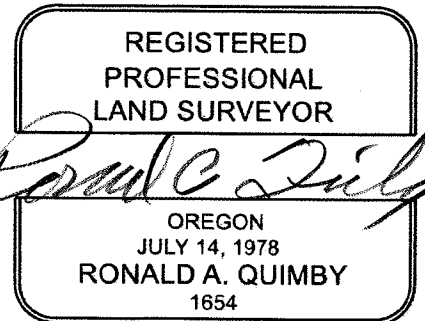

EXPIRES: 12/31/2026

SKULL CRK, SLIDE

TOWNSHIP 32 RANGE 07 POINT IDENTIFIER # 100200

PRIMARY CORNER DESCRIPTION Sec. cor. for 30 & 31; 25 & 36 of T32-8

Alias _____	Description _____
Alias _____	Description _____
Alias _____	Description _____
Alias _____	Description _____

MINI GAS
42.75411
123.58340

GLO survey by W.H. Byars, Deputy Surveyor under contract # 420 survey dated Sept 16 1881 (DCSO records Vol. 20 Page(s) 8707)

Marked a Fir tree, 28" dia., for the corner to secs. 25, 30, 31 and 36 marked T32S R7W S30 on NE.; S31 on SE.; S36 on SW.; and T32S R8W S25 on NW.; with one notch on South and five notches on North edges, from which

A Fir 18" dia., bears N.68°E., 70 lks. mkd. T32S R7W S30 BT.

A Fir 20" dia., bears S.70°E., 74 lks. mkd. T32S R7W S31 BT.

A Fir 18" dia., bears S.10°W., 72 lks. mkd. T32S R8W S36 BT.

A Fir 10" dia., bears N.82°W., 100 lks. mkd. T32S R8W S25 BT.

Cor. Fd. and used in GLO survey by Richmond Dickerson, under Contract #474, May 1883 (DCSO records, Vol. 21 Page 8782)

Douglas Co. Surveyors Office - John M. Powell, Frank Jones, Joe Darby, crew - November 1967 - C.S. File 54/36-93

Found - 28" Corner Tree, now rotten stob.
 Orig. 20" Fir now stob, S.70°E., 48.8 ft., no scribing.
 Orig. 18" Fir, now burnt stub, S.10°W., 47.5 ft. bark scribe found, T3 R8W BT
 Orig. 10" Fir, now stob, N.82°W., 66.0 ft., scribe marks but not legible.
 Distances to bearing trees appear to be slope distances.

Set Brass cap at South edge of Corner tree stob mkd:

County Surveyors Office			
R	T 32 S	R	
8	S 25 S 30	7	
W	S 36 S 31	W	
1967			

New BTs -8" D.Fir, East 13.4 ft. mkd. T32S R7W S30 CS BT.
 8" D.Fir S.78°E., 16.1 ft. mkd. T32S R7W S31 CS BT.
 9" D.Fir N.34°W., 3.5 ft. mkd. T32S R8W S25 CS BT.
 10" Laurel S.4°W., 25.2 ft. mkd. T32S R8W S36 CS BT.

This corner lies approx. 30 ft. South of high rock point.

Fd. OK, DCSO, J.Powell, March 1968, C.S. File 54/36-157

(Cont. Next Page)

CS 67/60-22 pg 3/4

PRIMARY CORNER DESCRIPTION Sec. Cor. for 30 & 31; 25 & 36, T32-8

Alias _____	Description _____
Alias _____	Description <u>GEO XT GPS POSITION</u>
Alias _____	Description _____
Alias _____	Description <u>42.75414 N</u>
Alias _____	Description <u>123.58342 W</u>

RENEWED 4/24/25

Douglas Co. Surveyors Office - Randall Smith, Stephen Flauser, crew - Dec. 10, 1992 - C.S. File 64/35-4

PROPERLY MARKED AND SEE BELOW -----

Found - A 2 1/2" dia. 1967 DCSO brass cap on a 1 1/4" O.D. Iron pipe, protruding 18" above ground.

NOT CHKD Orig. 18" now 20" dia., D.Fir stob with illegible bark scribing, bears S.10°W., 44.8 ft. (Rec. S.10°W., 47.5 ft.)

17" 8" now 13" dia., D.Fir with a fully healed double blaze bears S.85 1/2° E, 13.4 ft. (Rec. East, 13.4 ft.)

ADD 3 1/2" MAG NAIL R.S.C.

10" x 9' DEAD ROTTED SNAG now 9" dia., D.Fir with a ALMOST partially healed double blaze scribe marks visible, bears S.78°E. 15.0 ft. (Rec. S.78°E., 16.1 ft.)

17" 9" now 13" dia., D.Fir with a fully healed double blaze bears N.34°W, 3.5 ft. (agrees w/rec)

ADD 3 1/2" MAG NAIL R.S.C.

11" 10" now 10" dia., Madrone with a partially healed double blaze scribing visible "32S R8W S36 CS BT" bears S.4°W, 24.1 ft. (Rec. S.4°W., 25.2 ft.)

LOWER BLZ HEALED 3/2" MAG NAIL L.S.C.

A mound of stone is added around base of DCSO BC/IP. Brass cap protrudes 3" above 3 ft x 2 ft x 15" deep mound of stone.

No new accessories.
DECLINATION 14 1/2° E

Fd. OK - Bruce Shaner - 1/6/96 - M 123-17

MON. ON STEEP ROCKY NE SLOPE, OLD REGROWTH: OAK, FIR, MADRONE
MON. IS APPROX 400 FT. SOUTH FROM FIRST SWITCHBACK ON SKULL CRK. RD.