

GOVERNMENT CORNER RESTORATION FORM

FILED

TOWNSHIP 325 RANGE 51W SEC. 12 PLSS # 602500

Date: 4/22/2025 By: KE
This survey consists of:

DOUGLAS COUNTY OREGON

DATE 4/9/25

Map: _____

Narrative: _____

Corner Rpt: CS 01100-17

DOUGLAS COUNTY
SURVEYOR

Corner Designation

1/4 COR S12
S13

Monument(s) Found: (Condition and Source)

BLM BRASS CAP

Condition report

Not Found

Renewed

Unrecorded

Surveyed In

Previous Renewals

DCSO 1968 CS 54/65.2

NOT FD

BLM RESURVEY 1973-1975

Vol 40 pg 15977

MONUMENT DETAIL

Accessories Found

SAWN - SINGED 17" X 1 FT D. FIR STUMP
N 64° E 38.5 FT (REC 60 LKS) UNDER LOG
CUT LOW NO BLAZE

SAWN SINGED 25" X 2 1/2 FT D. FIR STUMP
S 10 1/2° W 36.3 FT (REC 55 LKS) FULLY HEATED
SINGLE BLAZE ADD 3 1/2" MAG NAIL TOP
CENTER

Monument Set (Procedure and Description)

MONUMENT DETAIL

New Accessories

24" X 2 FT SAWN D. FIR STUMP N 88° E
21.2 FT 3 1/2" MAG NAIL TOP CENTER

18" X 1 FT SAWN D. FIR STUMP N 74° W
21.3 FT 3 1/2" MAG NAIL TOP CENTER

Sketch of Monument, Accessories, and General Area

Location & Comments

LAT & LONG

LAT 42° 47' 48.44548

LONG. 123° 35' 37.52798

Comp. Decline. 19 1/2° E
Agency DCSO
Party Chief S. Fause
Note keeper
Witnesses J. Larsung

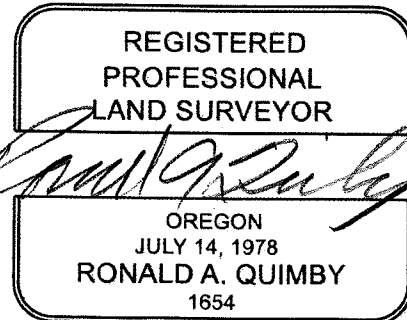

CS 67/60-17

pg 2/4

EXPIRES: 12/31/2026

T32S-R08W-640500

LEICA GPS POSITION

42° 47' 48.44548" N

123° 35' 37.52798" W

CS 67160-17 pg 3/4

