

GOVERNMENT CORNER RESTORATION FORM

FILED

TOWNSHIP 31S RANGE 7W SEC. 35 PLSS # 540160

Date: 4/22/2025 By: KC  
This survey consists of:

DOUGLAS COUNTY OREGON

DATE 4-1-25

Map: \_\_\_\_\_

Narrative: \_\_\_\_\_

Corner Rpt: CS 67/60-16

Corner Designation

DOUGLAS COUNTY  
SURVEYOR

C N 1/16 S 35

Monument(s) Found: (Condition and Source)

\_\_\_ Condition report

5/8" Iron Rod with 2 1/2"

\_\_\_ Not Found

Alum. Cap 4p 0.2

\_\_\_ Renewed

\_\_\_ Unrecorded

Previous Renewals

\_\_\_ Surveyed In

Established by Lone  
Rock Timber M184-40

MONUMENT DETAIL

Lone Rock Timber

C N 1/16

S 35

2024

85006 PLS

Accessories Found

17" D. FIR N 37° 34' E 14.3 FT OPEN  
Single BLAZE Large Alum. Nail Left  
Side Center

16" PACIFIC YEW S 63° 1/2° W 17.9 FT OPEN  
Single blaze Large Alum Nail  
Right side center

Monument Set (Procedure and Description)

MONUMENT DETAIL

Horizontal lines for Monument Set description.

New Accessories

Horizontal lines for New Accessories description.

Sketch of Monument, Accessories, and General Area

see attached sheet

Location & Comments

Horizontal lines for Location & Comments.

OCRS coordinates  
Cottage Grove - Canyonville  
zone

N 1382.591  
E 120311.684

Comp. Decline. 14 1/2° E  
Agency DCSO  
Party Chief S. FIAUSE  
Note keeper  
Witnesses J. LORSBURY

CS 67160-116

pg 2/3

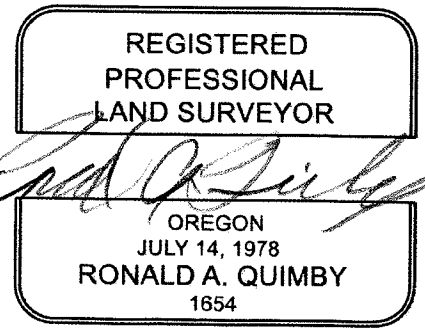

OCCRS CANYONVILLE COTTAGE GROVE COORDS

1382.591 N  
120311.684 E

540160

T31S, R7W, ~~560140~~

VISITED 4/1/25

- FOUND 7" X 2' TALL ROTTEN PINE STUMP AT (RECORD N55 3/4°W 17.16' (26 LINKS)) NO TAG OR VISIBLE FACE.
  - FOUND ROTTEN DOUGLAS-FIR STOB AT (RECORD S17 3/4°W 26.4' (40 LINKS)) WITH A VISIBLE "BT" SCRIBE AND BLM TAG.
  - NEW 14" PONDEROSA PINE BEARS S19 1/2°W 23.1'. WE SCRIBE 1/4 S35 BT AND TAG.
  - NEW 23" DOUGLAS-FIR BEARS N21 1/4°W 23.1'. WE SCRIBE 1/4 S26 BT AND TAG.
- CORNER MONUMENT LIES ON A GENTLE SOUTH FACING SLOPE IN MATURE TIMBER. TOP OF MONUMENT IS 0.2' ABOVE GROUND LEVEL. WE PLACE A 5 1/2' TALL STEEL GALVANIZED U-POST 1.0' WEST.

3) CENTER NORTH ONE SIXTEENTH CORNER OF SECTION 35, T31S R7W (PLSS 540160)

SET 5/8" X 40" IRON ROD WITH 2.5" ALUMINUM CAP MARKED LONE ROCK TIMBER CN 1/16 S35 2024 85006PLS

- NEW 17" DOUGLAS-FIR BEARS N37 3/4°E 16.3' WE SCRIBE CN 1/16 S35 BT AND TAG. OPEN SB, LARGE ALUM. NAIL L.S.C.
- NEW 16" PACIFIC YEW BEARS S63 1/2°W 17.9' WE SCRIBE CN 1/16 S35 BT AND TAG. " " " " R.S.C.

CORNER MONUMENT LIES ON FLAT CREEK BENCH IN MATURE TIMBER, APPROXIMATELY 75' EAST AND 160' SOUTH OF MIDDLE CREEK RUNNING SOUTHWEST AND 40' EAST OF THE CENTERLINE OF MIDDLE CREEK GRAVEL SURFACE ROAD. TOP OF MONUMENT IS 0.2' ABOVE GROUND LEVEL. WE PLACE A 5 1/2' TALL STEEL GALVANIZED U-POST 1.0' NORTH WEST

4) CENTER QUARTER CORNER OF SECTION 35, T31S R7W (PLSS 540140)

FOUND 1964 BLM BRASS CAP AND IRON PIPE MARKED T31S R7W C 1/4 S35 AS PER VOLUME 33 PAGE 13644-13645 FILED IN THE DOUGLAS COUNTY SURVEYOR'S OFFICE.

- FOUND INDETERMINATE SIZE ROTTEN DOUGLAS-FIR STUMP BEARS N21 1/4°W 28.3' TO A SPIKE IN THE TOP CENTER (RECORD N21°W 28.3').
- FOUND TIN COVERED FIR STUMP BEARS S53 1/2°W 22.8' (RECORD S53°W 16.5') WITH BLM TAG AND SPIKE.
- NEW 12" DOUGLAS-FIR BEARS N28 1/2°W 28.5'. WE SCRIBE C1/4 S35 BT AND TAG.
- NEW 9" DOUGLAS-FIR BEARS S42°W 17.2' WE SCRIBE C1/4 S35 BT AND TAG.

M184-40

CS 67160-14

pg 2/3