

GOVERNMENT CORNER RESTORATION FORM

FILED

TOWNSHIP 315 RANGE BW SEC. 18 PLSS # 100440

Date: 2-24-2025 By: Ke  
This survey consists of:

DOUGLAS COUNTY OREGON

DATE 2-10-25

Map: \_\_\_\_\_

Narrative: \_\_\_\_\_

Corner Rpt: CS 07110-4

Corner Designation

1/4 COR S13 | S18  
R9W | R8W

DOUGLAS COUNTY  
SURVEYOR

Monument(s) Found: (Condition and Source)

Condition report

Not Found

Renewed

Unrecorded

Surveyed In

BLM BRASS Cap  
projecting 4"

Previous Renewals

MONUMENT DETAIL

GLO Survey 1900 Vol 19 pg 8241

BLM Resurvey 1940 - 1962

Vol 31 - pgs 13185 - 86

DCSO 1967 CS 54/32 - 43

Woodruff 2008 M 156-5

Woodruff 2010 M 161-7

Quimby 2015 CS 65/87-14

1/4  
S13 | S18  
R9W | R8W  
T315  
1962

Accessories Found

30" X 10 FT Very Rotted Fir 50A9 N50°E 12.0 FT

No BLAZE NO NAIL

26" X 11 FT SAWN FIR N77°E 18.8 FT Fully

Healed Single BLAZE

17" FIR N35°W 15.9 FT (REC 15.8 FT)

Fully Healed Single BLAZE

10" FIR S36°W 24.3 FT (REC 24.5 FT) Fully

Healed Single BLAZE

23" FIR S15°W 37.2 FT Full Healed

Single BLAZE

Metal Posts 1 1/2 FT South AND ON

North Edge of B.C.

All Tree were side spiked with 3 1/2"

MAG Nails RIGHT Side Center

Monument Set (Procedure and Description)

MONUMENT DETAIL

---



---



---



---



---



---

New Accessories

---



---



---



---



---



---



---



---



---



---

Sketch of Monument, Accessories, and General Area

Location & Comments

GIS MAP LATELONG  
 42° 87508N  
 123° 70199W

MON IS APPROX  
 200' EAST OF  
 GRAVEL ROAD  
 ON MODERATE WEST SLOPE,  
 YOUNG REPROD TO EAST, OLDER  
 FOREST WEST

Comp. Decline. 14 1/2° E  
 Agency DCSO  
 Party Chief S. E. AUSE  
 Note keeper  
 Witnesses J. LORESONG

CS 67160-4

pg 2/4.

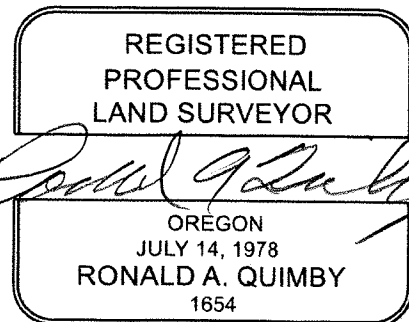

EXPIRES: 12/31/2026

TOWNSHIP 31 RANGE 08 POINT IDENTIFIER # 100440

PRIMARY CORNER DESCRIPTION 1/4 Cor. for Sec. 18; & 13, T31-9

Alias _____	Description _____
Alias _____	Description _____
Alias _____	Description _____
Alias _____	Description _____

GLO survey by W.H. Byars, Deputy Surveyor under contract # 456 dated July 28, 1882 (DCSO records Vol. 19 Page(s) 8106)

-----  
Set a Cedar post 3 ft. long, 3" sq., 20" in the ground, mkd. 1/4 S on the W. side for the 1/4 sec. cor., and from which  
A Fir 24" dia., bears N.64°E., 18 lks. dist. mkd. 1/4 S BT  
A Fir 22" dia., bears S.43°W., 14 lks. dist. mkd. 1/4 S BT

GLO survey by Wm. H. Byars, Deputy Surveyor, under Contract #727, dated Dec. 20, 1900 - (DCSO records Vol. 19 Page 8241)

-----  
Corner post gone. Set a Fir post, 4 ft. long, 4" sq., 24" in the ground, mkd. 1/4 S on E. and S13 1/4 S on W. faces. Established from old witness corners.

BLM Resurvey by C.A. White, H.D. Corbing Cad. Surveyor & D.R. Beck, Surveying Tech, Under Group #446, Surveyed Nov. 1960/Sept. 1962 - (DCSO recs Vol. 31 Pages 13185-86)

-----  
The 1/4 sec. cor., determined at record distance from the original bearing trees:

- A Fir 37" dia., bears N.53 3/4°E., 18 lks. dist., mkd. 1/4 S BT on bark blaze, remarked 1/4 S18 BT on bark blaze. (Rec. brg. N.64°E.)
- A Fir 31" dia., bears S.48 3/4°W., 14 lks. dist., visible scribe marks on bark blaze, remarked 1/4 S13 BT. (Rec. brg. S.43°W.)

At the corner point  
Set an iron post, 28" long, 2 1/2" dia., 22" in the ground, with brass cap mkd:

	1/4	
S 13	S 18	
R 9 W	R 8 W	
	T 31 S	
	1962	

Douglas Co. Surveyors Office - John M. Powell, and crew - March 17, 1967 - C.S. File 54/32 -43

-----  
Found - GLO brass cap mkd. in 1962.  
37" D.Fir, now broken snag, N.53 3/4°E., 11.9 ft., bark scribed 1/4 S18 BT.  
31" D.Fir, now stump, S.48 3/4°W., 9.2 ft. Stump out of ground, scribe visible S13.  
New BTs- 14" D.Fir N.77°E., 18.8 ft. mkd. 1/4 S18 CS BT.  
6" Live Oak S.14°W., 56.6 ft. mkd. 1/4 S13 CS BT.  
Corner lies East of Elk Valley Road approx. 150 ft.

Fd. BC & BTs by C. Woodruff, 4/2008 - M156-5  
Fd. by C. Woodruff, 6/2010 - M161-7 continued next page

MINI GIS  
42.87508  
123.76199

TOWNSHIP 31 RANGE 08 POINT IDENTIFIER # 100440

PRIMARY CORNER DESCRIPTION 1/4 Cor for Sec. 18; & 13, T31-9

Alias _____	Description _____
Alias _____	Description <u>GIS MAP LAT &amp; LONG</u>
Alias _____	Description _____
Alias _____	Description <u>42.87509 N</u>

DECLINATION -14 1/2° E 123.70199 W RENEWED 2/10/25

Ron Quimby - Crew: N. Fromdahl & R. Olsen - 2/2015 - C.S.  
File 65/87-14

~~----- PROPERLY MARKED PROT. 4" -----~~

Found - BLM brass cap

*VERY ROTTED 30" x 10"* 35" Fir snag, N. 50° E, 12.0 ft. (rotted) *NO NAIL NO BLZ.*

*SAWN SOLID 26" x 11 FT.* 26" Fir N. 77° E, 18.8 ft. good scar. *FHSB*

New - 17" 12" Fir N. 35° W, 15.89 ft. scribed 1/4 S13 BT. *FHSB ADD 3 1/2" MAG-NAIL RSC.*

10" - 6" Fir S. 36° W, 24.83 ft. scribed 1/4 S13 BT. " " " "

23" - 16" Fir S. 15° W, 37.2 ft. scribed 1/4 S13 BT. " " " "

Clear cut unit to the east.

Note - Corner is on west of new clear cut unit approx 200' east of Rd. #31-8-31 and approx. 200' north of logging spur to clear cut. Rd. #9-13

*ON MODERATE WEST SLOPE*

*YOUNG FOUND METAL LATH 1 1/2 FT SOUTH*

*REPROD. TO EAST " " " ON NORTH EDGE OF B.C. MON*

*OLDER FOREST WEST*

*APPROX. 200 FT EAST FROM GRAVEL RD.*