

TOWNSHIP 31S RANGE 9W SEC. 12 PLSS # 690540

Date: 2-5-2025 By: ke

This survey consists of:

DOUGLAS COUNTY OREGON

DATE 1-29-25

Map: _____

Narrative: _____

Corner Rpt: CS 67159.61

Corner Designation

C 1/4 S12

DOUGLAS COUNTY
SURVEYOR

Monument(s) Found: (Condition and Source)

5/8" I. Rod with 2"
Alum. CAP

Condition report

Not Found

Renewed

Unrecorded

Surveyed In

Previous Renewals

Set by DEGroot 2001
M-137-13

DCSD - 615 CORNER
VISITATION

Rummy 2016 CS 65/93-62

MONUMENT DETAIL

T31S R9W
C 1/4 S12
2001
PLS 1941

Accessories Found

19" D. Fir S 1°27'26" E 20.8 FT Fully
Healed Single BLAZE

23" D. Fir N 81°52'41" W 34.0 FT Fully
Healed Single BLAZE

5/8" I. Rod with plastic cap MKD. BTS
ENG-SURV. S 81°52'41" E 20.0 FT

5/8" I. Rod with plastic cap MKD
BTS ENG-SURV N 1°27'26" W 20.0 FT

Monument Set (Procedure and Description)

MONUMENT DETAIL

Horizontal lines for Monument Set description.

New Accessories

Horizontal lines for New Accessories description.

Sketch of Monument, Accessories, and General Area

Location & Comments

MON IS APPROX
110 FT EAST ON
North - South
RUNNING GRAVE
ROAD

Comp. Decline. 14 1/2° E
Agency DLSO
Party Chief S. F. HAUSE
Note keeper
Witnesses J. LOISHAW

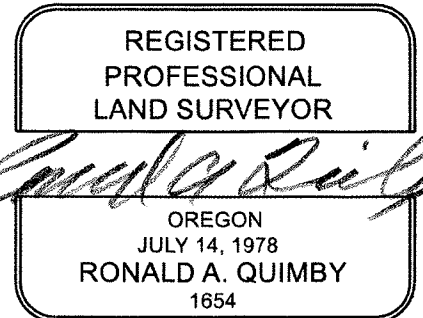

CS 67159-61

pg 2/3

EXPIRES: 12/31/2026

TOWNSHIP 31 RANGE 09 POINT IDENTIFIER # 640540

PRIMARY CORNER DESCRIPTION Center 1/4 Cor. Sec. 12

Alias _____	Description _____
Alias _____	Description _____
Alias _____	Description _____
Alias _____	Description _____

FOUND OK 1/29/25

Kristian DeGroot - For: Roseburg Resources - 6/2001 - M137-13

Set- 5/8"x30" iron rod 29" in the ground w/2" alum. cap stamped: T31S R9W C¼ • S12 2001 PLS 1941

19" 14" D.Fir bears S.1°27'26"E., 20.8 ft. scribed "C¼ S12 BT" *FHSB*

23" 16" D.Fir bears N.81°52'41"W., 34.0 ft. scribed "C¼ S12 BT" *FHSB*

5/8"x30" iron rod w/plastic cap mkd: "BTS ENG-SURV" bears S.81°52'41"E., 20.0 ft.

5/8"x30" iron rod w/plastic cap mkd: "BTS ENG-SURV" bears N.1°27'26"W., 20.0 ft.

BOTH I.R.S HAVE METAL LATH SET ON THE EDGE

Note- All new BTs have double blazed faces w/brass washer stamped "PLS 1941" nail into the lower blaze. Bearings are taken to the center of the tree at the root crown & distances are measured to a nail in the root crown at the center of the tree all BTs have a 6" red band painted around the tree & the blazed face painted red & BT signs nailed to the tree.

DCSO-GIS Corner visitation - 1/22/2004 - Typed: 2/10/2011 - C.S. File 67/33-1

Monument - .625 rebar

Fd. as per M137-13 12/2016 - By R Quimby - C.S. File 65/93-62

MONUMENT IS APPROX 110FT EAST FROM N-S RUNNING GRAVEL RD.

*MINI GIS
42.88958
123.71178*