

GOVERNMENT CORNER RESTORATION FORM

FILED

TOWNSHIP 31S RANGE 9W SEC. 14 PLSS # 54040

Date: 2/6/2025 By: KE  
This survey consists of:

DOUGLAS COUNTY OREGON

DATE 2-4-25

Map: \_\_\_\_\_

Narrative: \_\_\_\_\_

Corner Rpt: CS 07/59-00

Corner Designation

CN 1/16 S 14

DOUGLAS COUNTY  
SURVEYOR

Monument(s) Found: (Condition and Source)

5/8" I. Rod with plastic  
cap marked  
Hostetter 65 1975

Previous Renewals

Established by  
Hostetter in 2009  
per m 160-4

- Condition report
- Not Found
- Renewed
- Unrecorded
- Surveyed In

MONUMENT DETAIL

Accessories Found

21" W. Fir N 76° 49' E 28.7 FT TO  
Spike in place Fully Healed Single  
BLAZE

9" W. Fir fallen out of position  
(REC S 74° 30' W 4.0 FT) All scribing  
visible on party Healed Single  
BLAZE

Metal Post west 0.5 FT

---



---



---



---



---



---

New Accessories

5/8" X 30" Iron Rod with DCSD  
 PLASTIC CAP up 7" BEARS N186°W  
 72.1 FT

Sketch of Monument, Accessories, and General Area

Location & Comments

OCRS Coordinates  
 Cottage Grove - Canyonville  
 Zone

CORNER IS APPROX.  
 45 FT EAST OF  
 GRAVEL ROAD

N 116794.067  
 E 57305.798

Comp. Decline. 14 1/2° E  
 Agency DCSD  
 Party Chief S. F. HAUSE  
 Note keeper  
 Witnesses J. Korsung

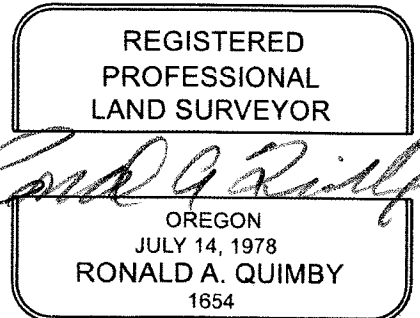

(S89°56'W, 39.98 C)

N 1/4

S 89°51'51" E

E 1/16

1326.05'

BRASS CAP AND ACCESSORIES  
ED BY DOUGLAS COUNTY  
CS FILE 54/32 ).

N34°E IS 25.0 FEET NOT 14.3 FEET

SET: 5/8"  
CAP MAR  
1975" FRC  
20" FIR, S  
BEARS; S  
20" FIR, S  
BEARS; S

1308.80'

N 0°47'43" W

1311.83'

N 0°19'59" W

DCRS CANYONVILLE COTTAGE GROVE COORDS  
16794.067 N  
57305.798 E

CN 1/16

T31S, R9W, S14  
540460

RENEWED 2/4/25 S 89°43'36" E

NE 1/16

DECLINATION 14 1/2° E 1315.52' METAL LATH FOUND WEST 0.5 FT

SET: 5/8"X30" REBAR W/PLASTIC  
CAP MARKED "HOSTETTER LSV PROT 6"  
1975" FROM WHICH:

21" 20" WHITE FIR, SCRIBED "S14 1/16 BT", FHSB  
BEARS; N76°49'E 28.7 FEET TO SPIKE IN FACE

9" FALLEN OUT OF POS. - 8" WHITE FIR, SCRIBED "S14 1/16 BT", FHSB

BEARS; S74°30'W, 4.0 FEET TO SPIKE.

ALL SCRIBING VIS, ON PHSB

NEW REFERENCE

A 5/8" X 30" I.R. / DCSD SET PROT. 4 INCHES  
PLSTC. CAP BEARS N86°W, 72 FT.

1308.80'

N 0°47'43" W

1311.83'

N 0°19'59" W

CORNER IS APPROX. 45 FT. EAST FROM GRAVEL RD.

CS 67/69-60 pg 3/4

C 1/4

N 89°35'12" W

**PROPERTY SURVEY**  
**SECTION 14, T31S, R9W, W.M.**  
**DOUGLAS COUNTY, OREGON**  
**SEPTEMBER 2009**

**SURVEY BY:**  
**HOSTETTER LAND SURVEYING**  
**63538 PINTAIL DR.**  
**COOS BAY, OREGON 97470**

**SURVEY FOR:**  
**ROSEBURG RESOURCES CO.**  
**PO BOX 1088**  
**ROSEBURG, OREGON 97470**  
**PLUM CREEK**  
**93459 OLIVE BARBER ROAD**  
**COOS BAY, OREGON 97470**

**MARRATIVE:**  
 THE PURPOSE OF THIS SURVEY WAS TO ESTABLISH PROPERTY CORNERS AND MARK PROPERTY LINES AS SHOWN.  
 BEARINGS ARE BASED ON GPS OBSERVATIONS USING 4 ASHTECH LOCUS RECEIVERS AND HAVE BEEN ROTATED 2.1242° FROM GRID.  
 BEARING TREE MEASUREMENTS TO ORIGINAL AND OTHER FOUND B.T.S. ARE LISTED TO THE CENTER OF THE TREE, UNLESS OTHERWISE NOTED. MEASUREMENTS LISTED FOR TREES MARKED IN THIS SURVEY ARE TO THE HEAD OF 6" SPIKES, PLACED IN THE ROOT COLLARS BELOW THE FACE FROM THE CORNER MONUMENT.  
 LINE WAS MARKED WITH RED FLAGGING AND 6" STEEL POSTS WERE PLACED ON LINE AT APPROXIMATE 200' INTERVALS ON ALL ROSEBURG RESOURCES PROPERTY LINES. BOTH SIDES OF LINE WERE BLAZED AND PAINTED.

FOUND 1967 BRASS CAP AND ACCESSORIES AS DESCRIBED BY SWEDEN IN 2003 (CS FILE M141.39)

(S89°56'W, 39.98 CH)

N 89°55'31" E

2870.13'

FOUND 1967 BRASS CAP AND ACCESSORIES AS DESCRIBED BY DOUGLAS COUNTY SURVEYOR (CS FILE 5432) EXCEPT:  
 10" CEDAR @ N34°E IS 26.0 FEET NOT 14.3 FEET NOW 12".

(S89°56'W, 39.98 CH)

N 1/4 S 89°51'51" E

1315.52'

1326.05'

SET 5/8"x30" REBAR W/PLASTIC CAP MARKED "HOSTETTER LS 1975" FROM WHICH:  
 20" FIR, SCRIBED "S14 1/16 BT", BEARS: S45°19'E, 3.5 FEET TO SPIKE.  
 20" FIR, SCRIBED "S14 1/16 BT", BEARS: S87°22'E, 35.4 FEET TO SPIKE

N 07°43'30" W

1308.80'

1311.83'

1314.84'

1314.84'

1314.84'

1314.84'

1314.84'

1314.84'

1314.84'

1314.84'

1314.84'

1314.84'

1314.84'

1314.84'

1314.84'

1314.84'

1314.84'

1314.84'

1314.84'

1314.84'

1314.84'

1314.84'

1314.84'

1314.84'

1314.84'

1314.84'

1314.84'

1314.84'

1314.84'

1314.84'

1314.84'

1314.84'

1314.84'

1314.84'

1314.84'

1314.84'

1314.84'

1314.84'

1314.84'

1314.84'

1314.84'

1314.84'

1314.84'

1314.84'

1314.84'

1314.84'

1314.84'

1314.84'

1314.84'

1314.84'

1314.84'

1314.84'

1314.84'

1314.84'

1314.84'

1314.84'

1314.84'

1314.84'

1314.84'

1314.84'

1314.84'

1314.84'

1314.84'

1314.84'

1314.84'

1314.84'

1314.84'

1314.84'

1314.84'

1314.84'

1314.84'

1314.84'

1314.84'

1314.84'

1314.84'

1314.84'

1314.84'

1314.84'

1314.84'

1314.84'

1314.84'

1314.84'

1314.84'

1314.84'

1314.84'

1314.84'

1314.84'

1314.84'

1314.84'

1314.84'

1314.84'

1314.84'

1314.84'

1314.84'

1314.84'

1314.84'

1314.84'

1314.84'

1314.84'

1314.84'

1314.84'

1314.84'

1314.84'

1314.84'

1314.84'

1314.84'

1314.84'

1314.84'

1314.84'

1314.84'

1314.84'

1314.84'

1314.84'

1314.84'

1314.84'

1314.84'

1314.84'

1314.84'

1314.84'

1314.84'

1314.84'

1314.84'

1314.84'

1314.84'

1314.84'

1314.84'

1314.84'

1314.84'

1314.84'

1314.84'

1314.84'

1314.84'

1314.84'

1314.84'

1314.84'

1314.84'

1314.84'

1314.84'

1314.84'

1314.84'

1314.84'

1314.84'

1314.84'

1314.84'

1314.84'

1314.84'

1314.84'

1314.84'

1314.84'

1314.84'

1314.84'

1314.84'

1314.84'

1314.84'

1314.84'

1314.84'

1314.84'

1314.84'

1314.84'

1314.84'

E 1/16 S 89°51'51" E

1326.05'

1326.05'

1326.05'

1326.05'

1326.05'

1326.05'

1326.05'

1326.05'

1326.05'

1326.05'

1326.05'

1326.05'

1326.05'

1326.05'

1326.05'

1326.05'

1326.05'

1326.05'

1326.05'

1326.05'

1326.05'

1326.05'

1326.05'

1326.05'

1326.05'

1326.05'

1326.05'

1326.05'

1326.05'

1326.05'

1326.05'

1326.05'

1326.05'

1326.05'

1326.05'

1326.05'

1326.05'

1326.05'

1326.05'

1326.05'

1326.05'

1326.05'

1326.05'

1326.05'

1326.05'

1326.05'

1326.05'

1326.05'

1326.05'

1326.05'

1326.05'

1326.05'

1326.05'

1326.05'

1326.05'

1326.05'

1326.05'

1326.05'

1326.05'

1326.05'

1326.05'

1326.05'

1326.05'

1326.05'

1326.05'

1326.05'

1326.05'

1326.05'

1326.05'

1326.05'

1326.05'

1326.05'

1326.05'

1326.05'

1326.05'

1326.05'

1326.05'

1326.05'

1326.05'

1326.05'

1326.05'

1326.05'

1326.05'

1326.05'

1326.05'

1326.05'

1326.05'

1326.05'

1326.05'