

TOWNSHIP 315 RANGE 9W SEC. 12 4B PLSS # 240540

Date: 2/5/2025 By: ke
This survey consists of:

DOUGLAS COUNTY OREGON

DATE 1-29-25

Map: _____
Narrative: _____
Corner Rpt: CS 67159-55

Corner Designation

$\frac{1}{4}$ $\frac{S12}{13}$

DOUGLAS COUNTY
SURVEYOR

Monument(s) Found: (Condition and Source)

DCSO BRASS CAP
Proj 8"

- Condition report
- Not Found
- Renewed
- Unrecorded
- Surveyed In

Previous Renewals

DCSO 1967 CS 54/32
DE Groot 2001 M139-13
Woodruff 2010 M161-7

MONUMENT DETAIL

COUNTY
SURVEYORS
OFFICE
T 315 R 9W
 $\frac{1}{4}$ $\frac{S12}{S13}$
1967

Accessories Found

21" W. Fir N54°E 52.4 FT Fully Healed
Double BLAZE

23" D. Fir S18°E 19.7 FT Fully Healed
Double BLAZE

60" x 7 ft. D. Fir stump N75°E 10.6 ft

New Accessories

5 FT Metal Post 2 FT WEST
OF MONUMENT

Sketch of Monument, Accessories, and General Area

Location & Comments

MON ON FLAT
GROUND IN LEFT
BANK OF WESTERLY
FLOWING STREAM

Comp. Decline. $19\frac{1}{2}^{\circ} E$
 Agency DCSO
 Party Chief S. FRAUSE
 Note keeper
 Witnesses J. LORSUNG

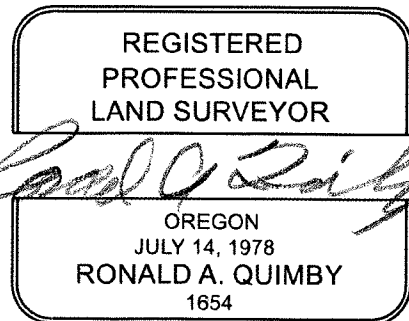

CS 67/59-55 pg 2/3

EXPIRES: 12/31/2026

TOWNSHIP 31 RANGE 09 POINT IDENTIFIER # 640500

PRIMARY CORNER DESCRIPTION 1/4 Cor. Secs. 12 & 13

Alias _____	Description _____
Alias _____	Description _____
Alias _____	Description _____
Alias _____	Description _____

MINI GIS
42.88238
123.71178

GLO survey by W.H. Byars under contract #727, dated December 20, 1900 - (DCSO records Vol. 19 Page(s) 8187)

Set a yew post, 4 ft. long, 4" sq., 24" in the ground, marked S12 1/4 S on N & S13 on S faces for 1/4 sec. cor. from which
A fir, 60" dia., bears N.75°E., 16 lks., mkd: S12 1/4 S BT.
A W.Fir, 24" dia., bears S.45°W., 10 lks., mkd: S 13 1/4 S BT

CONDITION REPORT 1/29/25

Douglas Co. Surveyors Office - John M. Powell - Frank Jones & Joe Brady - March 1967 - C.S. File 54/32

Found - ^{x 7 FT} 60" D.Fir, now stump ✓ N.75°E., 10.6 ft., shows good scars.

~~GONE NO EVID.~~ 24" W.Fir, now dead, S.45°W., 6.6 ft. scribe visible "1/4".

Set - Brass Cap at 1/4 Cor. Mkd: County Surveyors T31S R9W
Office 1/4 S 12
1967 S 13

PROT. 8"

New BTs ^{21"} W.Fir ✓ N.54°E., 52.4 ft mkd. 1/4 S12 CS BT. FHDB
^{23" 7"} D.Fir ✓ S.18°E., 19.7 ft. mkd. 1/4 S13 CS BT. "

Fd. Ok K. DeGroot, 6/2001, M137-13
FD. Ok C. Woodruff, 7/2010 - M161-7

ADD 5 FT METAL LATH SET 2 FT. WEST FROM B.C. MONUMENT

CAP ON FLAT GROUND
IN LEFT BANK FLOOD CUT OF WESTERLY RUNNING STREAM.