

GOVERNMENT CORNER RESTORATION FORM

FILED

TOWNSHIP 28S RANGE 6W SEC. 29 PLSS # 240200

Date: 1-23-2005 By: JC
This survey consists of:

DOUGLAS COUNTY OREGON

DATE 1-13-25

Map: _____
Narrative: _____
Corner Rpt: CS67/59-44

Corner Designation

1/4 COR 529
532

DOUGLAS COUNTY
SURVEYOR

Monument(s) Found: (Condition and Source)

5/8" X 1" TRIANGULAR SHAPE
I BAR 10" BELOW ROAD
SHOULDER

- Condition report
- Not Found
- Renewed
- Unrecorded
- Surveyed In

Previous Renewals

FREAR 1932 old corner
Book pg 110
FREAR 1948 CS 46/151
DCSO 1961 CS 49/139-18
DeGroot M 104-23
DCSO 1990 CS 64/5-7
See other side

MONUMENT DETAIL

Accessories Found

2" OD Iron pipe N89 3/4 E 236.24 FT
GOOD MAG READING
5/8" I. Rod S75° E 70.9 Under gravel in
Deep pit like Good MAGNETIC READING Could
Not Check directly

PREVIOUS

RENEWAL

Monument Set (Procedure and Description)

MONUMENT DETAIL

DeGroot 1995 PP 1995-0088

Smalley 1996 M 124-32

Sweeden 2013 M 164-58

THATCHER 2015

New Accessories

Triple Trunk E. Cedar 10" x 13" x 11"
S 12 1/2° W 94.4 FT DIAM MEASURED CLOCKWISE
FROM EAST ADD 3 1/2" NAIL RIGHT SIDE
CENTER

2" I. D. GALVANIZED CHAIN LINK FENCE
ANGLE POST SET IN CONCRETE N 5 1/2° E
8.7 FT

Sketch of Monument, Accessories, and General Area

Location & Comments

OCRS COORDINATE SYSTEM
COTTAGE GROVE - CANYONVILLE
ZONE

N 96535.125

E 137064.091

Comp. Decline. 14 1/2° E
Agency DCSO
Party Chief S. KRAUSE
Note keeper
Witnesses J. LORSONG

CS 67/59-44

2/4

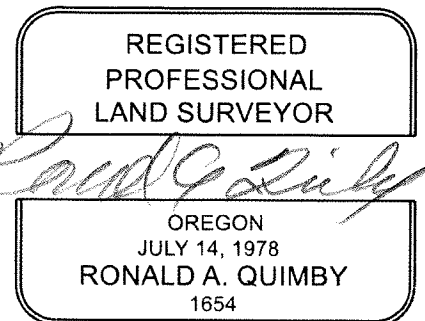

EXPIRES: 12/31/2026

TOWNSHIP 28 RANGE 06 POINT IDENTIFIER # 240200

PRIMARY CORNER DESCRIPTION 1/4 Cor. for 29 and 32

Alias _____	Description _____
Alias _____	Description <u>DCRS CANYONVILLE COTTAGE GROVE COORDS</u>
Alias _____	Description _____
Alias _____	Description <u>96535.125 N</u> <u>137064.091 E</u>

Original - Elder and Gile, under Contract #31 dated April 7, 1853 (DCSO records, Vol. 14 Page 5733)

Set 1/4 sec. post, from which
 A Maple 12" dia., bears S.19°W., 69 lks.
 An Ash 12" dia., bears N.70°W., 154 lks.

F.C. Frear - Co. Roadmaster - Wit: N.E. Richardson; P.D. Wolford - July 16, 1932- "Old" corner book, Pg 110 (No other record source found)

Large Iron bar in ground from which old Maple nearly gone bears S.19°W., 69 lks. I also set a 5/8" x 24" I.Bar at fence corner, S.61 1/4°E., 49 ft.
 A 5/8" x 24" I.Bar S.6 1/4°E., 42.0 ft.

F.C. Frear - Durwood Owens - March 31, 1948 - C.S. File 46/151

Both iron reference pins previously set have been destroyed and covered up. Old original BT, Maple which bears S.19°W., 9 lks. is still up and remarked.
 I set a 3" x 3" x 4 ft. angle iron, North 45 ft. from 1/4 cor.

Doug. County Surveyors Office - James Byron, Deputy - Dale McFarland; John Powell - Dec. 1961 - C.S. File 49/139-18

Found - 5/8" Iron at corner, 6" under ground & 3 x 3" angle iron in N-S fence & 45 dr. North of corner as recorded by Frear 1948.
 Set 3/4" Iron rod flush and alongside 5/8" Iron at corner.
 No trees near 1/4 cor. for BTs.

Found 3/4" I.R. at corner OK, K. Degroot, M 104-23
DECLINATION 14 1/2° E *RENEWED 1/13/25*

Doug. County Surveyors Office - Randall Smith; Stephen Flause Jan. 24, 1990 - C.S. File 64/5-7

Found - 5/8" x 1" triangular shaped I.bar is found ^{10"}6" below shoulder of road. Dug 6" down below top of iron bar, no other monuments found.
 No original BTs found.
NOT SEEN 3"x3" angle iron found 8" below ground bears North, 45.0 ft. (agrees w/record) *BURIED UNDER 3 FT. OF FILL*
 2" $\sqrt{0D}$ I.Pipe which protrudes 3" above ground bears N.84 3/4°E., 236.24 ft (Rec. N.85 3/4°E., 236.24 ft per M 104-23) (Source if from M 35-66) cont.

CS 67/59-44
3/4

TOWNSHIP 28 RANGE 06 POINT IDENTIFIER # 240200

PRIMARY CORNER DESCRIPTION 1/4 Cor. Secs. 29 & 32

Alias _____	Description _____
Alias _____	Description _____
Alias _____	Description _____
Alias _____	Description _____

New Accessories:

UNDER GRAVEL IN DEEP PUDDLE 5/8" Iron rod with plastic cap "Baughman Tech Serv" found set flush in graveled access to shop area, bears S.75°E, 70.9 ft. (Set in M 104-23; rec. S.73 3/4°E., 71.13 ft.)

GONE POSSIBLE ROOTHOLE 8" dia. Poplar double blazed & scribed "1/4 S32 CS BT" bears S.2°E., 85.1 ft. (dist. to center of a base of most northerly tree in a 5 tree cluster.)

GONE NO EVID. 22" dia. Poplar double blazed & scribed "1/4 S32 CS BT" bears S.89 3/4°W., 96.7 ft.

Corner is approx. 2 1/2 ft. North of north edge of asphalt road, along West edge of entrance road to Quality Machine and Welding.

*MAGNETIC SIGNAL
COULD NOT CHECK DIRECTLY*

Fd. Ok - Jan 1995 - K. DeGroot - 1995-0088
 Fd. OK - Nov. 1996 by Mark Smalley - M 124-32

FD. I.Bar, 5/8" IR & 1 BT (SE) SW BT gone by C.Sweedon, 1/2013 - M164-58

Fd. triangular bar 1"x1"x1" down 10" 1/2015 - J. Thatcher

NEW REFS

3 1/2" MAG NAIL SET R.S.G.

DISTINCTLY TRIPLE TRUNK I.CEDAR 10"x13"x11" DIAM. MEAS. CLKWSE FROM EAST S12 1/2°W, 94 1/4 FT

2" I.D. GALVANIZED CHAINLINK FENCE ANGLE POST SET IN CONCRETE N 5 1/2°E, 8 1/2 FT.

CS 67/59-44
4/4