

GOVERNMENT CORNER RESTORATION FORM

FILED

TOWNSHIP 26S RANGE 2W SEC. 16

PLSS # 300450

Date: 10/2/2024 By: JC

This survey consists of:

Map: _____

DOUGLAS COUNTY OREGON

DATE 9-11-24

Narrative: _____

Corner Rpt: CS 67/59-2

Corner Designation

SN 1/4 17/16

DOUGLAS COUNTY
SURVEYOR

Monument(s) Found: (Condition and Source)

2" Alum CAP ON 5/8"
IRON ROD FLUSH WITH
GROUND

___ Condition report

___ Not Found

Renewed

___ Unrecorded

___ Surveyed In

Previous Renewals

Set by EDWARDS
JAN. 2000 M134-15

MONUMENT DETAIL

SN 1/4
S17/S14
L52339
2000

Accessories Found

(REC 513E)

SAWN - BURNED 9" X 1 FT FIR STUMP S15°E
28.23 FT GOOD SCAR ADD 3 1/2" MAG
NAIL TOP CENTER

SAWN BURNED 9" X 4" FIR STUMP
N86°E W 46.23 FT (REC N88°W) 131A2C
GONE ADD 3 1/2" MAG NAIL TOP CENTER

RENEWAL

Monument Set (Procedure and Description)

MONUMENT DETAIL

New Accessories

5/8" x 30" Iron Rod with DCSO plastic
CAP N 34°W 40.5 FT Proj 4"

Sketch of Monument, Accessories, and General Area

Location & Comments

OCRS COORDINATE SYSTEM
Cottage Grove - Canyonville
zone

MON ON FLAT
GROUND APPROX
25' EAST OF
GRAVEL ROAD

AREA BURNT
9/2020

N. 173196.321
E 265585.065

Comp. Decline. 14' 4" E
Agency DCSO
Party Chief S. FLAUSE
Note keeper
Witnesses Jo LORSBURY

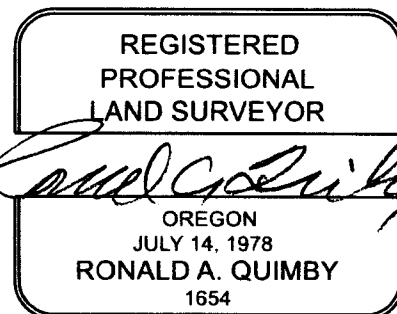

EXPIRES: 12/31/2024

CS 67/59-2
2/3

T269, R02W, 300450

NORTH 1/16 CORNER
3" DIAM. FIR S.49°W., 23.10'
10" DIAM. FIR N.18°W., 4.95'

RENEWED 9/11/24

DECLINATION 14 1/4° E

2" DIA. ALUM. CAP MARKED LS 2339 SN 1/64° ON 5/8" I.R. WITH GROUND

BURNED SAWN 9" X 1 FT. STUMP - 15° BLZ. SCAR

SET SN 1/64 CORNER
6" DIAM. FIR BRS. S.15°E., 128.23'
SCRIBED "SN 1/64 S16 BT"

BURNED SAWN 9" X 4 INCH STUMP - A 6" DIAM. FIR BRS. N.86 1/2° W

ADD 3 1/2" MAG NAIL TOP CNTR TO FND. BT'S

NEW REF. 5/8" X 30" PLSTC. CAP

1/4 CORNER

30" DIAM. FIR S.38°W., 34.98'

37" DIAM. CEDAR N.18°W., 31.68'

MONUMENT IS
ON FLAT GROUND
~ 25 FT EAST OF GRAVEL RD.

OCCAS TANYONVILLE COTTAGE GROVE COORD.S
173196.321 N
265585.065 E

① SET CWNW 1/64 CORNER.
CAP IS MKD. "CWNW 1/64-S16-LS 2339-2000"
A 5" DIAM. CEDAR BRS. N.11°E., 13.22'
A 12" DIAM. FIR BRS. N.78°E., 38.40'
BOTH SCRIBED "1/64 S16 BT"

② SET PROP. COR. ON 1/64 LINE 100' PERP.
SE'LY FROM CREEK
A 8" DIAM. FIR BRS. S.5°W., 3.90'
A 12" DIAM. FIR BRS. S.81°W., 23.60'
BOTH SCRIBED "PC-BT"
CAP IS MKD. "PROP. COR.-LS 2339-2000"
CORNER IS S.2°02'02"W.
FROM CWNW 1/64 CORN

③ SET SWNW 1/64 CORNER.
CAP IS MKD. "SWNW 1/64-S16-LS2339-2000"
A 7" DIAM. FIR BRS. S.4°E., 4.55'
A 19" CEDAR BRS. N.72°W., 16.54'
BOTH SCRIBED "1/64 S16 BT"

MAP FILE M134-15

Edwards
2000 17/14
EX 1/64

CS 67/59-2
3/3

SOUTH 1/4
FD 1918 G.L
1918 B.T.S.L
A 7" DIAM.
AN 8" DIAM.
BOTH TREES

