

GOVERNMENT CORNER RESTORATION FORM

FILED

TOWNSHIP 245 RANGE 3W SEC. 28

PLSS # 300246

Date: 9/23/2024 By: X
This survey consists of:

Map: _____

DOUGLAS COUNTY OREGON

DATE 8/22/24

Narrative: _____

Corner Rpt: 6567/58-54

Corner Designation

1/4 COR 29/28

DOUGLAS COUNTY
SURVEYOR

Monument(s) Found: (Condition and Source)

2 1/2" BRASS CAP ON 1 1/4"
IRON PIPE UP 6"

___ Condition report

___ Not Found

Renewed

___ Unrecorded

___ Surveyed In

Previous Renewals

DCSO 1968 NOT FOUND
BAKER 1994 M 121-5817&B
EDWARDS 2004 M 147-4

MONUMENT DETAIL

T 245 R 3W

1/4

S29/S28

PLS 1978

1994

Accessories Found

Singed - Rotted 15" X 2 FT FIR STUMP N86°W
11.5 FT (REC N80°W 11.3 FT) Fully Healed
DOUBLE BLAZE
Rotted Very BURNED 12" X 5 FT FIR STUMP
N24°E 18.7 FT (REC N30°E) BLAZE GONE
BURNED Rotted 14" X 6 FT FIR STUMP S88°E
11.0 FT (REC S82°E) Fully Healed Double BLAZE
BURNED Rotted 12" X 6 FT FIR STUMP
S26°W 13.5 FT (REC S32°W) Fully Healed
DOUBLE BLAZE
6' CARSONITE Post 1' North
ALL DISTANCES TO N NAIL IN TREE
FACE S
6' STEEL Post 2' south AND west.

C.S. File 67/58-54

Monument Set (Procedure and Description)

MONUMENT DETAIL

New Accessories

Sketch of Monument, Accessories, and General Area

Location & Comments

MON on steep NNW slope in
Partly Burned Reprod Ridge Top
Approx 70 FT South

GRAVEL ROAD APPROX
140 FT NORTH

AREA BURNED
9/2020

OCRS COORDINATE SYSTEM
COTTAGE GROVE CANYONVILLE
ZONE

Comp. Decline. 14 1/4° E
Agency DCSD
Party Chief S. F. AUSE
Note keeper
Witnesses J. LORSUNG

N 225979.417
E 233769.994

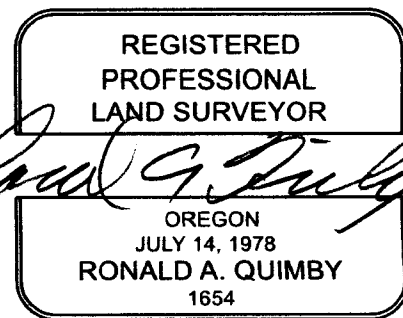

EXPIRES: 12/31/2024

CS 67/58-56
213

TOWNSHIP 24 RANGE 03 POINT IDENTIFIER # 300240 8/22/24

PRIMARY CORNER DESCRIPTION 1/4 Cor. Secs. 28 & 29

Alias _____	Description _____
Alias _____	Description <u>OGRS CANYONVILLE COTTAGE GROVE COORDS</u>
Alias _____	Description _____
Alias _____	Description <u>225979.417 N</u>
	<u>233709.994 E</u>

GLO survey by W.H. Byars under contract #152, dated June 3, 1871 - (DCSO records Vol. 7 Page(s) 2956)

Set 1/4 sec. post from which
 A cedar, 10" dia., bears N.80°E., 5 lks.
 A fir, 14" dia., bears N.35°W., 31 lks.

Douglas Co. Surveyors Office - Vernon "Ray" Tracy - - April/May 1968 - C.S. File 54/27-153

Reported as not found. DECLINATION 14 1/4° E
 Logged many years ago.

Daniel Baker - Weyerhaeuser Co. - 12/15/94 - M 121 - 58 A&B

ALL BT'S BROKEN OFF STUMPS 2 1/2 BE/IP PROT, 6" MARKED AS BELOW *ALL DISTANCES TO "W" NAILS*
 Set - 1 1/4" x 36" iron pipe with 2 1/2" Brass cap dated 1994 *IN TREE FACE*
~~12" fir, N.80°W. 11.3', scribed "1/4 S29 BT" N86°W 11.5' FHDB~~
~~12" x 5 ft. 15" fir, N.20°E. 18.7', scribed "1/4 S28 BT" BLAZE GOREN 24°E, 18Z~~
~~14" x 6 ft. 14" fir, S.82°E. 11', scribed "1/4 S28 BT" FHDB S88°E, 11Z~~
~~12" x 6 ft. 10" fir, S.32°W. 13.5', scribed "1/4 S29 BT" FHDB S26°W, 13.5~~
 6" Carsonite post 1' north.

David Edwards - For: Roseburg Resources Co. - 12/2004 - M 147-4

Found - Brass cap
 All BTs are stumps
 6' carsonite post 1' north ✓
 Set - 6' steel posts 2' South and West ✓

CAP IS MARKED

" T24S R3W "

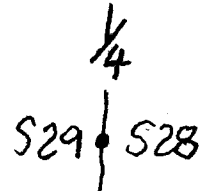

PLS 1978
1994

CS 67/58-56
3/3

MONUMENT ON STEEP NNW SLOPE IN PARTIALLY BURNED FIR REPROD.
RIDGE TOP IS APPROX 70 FT. SOUTH, GRAVEL RD. APPROX 140 FT. NORTH

MINI GIS
43.45305
123.07115