

GOVERNMENT CORNER RESTORATION FORM

FILED

TOWNSHIP 26S RANGE 2W SEC. 8 PLSS # 260540

Date: 8/30/2023 By: X

This survey consists of:

DOUGLAS COUNTY OREGON

DATE 8-17-23

Map: _____

Narrative: _____

Corner Rpt: CS 67/5656

Corner Designation

CE 1/4 S 8

DOUGLAS COUNTY
SURVEYOR

Monument(s) Found: (Condition and Source)

5/8" I. Rod 8" below
ROAD SURFACE

___ Condition report

___ Not Found

Renewed

___ Unrecorded

___ Surveyed In

Previous Renewals

RAMSEY 1960 CS 51/86
Hoffine 2016 M 172-7

MONUMENT DETAIL

Accessories Found

BURNED - DEAD 14" D. FIR N 8 1/4° E 9.3 FT
PARTLY HEATED SINGLE BLAZE PARTIAL
SCRIBE VISIBLE ADD 3 1/2" MAG NAIL
RIGHT SIDE CENTER

METAL U POST N 5° W 5.0 FT

RENEWAL

Monument Set (Procedure and Description)

MONUMENT DETAIL

New Accessories

5/8" X 30" I. ROD with DCSD yellow
PLASTIC CAP N75°W 17.8 FT UP 6"

Sketch of Monument, Accessories, and General Area

Location & Comments

OCRS Coordinate System
Cottage Grove - Canyonville
zone

N 177869.752
E 264388.945

MOD. ON GRADED
FLAT RIDGE AT
3 WAY ROAD
INTERSECTION

AREA BURNT
9-2020

Comp. Decline. 14 1/2° E
Agency DCSD
Party Chief S. F. HAUSE
Note keeper
Witnesses J. LORSUNG

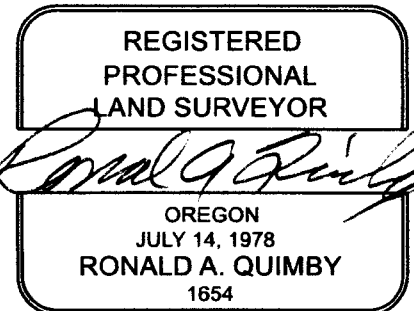

EXPIRES: 12/31/2024

CS 67/56-56 2/3

CORNER INFORMATION:

- 1) THE QUARTER CORNER BETWEEN SECTIONS 8 AND 9 GCDB 300540
 FOUND 1959 BLM BRASS CAP 0.8 FEET ABOVE GROUND
 - 12" DOUGLAS FIR BEARS N77°E 17.9 FEET (RECORD N75°E 19.14 FEET) HEALED FACE AND BLM TAG
 - 36" DOUGLAS FIR BEARS N68 1/4°W 29.9 FEET (RECORD N70°W 29.37 FEET) HEALED FACE AND BLM TAG
 CORNER LIES ON NORTH FACING SLOPE IN MOUND OF STONES
- 2) THE SOUTH 1/16TH CORNER BETWEEN SECTIONS 8 AND 9 GCDB 300520
 FOUND 1959 BLM BRASS CAP 0.2 FEET ABOVE GROUND
 - 25" DOUGLAS FIR BEARS S60 1/2°E 21.4 FEET (RECORD S61 1/2°E 21.78 FEET) HEALED FACE AND TAG
 - 12" FIR SNAG BEARS S62 1/2°W 5.6 FEET (RECORD S58 1/2°W 5.61 FEET) HEALED FACE AND BLM TAG
 - 8" DOUGLAS FIR BEARS S71 1/2°W 25.2 FEET WE SCRIBE S 1/16 S8 BT AND TAG TREE
 CORNER LIES ON SOUTHEAST SLOPE WITH LARGE BLM TIMBER TO EAST.
- 3) THE SOUTHEAST SECTION CORNER FOR SECTION 8 GCDB 300500
 FOUND 1918 USGLO BRASS CAP 1.0 FEET ABOVE GROUND
 - 67" DOUGLAS FIR BEARS N41°E 19.4 FEET (RECORD N40°E 18.48 FEET) HEALED FACE AND BLM TAG
 - 38" DOUGLAS FIR BEARS S20 1/4°E 7.7 FEET (RECORD S20°E 6.6 FEET) HEALED FACE AND BLM TAG
 - 53" DOUGLAS FIR BEARS S54°W 25.4 FEET (RECORD S55°W 25.74 FEET) HEALED FACE AND BLM TAG
 - 14" CHINQUAPIN BEARS N74 1/4°W 10.55 FEET (RECORD N75 1/4°W 10.56 FEET) HEALED FACE AND BLM TAG
 CORNER LIES ON EAST FACING SLOPE IN HEAVY HUCKLEBERRY BRUSH
- 4) THE EAST 1/16 TH CORNER BETWEEN SECTIONS 8 AND 17 GCDB 260500
 FOUND 1959 BLM BRASS CAP 0.3 FEET ABOVE GROUND
 - 40" DOUGLAS FIR BEARS S52°E 86.4 FEET (RECORD S51 1/4°E 87.12 FEET) HEALED FACE AND BLM TAG
 - ROTTEN FIR STUMP BEARS N84°E 49.7 FEET (RECORD N84 1/2°E 50.16 FEET) NO VISIBLE MARKS
 - 13" DOUGLAS FIR BEARS N72 1/2°E 16.3 FEET WE SCRIBE E1/16 S8 BT AND TAG TREE
 CORNER LIES ON SOUTHWEST SLOPE APPROX. 75 FEET WEST OF ROAD
- 5) THE QUARTER CORNER BETWEEN SECTIONS 8 AND 17 GCDB 240500
 FOUND 1959 BLM BRASS CAP 0.4 FEET ABOVE GROUND
 - 20" DOUGLAS FIR BEARS S41 1/4°E 22.11 FEET (RECORD S41°E 22.44 FEET) HEALED FACE AND BLM TAG
 - 28" DOUGLAS FIR BEARS N57°W 10.3 FEET (RECORD N53 1/2°W 11.22 FEET) HEALED FACE AND BLM TAG
 CORNER LIES ON STEEP SOUTH FACING SLOPE APPROX. 100 FEET SOUTH OF OLD ROADWAY
- 6) THE CENTER SOUTH 1/16 TH CORNER FOR SECTION 8 GCDB 240520
 FOUND 1" IRON PIPE 0.2 FEET ABOVE GROUND PER SURVEY CS 51/86
 - ROTTEN FIR STUMP BEARS N10 1/4°W 19.6 FEET (RECORD N10°W 19.8 FEET) VISIBLE SCRIBING
 - ROTTEN FIR STUMP BEARS S79 1/4°W 5.9 FEET (RECORD S70°W 5.28 FEET) VISIBLE SCRIBING
 - 9" DOUGLAS FIR BEARS N23 3/4°W 11.8 FEET WE SCRIBE CS 1/16 S8 BT AND TAGGED TREE
 - 15" DOUGLAS FIR BEARS N49°E 23.5 FEET WE SCRIBE CS 1/16 S8 BT AND TAGGED TREE
 CORNER LIES ON STEEP WEST FACING SLOPE
- 7) THE SOUTHEAST 1/16 TH CORNER FOR SECTION 8 GCDB 260520
 FOUND 1" IRON PIPE 0.6 FEET ABOVE GROUND PER SURVEY CS 51/86
 - 26" DOUGLAS FIR BEARS N5 1/4°W 27.5 FEET (RECORD N5°W 27.06 FEET) HEALED FACE AND TAG
 - 8" DOUGLAS FIR BEARS N52 1/2°W 15.5 FEET WE SCRIBE SE1/16 S8 BT AND TAG TREE
 CORNER LIES ON WEST SIDE OF MAIN RIDGE.
- 8) THE CENTER WEST EAST SOUTHEAST 1/256 CORNER FOR SECTION 8
 SET 5/8" X 40" IRON ROD WITH 2 1/2" ALUMINUM CAP MARKED LONE ROCK TIMBER S8 CW E SE 1/256 2016 PLS 2291
 - 18" DOUGLAS FIR BEARS S23°W 16.2 FEET WE SCRIBE BT AND TAG TREE
 - 17" DOUGLAS FIR BEARS N57 1/2°E 33.7 FEET WE SCRIBE BT AND TAG TREE
 CORNER LIES ON SOUTHEAST SLOPE APPROX. 80 FEET S45°E FROM PROPOSED 2016 NEW ROAD CONSTRUCTION.
 WE PUT METAL U - POST 0.5 FEET NORTH OF CORNER.
- 9) THE CENTER WEST EAST EAST 1/256 CORNER FOR SECTION 8
 SET 5/8" X 40" IRON ROD WITH 2 1/2" ALUMINUM CAP MARKED LONE ROCK TIMBER S8 CW E E 1/256 2016 PLS 2291
 - 13" DOUGLAS FIR BEARS N81 1/4°E 8.4 FEET WE SCRIBE BT AND TAG TREE
 - 15" DOUGLAS FIR BEARS S1 1/4°E 28.3 FEET WE SCRIBE BT AND TAG TREE
 CORNER IS 0.2 FEET ABOVE GROUND ON SOUTH FACING SLOPE. WE PUT METAL U - POST APPROX. 0.5 FEET
 NORTH OF CORNER.
- 10) THE CENTER EAST 1/16 TH CORNER FOR SECTION 8 GCDB 260540
 SET 5/8" X 40" IRON ROD WITH 2 1/2" ALUMINUM CAP MARKED LONE ROCK TIMBER SE 1/16 S8 2016 PLS 2291
 - 14" DOUGLAS FIR BEARS N8 1/2°E 9.7 FEET WE SCRIBE CE1/16 S8 BT AND TAG TREE
 - 12" DOUGLAS FIR BEARS S11 1/2°W 39.0 FEET WE SCRIBE CE 1/16 S8 BT AND TAG TREE
 FOUND RAMSEY BEARING TREE STUMPS WITH IRON PIPE PUSHED OUT OF POSITION. WE RESET CORNER AT
 PROPORTIONATE DISTANCE. CORNER LIES AT NORTH EDGE OF THREE WAY ROAD JUNCTION. WE SET
 CORNER 0.1 FEET BELOW THE ROAD SURFACE AND PUT A METAL U - POST APPROX. 5.0 FEET NORTH OF CORNER.
- 11) THE CENTER QUARTER CORNER FOR SECTION 8 GCDB 240540
 FOUND 1 1/2" IRON PIPE PER SURVEY CS 51/86
 - 62" FIR STUMP BEARS N89 1/2°E 19.3 FEET (RECORD S88 °E 17.6 FEET) WEYCO TAG
 - 30" FIR STUMP BEARS N61 1/2°E 24.1 FEET WEYCO TAG AND MAG NAIL TAG READS
 S60 1/2°W 26.3 FEET NO RECORD
 - 12" DOUGLAS FIR BEARS N28 3/4°E 27.7 FEET WE SCRIBE C1/4 S8 BT AND TAG TREE
 - 6" DOUGLAS FIR BEARS N80°W 13.7 FEET WE SCRIBE C1/4 S8 BT AND TAG TREE
 - 13" DOUGLAS FIR BEARS N89 1/2°E 19.3 FEET WE SCRIBE C1/4 S8 BT AND TAG TREE
 - 11" DOUGLAS FIR BEARS S31 1/4°W 34.4 FEET WE SCRIBE C1/4 S8 BT AND TAG TREE
 CORNER LIES APPROX. 65 FEET WEST OF UNMAINTAINED ROCK ROAD

T265-R2W-260540

OCR9 CANYONVILLE COTTAGE GROVE COORD.S

177869.752 N
264388.945 E

RENEWED 8/17/23

DECLINATION 14 1/2°E

ALUM. CAP GONE, IR. 8" BELOW RD. SURFACE
PHYS PARTIAL SCRIBB. VISIBLE

MONUMENT ON GRADED FLAT RIDGE TOP AT 3WAY RD. INTERSECTION

BURNED DEAD 14" DESTROYED DUE TO ROAD WORK.

NEW REF. 5/8" X 30" IR/YELLOW PLASTIC CAP PROT. 6" BEARS N75°W, 17 1/2 FT

FOUND A GALVANIZED STEEL LATH BEARS N05°W, 5 1/2 FT.

| LEGEND | |
|--------|--|
| ● | FOUND 1959 BLM BCIP'S & 1918 US GLO BCIP |
| ○ | FOUND IRON PIPES SET BY RAMSEY IN CS 51/86 |
| ● | SET 5/8" X 40" IRON ROD WITH 2 1/2" ALUMINUM CAP |
| [] | RECORD FROM 1960 BLM PLAT 245 |

REGISTERED PROFESSIONAL LAND SURVEYOR

Ken W. Hoffman

