

GOVERNMENT CORNER RESTORATION FORM

TOWNSHIP 245 RANGE 1W SEC. 27 PLSS # 400200

FILED
Date: 8/30/2023 By: SC
This survey consists of:

DOUGLAS COUNTY OREGON

DATE 7-31-23

Map: _____
Narrative: _____
Corner Rpt: CS 67/56-53

Corner Designation

Sec COR 28/27
33/34

DOUGLAS COUNTY
SURVEYOR

Monument(s) Found: (Condition and Source)

DCSO BRASS CAP 2 1/2"
UP 11" IN MOUND OF
STONE

- Condition report
- Not Found
- Renewed
- Unrecorded
- Surveyed In

Previous Renewals

DCSO 1961 CS 52/42-7
DCSO 1970 CS 54/27-197
DCSO 1996 CS 65/9-23

MONUMENT DETAIL

County Surveyors
OFFICE
T245 R1W
528/527
533/534
1961

Accessories Found

22" X 70' pine snag S42°W 17.8 FT with
unhealed Double BLAZE
13" X 2' Broken Rotted Fir Stump N147°E
26.1 FT BLAZE GONE
15" D. FIR N84°W 21.7 FT Fully healed
Double BLAZE
10" Hemlock S33°W 6.4 FT Fully healed
Double BLAZE
11" D. FIR N16°E 19.6 FT Fully Healed
Double BLAZE
Down 9" Hemlock S73°E 14.3 FT Fully
Healed HIGH-LOW BLAZE BRNG & DIST
OK TO Root Hole

Blank lines for monument set procedure and description.

New Accessories

9" Hemlock 545°E 15.7 FT Scrip ed
"T245 RIW 534" 'CSBT' on Double
BLAZE 4" steel NAIL RIGHT Side
Center

Sketch of Monument, Accessories, and General Area

Location & Comments

CORNER ON FLAT GROUND
IN older Reprod Forest

AREA BURN T
9-2020

OCRS Coordinate System
Cottage Grove - Canyonville
Zone

Comp. Decline. 14 1/2° E
Agency DCSO
Party Chief S. F. Haase
Note keeper
Witnesses J. Korsunov

N 225950.569
E 305529.089

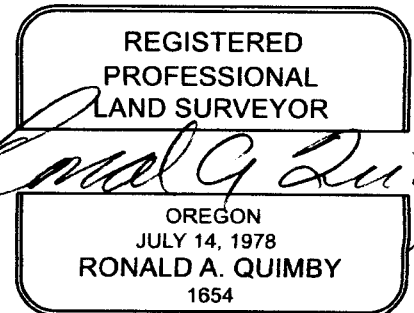

EXPIRES: 12/31/2024

TOWNSHIP 24 RANGE 01 POINT IDENTIFIER # 400200

PRIMARY CORNER DESCRIPTION Cor. Secs. 27, 28, 33, & 34

Alias _____	Description _____
Alias _____	Description _____
Alias _____	Description _____
Alias _____	Description _____

GLO survey by Carl S. Nicklin, Dep. Surveyor under contract # 664, dated May 23, 1896 - (DCSO recs Vol. 7 Page(s) 2812)

Set a pine post, 4 ft. long, 4" sq. 24" in the ground, for cor. to secs. 27, 34, 33, & 28, marked T24S S27 on NE, R1W S34 on SE, S33 on SW, S28 on NW faces, with 3 notches on E & 1 notch on S edges; from which

A fir, 8" dia. bears N.66°E., 34 lks. mkd: T24S R1W S27 BT
A chincapin, 6" dia., bears S.34°E., 8 lks., mkd: T24S R1W S34 BT.

A fir, 10" dia. bears S.41°W. 27 lks. mkd: T24S R1W S33 BT
A chincapin, 8" dia., bears N.47°W., 24 lks., mkd: T24S R1W S28 BT.

This cor. is on top of a spur sloping S about 200 ft. above ¼ sec. cor.

Douglas Co. Surveyors Office - Milo E. Godfrey, Deputy Co. Surveyor - Vernon Tracy - Clete Putnam - Oct. 1961 - C.S. File 52/42-7

Found - Mound of rocks.

Fir tree now 24" N.68°E. 22.4' (instead of N.66°E.) 22.4 ft., shows good scars. Tree in good cond.

Chinq. now 8", S.29°E., 5.3 ft. (instead of S.34°E.) 5.3 ft face badly rotted but scribing "BT" vis.

Pine tree, instead of Fir, now 24" S.42°W., (instead of S.41°W.) 17.8 ft., shows scars. Blaze 7 rescribe this tree "T24S R1W S33 CS BT"

NW BT not found.

Set - Iron pipe with Brass cap mkd: COUNTY SURVEYORS OFFICE 1961 T24S R1W S 28 | S 27 S 33 | S 34

17" D.Fir N.32½°W., 24.3 ft. mkd: T24S R1W S28 CS BT

13" D.Fir S.47¼°E., 26.3 ft. mkd: T24S R1W S34 CS BT

Fd. Ok by VRT, DCSO - May 1970 C.S. File 54/27-197

Douglas Co. Surveyors Office - Randall W. Smith, Deputy - Stephen J. Flause - 10/29/1996 - C.S. File 65/9-23

RENEWED 7/31/23

Found - 2½" dia. DCSO brass cap on a 1½" O.D. iron pipe. protrudes 11" above ground. Is surrounded by a 1 ft. mound of stone. 1961

6" now 7" dia. 5 ft. high rotted Chinquapin snag, with a rotted blaze, no scribing visible, bears S.29°E., 5.3 ft. (agrees with 1961 rec.) O.B.T.

continued next page

OVER

CS 67/56-53.1
314

RENEWED 7/31/23

TOWNSHIP 24 RANGE 01 POINT IDENTIFIER # 400200

PRIMARY CORNER DESCRIPTION Cor Secs 27, 28, 33, & 34

Alias _____ Description CCRS CANYONVILLE COTTAGE GRV. COORDS
 Alias _____ Description _____
 Alias _____ Description 225950.569 N
 Alias _____ Description _____

SEE PG 1 FORMON. DESCR 305529.089 E

10" now 22" dia. 70 ft. high dead Pine snag, with an unhealed double blaze, scribing visible "T24S R1W S33 CS BT" bears S.42°WV, 17.8 ft (agrees with 1961rec.) O.B.T.

BROKEN ROTTED 13" x 2 FT No other original BT's found.

FIR STUMP 13" now 12" dia. 4 ft. high rotted D. Fir stump with scribing visible on a partially healed double blaze "R1W" bears S.47½°E. 26.3 ft. (agrees with rec.) 1961

BLAZE GONE

SW BT from 1961 now gone.

New BTs- 12" dia. D. Fir, double blazed and scribed "T24S R1W S28 CS BT" bears N.84½°WV, 21.7 ft. FHDB

15" D. FIR 5" dia. Hemlock, double blazed and scribed "T24S R1W S33 CS BT" bears S.33°W. 6.4 ft. FHDB

10" HEMLOCK 11" D. FIR 8" dia. D. Fir, double blazed and scribed "T24S R1W S27 CS BT" bears N.16°E. 19.6 ft. FHDB

FALLEN 9" 3" dia. pistol butt Hemlock double blazed and scribed "X BT", bearing and distance taken at upper blaze on straight trunk, bears S.73°E., 14.3 ft. BRG, AND DIST. OK TO ROOT HOLE FULLY HEALED HIGH LOW BLZ

DECLINATION 4½°E

NEW BT.

9" HEMLOCK SCRIBED "T24S R1W S34" "CS BT ON DOUBLE BLAZE AND 4" STEEL NAIL R.S.C. BEARS S45°E, 15.3 FT.

MONUMENT ON FLAT GROUND IN OLDER REPROD. FOREST

5272.74 589°46'E (90°72')

CS 67/56-53 4/4