

TOWNSHIP 24S RANGE 1W SEC. 28 PLSS # 300200

Date: 7/24/2023 By: X
This survey consists of:

DOUGLAS COUNTY OREGON

DATE 7-11-23

Map: _____

Narrative: _____

Corner Rpt: CS 67/56-47

Corner Designation

DOUGLAS COUNTY
SURVEYOR

1/1 Sec Cor 28-29-32-33

Monument(s) Found: (Condition and Source)

___ Condition report

1983 C.S BRASS CAP

___ Not Found

DOWN 8" DCSD BRASS

Renewed

Cap witness corner

___ Unrecorded

Previous Renewals

___ Surveyed In

DCSD 1960 CS 52/42-1

DCSD 1970 CS 54/27-196

DCSD 1983 CS 62/9-6

DCSD 1996 CS 65/9-26

Nygren 2016 M 172-62

MONUMENT DETAIL

Accessories Found

Reference To Corner

13" Rotted PINE STUMP S28°30'E 16.5 FT

48" FIR STUMP S76°E 35.4 FT (NOT CHECKED)

8" D.FIR S2°W 9.1 FT GOOD SCAR

10" D.FIR N38°E 18.5 FT GOOD SCAR

DEAD 13" D.FIR N70°W 41.5 FT GOOD SCAR

16" D.FIR S78°W 77.2 FT GOOD SCAR

References To W.C.

15" D.FIR N46°W 7.9 FT GOOD SCAR

15" D.FIR S55½°W 12.9 FT GOOD SCAR

16" D.FIR S32°E 33.2 FT GOOD SCAR

(Note Tree is a pistol Butt BEARING

AND DISTANCE GOES TO STRIGHT TRUNK

AT CENTER OF UPPER BLAZE

C.S. File 67/56-47

Monument Set (Procedure and Description)

MONUMENT DETAIL

Blank lines for Monument Set description.

New Accessories

Blank lines for New Accessories description.

Sketch of Monument, Accessories, and General Area

Location & Comments

LAT AND LONG POSITION ARE FOR M.C.

LAT 226007.033

LONG 300212.899

O.C.R.S

AREA BURNT
9-2020

Comp. Decline. 14 1/2° E
Agency DCSO
Party Chief S. ELAUSE
Note keeper
Witnesses J LORSUNG

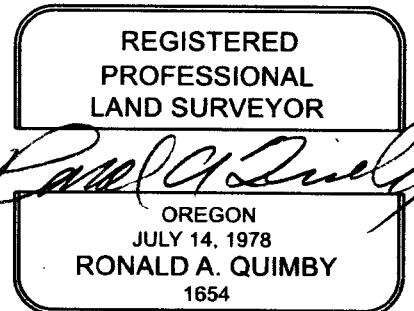

EXPIRES: 12/31/2024

CS 67/56-47

213

MM GPS 7/11/23
TIME - 9:50
H.I. - 2,000M

FWD OK 7/11/23

continued next page
TOWNSHIP 24 RANGE 01 POINT IDENTIFIER # 300200

PRIMARY CORNER DESCRIPTION Cor. Secs 28, 29, 32, & 33

Alias _____	Description _____
Alias _____	Description _____
Alias _____	Description _____
Alias _____	Description _____

Note: This corner is a bearing object as line was not run between sections in renewal #104) From witness cor (BC/IP) corner (drill cap) bears N.89°E., 60.0 ft. (Agrees with record, 1983)

Accessories Found - To witness corner (BC/IP)
 10" now 9" dia. 3 ft. high partially buried rotted Pine stump, no scribing visible, bears N.76°W., 14.5 ft. (agrees with renewal #144) Renewal #104
 11" now 12" dia. 6 ft. high rotted D.Fir snag with an unhealed single blaze, scribing visible "WC T24S R1W S29 CS BT" bears N.37°E., 30.3 ft. (rec. per 1970) N.37°E., 31.4 ft. goes to center of trunk) 1970

Accessories Found - To Section corner (drill cap)
 6" now 13" dia. 1½ ft. high rotted Pine stump with scribing visible "T" bears S.28½°E., 16.5 ft. (agrees with rec.) O.B.T.
 48" dia. 2 ft. high D.Fir with boat spike in top, boat spike bears S.76°E., 35.4 ft. (agrees with BT tag, rec. per 1983 is S.76°E., 34.5 ft.)
 All other BT's now gone.

New - B.T. bearing & distance go from wit. cor. (BC/IP)
 15" 8" dia. D.Fir, double blazed and scribed "WC T24S R1W S29 CS BT" bears N.66°W, 7.9 ft.
 15" 7" dia. D.Fir, double blazed and scribed "WC T24S R1W S32 CS BT" bears S.55½°W, 12.9 ft.
 16" 7" dia. D.Fir, double blazed and scribed "WC T24S R1W S32 CS BT" bears S.32°E, 33.2 ft. (note: tree is a pistol butt, bearing & dist. goes to straight trunk at center of upper blaze)

Gerald V. Nygren - For: Barnes & Assoc. Inc. - 11/2016 - M172-62

Found - 1983 C.S. brass cap per PLSS 300200-8" BELOW GRND. (1896) 6" pine, now 13" rotten stump bears S.28°30'E., 16.5' no marks visible
 FD WC (1970) 1970 C.S. brass cap bears S.89°W., 60.0' - 2½" BC/IP PROT 10"
 (1983) 48" fir stump and boat spike in top bears S.76°E., 35.4' NOT CHK'D

New BTs - 8" D.Fir bears S.02°W., 9.1' scribed: "X BT"
 10" 8" D.Fir bears N.38°E., 18.5' scribed: "T24S R1W S28 BT"
 NOW DEAD 13" D.Fir bears N.70°W., 41.5' scribed: "T24S R1W S29 BT"
 16 13" D.Fir bears S.78°W., 77.2' scribed: "T24S R1W S32 BT"

CS 67/56-47
3/3

PRIMARY CORNER DESCRIPTION Cor. Secs. 28, 29, 32, & 33

Alias _____	Description _____
Alias _____	Description _____
Alias _____	Description _____
Alias _____	Description _____

950

GLO survey by Carl S. Nicklin, Dep. Surveyor under contract # 664, dated May 23, 1896 - (DCSO recs Vol. 7 Page(s) 2825-6)

Set a pine post, 4 ft. long, 4" sq. 24" in the ground, for cor. to secs. 28, 33, 32, & 29, marked T24S S28 on NE, R1W S33 on SE, S32 on SW, S29 on NW faces, with 4 notches on E & 1 notch on S edges; from which

A pine, 14" dia., bears N.60°E., 32 lks., mkd: T24S R1W S28 BT.

A pine, 6" dia., bears S.28½°E., 25 lks., mkd: T24S R1W S33 BT.

A pine, 6" dia., bears S.42½°W., 15 lks., mkd: T24S R1W S32 BT.

A pine, 6" dia., bears N.39°W., 44 lks., mkd: T24S R1W S29 BT.

This corner is on a steep hillside, sloping W about 25 ft. above dry bed of creek, last noted.

Douglas Co. Surveyors Office - James W. Byron, Deputy - Milo E. Godfrey - Clete Putnam - Aug. 1960 - C.S. File 52/42-1

Found - Three orig. BTs, check bearing & dist.
 SW BT gone, NE & NW show scribing.
 SE BT shows good face but no scribing. I scribe this BT, S.28½°E., 16.5 ft., S33 T24S R1W.

Note - Centerline logging Rd. N.40°W., 13 ft.

Set - Brass cap at corner mkd: COUNTY SURVEYORS T24S R1W
 OFFICE 1969 S 29|S 28
 S 32|S 33

15" Pine bears S.54°W., 27.9 ft., scribed S32 T24S R1W CS BT.

Douglas Co. Surveyors Office - Vernon "Ray" Tracy - Vincent Perron - May 28, 1970 - C.S. File 54/27-196

Found - No trace of 1960 county brass cap or BT.
 Orig. 14" now 20" Pine, good condition, N.60°E., 21.1 ft. Alive.
 Orig. 6" Pine, now 15" snag, S.28½°E., 16.5 ft., scribe visible.
 Other orig. BT down.
 Drive 3/4" iron rod on very steep, cut bank & measure 60 ft. W to West shoulder of new logging road & SET WITNESS CORNER as follows:

Set - Brass cap at cor. mkd: COUNTY SURVEYORS T24S R1W
 (Set 6.0 ft, steel fence post alongside) OFFICE WIT S 29|S 28 60' E
 1970 COR S 32|S 33 to cor.

continued next page

PRIMARY CORNER DESCRIPTION Cor. Secs. 28, 29, 32, & 33

Alias_____	Description_____
Alias_____	Description_____
Alias_____	Description_____
Alias_____	Description_____

New BTs- 10" Pine N.76°W. 15.3 ft. mkd: WC T24S R1W S29 CS BT
 11" D.Fir N.37°E., 31.4 ft., mkd: "WC T24S R1W S29 CS BT"
 Road bears N.55°E. - S.55°W. No other trees available.

Douglas Co. Surveyors Office - Larry E. Monrean, Deputy -
 John Powell - Janet Lundeen - Sept. 28, 1983 - C.S. File
 62/9-6

 Found - Did not find County cap per 1960 or 3/4" I.R. per 1970
 Orig. 6" pine, now 18" stump with lower portion of
 Byron's rescribing visible (Rec. S.28½°E. 25 lks)
 Orig. 6" pine, (rec. N.39°W., 44 lks.) falls in road
 bed. Gone
 Orig. 6" pine (rec. S.42½°W., 15 lks.) Gone.
 Orig. 14" pine (rec. N.60°E., 32 lks.) Gone, down &
 across road.
 Byron's 15" pine (rec. S.54°W., 27.9 ft.) lying dead
 on edge of bank.
 1970 County Surveyor's brass cap for witness corner
 (properly marked), bears S.89°W., 60 ft. from
 corner. (Rec. West, 60 ft.)
 10" Pine, now snag, bears N.76°W., 14.5 ft., (15.3)
 from WC.
 11" D.Fir now snag, bears N.38½°E., 31.3 ft. (31.4)
 from WC.

Set - Using fd. orig. 6" Pine, (now 18" stump) we pull
 record S.28½°E., 16.5 ft. & set brass cap in
 drill hole flush with rock on a steep cut bank.
 Cap marked: COUNTY SURVEYORS OFFICE

	29 28
T24S	32 33
R1W	1983

Material will slough off bank & cover cap.
 BLM notified us in 9/1983 that they disagree
 with the rec. bearing from the corner to the
 WC. We find that the WC is S.89°W., 60 ft.
 from corner.

New - Boat spike in 48" Fir stump bears S.76°E., 34.5 ft.
 Boat spike in 14" W.Pine stump bears N.20°W. 53.6 ft

Douglas Co. Surveyors Office - Randall W. Smith, Deputy -
 Stephen J. Flause - 10/31/1996 - C.S. File 65/9-26

 Found - 3" dia. drill cap (DCSO) set in rock on a cut bank
 6" below ground on a road cut bank. 1983
 2½" dia. DCSO brass cap on a 1½" O.D. iron pipe
 protrudes 6" above ground in Road shoulder. 1970