

CORNER RENEWAL

DATE 9/17/2021

RENEWAL STATUS RENEWAL T-R-PLSS T28S, R03E, 600140

MONUMENT FOUND:
FROM 1928/1929
GLO SURVEY

A 2 1/2" DIA. BRASS CAP, MARKED AS DESCRIBED, ON
A 3/4" I.D. IRON PIPE PROJECTING 8" ABOVE GROUND.

NEW BEARING OBJECTS

48" DIA.
WHITE FIR

HAS USFS LOCATION TAG INDICATING TREE IS N74°E, 52 FT. FROM COR.
WE DO NOT SCRIBE BUT ADD SIDE-CENTER SPIKE.
TREE BEARS: N70°E, 51 1/2 FT. DISTANT.

19" DIA.
NOBLE FIR

SCRIBED "114536" "CSBT" ON A DOUBLE BLAZE
BEARS: S05°E, 104° FT. DISTANT.

16" DIA.
NOBLE FIR

HAS USFS LOCATION TAG INDICATING TREE IS N43°W, 43 1/2 FT. FROM COR.
WE DO NOT SCRIBE BUT ADD SIDE-CENTER SPIKE.
TREE BEARS: N47°W, 43 1/2 FT. DISTANT.

19" DIA
NOBLE FIR

TREE IS MARKED WITH A DOUGLAS COUNTY LOCATION TAG.
TREE IS APPROX. SOUTH, 140 FT.

HISTORICAL OBJECTS
THE ORIGINAL
1928 BEARING TREES

A 44" DIA. 4 FT. TALL SAWN AND BARKLESS TWIN FIR STUMP
WITH A FULLY HEALED BLAZE BEARS:
S18°E, 48 1/2 FT. DISTANT

A 21" DIA. APPROX. 40 FT. TALL DEAD FIR SNAG WITH AN
UNHEALED AND ROTTED BLAZE SHOWING PARTIAL SCRIBE MARKS.
BEARS: N42°W, 124 1/2 FT. DISTANT (AS PER RECORD)

FILED

Date: 3/21/2023 By: SC

This survey consists of:

Map: _____

Narrative: _____

Corner Rpt: 67/55-51

DCSO

DOUGLAS COUNTY
SURVEYOR

C.S. FILE 67/55-51

LOCATION AND COMMENTS

MONUMENT NEAR NORTHEND AND ON EAST EDGE OF A MEADOW IN A MIXED FIR; OLD GROWTH FOREST. MONUMENT IS ON GENTLE NORTH SLOPE.

SKETCH

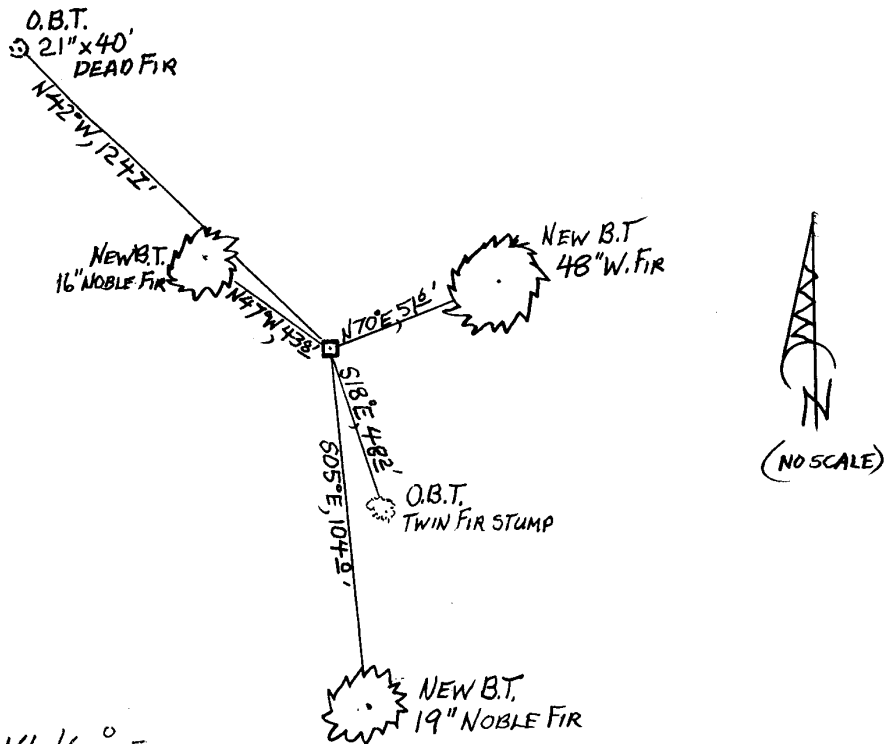

DECLINATION: $14\frac{1}{2}^{\circ}$ E

CREW: PARTY CHIEF - S. J. FLAUSE

TECHNICIAN - J. A. LORSUNG

COORDINATES:

WGS84 LAT. = N $43^{\circ}05'26.77''$

WGS84 LONG. = W $122^{\circ}25'14.78''$

MMGPS 9/8/21

9/17/21

TOWNSHIP 28 RANGE 03E POINT IDENTIFIER # 600140

PRIMARY CORNER DESCRIPTION 1/4 Cor. Secs. 35 & 36

Alias _____	Description _____
Alias _____	Description _____
Alias _____	Description _____
Alias _____	Description _____

GLO survey by Herbert N Raymond, U.S. Cadastral Engineer, under special instructions dated Dec. 27, 1920, Surveyed Aug 1928/Aug 1929 - (DCSO records Vol. 25 Page(s) 10492)

Set an iron post, 3 ft. long, 1" dia., 30" in the ground, for 1/4 sec. cor., with brass cap marked

2 1/2" BC on 3/4" 1" 1/4 S 35 S 36
PRO 8" 1928

from which

A twin fir, 36" dia., bears S 20° E., 73 lks. mkd: 1/4 S36 BT

A fir, 20" dia., bears N 42° W., 189 lks., mkd: 1/4 S35 BT.

ROTTEN SPUNK STMP 44x44
21"x40" DEAD SNAG

618°E 402

124 1/2 UNHEALED BLZ

SOME PARTIAL SCRAP MARKS

NORTH END, EAST EDGE OF MEADOW ON MOD. N SLOPE, IN MIXED OLD GRTD FIR

NEW BTs

FS LOC TAGSAYS
N74°E, 52 FT
(COR)

48" W. FIR NOT BLZ'D BUT SC NAIL N70°E, 51 1/2

DCSO

19" NOBLE FIR " 1/4 S36 " CSBT S 05° E, 104'

FS LOC TAGSAYS
N43°W, 43 1/2
(COR)

16" NOBLE FIR NOT BLZ'D BUT SC NAIL N47°W 43 1/2

140' SOUTH TO LINE XING TAG ON 1/4" NOBLE

943
30

C.S. FILE 67/55-51