

CORNER RENEWAL

DATE SEPT. 8, 2021

RENEWAL STATUS RENEWAL T-R-PLSS T28S, R03E, 700200

FROM 1928/1929 GLO SURVEY

MONUMENT FOUND:

A 2 1/2 INCH DIA. GLO BRASS CAP MARKED AS DESCRIBED
ON A 1 1/2 INCH I.D. IRON PIPE PROJECTING 9 INCHES ABOVE GROUND.

NEW BEARING OBJECTS

18 INCH DIA.
WHITE FIR

NOT ~~BLAZED~~ OR SCRIBED
FOREST SERVICE LOCATION TAG MARKED S70°W, 23 8 FT.
WE RIGHT SIDE, CENTER SPIKE TREE AND MEASURE
A BEARING AND DISTANCE OF N66°E, 24 0 FT, TO TREE

35 INCH DIA.
GRAND FIR

AS ABOVE BUT WITH TAG MARKED N72°W, 15 4 FT.
WE SIDE SPIKE AND MEASURE S76°E, 15 9 FT. TO TREE

HISTORICAL OBJECTS

1928/1929
GLO SURVEY

≈ 36 INCH DIA. 4 FT. TALL ROTTED AND BROKEN FIR STUMP.
ALL NOTED SCRIBING STILL LEGIBLE ON UNHEALED FACE.
STUMP BEARS S30°E, 35 4 FT.
NO CLEAR EVIDENCE OF OTHER B.T.'S FOUND.

FILED

Date: 3/2/2023 By: SC

This survey consists of:

Map: _____

Narrative: _____

Corner Rpt: CG 67/55-50

DOUGLAS COUNTY
SURVEYOR

DCSO

C.S. FILE 67/55-50

LOCATION AND COMMENTS

CORNER ON EASTERLY EDGE OF ALDER THICKET, ON MODERATE NNW SLOPE,
APPROXIMATELY 85 FT NORTH OF GRAVEL FOREST ACCESS RD.

SKETCH

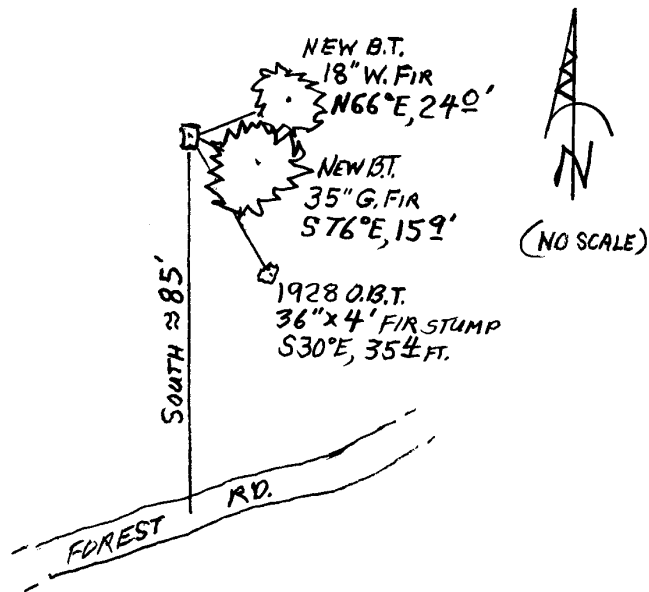

DECLINATION: $14\frac{1}{2}^{\circ}$

CREW: CREW CHIEF - S. J. FLAUSE TECHNICIAN - J. A. LORSUNG

COORDINATES:
WG584 $43^{\circ} 05'$ N
 $122^{\circ} 24'$ W

DCSO

C.S. FILE 67/55-50
2/2