

GOVERNMENT CORNER RESTORATION FORM
DOUGLAS COUNTY SURVEYOR

TOWNSHIP 30S RANGE 04W SECTION 8

PLSS/GCDB No. 050040

CORNER DESIGNATION: SE COR JOSEPH P. WILSON DLC #50

CORNER HISTORY, PREVIOUS RENEWALS OR SURVEYS:

- ORIGINAL GLO SURVEY BY BOWMAN AND BURNETT SEPT. 1855 (DLC VOL. PG. 616).
- 1 1/2" X 30" GALV. IRON PIPE SET F.C FREAR, DEPUTY CO. SURVEYOR, DOUGLAS COUNTY SURVEYORS OFFICE, OCT/NOV. 1918, M 1-3, VOL 3 PG.29, C.S. FILE 7/18.
- BRASS CAP SET BY G. LANGLITZ DCSO, APR, 21, 1976. (C.S. FILE 59/8-20)

Date: 11/8/2022 FILED
By: SC
Corner Form: CS 67/54-56
Field Notes: 3 PGS
DOUGLAS COUNTY SURVEYOR
DATE: 8/13/2018
 Condition Report Only
 Not Found
 Renewed
 Unrecorded
 Surveyed In
 Referenced Out

MONUMENT FOUND (CONDITION AND SOURCE):

FOUND 1976 2 1/2" BRASS CAP ON A 1" IRON PIPE PROJECTING 2"
FOUND 1 1/2" IP ON WEST SIDE OF BRASS CAP PROJECTING 1"

MONUMENT DETAIL

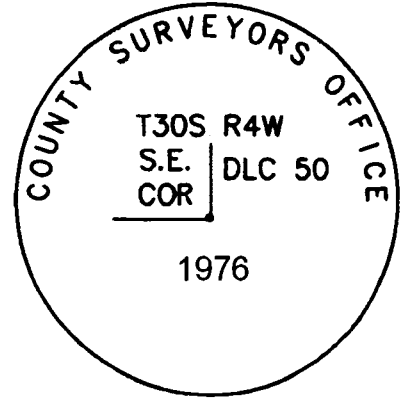

ACCESSORIES FOUND (CONDITION, SOURCE & RECORD):

BEARING TREES BY LANGLITZ:

- 18" DIAM. FIR STUMP 10" TALL BEARS N 3 1/2° W, 44.8 FT. WITH A FULLY HEALED LOWER BLAZE.
- 11" DIAM. MADRONE BEARS N 62° W, 3.5 FT. WITH A FULLY HEALED DOUBLE BLAZE.

NEW ACCESSORIES:

- 13" DIAM. MADRONE SCRIBED "SEDLC50", "CSBT" ON A DOUBLE BLAZE BEARS S 46° E, 13.5 FT.
- 17" DIAM. FIR SCRIBED " "SEDLC50", "CSBT" ON A DOUBLE BLAZE BEARS S 61 1/4° W, 16.2 FT.

LOCATION & COMMENTS:

THE IRON ROD MONUMENT WITH CAP IS LOCATED NEAR THE TOP OF EAST-WEST RIDGE WESTERLY OF GILBEAUGH CREEK ROAD (BLM 70) IN A REPROD FOREST OF MADRONE AND FIR. A 2" WIDE GALV. U-POST PROJECTING 4 FT. ABOVE GROUND BEARS S 80 1/2° W, 1.85 FT FROM THE MONUMENT. (BEST ACCESS IS FROM BLM RD. 70 FOLLOWING THE RIDGE LINE DOWN FROM THE Y INTERSECTION)

GEODETIC COORDINATES
LATITUDE:
LONGITUDE:
ELLIPSOID HEIGHT:
DATUM: NAD 83
SOURCE:

COMPASS DECLINATION: 15° E.
AGENCY:DCSO
PARTY CHIEF: S. J. FLAUSE
WITNESSES: JEFF A. LORSUNG
NOTES: ATTACHED

CS 67/54-56

8/13/18

TOWNSHIP 30 RANGE 04 POINT IDENTIFIER # 050040

PRIMARY CORNER DESCRIPTION SE Cor Joseph P. Wilson DLC #50

Alias _____	Description _____
Alias _____	Description _____
Alias _____	Description _____
Alias _____	Description _____

Original - GLO survey by Bowman and Burnett, under Contract dated Sept. 1855 (DLC survey Volume, Page 616)

Summit of mountain. Set a post marked, from which
A B.Oak 8" dia., bears N.73°W., 20 lks.

GLO survey by Wm. Thiel, Deputy Surveyor, under Contract #535, dated Feb. 5, 1889 (DCSO records DLC Volume Page 721)

The post set for this corner is gone, but the bearing tree, marked T30S R4W C.50 BT an Oak 9" in dia. is standing, but killed by fire. I restore this cor. by setting a sandstone 12 x 8 x 6 ins., 8" in the ground, marked 50 on NW. face, from which

- A Fir 10" dia., bears N.80°W., 5 lks. dist. mkd. T30S R4W C50 BT.
- A Laurel 6" dia., bears N.15°E., 16 lks. dist. mkd. T30S R4W C50 BT.

NO EVID

F.C. Frear, Deputy Co. Surveyor - Wit: A. Wallenburg; R. Morrison - Oct/Nov. 1918 - M 1-3; Vol. 3 Pg. 29; C.S. File 7/18 and Field book 14=45

1" I.D. GALV. I.P.

Renew from government BTs. Set in 1 1/2" x 30" galv. Iron pipe and 4" x 48" Fir stake, from which

- A 10" Fir bears S.56°E., 7 lks
- NOT FOUND A 10" Fir bears N.88 1/4°W., 11 1/2 lks.

FALLEN ALMOST COMPLETELY ROTTED AWAY NO SCRIBING REMAINS

Douglas Co. Surveyors Office - G. Langlitz; G. Quibell; A. Cangie; Debbie L. Stewart, crew - April 21, 1976 - C.S. File 59/8-20

Found - 1 1/2" I.P. and probable remains of a 4" stake set by Frear in 1918.

No trace of original bearing tree.

SEE ABOVE

- A windblown Fir 12" bears S.56°E., 4.6 ft. We open to find visible scribe "CS 50 BT".
- The probable remains of a NW. BT also down, 10". Its root wad bears N.88 1/4°W., 7.6 ft. We do not unearth, blaze is buried face down, and we do not open.

Set a 1" x 30" I.P. with brass cap stamped: 2 1/2" DIA.

PROT. 2"

County Surveyors Office ✓
T 30 S R 4 W
S.E. | D.L.C.
Cor. | 50

1976

(Cont. Next Page)

2/3 CS 67154-56

T30S, R04W
SEC. 1

TOWNSHIP 30 RANGE 04 POINT IDENTIFIER # 050040

PRIMARY CORNER DESCRIPTION SE Cor. Joseph Wilson DLC #50

Alias _____	Description _____
Alias _____	Description _____
Alias _____	Description _____
Alias _____	Description _____

The found 1 1/2" V.I.P. on the West side of brass cap. PROT. 1"
New BTs -12" D. Fir bears N. 3 1/2° W., 44.8 ft. scribed "SE DLC 50 FH LOWER BLZ.
18" x 10" TALL STMP CS BT" in double blaze.
11" 6" Madrone bears N. 62° W, 3.5 ft. scribed "SE DLC 50
CS BT" in double blaze. FHDB

NEW BEARING TREES
13" MADRONE "SE DLC 50" "CSBT" ON DBL. BLZ. S 46° E, 13 5 FT
17" D. FIR WITH CROOK IN TRUNK 5 FT. 1BY. GRND SCRIBED "SE DLC 50" CSBT ON D.B. S 61 1/4° W, 16 2 FT.
2" WIDE GALV. MARKER POST PROT. 4 FT. BEARS S 80 1/2° W, 1 85 FT.
MON. IS IN REPROD FOREST OF MAD. AND FIR ON STEEP SW SLOPE NEAR TOP OF EAST-WEST
RUNNING RIDGE

CS 67/54-56 2