

FILED NOV 9 2022 JUNE 20, 2017
T30S, R04W, NE DLG 46, PLSS 046010

MONUMENT FOUND:

THE 1922 DCSO RENEWAL MONUMENT AN IRON PIPE, NOW A 1/2" I.P. IRON PIPE, 27" LONG, TIPPED AND BENT SSE, PROTRUDING APPROX. 3" ABOVE GROUND. (LENGTH DETERMINED WHEN MONUMENT WAS REMOVED FROM GROUND TO STRAIGHTEN.)

ACCESSORIES FOUND: (MEASUREMENTS ARE FROM PLUMB POSITION OF FOUND I.P. MONUMENT)

EVIDENCE OF THE TWO ORIGINAL 1855 B.T.'S. A B. OAK 15" DIA., NOW A 35" DIA., BROKEN TOPPED BUT STILL ALIVE B. OAK SNAG WITH A FULLY HEALED DOUBLE BLAZE; BEARS S15°E, 10² FT. DISTANT (RECORD S15°E, 9² FT. DISTANT WOULD BE GOOD TO ORIGINAL FACE.)

THE B. OAK 8" DIA. IS NOW A SHALLOW ROOT DEPRESSION NEAR THE ORIGINAL BEARING AND DISTANCE.

THE ONE NEW IN 1889 BEARING TREE A LAUREL 6" DIA., NOW AN INDISTINCT ROOTHOLE S47°W, 15² FT DISTANT (AS PER RECORD).

C.S. FILE 67/54-55 1/5

(2)
T30S, R04W, PLSS 046010
THE ONE NEW IN 1922 BEARING TREE: A 20" B. OAK, NOW A FALLEN ROTTED AND OUT OF POSITION 22" DIA. B. OAK. TREE IS FALLEN ON FACE (BLAZE EVIDENCE NOT SEEN). THE ROOT CROWN OF THIS TREE IS STILL INTACT AND IN POSITION AND BEARS N07°E, 42² FT. DISTANT (BEARING IS AS PER RECORD, RECORD DISTANCE OF 44² WOULD BE A GOOD SLOPE MEASUREMENT)

MONUMENT RE-HAB:
PLUMB POSITION OF FOUND I.P. IS REFERENCED OUT. PIPE IS REMOVED FROM GROUND, STRAIGHTENED AND RETURNED TO THE REFERENCED POSITION.

NEW ACCESSORIES:
A DOUBLE TRUNK MADRONE SCRIBED "NE DLG 46 CS" BT ON A DOUBLE BLAZE ON ITS 30" DIA. SOUTHERLY TRUNK. THE CENTER OF THE ROOT CROWN OF THE DOUBLE TRUNK BEARS N26°E, 9² FT. DISTANT.

A 14" DIA. J. CEDAR SCRIBED "NE DLG 46 CS" BT ON A DOUBLE BLAZE; BEARS S84 1/2°W, 17² FT DISTANT.
CS 67/54-55 2/5

(3)
T30S, R04W, PLSS 046010 (CONT'D)

A 7" DIA. D. FIR SCRIBED "X" "CS BT" ON A HIGH-LOW BLAZE; BEARS N21°W, 3² FT DISTANT. DECLINATION 15°E

THE I.P. CORNER MON. IS APPROX. 1 FT. WEST FROM A N-S RUNNING WIRE FENCE THE CORNER IS ON A MODERATELY STEEP SOUTH SLOPE JUST INSIDE THE WEST EDGE OF A MIXED WOODS COMPOSED OF FIR, OAK, PINE, CEDAR AND MADRONE. MOSTLY OPEN MOUNTAIN PASTURE TO WEST.

T STEPHEN J. FLAUSE
+ MIKE S. KOCH
M Stephen John Flause

CS 67/54-55 3/5

(4)
T30S, R04W, PLSS 046010 (CONT'D)

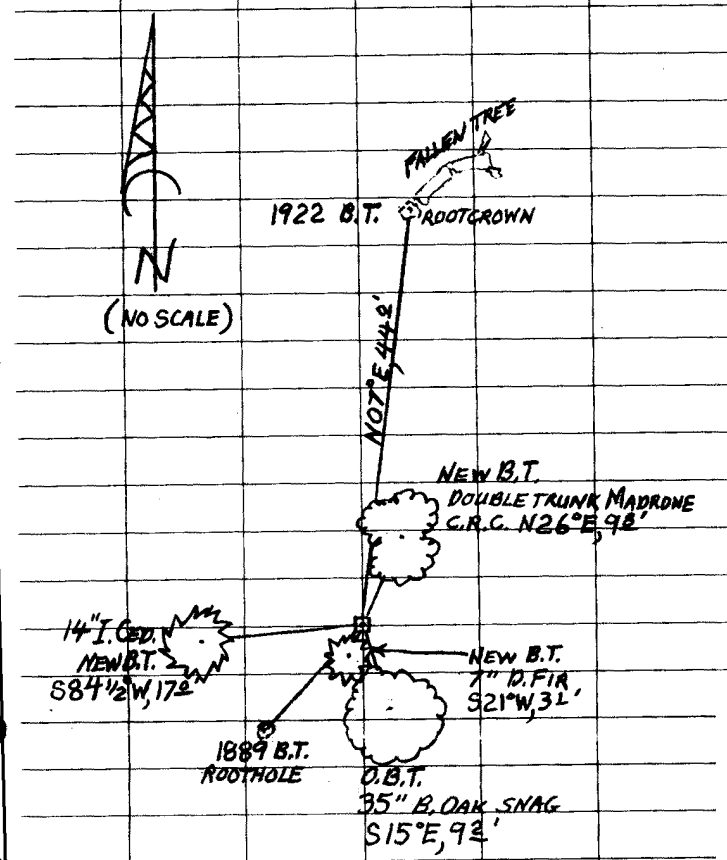

CS 67/54-55 4/5

JUNE 20, 2017

TOWNSHIP 30 RANGE 04 POINT IDENTIFIER # 046010

PRIMARY CORNER DESCRIPTION NE Cor. Alexander Dumond DLC #46

Alias _____	Description _____
Alias _____	Description _____
Alias _____	Description _____
Alias _____	Description _____

Original - GLO survey by J.A. Burnett, under Contract dated Sept. 1855 (DLC survey) (DLC Vol. Page 609)

Set a post, from which ^{NEAR B&D} A B.Oak 8" dia., bears S. 15° W., 15 lks. ^{9 90}

SHALLOW DEPR A B.Oak 15" dia., bears S. 15° E., 14 lks. ⁹²⁴ POS FACE MEAS CRE NOW 10' _{35" LIVE}

FHDB

GLO survey by Wm. Thiel, Deputy Surveyor, under Contract #535, dated Feb. 5, 1889 (DCSO records DLC Volume Page 709)

The NE. Corner, a Post without marks is in place, probably set by the Co. Surveyor; the bearing tree SE. of cor. is standing; and a stump of a B.Oak, corresponding in size, direction and bearing with the field notes of original survey. I replace the partially decayed post and restore the corner by setting a Laurel post 4½ ft. long, 4" sq., 24" in the ground, marked T30S R4W C. 46 on the SW. face, from which

A B.Oak 24" dia., bears S. 15° E., 14 lks. dist. mkd. T30S R4W C. 46 BT. This is the old bearing tree, whose marks being dim, I renew. ^{15 18}

good ROOT HOLE Laurel 6" dia., bears S. 47° W., 23 lks. dist. mkd. T30S R4W C. 46 BT. _{TREE GONE}

G. G. Stewart - Wit: H.A. Hill - April 6, 1922 - C.S. File 7/6

Set Iron pipe from orig. BT.

A 24" B.Oak S. 15° E., 9.2 ft. (orig. BT)

OUT OF POS A 20" B.Oak N. 7° E., 44.0 ft. ⁴²⁶ _{FALLEN 22" ROOT CROWN INTACT} ^{GOOD SLOPE MEAS} _{FALLEN ON FACE BLZ NOT SEEN}

Fd. I.P. and BTs OK, June 1970 by L. Bishop - M 42-1

1/2" 10 x 27" I.P. TIPPED EBNT 0 5 SSE PROT. 3" STRAIGHTEN & RETURN TO PLMB.

NEW BTs

DOUBLE TANK MAD. SCRBO. ON STNLY 30" TANK "NE DLC 46 CS" BT" N 26° E, 98'

14" I. CED "NE DLC 46 CS" BT" S 84 1/2° W, 170'

7" D. FIR "X" "CS BT" ON HI-LOW BLZ N 21° W, 31'

WIRE N-S FNC 1 FT EAST

MDD STEEP SOUTH SLOPE JUGT INSIDE NEST EDGE MIXED WOODS 1
FIR OAK PINE CED MAD

CS 67/54-55 5/5