

FILED NOV 7 2022 JUNE 5, 2017

T30S, R04W, SE DLC40, PLSS 040040

MONUMENT FOUND:

FROM THE 1963 DC50 RENEWAL A 3/4" IRON ROD, NOW A 3/4" DIA., 36" LONG IRON ROD 14" BELOW GROUND SURFACE. TOP OF IRON ROD IS BENT NORTHERLY APPROX. 1 5/8 FT. OFF OF PLUMB BASE.

ACCESSORIES FOUND:

(MEASUREMENTS MADE FROM PLUMB PORTION OF FOUND IRON ROD.) THE 1855 O.B.T. A.B. OAK 12" DIA., NOW A 56" DIA. (MEASUREMENT OF MAIN TRUNK OF A NOW M/L DOUBLE TRUNK TREE) B. OAK WITH POSSIBLE HEALED SCAR FROM 1963 SCRIBING SEARCH; BEARS N68 1/2° W, 323 3/4 FT. DISTANT (AS PER RECORD).

NO EVIDENCE REMAINS OF 1963 RENEWAL B.T. BEARING TREES MARKED IN 1963 FOR SW CORNER OF DLC 41 ALSO AGREE WELL WITH THE FOUND I.R.

MONUMENT SET:

THE POSITION OF THE PLUMB PORTION OF THE FOUND

115

C.S. FILE 67/54-50

(3)

T30S, R04W, PLSS 040040 (CONT'D)

GROUND, UNDER A WIRE FENCE RUNNING APPROX. S30°W-N30°E; BEARS WEST, 85 00 FT. DISTANT. A WHITE METAL WITNESS SIGN AND POST IS SET 1 FT. EAST FROM "B0" REFERENCE MONUMENT. A WHITE METAL WIT. POST AND SIGN 1 0 FT. EAST OF B.C. SET

THE CORNER MONUMENT IS IN ROLLING OPEN PASTURELAND WITH SCATTERED LARGE OAK TREES.

⌘ STEPHEN J. FLAISE  
⌘ MIKE S. KOCH  
⌘ Stephen John Flaese

3/5

CS 67/54-50

(2)

T30S, R04W, PLSS 040040 (CONT'D)

3/4" I.R. IS REFERENCED OUT, THE ROD IS REMOVED AND IN ITS PLACE IS SET A 2 3/8" DIA. BRASS CAP ON A 1" DIA X 32" LONG IRON PIPE. THE TOP OF THIS B.C./I.P. MONUMENT IS 2" ABOVE GROUND. THE FOUND 3/4" I.R. IS STRAIGHTENED AND IS SET ON THE SOUTH EDGE OF THE B.C. MONUMENT PROTRUDING 1" ABOVE GROUND. THE BRASS CAP IS MARKED AS FOLLOWS:

" DOUGLAS COUNTY SURVEYOR "

T30S

SE

DLC40

R4W

2017

NEW ACCESSORIES:

THE SW CORNER OF DLC 41, A 2 3/8" DIA. BRASS CAP ON A 1" I.D. IRON PIPE BEARS NORTH, 132 0 FT. DISTANT. (AS PER ORIG. DLC REC.)

A 28" DIA. W. OAK SCRIBED "SE DLC 40" "CSBT" ON A DOUBLE BLAZE; BEARS S08°W, 134 2 FT. DISTANT.

A 1 1/2" DIA. DC50 ALUMINUM CAP, STAMPED "B0", ON A 5/8" X 30" IRON ROD, SET FLUSH WITH

215

CS 67/54-50

(4)

T30S, R04W, PLSS 040040

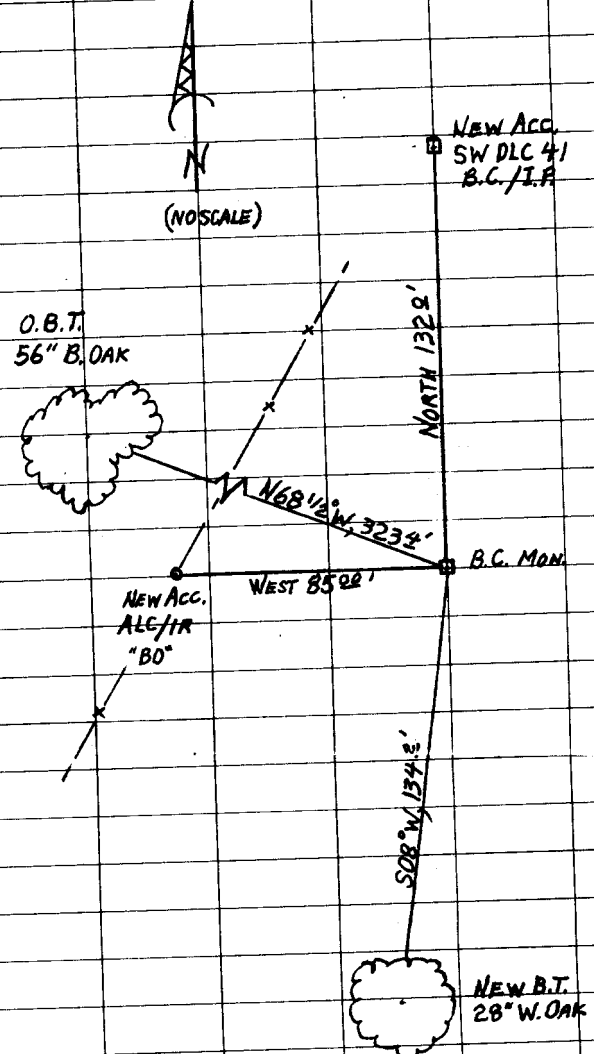

115

CS 67/54-50

TOWNSHIP 30 RANGE 04 POINT IDENTIFIER # 040040

PRIMARY CORNER DESCRIPTION SE Cor Issac Boyles DLC #40

Alias _____	Description _____
Alias _____	Description _____
Alias _____	Description _____
Alias _____	Description _____

6/5/17

Original - GLO survey by Bowman and Burnett, under Contract dated Sept. 1855 (DLC survey) (Page 601, DLC Volume)

56" (MAIN TRNK) Set a post marked, from which A B.Oak 12" dia., bears N.68½°W., 490 lks. <sup>323 1/2 FT</sup> ~~PGS HEALED SEARCH SCAR~~

GLO survey by Wm. Thiel, Deputy Surveyor, under Contract #535, dated Feb. 5, 1889 (DCSO records DLC Volume Page 697)

The post, set for this corner is gone, but the bearing tree is standing. I restore this cor. by setting a Fir post, 4½ ft. long, 4" sq., 24" in the ground, marked T30S R4W C. 40 on NW. face, from which

A B.Oak 15" dia., bears N.68½°W., 490 lks. dist., mkd. T30S R4W C. 40 BT. This is the old bearing tree whose marks being dim. I renew.

F.C. Frear, Douglas Co. Surveyor - Wit: Ralph Knight and Opher Perdue - Nov. 12, 1919 - Field Book 47 Pg. 41

I reestablish from O.B.T. by setting a 4" x 4' x 36" Yew stake and rock mound, from which A 36" B.Oak N.68½°W., 4.90 chs., O.B.T. The SW. Cor. of Claim 41 bears North 2.00 chs.

Douglas Co. Surveyors Office - James W. Byron - Milo Godfrey and Mike Stone, crew - Aug/Sept. 1963 - C.S. File 53/26

Found - Orig. 36" now 36" B.Oak N.68½°W., 323.4 ft. We open and find good scribing. Find mound of stone and old stake at corner. Corner is in old fence line and is S 11½°W., 132.0 ft. from SW. cor. DLC #41. Set 3/4" Iron rod at corner. New BT - 7" W.Oak bears N.8°W., 17.3 ft. scribed SE DLC 40 CS NO EVID BT.

NEW BT'S

28" W. OAK SCRIBED "SE DLC 40" "CS BT" S 08° W, 134 1/2 FT,

5/8" x 30" IR/ALM. CAP "BO" FLUSH/GROUND WEST 85 00' IN FENCE RUNNING N 63 00' W WITH A WHITE METAL WIT SIGN & POST 1 FT EAST

2 3/8" BC STAMPED "DOUGLAS COUNTY SURVEYOR"

5/5 CS 67/54-50

T30S  
SE  
DLC 40  
R4W  
2017