

FEB. 14, 2017

T305, R04W, NW1/4, DL49, PLSS 049040

MONUMENT FOUND:

FROM THE 1963 DCSD RENEWAL A 2 1/2 INCH DIA. BRASS CAP ON A 1" I.D. IRON PIPE SET PLUMB & PROTRUDING 18" ABOVE GROUND. THE BRASS CAP IS MARKED AS FOLLOWS.

" COUNTY SURVEYORS OFFICE "

T305  
R4W.

FILED NOV 7 2022

NW  
DL4  
49

1963

ACCESSORIES FOUND:

NO EVIDENCE REMAINS OF O.B.T.

EVIDENCE OF TWO 1924 COLE RENEWAL BEARING TREES.

A B. OAK 18" DIA. NOW A ROOT REPRESSION, WITH ROTTED OAK REMAINS NEARBY, DOWNHILL; BEARS S10°E, 6 1/2 FT. DISTANT (AS PER RECORD).

A FIR 12" DIA. NOW 18" DIA., 2 1/2 FT. TALL. DIA. FIR STUMP WITH A PREVIOUSLY OPENED AND NOW

C.S. FILE 67154-49

115

(2)

T305, R04W, PLSS 049040 (CONT'D)

REHEALED SINGLE BLAZE; BEARS S65°W, 6 1/2 FT. DISTANT (AS PER RECORD).

THE TWO 1954 DCSD RENEWAL B.T.'S. A 10" CEDAR NOW A 31" DIA. I. CEDAR WITH A FULLY HEALED DOUBLE BLAZE; BEARS N42 1/2°E, 23 1/2 FT. DISTANT (RECORD N44°E, 23 1/2 FT.).

A 6" R. FIR NOW A 19" DIA. D. FIR WITH A FULLY HEALED DOUBLE BLAZE; BEARS S77°W, 19 1/2 FT. DISTANT (AS PER RECORD).

NEW ACCESSORIES:

A 14" DIA. D. FIR SCABBED "NW DL49CS" "BT" ON A DOUBLE BLAZE; BEARS S61 1/4°E, 20 1/2 FT. DISTANT.

A 13" DIA. D. FIR SCABBED "NW DL49" "CS BT" ON A DOUBLE BLAZE; BEARS N02°W, 27 1/2 FT. DISTANT.

DECLINATION 15°E

CORNER MONUMENT IS ON A MODERATE SE SLOPE IN AN OLD SELECT CUT FOREST OF FIR, CED, MAP, OAK, BUE, MFL.

STEPHEN J. FLAUSE

MIKE S. KOCH

Stephen John Flause

CS 67154-49  
215

(3)  
T305, R04W, PLSS 049040

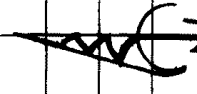

(NO SCALE)

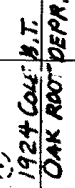
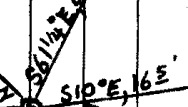
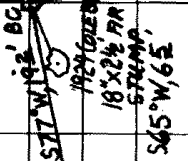
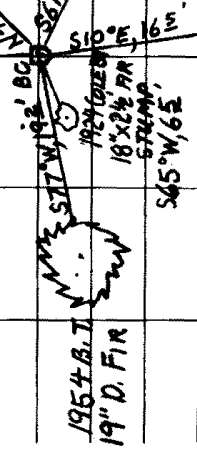
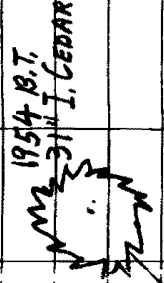
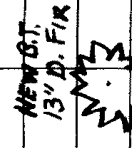

CS 67154-49  
315

TOWNSHIP 30 RANGE 04 POINT IDENTIFIER # 049040

PRIMARY CORNER DESCRIPTION W NW Cor Franklin O. Worley DLC 49

Alias _____	Description _____	<u>2/19/17</u>
Alias _____	Description _____	
Alias _____	Description _____	
Alias _____	Description _____	

Original - GLO survey by Bowman and Burnett, under Contract dated Sept. 1855 (DLC survey Volume, page 614)

-----

Set a post marked, from which 2112  
 A B.Oak 14" dia., bears S.67°E., 32 lks.

GLO survey by Wm. Thiel, Deputy Surveyor, under Contract #535, dated Feb. 5, 1889 (DCSO records DLC Volume, Pg. 717)

-----

I found here a post, marked T30S R4W C.49, lying down; but the bearing tree is standing. I restore the cor. by setting a Laurel post 4½ ft. long, 4" sq., 24" in the ground, marked T30S R4W C.49 on SE. face, from which  
 A B.Oak 18" dia., bears S.67°E., 32 lks. dist. mkd. T30S R4W C.49 BT. This is the old bearing tree, whose dim marks, I renew.

J.W. Cole - Wit: L.H. Billings; J. Sutton; J.R. Chaney; P.L. Beals - March 1924 - Field book 52 Pg. 58; Vol. 3 Pg. 186

-----

I found an old stake properly marked but which did not exactly correspond with calls of the bearing tree. I set the corner to correspond to the calls on the original BT which was standing. The scars having been cut open were rotted out. I marked new trees:  
 ROOT DEPR A B.Oak 18" dia., S.10°E., 16.5 ft. *ROOTS OAK REMAINS DOWN IN*  
 18" x 2½ STMP Ad.Fir 12" dia., S.65°W., 6.5 ft. *HEALED SB OPEN & REHEALED*  
 I set a galv. Iron pipe 1½" dia., 40" long, 36" in the ground at corner.

Douglas Co. Surveyors Office - J.W. Byron; Ray Irving; John Fee, crew - May 14, 1954 - C.S. File 46/45

-----

Found - 1½" Iron pipe at corner, checks bearing and distance to 18" R.Fir, S.65°W., 6.5 ft., scribing visible, fair condition.  
 B.Oak BT down and rotted.  
 Blazed and scribed:  
 19" 6" R.Fir S.77°W., 19.2 ft. mkd. NW CL. 49 CS BT. *FHDB*  
 31" 10" Cedar N.44°E., 23.6 ft. mkd. NW CL 49 CS BT. *FHDB*  
42½"

Douglas Co. Surveyors Office - James Byron, Deputy - Mike Darby; Wm. S. Stoffel crew - Aug. 1963 - C.S. File 53/26

-----

Found - All BTs as recorded.  
 10" now 14" Cedar N.44°E., 23.6 ft., shows scribing.  
 8" Fir S.77°W., 19.2 ft., shows scribing.  
 (Cont. Next Page)

CS 67/54-49 1  
415

