

GOVERNMENT CORNER RESTORATION FORM

FILED

TOWNSHIP 255 RANGE 1W SEC. 4 PLSS # 300640

Date: 10/18/2022 By: X
This survey consists of:

DOUGLAS COUNTY OREGON

DATE 9-6-22

Map: _____
Narrative: _____
Corner Rpt: CS 67/54 16

DOUGLAS COUNTY
SURVEYOR

Corner Designation

1/4 COR 5/4

Monument(s) Found: (Condition and Source)

BLM 3 1/4" BRASS CAP ON
2" I.D IRON PIPE UP 1"

___ Condition report

___ Not Found

Renewed

___ Unrecorded

___ Surveyed In

Previous Renewals

DCSD 1966 Not Found CS 52/
30-55A

BLM Resurveyed 1978-1980
Set Corner Vol 42 pg 16345

MONUMENT DETAIL

T255 R1W
1/4
55 | 54
1978

Accessories Found

A 34" D. FIRE 569 1/2° E 8.8 FT (REC 14 1/2 LKS)
Healed Single BLAZE ADD 3 1/2" MAG NAIL RIGHT
Side Center

A 17" D. FIRE N 60° W 14.3 FT (REC 22 1/2 LKS)
Healed Single BLAZE ADD 3 1/2" MAG NAIL RIGHT
Side Center

C.S. File 67/54-16

1/4

Monument Set (Procedure and Description)

MONUMENT DETAIL

New Accessories

5/8" x 30" I. Rod with DCSO yellow Plastic Cap
N 67 1/2° W 152.0 FT up 14"

5/8" x 30" I. Rod with DCSO yellow Plastic Cap
N 31° W 125.8 FT up 13"

Note: Iron Rods set on North Road
Shoulder

Sketch of Monument, Accessories, and General Area

Location & Comments

LAT 43° 25' 47.75" N
LONG 122° 49' 16.11" W

on moderately steep
N.W. slope
Rock outcrop ENE
30 FT ±

For sketch see Attached
Sheet

AREA BURNED
9-2020
Comp. Decline. 14 1/2" E

Agency DCSO
Party Chief S. F. LAUSE
Note keeper
Witnesses J. LORSUNG

REGISTERED
PROFESSIONAL
LAND SURVEYOR

Ronald A. Quimby

OREGON
JULY 14, 1978
RONALD A. QUIMBY
1654

EXPIRES: 12/31/2022

CS 67/54-16

T25S, R01W, 300640

9/16/22

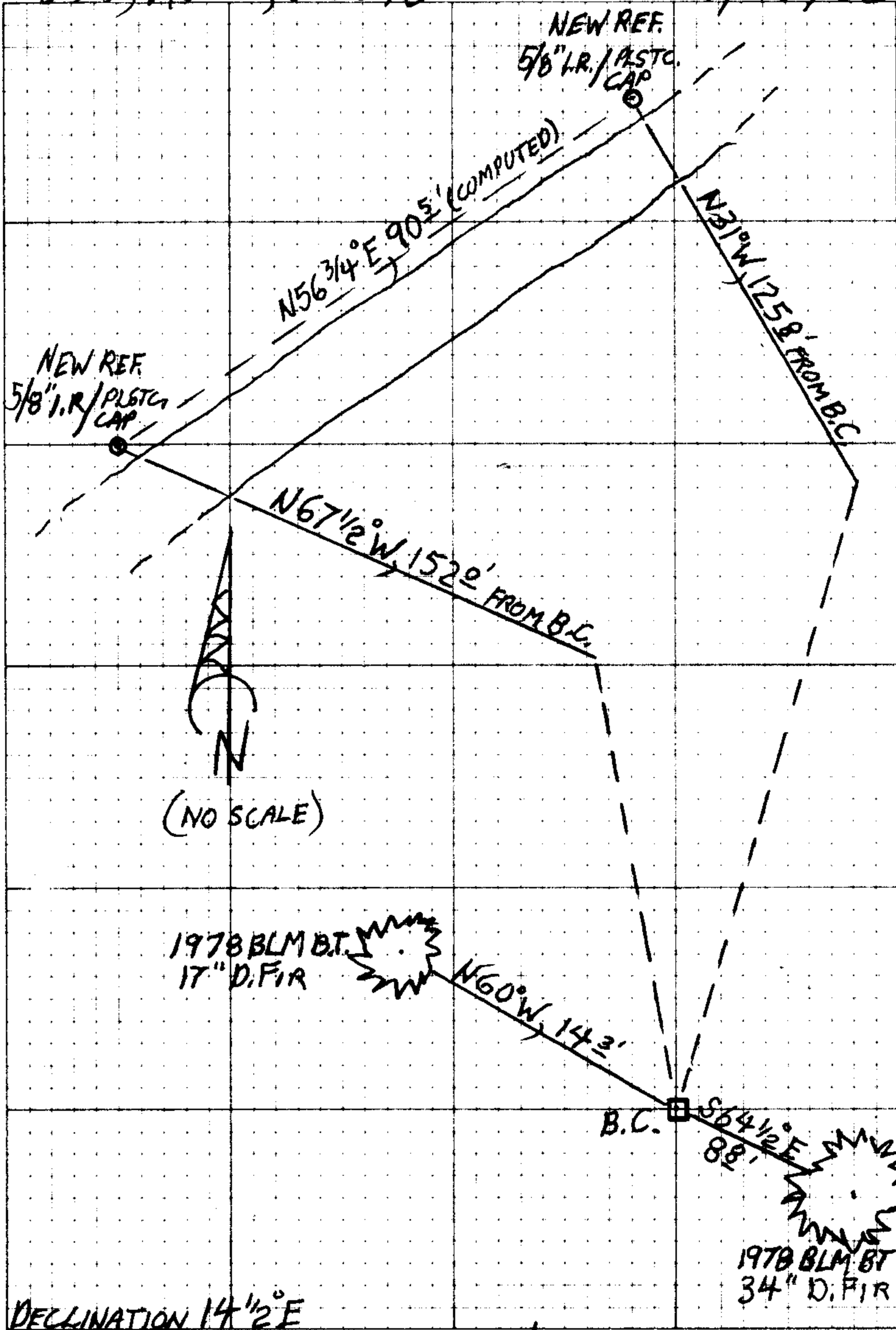

CS 67/54-16
3/4

