

GOVERNMENT CORNER RESTORATION FORM

FILED

TOWNSHIP 245 RANGE 3W SEC. 27 PLSS # 4002A0

Date: 8/11/2022 By: X

This survey consists of:

DOUGLAS COUNTY OREGON

DATE 6-15-22

Map: _____

Narrative: _____

Corner Rpt: C-S 67/54-5

Corner Designation

DOUGLAS COUNTY SURVEYOR

1/4 COR S28/527

Monument(s) Found: (Condition and Source)

Condition report

5/8" Iron Rod with 2"

Not Found

Alum Cap

Renewed

Unrecorded

Previous Renewals

Surveyed In

DCSD 1968 Not FD

MONUMENT DETAIL

EDWARD'S 2004 M 147-4

Roseburg Resources

Set

T245 R3W

1/4

S28/527

LS 2339

2004

Accessories Found

FIRE killed 38" Hemlock S68°W 35.5 FT

Broken 16" x 6' Burnt Hemlock SWAG N19°W 34.6 FT All scribes visible

6" steel Post East & West 1.5 FT

Unrecorded 1" I. Pipe N11 1/2° E 34.0 FT

Monument Set (Procedure and Description)

MONUMENT DETAIL

New Accessories

SAWN-Burnt 12" X 1" D. Fir Stump N176°E
24.0 FT 3 1/2" P.K NAIL Top Center

SAWN Burnt 13" X 1" D. Fir Stump S59°E
24.1 FT 3 1/2" P.K NAIL Top Center

Sketch of Monument, Accessories, and General Area

Location & Comments

LAT 43°27'10.55" N

LONG 123°03'05.01" W

For sketch see Attached
Sheet

AREA BURNT
9-2020

Comp. Decline. 19 1/2° E

Agency DCSO

Party Chief S. Flause

Note keeper

Witnesses J. Lorusong

REGISTERED
PROFESSIONAL
LAND SURVEYOR

Ronald A. Quimby

OREGON
JULY 14, 1978
RONALD A. QUIMBY
1654

EXPIRES: 12/31/2022

CS 67/54-5 214

T245, R03W, 400240

6/15/22

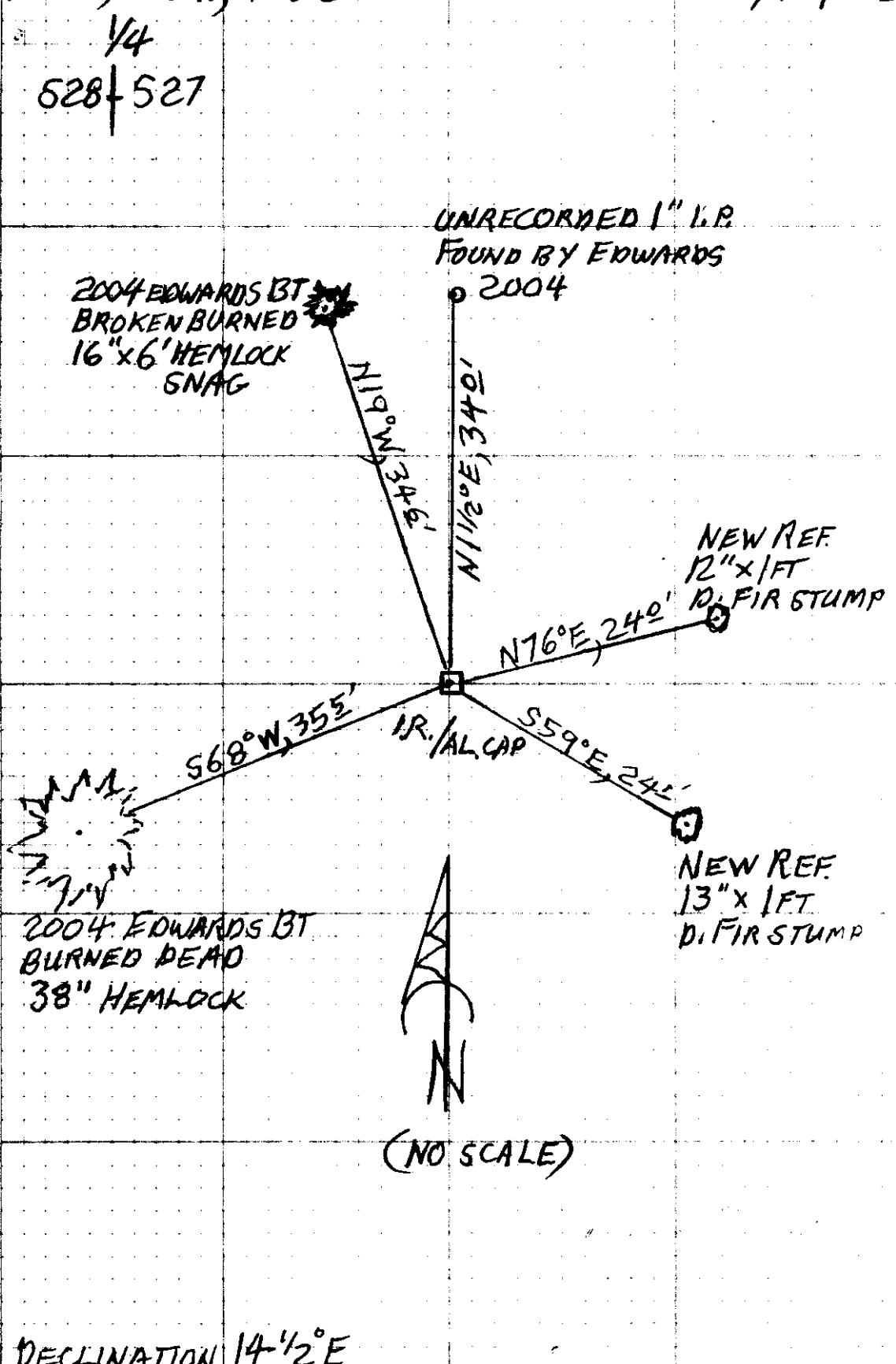

2004 EDWARDS BT
BROKEN BURNED
16" x 6' HEMLOCK
SNAG

UNRECORDED 1" I.P.
FOUND BY EDWARDS

2004

NEW REF.
12" x 1 FT
D. FIR STUMP

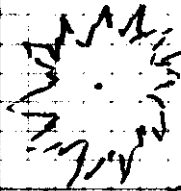

2004 EDWARDS BT
BURNED DEAD
38" HEMLOCK

NEW REF.
13" x 1 FT
D. FIR STUMP



(NO SCALE)

DECLINATION 14 1/2° E

CS 67/54-5
3/4

MM GPS 6/15/22
TIME - 9:55
H.I. - 2.000M

REFRESH 6/15/22

TOWNSHIP 24 RANGE 03 POINT IDENTIFIER # 400240

PRIMARY CORNER DESCRIPTION 1/4 Cor. Secs. 27 & 28

Alias _____	Description _____
Alias _____	Description _____
Alias _____	Description _____
Alias _____	Description _____

GLO survey by L.H. Wheeler under Contract No. 467 dated April 7, 1883 (DCSO records Vol. 7 Page(s) 2994)

Set hemlock post 3 ft. long, 3" sq., 24" in the ground for 1/4 sec. cor. marked 1/4 sec. cor. mkd. 1/4 S on W face from which
A fir, 48" dia., bears N.46°E., 42 lks., mkd: 1/4 S BT.
A fir, 24" dia., bears West 36 lks., mkd: 1/4 S BT.

Douglas Co. Surveyors Office - Vernon "Ray" Tracy - April 1968 - C.S. File 54/27-153

Reported as not found.
Logged & burned many years ago.

David Edwards - For: Roseburg Resources Co. - 12/2004 - M 147-4

Old Weyerhaeuser notes provided by my client regarding the East 1/4 corner call out BTs which do not match the orig. Gov;t. record & the pipe found near my proportionate position was disregarded at said East 1/4 corner:

Found - 1" dia., iron pipe bears N.1°31'41"E., 33.95' PROT 10"
 Set - 5/8"x30" steel rebar with 2" alum. cap stamped per 1973 BLM manual & also stamped "ROSEBURG RESOURCES - PROT 3"
 LS - 2339 - 2004 NOW WEST
 6' Steel posts North & East. BOTH 1/2 FT. DIST.
 36" Hemlock bears S.68°W., 35.5'
 14" Hemlock bears N.19°W., 34.6' ALL SCRIBES VISIBLE
 Note - BTs were scribed according to 1973 BLM manual & measured to center of tree at root crown.

FIRE KILLED 38"
BROKEN BURNED 16"x6" SNAG

DECLINATION 14 1/2° E

NEW REF'S

BURNED SAWN D. FIR STAMP 12"x1 FT 3 1/2" PK TOP CNTR. N 76° E, 240 FT.

BURNED SAWN D. FIR STAMP 13"x1 FT. 3 1/2" PK TOP CNTR S 59° E, 241 FT.

CS 67/54-S
4/4