

GOVERNMENT CORNER RESTORATION FORM

FILED

TOWNSHIP 24S RANGE 3W SEC. 36 PLSS # 6A0100

Date: 8-11-2022 By: X

This survey consists of:

DOUGLAS COUNTY OREGON

DATE 6-7-22

Map: _____

Narrative: _____

Corner Rpt: CS 67/54-2

Corner Designation

1/4 COR S36 T24S
 S1 T25S

DOUGLAS COUNTY
SURVEYOR

Monument(s) Found: (Condition and Source)

___ Condition report

2 1/2" GLO BRASS CAP ON

___ Not Found

1" Iron pipe Proj 8" IN

Renewed

Rough mound of stone

___ Unrecorded

Previous Renewals

___ Surveyed In

GLO dependent Resurvey

1940 Vol 27 pg 11539

DCSD 1966 CS 54/27-129

MONUMENT DETAIL

1/4 S36
 S1

1944

Accessories Found

GLO BEARING Trees

Burned 36" x 3' FIR STUMP N46°W 10.7 FT
(Rec 9.2 FT) FACE BURNT OFF

Burned 34" x 2 1/2' FIR STUMP S81°W 34.3 FT
FACE BURNT OFF.

MT SCO H Lookout bears S40°W

1" Iron pipe S78°W 20 FT 6' TALL

New Accessories

5/8" x 30" Iron Rod S55°E 72.0 FT with yellow plastic cap marked Doug Co. Surveyor Proj 6"

5/8" x 30" Iron Rod S47 1/2°W 17° FT with yellow plastic cap marked Doug Co Surveyor Proj 6"

5/8" x 30" Iron Rod N105°E 32.6 FT with yellow plastic cap marked Doug Co Surveyor Proj 6"

Rough mound of stone around each iron rod

Sketch of Monument, Accessories, and General Area

Location & Comments

LAT 43°25'58.48" N
LONG 122°59'56.25" W

CORNER IS APPROX 100' SOUTH OF LOGGING ROAD INTERSECTION

FOR SKETCH SEE ATTACHED SHEET.

AREA BURNT 9-2020

Comp. Decline. 14 1/2° E
Agency DCSO
Party Chief S F LAUSE
Note keeper
Witnesses J LORSUNG

REGISTERED PROFESSIONAL LAND SURVEYOR

Ronald A. Quimby

OREGON
JULY 14, 1978
RONALD A. QUIMBY
1654

EXPIRES: 12/31/2022

CS 67/54-2

T24S, R03W, 640100

JUNE 7, 2022

1/4	536	T24S, R3W
	81	T25S, R3W

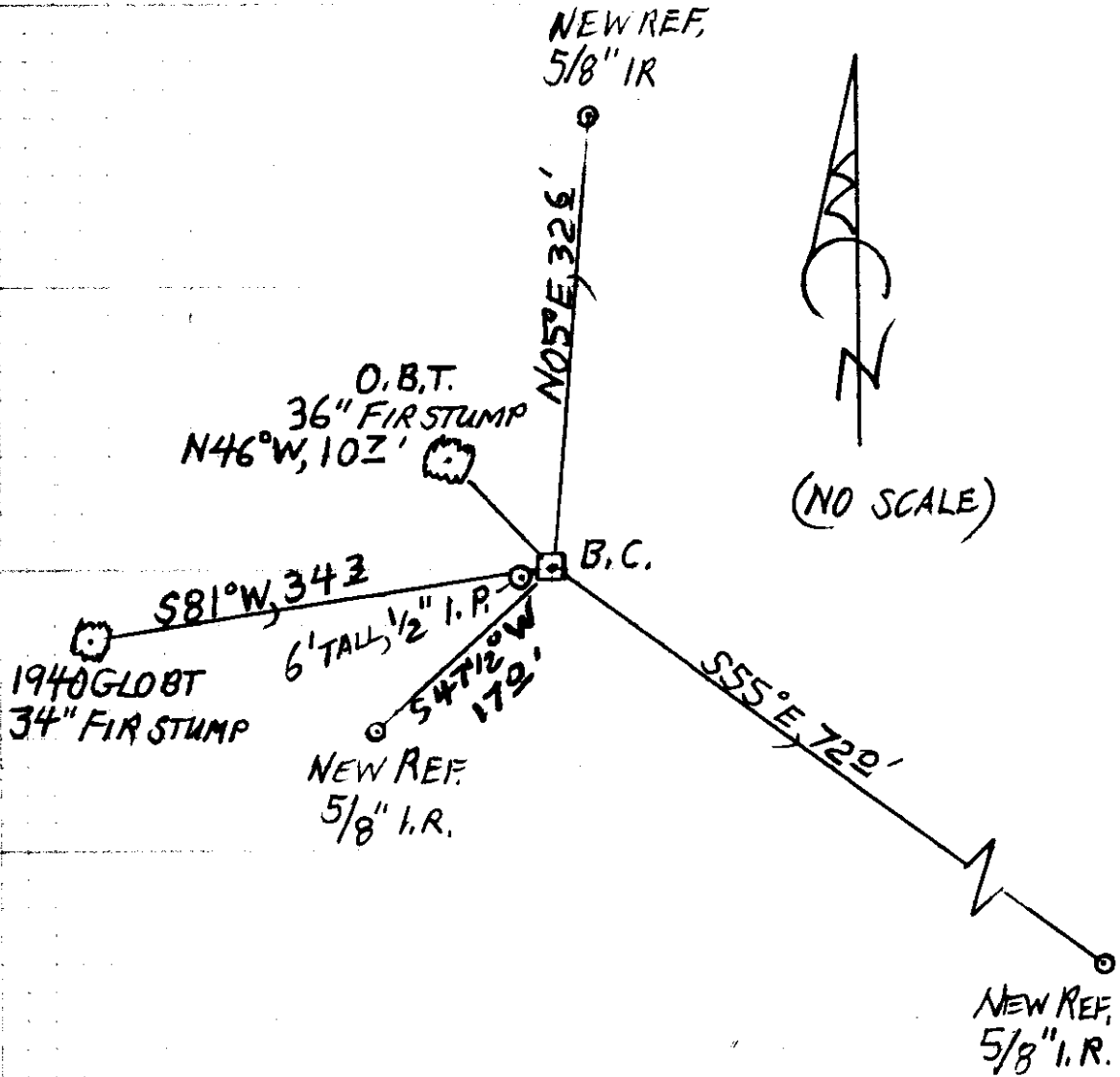

DECLINATION 14 1/2° E

CS 67/54-2
314

MMGPS 6/1/22
TIME - 12:20
N.1. - 2.000 M

MMGA 10/26/21

RENEW 6/7/22

TOWNSHIP 24 RANGE 03 POINT IDENTIFIER # 640100

PRIMARY CORNER DESCRIPTION 1/4 Cor. for Sec. 36; & 1 of T25-3

Alias _____	Description _____
Alias _____	Description _____
Alias _____	Description _____
Alias _____	Description _____

Original - W.H. Byars, Under Contract #152 dated June 3, 1871 (DCSO records, Volume 7 Page 2946)

Set 1/4 sec. post, from which

- A Fir 40" dia. bears N.50°W., 14 lks. dist.
- A Fir 24" dia. bears S.50°E., 44 lks. dist.

GLO Dependent Resurvey by Norman D. Price, Under Special Instructions dated April 5, 1940 (DCSO records, Volume 27 Page 11539)

Point for original 1/4 sec. cor., determined at record measurements from both old bearing trees.

At point for corner, set an iron post 3 ft. long 1" dia., 28" in the ground, with brass cap mkd. $\frac{1}{4}$ S 36

S 1
1944 from which

- A Fir 42" dia., bears N.46°W., 14 lks. dist., with no marks remaining on charred face of old bark blaze. I reblaze and remark this old bearing tree $\frac{1}{4}$ S36 BT.
- A Fir stub 36" dia., bears S.37 1/2°E., 44 lks. dist., mkd. $\frac{1}{4}$ S B T. (Old BT)
- A Fir 46" dia., bears S.81°W., 52 lks., dist., mkd. $\frac{1}{4}$ S 1 BT. (New BT.)

2" GLO CAP MARKED AS DESCRIBED PROT 8" SURROUNDED BY ROUGH MOUND OF STONE

Doug. Co. Surveyors Office - Ray Tracy; Joe Brady; Jack Heritage - July/Aug. 1966 - C.S. File 54/27-129

Found - GLO brass cap mkd. "1/4" 1944". *10Z*

BURNED 36" x 3' 42" now *38"* Fir stump N.46°W., *9.2* ft., face burned rescribe "~~1/4 S36 CS BT~~". *BURNED OFF AGAIN*

BURNED 34" x 2 1/2' 46" now *48"* Fir stump S.81°W., *34√3* ft., burned, no scribe, Rescribe "~~1/4 S 1 CS BT~~". *BURNED OFF AGAIN*

578°W, 2°

Set - *→* 1/2" Iron pipe alongside brass cap 6 ft. above ground.

✓ Corner lies approx. 125 ft. west of logging road on slight SW slope in logged off area. Mt. Scott Lookout bears S.40°W. AND NOW APPROX. 100 FT. SOUTH OF LOGGING RD "Y" INTERSECTION.

NEW REFS

5/8" x 30" I.R. / YELLOW DCSO PLSTC. CAP	PROT. 6"	S 55° E, 72° FT.
"	"	PROT. 6" S 47 1/2° W, 17° FT.
"	"	PROT. 6" N 05° E, 32 1/2° FT.

ROUGH MOUND OF STONE SET AROUND I.R.'S

CS 67/54-2