

GOVERNMENT CORNER RESTORATION FORM

TOWNSHIP 255 RANGE 2W SEC. 29 PLSS # 200200

FILED
Date: 8/11/2022 By: JC
This survey consists of:

DOUGLAS COUNTY OREGON

DATE 5-10-22

Map: _____
Narrative: _____
Corner Rpt: CS 67/52-49

Corner Designation

Sec Cor 30/29
31/32

DOUGLAS COUNTY
SURVEYOR

Monument(s) Found: (Condition and Source)

3/4^{OLD} BRASS CAP ON 2" I.D
Iron pipe Proj 6" ORIGINAL
CORNER Stone ON S.W Edge Proj 3"

Condition report
 Not Found
 Renewed
 Unrecorded
 Surveyed In

Previous Renewals

Mc Chesney 1959 CS 53/112-45
BLM resurvey 1962 Vol 32 pg 13236
BLM resurvey 1972-1975 Vol 36
pgs 15/25-6
BLM Resurvey 1993 Vol 51 pg 19418-9

MONUMENT DETAIL

T255 R2W
530/529
531/532
1962

Accessories Found

ORIGINAL BT
Burnt-Dead 32" FIR N 12 1/2 W 33.7 FT WITH
Fully heated Single BLAZE ADD 3 1/2" PK NAIL
RIGHT Side Center
Brooks BT
Burnt-Dead 29" FIR N 78° E 13.7 FT WITH Fully
heated Single BLAZE ADD 3 1/2" PK NAIL
RIGHT Side Center
Wofford BT'S
Burnt-Dead 26" FIR S 15 1/4 W 62.0 FT (REC
S 17° W) WITH Fully heated Single BLAZE

RENEWAL

Monument Set (Procedure and Description)

MONUMENT DETAIL

New Accessories

Metal LATH 1" EAST

Sketch of Monument, Accessories, and General Area

Location & Comments

LAT 43°21'29.85"N
LONG 122°58'23.03"W
For sketch see attached
sheet.

CORNER IS ON A
SPUR SLOPING
N 20° E
AREA
Burnt 9/2020

Comp. Decline. 14 1/2° E
Agency DCSO
Party Chief S. FLAUSE
Note keeper
Witnesses J. LORSUNG

REGISTERED
PROFESSIONAL
LAND SURVEYOR

Ronald A. Quimby

OREGON
JULY 14, 1978
RONALD A. QUIMBY
1654

EXPIRES: 12/31/2022

CS 67/52-49
216

T25S, R02W, 200200

MAY 10, 2022

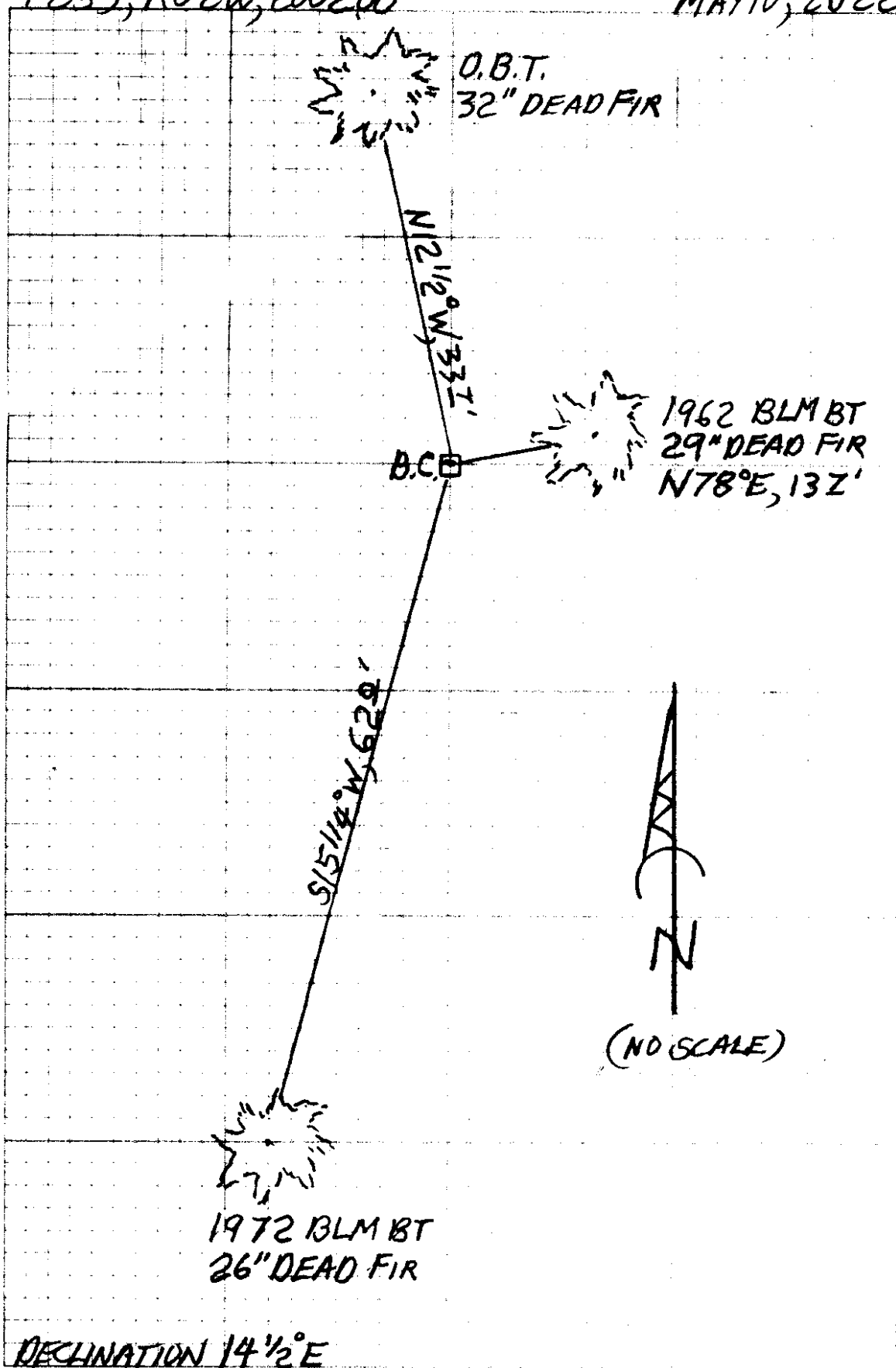

CS 67/SZ-49
316

RENEWED 5/10/22

TOWNSHIP 25 RANGE 02 POINT IDENTIFIER # 200200

PRIMARY CORNER DESCRIPTION Cor. Secs. 29, 30, 31, 32

Alias _____	Description _____
Alias _____	Description _____
Alias _____	Description _____
Alias _____	Description _____

Set an iron post, 28" long, 2½" dia., 22" in the ground with brass cap marked "

3 1/4" I.D. I.P.
BLM MONUMENT

T25S	R2W
S 30	S 29
S 31	S 32

PROT 6"

from which a new bearing tree

ORIGINAL COR. STONE ON SW EDGE

A fir, 20" dia. bears N.78°E., 21 lks. mkd T25S R2W S29 BT

PROT 3"

Deposit the original corner stone alongside the iron post.

BLM dependent resurvey by Daniel L. Berry, Harvey E. Wofford, & G. Steven Popken Cadastral Surveyors & Glenn S. Baughman, LS, under contract #52500-CT5-1116 & Group E 786, 848, & 854, surveyed July 1972/Oct. 1975 - (DCSO records Vol. 36 Page(s) 15125-6)

The cor. of secs. 29, 30, 31, & 32, monumented with an iron post, 2½" dia., firmly set, protruding 6" above ground, with brass cap (properly) mkd.

- from which the remains of the orig. BTs
- A chinquapin snag, 18" dia., bears N.36°E., 36 lks., with no marks visible.
- A chinquapin snag, 15" dia., bears S.44½°E., 33 lks., no marks visible.
- A root hole bears S.13°W., 41. lks., with a down chinquapin alongside, 16" dia., with healed blaze.
- A fir, 25" dia. bears N.12½°W: 51 lks. healed blaze and a BT mkd. by Brooks, in 1962
- A fir, 24" dia., bears N.78°E., 21 lks. with healed blaze. and new BTs
- A hemlock, 15" dia., bears S.3°E., 55 lks., mkd: T25S R2W S32 BT.
- A fir, 15" dia. bears S.17°W. 94 lks. mkd: T25S R2W S31 BT

BLM Dependent resurvey by Wayne Rogers, Cadastral Surveyor & Robert Browning, Surveying Technician, under Group #1659, surveyed June/July 1993 - (DCSO recs Vol. 51 Pages 19418-9)

The cor. of secs. 29, 30, 31, & 32, monumented with an iron post, 2½" dia., firmly set, projecting 2" above ground, with brass cap (properly) mkd. (SEE ABOVE FOR MARKS)

- NO EVID. A decayed chinquapin stump, size indeterminate, bears N.36°E., 36 lks., with decayed remains alongside, no marks visible. ⁸³⁶
- NO EVID. A chinquapin snag, 15" dia., bears S.44½°E., 33 lks., with healed blaze. ^{21 78}
- NO GOOD EVID. A roothole, bears S.13°W., 41 lks., with a down chinquapin alongside, 16" dia., with healed blaze. cont next pg ^{27 06}

MM GPS 5/4/22
TIME - 8:40
H.I. - 2.000M

CS 67/52-49
416

2
OVER →

TOWNSHIP 25 RANGE 02 POINT IDENTIFIER # 200200

PRIMARY CORNER DESCRIPTION Cor. Secs. 29, 30, 31, 32

Alias _____ Description _____
Alias _____ Description _____
Alias _____ Description _____
Alias _____ Description _____

BURNED DEAD ^{33⁷} ~~32~~ fir, 30" dia., bears N.12½°W., 51 lks. with healed blaze ^{ADD 3½" PK RSC} **FHSB**
and a bearing tree mkd. by Brooks ¹³⁰⁶¹³⁷ ~~1306137~~ ^{ADD 3½" PK RSC} **FHSB**
BURNED DEAD 29"-A fir, 26" dia., bears N.78°E., 21 lks., with healed blaze
and remains of BTs mkd by Wofford, Berry, Popken, & Baughman
^{GONE} A sawed hemlock stump, 19" dia., bears S.3°E., 55 lks.,
^{INDISTINCT ROOTHOLE} with partially healed blaze. ^{62^{04V}} ~~62~~ ³⁶³⁰
BURNED DEAD 26"-A fir, 18" dia., bears S.17°W., 94 lks., with healed blaze **FHSB**
and a new bearing tree ^{515¼W} ~~515¼W~~ ²⁶⁴⁰
^{GONE IN RD, CUT} hemlock, 4" dia., bears S.29½°E., 40 lks., mkd. X BT.
The corner is located on a spur, sloping N.20°E.

SET METAL LATH EAST, 1⁰ FT.

CS 67/52-49 3
5/6

Alias _____	Description _____
Alias _____	Description _____
Alias _____	Description _____
Alias _____	Description _____

GLO Survey by Hezekiah H. Johnson, under Contract #721, dated May 1, 1900 (DCSO records Vol. 9 Page(s) 3639)

- Summit of spur, slopes N. Set a basalt stone 16x8x6", 11" in the ground for cor. for cor. of secs. 29, 30, 31, & 32 marked with 1 notch on S & 5 notches on E edges, from which
- A chinquapin, 12" dia., bears N.36°E., 35 lks., mkd: T25S R2W S29 BT.
 - A chinquapin, 9" dia., bears S.44°30'E., 32 lks., mkd: T25S R2W S32 BT.
 - A chinquapin, 8" dia., bears S.13°W., 41 lks., mkd: T25S R2W S31 BT.
 - A fir, 7" dia., bears N.12°30'W., 51 lks., mkd: T25S R2W S30 BT.

Glen McChesney, WEYCO - 8/20/1959 - C.S. File 53/112-45

- Found - Orig. stone with notches
- 14" chinquapin, face rotted, N.37°E., 22.7 ft.
 - 12" chinquapin, scribing visible, face rotted, S.44°E., 21.6 ft.
 - 12" chinquapin, cat faces - not opened, S.13°W., 27.1 ft.
 - 22" fir, cat faces - not opened, N.11°W., 33.7 ft. ADDED "W" nail & plate.
- New -
- 18" Fir N.79°E., 13.0 ft., "W" nail & plate.
 - 9" Hemlock S.4°E., 35.5 ft., "W" nail & plate.
 - 22" Fir S.78°W., 37.5 ft., "W" nail & plate.

BLM dependent resurvey by Floyd A. Brooks, Cadastral Surveyor, under Group #350, surveyed April 1962 -(DCSO records Vol. 32 Page(s) 13236)

The cor. of secs. 29, 30, 31 & 32, monumented with a basalt stone, 16x8x6" firmly set 11" in the ground, marked with 1 notch on the S, & 5 notches on the E edge, from which the original bearing trees:

- A chinquapin, 17" dia., bears N.36°E., 36 lks., with no marks remaining on decayed blaze. (Rec dist 35 lks.)
 - A chinquapin, 14" dia., bears S.44½°E., 33 lks., with fragmentary scribe marks visible on nearly healed blaze. (Record distance, 32 lks.)
 - A chinquapin, 14" dia. bears S.13°W., 41. lks., with a healed blaze.
 - A fir, 21" dia. bears N.12½°W. 51 lks. with a healed blaze
- At the corner point

continued next page