

GOVERNMENT CORNER RESTORATION FORM

FILED

TOWNSHIP 255 RANGE 1W SEC. 1 PLSS # 100607
2W DOUGLAS COUNTY OREGON DATE 4-23-22 700640

Date: 8/11/2022 By: J
This survey consists of:
Map: _____
Narrative: _____
Corner Rpt: CS 67/52-45

DOUGLAS COUNTY
SURVEYOR

Corner Designation

E 1/4 COR Sec 1 only

Monument(s) Found: (Condition and Source)

1951 2 1/2" GLD BRASS CAP
ON 1" ID IRON PIPE PROJ 6"

- Condition report
- Not Found
- Renewed
- Unrecorded
- Surveyed In

Previous Renewals

GLD 1900 Vol 8 3493 AND
3498-99
Hosford 1949-1950 CS 40/279
M 12-61
BLM Re Survey 1951-1963
Vol 32 pg 13340
BLM Re Survey 1981 Vol 45
Pgs 17351-52
Accessories Found

MONUMENT DETAIL

1/4
S 1
1951

White BT'S
Burnt- DEAD 25" Hemlock S29°W 44.1 FT
(Rec 42.6 FT) Healed BLAZE
Hosford BT'S
Burnt DEAD 34" Hemlock S73°W 14.5 FT
To GLO monument (S84°W 14.2 FT To
Hosford monument)
Hosford monument bears S25 1/2° E 2.4
FT

New Accessories

Burnt- DEAD 2" X 30' CEDAR SNAG
N 70° W 26.0 FT Not Blazed or Scribed
3" PK RIGHT SIDE CENTER

5/8" X 30" Iron Rod with yellow Plastic
CAP MARKED Doug Co Surveyor N 06° W
34.0 FT PROJ 8"

Sketch of Monument, Accessories, and General Area

Location & Comments

LAT 43° 25' 26.62" N
LONG 122° 52' 26.76" W

See Attached Sheet
For Sketch

MONUMENT ON
MODERATE EAST
SLOPE 35 FT EAST
OF ROAD

AREA BURNED
9/2020

Comp. Decline. 14 1/2° E

Agency DCSD

Party Chief S. FIAUSE

Note keeper

Witnesses J. LORSUNG

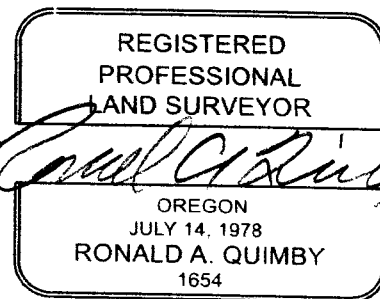

CS 67152-45 215

T25S, R01W, 100607

APRIL 23, 2022

E 1/4 S1, T25S, R2W

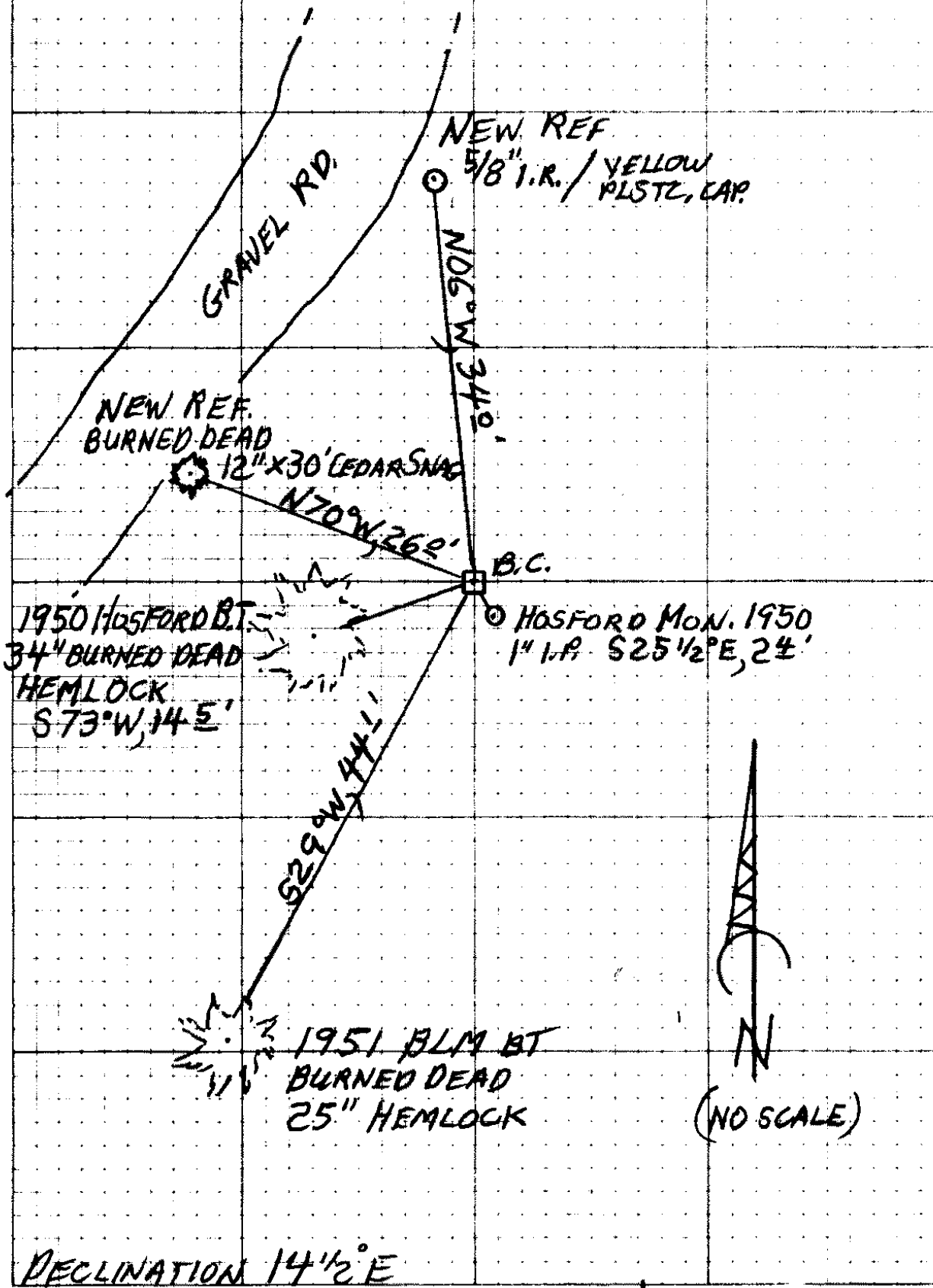

CS 67/52-45
3/5

MM GPS 3/16/22
TIME - 14:08
H.I. - 2.000M

TOWNSHIP 25 RANGE 01 POINT IDENTIFIER # 100607

PRIMARY CORNER DESCRIPTION E. 1/4 Cor. for Sec. 1 only, T25-2

Alias _____	Description _____
Alias _____	Description _____
Alias _____	Description _____
Alias _____	Description _____

GLO survey by John A. McQuinn, Deputy Surveyor, under Contract #466, dated April 5, 1883 (DCSO records Vol. 8 Page(s) 3480-81)

Set Hemlock post 3 ft. long, 3" sq., 24" in ground for 1/4 sec. cor. mkd. 1/4 S on W. face, from which

 A Fir 12" dia., bears S.85°E., 13 lks. dist. mkd. 1/4 S BT.

 A Fir 12" dia., bears N.50°W., 18 lks. dist. mkd. 1/4 S BT.

GLO survey by Hezekiah H. Johnson, Deputy Surveyor, under Contract #721, dated May 1, 1900 - (DCSO records Vol. 8 Page(s) 3493 and 3498-99)

(Page 3493)

Find no trace of any line or corners.

(Pages 3498-99)

Set a basalt stone 16x8x8 ins., 11" in the ground for 1/4 sec. cor. mkd. 1/4 on W. face, from which

 A Fir 18" dia., bears S.63°E., 55 lks. dist. mkd. 1/4 S6 BT.

 A Fir 8" dia., bears S.79°W., 75 lks. dist. mkd. 1/4 S1 BT.

V. W. Hosford, Surveyor - May 1949/Oct. 1950 - C.S. File 40/279 and M 12-61

I Set a 1" I.P. with steel cap, from which

 A Hemlock 14" dia., bears S.84°W., 14.2 ft. mkd. T25S R2W 1/4 S1 P.S. 253 BT.

 A Hemlock 20" dia., bears N.28 1/2°W., 36.4 ft. mkd. T25S R2W 1/4 S1 P.S. 253 BT.

BLM resurvey by Levi E. Tallett and C. Albert White, Cadastral Surveyors, under Group #294, Surveyed May 1951/Aug. 1963 - (DCSO records Vol. 32 Page(s) 13340)

Point for the 1/4 sec. cor., at proportionate distance; there is no remaining evidence of the original corner.

Set an iron post, 36" long, 1" dia., 28" in the ground, with brass cap mkd:

1/4
S 1
1951

from which

 A Hemlock 26" dia., bears N.12°45'W., 49 lks. dist. mkd. 1/4 S1 BT. 32 34

 A Hemlock 16" dia., bears S.28°W., 66 lks. dist. mkd. 1/4 S1 BT. 43 56

(Cont. Next Page)

CS 67/52-45
415 1

RENEWAL 4/23/22

TOWNSHIP 25 RANGE 01 POINT IDENTIFIER # 100607

PRIMARY CORNER DESCRIPTION E 1/4 Cor. for Sec. 1 only, T25-2

Alias	Description

BLM resurvey by James E. Jelley, Cadastral Surveyor, under Group #1061 - Surveyed April/June 1981 - (DCSO records Vol. 45 Page(s) 17351-52)

1951 GLO 2 1/2" BC ON 1" I.D. I.P. MON. FOUND PROT. 18" LEAVING

The 1/4 sec. cor., monumented with an iron post, 1/2" dia. firmly set, projecting 10" above ground with brass cap as mkd. in 1951, from which bearing trees mkd. by White and Tallett:

REFERENCE OUT PLUMB POSITION REMOVE AND RESET DEEPER NOW PROT. 6"

BURNED DEAD 25" GONE NOW IN RD.

A Hemlock 19" dia., bears S. 29° W., 64 1/2 lks. dist. with healed blaze. (Rec. S. 28° W., 66 lks.)
 A Hemlock 28" dia., bears N. 12 3/4° W., 49 lks. dist. with healed blaze.

42 1/2 44 1/2

From this point, a monument established by Hosford, in 1950, bears S. 25 1/2° E., 0.82 chs. dist. monumented with an iron pipe 1" dia., firmly set, projecting 10" above ground from which bearing trees mkd. by Hosford:

BURNED DEAD 34" GONE NOW IN RD.

A Hemlock 23" dia., bears S. 84° W., 21 1/2 lks. dist. with healed blaze. GOOD TO HOSFORD MON.
 A Hemlock 27" dia., bears N. 28 1/2° W., 55 lks. dist. with healed blaze.

S 73° W, 145 ADD 3" PK RSC

NEW B&D FROM GLO MON.

NEW REFS

BURNED DEAD 12" x 30 FT CEDAR SNAG NOT BLZD NOT SCRIB. N 70° W, 26° FT. 3" PK RSC

5/8" x 30" IR/YELLOW PLST CAP PROT 8" BEARS N 06° W, 34 0

MONUMENT ON MODERATE EAST SLOPE APPROX 35 FT. EAST FROM ROAD.

GPS 3/16/22 14:08

DECLINATION 14 1/2° E

C S 67/52-45 515