

GOVERNMENT CORNER RESTORATION FORM

FILED

TOWNSHIP 255 RANGE 2W SEC. 23 PLSS # 600300

Date: 7/20/2022 By: XC

This survey consists of:

DOUGLAS COUNTY OREGON

DATE 3-30-22

Map: \_\_\_\_\_

Narrative: \_\_\_\_\_

Corner Rpt: CS 67/52-3

Corner Designation

DOUGLAS COUNTY SURVEYOR

Sec COR 23/24  
26/25

Monument(s) Found: (Condition and Source)

\_\_\_ Condition report

3 1/4" BRASS CAP IN MOUND  
OK Stone proj 7 in.

\_\_\_ Not Found

Renewed

\_\_\_ Unrecorded

Previous Renewals

\_\_\_ Surveyed In

McChesney 1958 CS 53/112-41  
BLM Resurvey 1962 Vol 32 pg 13216  
BLM Resurvey 1972-1975 Vol  
36 pg 15114  
BLM Resurvey 2001-2002  
Vol 54 pgs 20907-8

MONUMENT DETAIL

T255 R2W

S23/S24  
S26/S25

1962

Accessories Found

ORIGINAL BEARING TREES  
well defined Root Hole S19°W 9.2 FT  
Bearing Trees by Brook 1962  
Mostly burnt 2' tall Cedar stumps S6 1/2°W  
27.7 FT  
BT'S BY SKEE side 2001-2002  
Burnt - SAWN 15" x 2' N 61 1/2° E 32.7 FT (Rec  
N 62 1/4° E 32.6 FT) 3 1/2" PK NAIL TOP CENTER  
BLAZE VISIABLE @ 6" DIAM.  
Burnt-Dead 11" Hemlock S 78 1/2° E 14° FT (Rec  
S 75° E 14.2 FT PK RIGHT SIDE CENTER PARTLY  
healed BLAZE PARTIAL SCRIBE VISIABLE  
15" Burnt-Dead Hemlock S 8° W 33.1 FT (Rec  
S 11 1/2° W 32.8 FT) PARTLY HEALED FACE BURNT AWAY  
BRASS WASHER IN FACE PK NAIL RIGHT  
Side Center

RENEWAL

Monument Set (Procedure and Description)

MONUMENT DETAIL

---



---



---



---



---



---

New Accessories

---



---



---



---



---



---



---



---



---



---

Sketch of Monument, Accessories, and General Area

Location & Comments

LAT.  $43^{\circ}22'23.60''N$   
 LONG  $122^{\circ}53'38.12''W$

FOR SKETCH SEE ATTACHED  
 SHEET

AREA BURN  
9-2020

CORNER IS APPROX  
60' WEST OF  
N-S GRAVEL ROAD  
 Comp. Decline.  $1412^{\circ}E$   
 Agency DCSO  
 Party Chief S F LAUSE  
 Note keeper \_\_\_\_\_  
 Witnesses J. LORSUNG

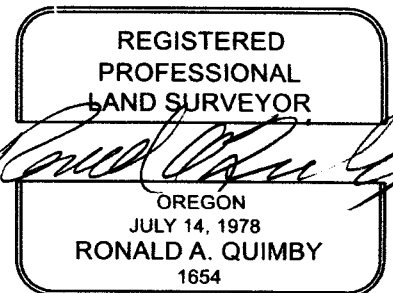

EXPIRES: 12/31/2022

CS 67/52-31  
 215

T25S, R2W, 600300

3/30/22

523	524
526	525



(NO SCALE)

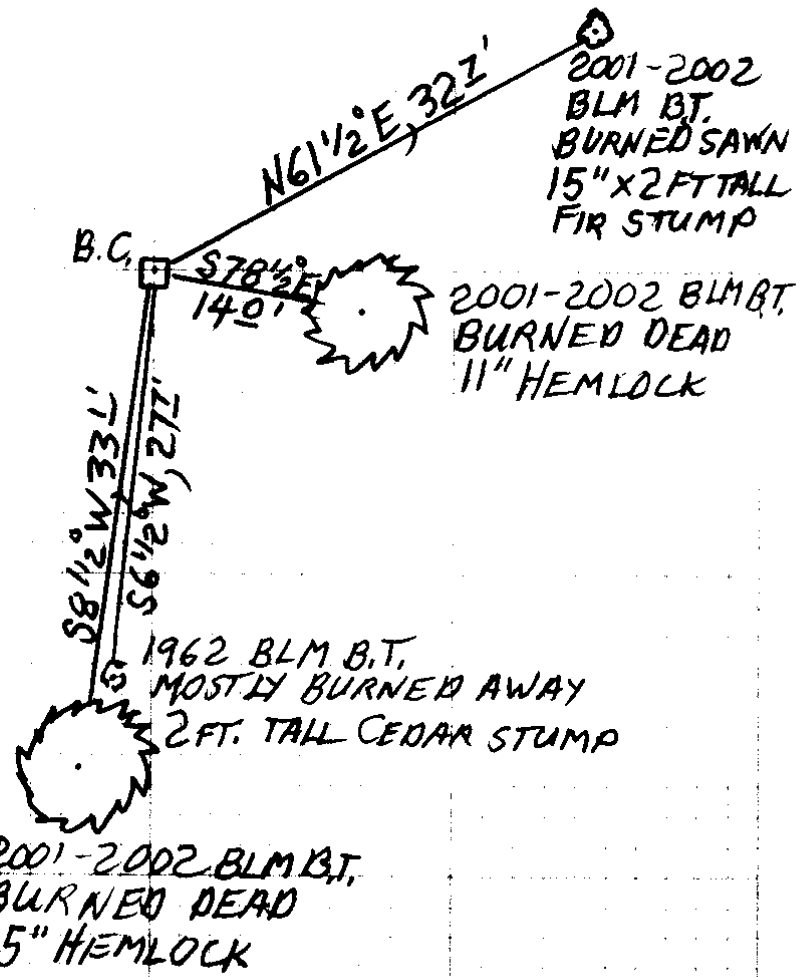

DECLINATION 14 1/2° E

CS 67/52-31  
315

TOWNSHIP 25 RANGE 02 POINT IDENTIFIER # 600300

PRIMARY CORNER DESCRIPTION Cor. Secs. 23, 24, 25, & 26

Alias \_\_\_\_\_ Description \_\_\_\_\_  
 Alias \_\_\_\_\_ Description \_\_\_\_\_  
 Alias \_\_\_\_\_ Description \_\_\_\_\_  
 Alias \_\_\_\_\_ Description \_\_\_\_\_

A hemlock, 28" dia., bears N.28°E., 16 lks., with a healed blaze.

At the corner point

Set an iron post, 28" long, 2½" dia., 22" in the ground, and in a mound of stone, 2 ft. base, to top, with brass cap marked:

T25S R2W  
 S 23 | S 24  
 S 26 | S 25  
 1962

from which new BTs

A hemlock, 40" dia., bears S.87°E., 61 lks., mkd: T25S R2W S25 BT.

A cedar, 24" dia., bears S.6¼°W., 42 lks., mkd: T25S R2W S26 BT.

Deposit the orig. corner stone alongside the iron post.

BLM dependent resurvey by Daniel L. Berry, Harvey E. Wofford, & G. Steven Popken Cadastral Surveyors & Glenn S. Baughman, LS, under contract #52500-CT5-1116 & Group E 786, 848, & 854, surveyed July 1972/Oct 1975 - (DCSO recs Vol. 36 Page 15114)

The cor. of secs. 23, 24, 25, & 26, remonumented by Brooks, in 1962, with an iron post, 2½" dia., firmly set, protruding 4", above ground, with brass cap mkd.

T25S R2W  
 S 23 | S 24  
 S 26 | S 25  
 1962

from which the remaining original bearing trees

A hemlock, 13" dia., bears N.61°E., 75 lks., with scribe mark 2 visible on open blaze.

A hemlock, 13" dia., bears S.19°W., 14 lks., with scribe marks T25S R2W visible on decaying blaze.

A hemlock, 28" dia., bears N.28°W., 16 lks., with healed blaze.

and a bearing tree mkd. by Brooks

A cedar, 25" dia., bears S.6¼°W., 42 lks., with scribe marks T25S R2W S26 BT visible on open blaze.

and a new bearing tree

A hemlock, 8" dia., bears S.59°E., 137 lks., mkd. T25S R2W S25 BT.

BLM resurvey by A. Bert Skeesick, Cadastral Surveyor, Group #1979, surveyed 2001/2002- (DCSO rec. Vol. 54 Pages 20907-8)

3/4" BC

MARKED AS ABOVE

The cor. of secs. 23, 24, 25, and 26, monumented with an iron post, 2½ ins. diam., firmly set, projecting 7 ins. above ground, with brass cap mkd. continued next page

MM GPS 3/30/22  
TIME - 10:30  
H.I. - 2.000M

3/30/22

CS 67/52-31  
415

OVER

3/30/22

TOWNSHIP 25 RANGE 02 POINT IDENTIFIER # 600300

PRIMARY CORNER DESCRIPTION Cor. Secs. 23, 24, 25, & 26

Alias _____	Description _____
Alias _____	Description _____
Alias _____	Description _____
Alias _____	Description _____

T25S R2W  
 S 23 | S 24  
 S 26 | S 25  
 1962

from which the remains of the original bearing trees

*NO EVID. REMAINS*  
*WELL DEFINED*  
*BURNED AWAY STUMP*  
*ROOT HOLE DISTURBED*  
*NOT USEABLE*

*MOSTLY BURNED AWAY*  
*2 FT. TALL*

*BURNED, SAWN 15' x 2' STUMP*

*BURNED DEAD 11"*

*BURNED DEAD 15"*

A hemlock stump, 18" dia., bears S.25°E., 42.6 ft., with healed blaze. (Record, 38.9 ft.)

A roothole, bears S.19°W, 9V2 ft., with sawed & decayed hemlock stump pushed over alongside, no marks visible. *GONE*

A fallen hemlock, 32" dia., bears N.38°W., 10.5 ft., with no marks visible on partially healed blaze. (Record, N.28°W.)

and remains of a bearing tree mkd. by Brooks ✓  
A sawed cedar stump, 34" dia., bears S.6½°W., 27.7 ft., with scribe marks BT visible on partially healed blaze. and new bearing trees

A fir, 6" dia., bears N.62¼°E., 32.6 ft., mkd. T25S R2W S24 BT. *6 1/2 32 7 TOP CNTR, 3 1/2" PK*  
*LOWER PART OF BLZ. VISIBLE AT 6" DIAM.*

A hemlock, 5" dia., bears S.75°E., 14.2 ft., mkd. T25S R2W S25 BT. *BLZ PARTLY HEALED MOSTLY BURNED FAC. SOME PARTIAL SCRIBING*

A hemlock, 7" dia., bears S.11½°W., 32.8 ft., mkd. T25S R2W S26 BT. *PART HEALED 8 1/2 33 L FACE BURNED AWAY*

*ST 8 1/2 E, 140*  
*3 1/2 PK RSC*  
*BRASS WASH IN FACE*  
*3 1/2 PK RSC*

Each new bearing tree has a 2½" x ¼" magnetic nail (Mag Nail) driven at the base right side-center. *THESE WERE NOT AD.*  
 From this point, National Geodetic Survey station "STEAM. 1989" bears S.75°20'40"E., 42,789.90 ft. (mean bearing & sea level), monumented with a brass disk set in concrete, buried 8 ins. below surface of parking area, in a monument well, mkd. OREGON PRIMARY GPS STATION STEAM 1989 and a triangle.

*MONUMENT IS APPROX. 60' WEST FROM N-S RUNNING GRAVEL RD.*  
*DECLINATION 14 1/2° E*