

TOWNSHIP 255 RANGE 3W SEC. 25 PLSS # 100206

Date: 4/14/2022 By: X  
This survey consists of:

DOUGLAS COUNTY OREGON

DATE 2/22/2022

Map: \_\_\_\_\_

Narrative: \_\_\_\_\_  
Corner Rpt: CS 67/52-22

Corner Designation

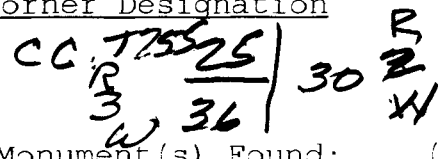

DOUGLAS COUNTY SURVEYOR

Monument(s) Found: (Condition and Source)

2 1/2" GLO BRASS CAP ON  
1 1/2" ID IRON PIPE project  
3"

- Condition report
- Not Found
- Renewed
- Unrecorded
- Surveyed In

Previous Renewals

GLO Survey 1900 Vol 9 Pg 3657-8

DCSD 1929 Vol 1 pg 50

GLO Resurvey 1940 Vol 27 pg 11510

DCSD 1966 CS 5A/27-123

BLM Resurvey 1972-1975 Vol 36

Pg 15111-12

EDWARDS 1998 M128-61

BLM Resurvey 2012 Vol 58 pg 23036-7 1943

Accessories Found

MONUMENT DETAIL

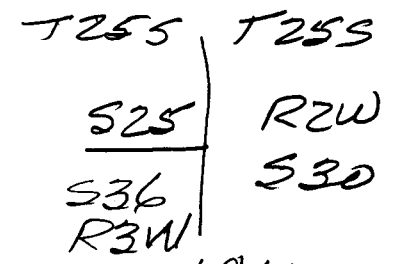

BURNED YEW ROOTS N41°W 25.1 FT

All other BT'S destroyed by FIRE then  
AREA Shovel logged for Power line  
R/W Clearing

New Accessories

5/8" x 30" I Rod with DCSD plastic Cap S 02° W  
43.0 FT projecting 6"

5/8" x 30" I. Rod with DCSD plastic Cap S 73° W  
38.8 FT projecting 6"

28" x 1/2 FT BURNED AND SAWN Stump S 33° W  
61.3 FT 3 1/2" PK Top Center

Sketch of Monument, Accessories, and General Area

Location & Comments

MON. 70'± ON PAVED ROCK  
C.R. ROAD COURSE E-W

AREA BADLY  
BURNED 7-2020

FOR SKETCH SEE ATTACHED  
SHEET

LAT. 43° 21' 34.86" N  
LONG 122° 29' 24.59" W

Comp. Decline. 14 1/2° E

Agency

Party Chief

Note keeper Steve Flouse

Witnesses Jeff Loring

REGISTERED  
PROFESSIONAL  
LAND SURVEYOR

Ronald A. Quimby

OREGON  
JULY 14, 1978  
RONALD A. QUIMBY  
1654

CS 67/52-22

Expires: 12/31/2022

T255, R02W, 100206

2/22/22

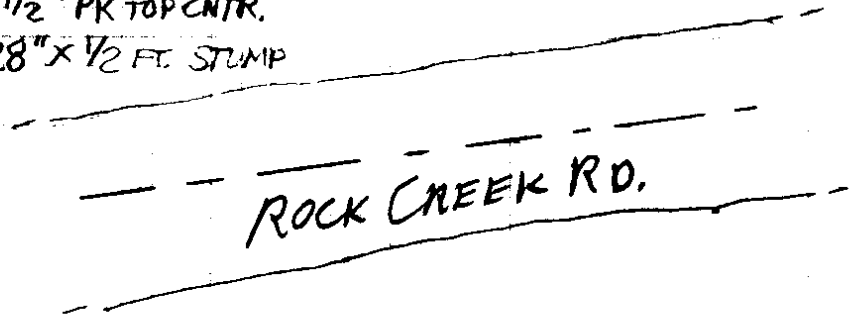
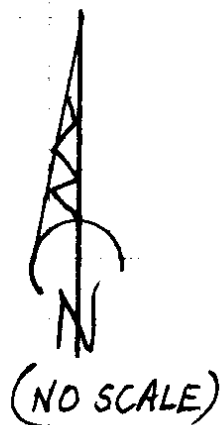
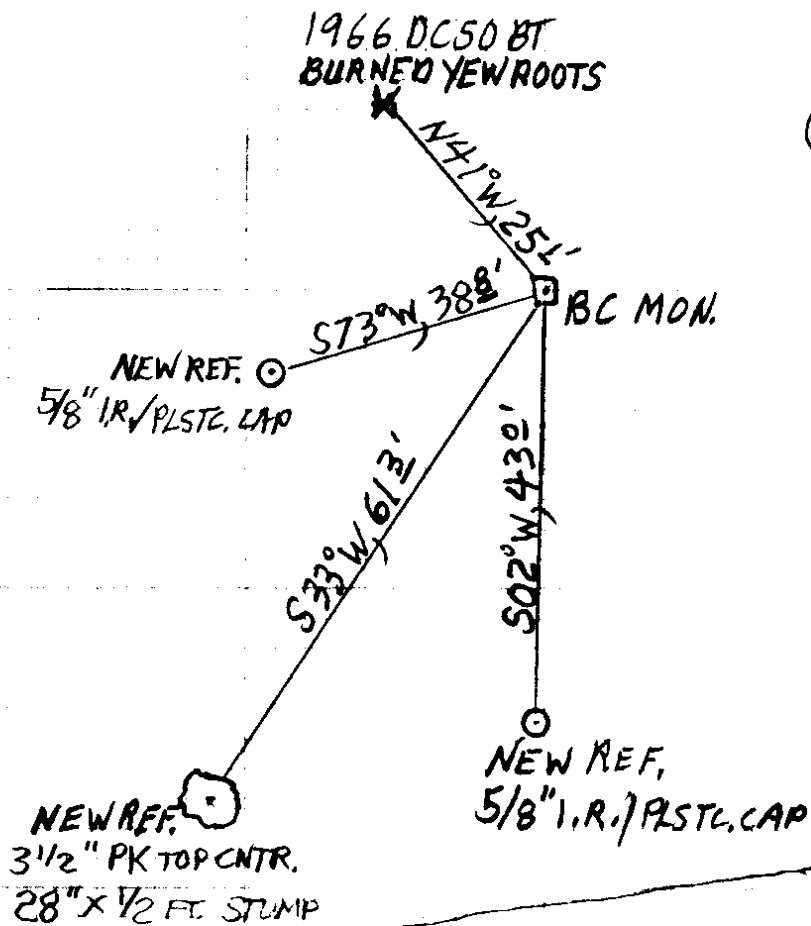

DECLINATION 14 1/2° E

CS 67/52-22

3/7

MMGPS 2/17/22

TIME - 12:00

H.I. - 2,000M

2/22/22

TOWNSHIP 25 RANGE 02 POINT IDENTIFIER # 100206

PRIMARY CORNER DESCRIPTION Section Corner for 25 & 36 only, T25-3

Alias	Description
Alias	Description
Alias	Description
Alias	Description

BLM resurvey by George M. Winter, Cadastral Surveyor under Group No. 2656, surveyed Sept./Nov. 2012 - (DCSO records Vol. 58 Page(s) 23036-7)

The cor. of secs. 25 and 36 only, on the E. bdy. of the Tp., monumented with an iron post, 2" dia., firmly set, projecting 9" above the ground, with brass cap (properly) mkd.

from which the remains of an original bearing tree

NO EVID. A decayed hemlock stump, size indeterminate, bears REMAINS S.67 1/2°E., 27.1 ft., with no marks visible.

and remains of the bearing trees mkd. by Price in 1943-44 NO EVID. A cedar snag, 30" dia., bears S.43°W., 56.8 ft., with REMAINS scribe marks 25S R3W S36 visible on a partially healed blaze.

A root wad, size indeterminate, bears N.39°W., 31.7 ft. SEE BELOW WHY and remains of a BT mkd. by the Douglas Co. Surveyor's Office in 1966

BT. EVID. GONE

BURNED - A yew snag, 6" dia., bears N.41°W., 25.1 ft., with scribe YEW ROOTS marks T25S R3W visible on a partially healed blaze. and BT mkd. by Berry, Wofford, Popken, & Baughman in 1972-75

NO EVID. A white fir, 24" dia., bears S.57 1/4°W., 57.4 ft. with a REMAINS healed blaze. (Record, hemlock, S.55°W.) and a new bearing tree

NO EVID. A hemlock, 16" dia., bears N.14 1/4°W., 13.9 ft., mkd. T25S REMAINS R3W S25 BT. Drive a 2 1/2"x 1/4" magnetic nail (Mag Nail) at the base on right side center.

The geographic position in NAD 1983 (2011) of this cor., as determined by a tie from a temporary Geographic Position System (GPS) control point, established utilizing dual frequency, carrier phase GPS receivers, relative to "DODSON BUTTE CORS ARP", "CAPE BLANCO CORS ARP", and "ROSEBURG COOP CORS ARP", is as follows:

Latitude: 43°21'34.81"N. Longitude: 122°59'25.55"W.

BC MON. ≈ 70' NORTH FROM EAST-WEST RUNNING PAVED ROCK CRK RD.

AREA BURNED THEN SHOVEL LOGGED FOR POWERLINE R/W CLEARING ALL EARLIER REF. EXCEPT NW YEW ROOTS DESTROYED

NEW REFS

5/8" x 30" I.R. / DCSO SET PROT. 6" BEARS - S02°W, 43 1/2 FT. PLSTC. CAP

28" x 1/2 FT BURNED AND SAWN STMP 3 1/2" PA TOP CNR S 33°W, 61 1/2 FT

5/8" x 30" I.R. / DCSO SET PROT. 6" BEARS - S73°W, 38 1/8 FT PLSTC. CAP

DECLINATION 14 1/2°E

CS 67152-22 417

2 1/2" GLO BC ON 1 1/2" I.D. 1" PROT. 3" MARKED AS DESCRIBED 1940 GLO SURV.

PRIMARY CORNER DESCRIPTION Section Corner for 25 & 36 only, T25-3

Alias \_\_\_\_\_ Description \_\_\_\_\_  
Alias \_\_\_\_\_ Description \_\_\_\_\_  
Alias \_\_\_\_\_ Description \_\_\_\_\_  
Alias \_\_\_\_\_ Description \_\_\_\_\_

Original - Laban H. Wheeler, Under Contract #467 dated April 7, 1883 (DCSO records, Volume 9 Page 3585-6 & 3669)

-----  
Set Hemlock post 4 ft. long 4" sq., 24" in the ground for corner to secs. 25, 30, 31 and 36 marked T25S S30 on NE., R2W S31 on SE., R3W S36 on SW., S25 on NW faces with 5 notches on N and 1 notch on S edges, from which

A Fir 60" dia. bears N.30°E., 44 lks. dist., marked T25S R2W S30 BT.

A Yew 12" dia. bears S.35°E., 33 lks. dist., marked T25S R2W S31 BT.

A Fir 36" dia. bears S.51°W., 50 lks. dist. marked T25S R3W S36 BT.

A Cedar 10" dia. bears N.61°W., 44 lks. dist. marked T25S R3W S25 BT.

-----  
GLO Survey of Exterior boundaries of T25-2 by Hezekiah H. Johnson, under Contract #721 dated May 1, 1900 (DCSO records Volume 9 Page 3657-8)

-----  
(In the survey of T25S R2W where closing corners were set on exterior lines, the marks on all old section corners were destroyed which referred to the sections bounded by the closing lines)

The cor. of secs. 25 and 36, which is a post 4" sq. from which

A Fir 8" dia. bears N.69°E., 27 lks dist. marked T25S R2W S30 BT.

A Fir 10" dia. bears S.66°E., 41 lks. dist., marked T25S R2W S31 BT.

A Fir 12" dia. bears S.49°W., 58 lks. dist. marked T25S R3W S36 BT.

A Fir 14" dia. bears N.62°W., 31 lks. dist. marked T25S R3W S25 BT.

-----  
H.L. Eppstein, Co. Surveyor Wit: N.E. Richardson; Larkin Rice January 1929 - "Old" Corner Renewal book Vol. 1 Page 50

-----  
Set corner from Fir tree, scribe marks plain for the S. & E., rest burned out. This tree was probably old tree in Sec. 30 The other trees were all down but evidence of cut marks on same but no scribe mark. I set a Yew wood post for corners and marked:

A 10" Fir S.80°W., 5.5 ft.

A 6" Fir N.15°W., 15.0 ft.

(Cont. Next Page)

PRIMARY CORNER DESCRIPTION Sec. Cor. for 25 & 36 only, T25-3

Alias \_\_\_\_\_ Description \_\_\_\_\_  
 Alias \_\_\_\_\_ Description \_\_\_\_\_  
 Alias \_\_\_\_\_ Description \_\_\_\_\_  
 Alias \_\_\_\_\_ Description \_\_\_\_\_

GLO Dependent Resurvey by Norman D. Price under Special Instructions dated April 5, 1940 (DCSO records, Volume 27 Page 11510)

-----  
 Note: After careful investigation, it is developed that Johnson's recorded retracement of this line is entirely fictitious, that it is a deliberate fabrication on his part for the purpose of justifying his own work and creating a limiting boundary for T25S R2W and is therefore rejected as a suitable basis for restoration of lost corners referring to T25S R3W" (From Volume 27 Pg. 11509)

The original sec. cor. which now refers to secs. 25 and 36 only, a basalt stone, 10x8x8 ins. firmly set in a small ring of stone, mkd. with 5 chaining pin scratches on N. and one chaining pin scratch on S. face. At point for corner, set an iron post, 3 ft. long, 2" dia. 28" in the ground, with the original stone deposited at the base, for cor. of secs. 25 and 36, with brass cap mkd.

T25S	T25S
S25	R2W
S36	S30
R3W	

1943 from which

- A D. Fir 14" dia. bears N.69°E., 27 lks. dist., on which I uncover and efface the inscription T25S R2W S30 BT which I find beneath 60 years overgrowth. (A Wheeler BT)
- A hemlock 14" dia. bears S.67½°E., 41 lks. dist., on which I uncover and efface the inscription T25S R2W S31 BT which I find beneath 60 years overgrowth. (A Wheeler BT)
- A Hemlock 12" dia. bears S.51½°W., 58 lks. dist., on which I uncover the scribe marks BT beneath 60 years overgrowth. (A Wheeler BT)
- A Hemlock 24" dia. bears N.61¼°W., 31 lks. dis., with old blaze healed. (A Wheeler BT)
- A Red Cedar 30" dia. bears S.43°W., 86 lks. dist. mkd. T25S R3W S36 BT. (New BT)
- A White Fir 12" dia. bears N.39°W., 48 lks. dist., mkd. T25S R3W S25 BT. (New BT)

Douglas Co. Surveyors Office - Vernon Tracy; Joe Brady; Jack Heritage - June 1966 - C.S. File 54/27-173

-----  
 (Cont. Next Page)

TOWNSHIP 25 RANGE 02 POINT IDENTIFIER # 100206

PRIMARY CORNER DESCRIPTION Sec. Cor. for 25 & 36 only, T25-3

Alias _____	Description _____
Alias _____	Description _____
Alias _____	Description _____
Alias _____	Description _____

Found - 1943 GLO brass cap.  
Orig. 24" Hemlock N.61¼°W., 20.5 ft., alive, shows scar.  
Other orig. BTs are now snags or gone.  
30" now 32" R.Cedar S.43°W., 56.8 ft., scribe visible on unhealed blaze. Tree alive & in good condition.  
12" now 16" W.Fir snag, N.39°W., 31.7 ft. shows good scar.  
No trace of BTs recorded by Eppstein.  
New BT - 6" yew N.41°W., 25.4 ft. mkd. T25S R3W S25 CS BT.  
This corner lies 50 ft. north of Rock Creek Road, course E-W.

BLM Dependent Resurvey by Berry; Wofford; Popken and Glenn S. Baughman under Contract #52500-CT5-1116 Under special instructions dated June 1972. Survey July 1972-Oct. 1975 (DCSO records, Volume 36 Pages 15111-12)

-----  
The cor. of secs. 25 and 36 only, monumented with an iron post 2" dia. firmly set, protruding 8" above ground with brass cap. from which the remains of the original bearing trees:

A decayed fir snag 14" dia. bears N.69°E., 27 lks. dist., no marks visible.

A decayed Hemlock stump 16" dia. bears S.67½°E., 41 lks. dist., no marks visible.

A root hole bears S.51½°W., 58 lks. dist., with a down hemlock alongside 16" dia., no marks visible.

A root hole bears N.61¼°W., 31 lks. dist. with a down hemlock alongside, 30" dia., no marks visible.

and the remains of bearing trees mkd. by Price:

A Red Cedar snag 34" dia. bears S.43°W., 86 lks. dist. with scribe marks T25S R3W S36 BT visible on open blaze.

A W.Fir snag 14" dia. bears N.39°W., 48 lks. dist., with healed blaze.

and a bearing tree mkd. by the County Surveyor:

A Yew 6" dia. bears N.41°W., 38 lks. dist., with scribe marks visible on open double blaze.

and a new bearing tree

A Hemlock 15" dia. bears S.55°W., 87 lks. dist., mkd. T25S R3W S36 BT.

Fd. Ok by D.Edwards, 4/1998 - M128-61

continued next page

CS 67/52-22 7/7