

TOWNSHIP 255 RANGE 2W SEC. 13 PLSS # 600400

Date: 4-13-2022 By: X
This survey consists of:

DOUGLAS COUNTY OREGON

DATE 2-1-22

Map: _____

Narrative: _____

Corner Rpt: CS67 | 52-13

Corner Designation

Sec cor 14 | 13
23 | 24

DOUGLAS COUNTY
SURVEYOR

Monument(s) Found: (Condition and Source)

___ Condition report

___ Not Found

Renewed

___ Unrecorded

___ Surveyed In

3/4" BLM BRASS CAP
1 3/4" ID IRON PIPE ALONGSIDE

Previous Renewals

Hosford 1955 CS 42/20
Hosford 1957 CS 42/308
BLM RESURVEY 1962 Vol 32 pg 1308
DCSO 1995 CS 64/58-10
BLM RESURVEY 2001/2002
Vol 54 pg 20910-2

MONUMENT DETAIL

T255 R2W
514 | 513
523 | 524

Accessories Found

- BURNT 12" X 3 1/2 FT D. FIR STUMP N12°W 13.9 FT
BLAZE burnt out
- BURNT 24" X 3' D. FIR STUMP N31°E 25.4 FT
Healed single blaze
- BURNT 4" X 3 FT D. FIR STUMP S9 1/2°E 15.5 FT
BLAZE BURNT OFF
- BURNT 12" X 8' D. FIR STUMP S65 1/2°E 21.5 FT TO
P.K SIDE CENTER (REC 212) Healed BLAZE
- BURNT 24" X 9' D. FIR STUMP S9°W 27.7 FT
Healed Double BLAZE PK ADDED Right side Center
- BURNT SAWN 17" X 6" TALL D. FIR N71 1/2°W (Rec
N71°W 25.7 FT ADDED P.K Right side Center
- BURNT 4" X 7' FIR SNAQ N77°E 10.5 FT
BLAZE BURNT

Monument Set (Procedure and Description)

MONUMENT DETAIL

New Accessories

5/8" I. Rod inside 3/4" ID Iron pipe
N 52°E 26.9 FT

17" x 1 FT. Tall Cedar Stump 3 1/2" PK Top
Center N 21°W 34.2 FT

Sketch of Monument, Accessories, and General Area

Location & Comments

See Attached Sheet

Area bad /
Burnt 9/2020

Lat 43° 23' 15.97 N
Long 122° 53' 37.58 W

Comp. Decline. 14 1/2° E
Agency DCSO
Party Chief S. FIAUSE
Note keeper
Witnesses J. LORSUNG

REGISTERED
PROFESSIONAL
LAND SURVEYOR

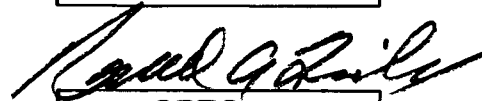

OREGON
JULY 14, 1978
RONALD A. QUMBY
1854

CS 67/52-13

Expires: 12/31/2022

T25S, R02W, 600400

2/1/22

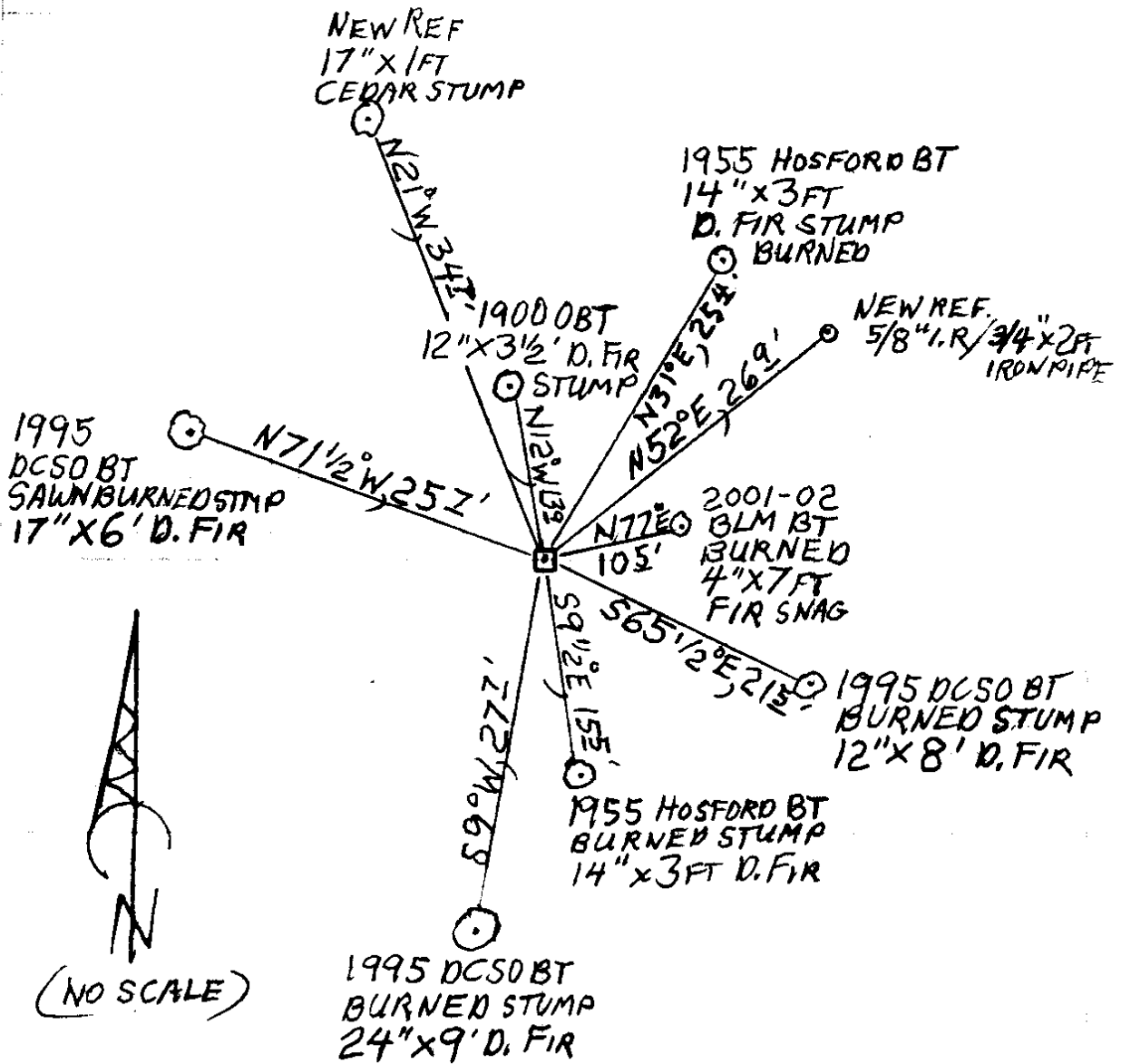

DECLINATION 14 1/2° E

CS 67/52-13

3/6

MM GPS TIME - 13:50
4.1. - 2.000M

2/1/22

TOWNSHIP 25 RANGE 02 POINT IDENTIFIER # 600400

PRIMARY CORNER DESCRIPTION Cor. Secs 13, 14, 23, & 24

Alias _____	Description _____
Alias _____	Description _____
Alias _____	Description _____
Alias _____	Description _____

A fir, 15" dia., bears N.31°E., 38½ lks., with a pitched over blaze.
 A fir, 18" dia., bears S.9½°E., 21½ lks., with a pitched over blaze.
 A fir, 10" dia., bears S.52°W., 28 lks., with a pitched over blaze.

At the corner point
 Set an iron post, 28", long, 2 1/4" dia., 24", in the ground with brass cap marked
 T25S R2W
 S 14 | S 13 ✓
 S 23 | S 24
 1962

from which a new bearing tree
 A fir, 14" dia, bears N.57°E., 79 lks., mkd T25 R2W S13 BT
 Reset iron pipe alongside the iron post.

Douglas County Surveyors Office - Randall Smith & Stephen Flause - Mar. 29, 1995 - C.S. 64/58-10

Found - ^{3 1/4"}~~2 1/2"~~ dia BLM brass cap on a 2 1/2" O.D. Iron pipe protrudes 5" above ground (1962 BLM).
 1 3/4" I.D. iron pipe protruding 14" above ground is found along east edge of BLM BC/IP.
 - SEVERELY BURNED 12" x 3 1/2' 6" now 20" dia 5' high D.Fir stump with fully healed - BLZ. GONE
 blaze, bears N.18°W., 18.9' (agrees with rec) OBT
 - NOW BURNED 12" now 14" dia 3' high D.Fir stump with fully healed single blaze, bears N.31°E., 24.4' (agrees with rec.)
 - NOW BURNED 14" x 3 FT 14" now 20" dia 3 1/2' high D.Fir stump with fully healed single blaze, bears S.9½°E., 13.5' (rec. S.9½°E., 14.2') BURNED OFF
 BURN TO GRND. 9" now 9" dia, 20' high D.Fir snag with fully healed double blaze, bears S.52°W., 17.8' (rec. S.52°W., 18.5' measured to trunk) ROOT ROUND
 BURN NO EVID. 14" now 14" dia. 3' high D.Fir stump, scribing found "T25S" lower blaze is healed, bears N.57°E., 52.1' (agrees with rec.)
 BURN NO EVID. NEW 7" dia. Hemlock, double blazed & scribed "T25S R2W S13 CS BT", bears N.59°E., 30.1'.
 - BURNED 12" x 8 FT. STUMP 7" dia. D.Fir, double blazed & scribed "T25S R2W S24 CS BT", bears S.65°E., 21.2' 21.5 AND 3 1/2" PK, RSC FIKSB
 - BURNED STMP. 24" x 9 FT. 22" dia. D.Fir, double blazed & scribed "T25S R2W S23 CS BT", bears S.6°W., 27.7', (old line blazes on north and south trunk) ADD RSC PK FHADB
 - SAWN BURNED STMP 17" x 6" TALL 4" dia. D.Fir, double blazed & scribed "X BT" bears, BLZ. GONE
 N.71°W., 25.7'. RSC PK
 7 1/2"

* continued next page FOR FOUND BTs

NEW REF 7/8" ID 3/4" KD. x 2 FT. IRON PIPE N 52° E , 26 9 FT 2

17" x 1 FT TALL CEDAR STMP, 3 1/2" PK TOP CNTR. N 21° W , 34 2 FT CS 67/52-13 416

PRIMARY CORNER DESCRIPTION Cor. Secs. 13, 14, 23, & 24

Alias _____	Description _____
Alias _____	Description _____
Alias _____	Description _____
Alias _____	Description _____

BLM resurvey by A. Bert Skeesick, Cadastral Surveyor Group #1979, surveyed 2001/2002- (DCSO rec. Vol. 54 Pages 20910-2)

The cor. of secs. 13, 14, 23, & 24, monumented with an iron post, 2½" dia., firmly set, projecting 6" above ground, with brass cap mkd.

T25S R2W
S 14 | S 13
S 23 | S 24
 1962

from which the remains of an original bearing tree

A decayed fir stump, 21" dia., bears N.12°W., 13.9 ft., with healed blaze.

and remains of bearing trees mkd. by Hosford, in 1955, reported by Brooks

A fir stump, 16" dia., bears N.31°E., 25.4 ft., with healed blaze.

A fir stump, 18" dia., bears S.9½°E., 16.6 ft., with healed blaze. (Record, 14.2 ft.)

A fir snag, 9" dia., 20 ft. high, bears S.52°W., 18.5 ft., with healed blaze.

and remains of a bearing tree mkd. by Brooks

A fir stump, size indeterminate, bears N.59°E., 52.1 ft., with no marks visible. (Record, N.57°E.)

and remains of bearing trees mkd. by Smith & Flauser, in 1995

A dead hemlock, 8" dia., bears N.59°E., 30.1 ft., with scribe marks T25S R2W S13 CS BT visible on unhealed double blaze.

A fir, 9" dia., bears S.65½°E., 21.2 ft., with healed double blaze.

A fir, 23" dia., bears S.9°W., 27.7 ft., with healed double blaze.

A fir, 6" dia., bears N.71°W., 25.7 ft., with healed double blaze.

and new bearing tree

A fir, 6" dia. bears N.71°E. 10.5 ft. mkd. T25S R2W S13 BT

A steel pipe, 4" dia., projecting 28" above ground, is alongside the iron post.

Each new bearing tree has a 2½"x ¼" magnetic nail (Mag Nail) driven at the base right side-center.

SEVERLY DAMAGED
4" X 7 FT SNAG

BLZ GONE

TOWNSHIP 25 RANGE 02 POINT IDENTIFIER # 600400

PRIMARY CORNER DESCRIPTION Cor. Secs. 13, 14, 23, & 24

Alias _____	Description _____
Alias _____	Description _____
Alias _____	Description _____
Alias _____	Description _____

GLO Survey by Hezekiah H. Johnson, under Contract #721, dated May 1, 1900 (DCSO records Vol. 9 Page(s) 3597)

Set a fir post 3 ft. long, 4" sq. , 24" in the ground for cor. of secs. 13, 14, 23 & 24 marked T25S S13 on NE, R2W S24 on SE, S23 on SW, & S14 on W faces, with 3 notches on S & 1 notch on edges, from which,

A chinquapin, 6" dia., bears N.57°E., 28 lks., mkd: T25S R2W S13 BT.

A fir, 6" dia. bears S.65°E., 14 lks. mkd: T25S R2W S24 BT

A fir, 4" dia. bears S.59°W., 23 lks. mkd: T25S R2W S23 BT

A fir, 6" dia. bears N.12°W., 21 lks. mkd: T25S R2W S14 BT

V.W. Hosford - Oct. 13, 1955 - C.S. File 42/20

Only 1 orig. BT remains.

I set a 3" fir post marked S13, S14, S23 & S 24 from which I mark new BTs as follows:

A fir 12" dia., bears N.32°E. 25.4 ft. marked S 13 253 BT.

A fir 14" dia. bears S8°E., 16.0 ft. marked S24 253 BT.

A fir 9" dia., bears S.54°W., 19.0 ft, marked S23 253 BT.

Orig. fir BT, now 15" in dia., bears N.12°W., 21 lks.

V.W. Hosford - Sept. 1957 - C.S. File 42/308

Before logging only the NW BT remained alive, the SE bearing was a dead snag with scribing visible, the other 2 BTs were not found.

After logging in section 13, 23, & 24 only the NW BT remains. At the true point of the corner I drove a 1½" iron pipe 36" long 18" in the ground, from which:

A Fir 12" in dia., bears N.32°E., 25.4 ft. mkd S13 253 BT.

A Fir 14" in dia., bears S.8°E., 16.0 ft. mkd S24 253 BT.

A Fir 9" in dia, bears S.54°W., 19.0 ft. mkd S23 253 B.T.

A Fir 15" dia, bears N.12°W., 15 lks. (orig BT not re-marked)

BLM dependent resurvey by Floyd A. Brooks, Cadastral Surveyor, under Group #350, surveyed April 1962 -(DCSO records Vol. 32 Page(s) 13218)

The cor. of sees. 13, 14, 23, and 24, perpetuated and recorded by V. W. Hosford in 1957, monumented with an iron pipe, 36" long, 1½" dia., firmly set, 18" in the ground, from which the original bearing tree:

A fir, 20" dia., bears N.12°W., 21 lks. with healed blaze. and bearing trees marked by Hosford
continued next page

CS 67/52-13

616