

TOWNSHIP 26S RANGE 3W SEC. 22 PLSS # 500300

Date: 4/12/2022 By: X
This survey consists of:

DOUGLAS COUNTY OREGON

DATE 1-20-22

Map: _____

Narrative: _____

Corner Rpt: 67/52-7

DOUGLAS COUNTY
SURVEYOR

Corner Designation

See Cor 522/523
527/526

Monument(s) Found: (Condition and Source)

___ Condition report

___ Not Found

Renewed

___ Unrecorded

___ Surveyed In

3/4" BLM BRASS CAP ON 2"

I.D Iron pipe projecting 8"

Previous Renewals

Flint 1882 Vol 10 pg 4388

BLM Resurvey 1972-1975

Vol 37 pg 15398

Hoffine 1995 M 122-80

BLM Resurvey 2009 Vol 57 pg 22704

MONUMENT DETAIL

T26S R3W

522/523

527/526

1972

Accessories Found

Down burnt 27" D. FIR N47'14" E 86.5 FT TO
Root Hole

Burnt SAWN 20" X 7 FT FIR STUMP N53°14'N
17.8 FT with healed single blaze

Monument Set (Procedure and Description)

MONUMENT DETAIL

New Accessories

Burnt 20" D. Fir N35°E 27.5 FT To 4" MAG Nail RT Side Center No blaze or scribe

27" burnt Maple S35°W 23° FT No BLAZE OR Scribe 4" MAG Nail RT Side Center

Sketch of Monument, Accessories, and General Area

Location & Comments

See Attached Sheet

AREA Burnt
9-2020

LAT 43°17'09.75"N
LONG 123°01'47.87"W

Comp. Decline 14 1/2°
Agency DCSO
Party Chief S. Flouse
Note keeper
Witnesses J. Lorusung

REGISTERED
PROFESSIONAL
LAND SURVEYOR

Ronald A. Quimby

OREGON
JULY 14, 1978
RONALD A. QUIMBY
1654

Expires: 12/31/2022

CS 67152-7 214

T26S, R03W, 500300

1/20/21

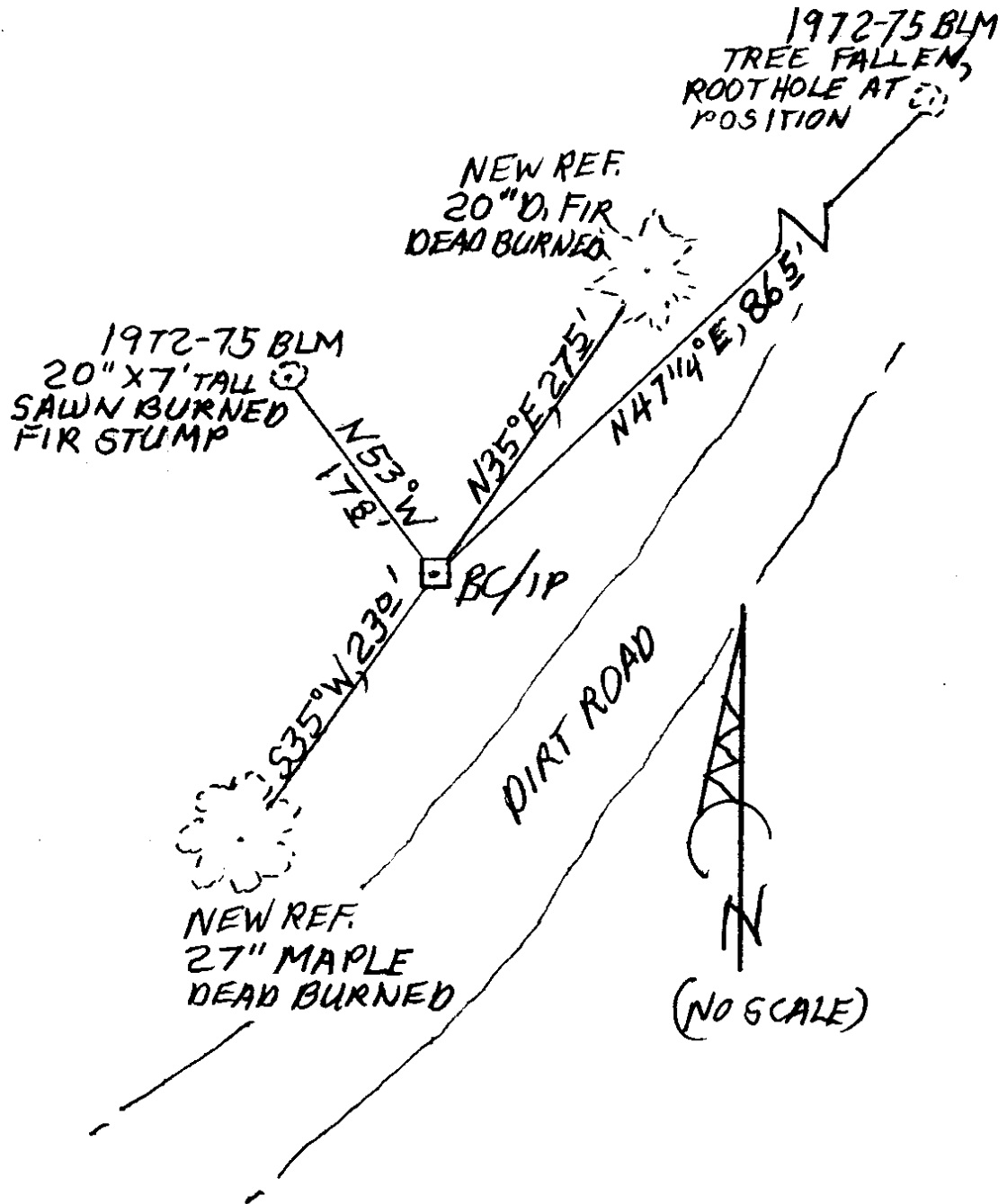

DECLINATION 14 1/2° E

CS 671 52-7
314

1/20/22

PRIMARY CORNER DESCRIPTION Sec. Cor. for 22, 23, 26 & 27

Alias _____	Description _____
Alias _____	Description _____
Alias _____	Description _____
Alias _____	Description _____

Original - L.L. Williams & A.R. Flint, Under Contract #151 dated May 23, 1871 (DCSO records, Vol. 10 Pg. 4377)

Set Laurel post to cor., from which
 A Laurel 13" dia., bears N.80°E., 50 lks. dist.
 A Laurel 11" dia., bears S.60°E., 37 lks. dist.
 A Laurel 12" dia., bears S.25°W., 20 lks. dist.
 A Laurel 14" dia., bears N.75°W., 37 lks. dist.

Found and tied by Samuel C. Flint, June 19, 1882 Under Contract #454 (DCSO records, Vol. 10 Page 4388)

BLM of Land Management Resurvey by Berry; Popken; and Carlson, Under Group #768 Survey, June 1972-April 1975 (DCSO records, Vol. 37 Page 15398)

Point for the cor., at proportionate distance; there is no remaining evidence of the original corner.
 Set and iron post, 28" long, 2 1/2" dia., 24" in the ground, with brass cap mkd.

T 26 S R 3 W
 S 22 | S 23 ✓
 S 27 | S 26
 1972
 3 1/4 BC PRO
 ON 2" IN IR 8"

from which
 A Fir 13" dia., bears N.52°E., 131 lks. mkd. T26S R3W S23 BT.
 A Fir 8" dia. bears S.30°E., 23 lks. mkd. T26S R3W S26 BT
 A Fir 16" dia. bears S.85°W., 93 lks mkd T26S R3W S27 BT
 A Fir 6" dia., bears N.61°W., 27 lks mkd T26S R3W S22 BT

Found OK, Oct. 1995 by Hoffine - M122-80

BLM Dependent Resurvey by A Bert Skeesick, Cadastral Surveyor and Robert H Browning, Survey Tech, Under Group No. 2268, Surveyed July/Nov. 2009 - DCSO records Vol. 57 Page(s) 22704

The cor. of secs. 22, 23, 26, and 27, monumented with an iron post, 2 1/2" dia., firmly set, projecting 11" above the ground, with brass cap (properly) mkd.

from which BTs mkd. by Berry, Popken, and Carlson in 1972-75
 A fir, 25" dia., bears N.47 1/4°E., 88.5 ft. with a healed blaze. FHSB Record, N.52°E.) - TO ROOT/HOLE
 A fir, 23" dia., bears S.30°E., 15.2 ft w/a healed blaze
 A fir, 26" dia., bears S.85°W., 61.4 ft w/a healed blaze
 A fir, 19" dia., bears N.51°W., 17.8 ft w/a healed blaze FHSB

NEW REFS

20" DEAD BURNED D. FIR NOT BLZD NOT SCRBD. N 35° E, 27.5 FT. TO RSC 4" MAG
 27" DEAD BURNED MAPLE " " S 35° W, 23° FT. " 1

DECLINATION 14 1/2° E

NM GPS
 TIME - 11:02
 H.I. - 2.000M

BURNED FALLEN
 IN RD. GONE
 GONE - ONLY BURNED
 ROOTS IN LOCATION
 SAW BURNED STMP 20" X 7 FT TALL
 53°

CS 67/52-7 4/4