

GOVERNMENT CORNER RESTORATION FORM

FILED

TOWNSHIP 25S RANGE 3W SEC. 5 PLSS # 200606

Date: 4/12/2022 By: X  
This survey consists of:

DOUGLAS COUNTY OREGON

DATE 1-22

Map: \_\_\_\_\_

Narrative: \_\_\_\_\_

Corner Rpt: CS 67/52-3

DOUGLAS COUNTY  
SURVEYOR

Corner Designation

Sec. COR 6/5  
7/8

- Condition report
- Not Found
- Renewed
- Unrecorded
- Surveyed In

Monument(s) Found: (Condition and Source)

BLM BRASS CAP projecting  
6"

Previous Renewals

BLM Resurvey 1944 Vol 27  
pg 11601

DCSD 1966 CS 54/27-46  
Edwards 2001 M 136-33  
KANG. 2001 M 138-6 CS  
65/37-56.

MONUMENT DETAIL

T25S R3W  
56/55  
57/58  
1944

Accessories Found

29'x6' FIR Broken & Burnt Stump S84 1/2° E  
54.5 (Rec 54.9) To 4" mag nail side center  
32" x 5" SAW Burnt Fir Stump S57 1/2° W 49.0 FT  
BLAZE Burnt out  
Burnt Rotted Root Hole N65 1/2° E 32.6 FT

Evidence Gove

10" Burnt-Dead Fir snag N59°W 27.7 FT  
Fully Healed blaze

Alum post along side Cor.

3 Steel Post N-E-S

Unrecorded 5/8" I. Rod with post along  
side N4°W 54.3 FT

C.S. File 67/52-3

\_\_\_\_\_

\_\_\_\_\_

\_\_\_\_\_

\_\_\_\_\_

\_\_\_\_\_

\_\_\_\_\_

New Accessories

\_\_\_\_\_

\_\_\_\_\_

\_\_\_\_\_

\_\_\_\_\_

\_\_\_\_\_

\_\_\_\_\_

\_\_\_\_\_

\_\_\_\_\_

\_\_\_\_\_

\_\_\_\_\_

Sketch of Monument, Accessories, and General Area

Location & Comments

Corner is on steep S.E  
Slope approx 200' Easterly  
of Ridge Road  
See Attached Sheet  
LAT 43°25'20.84" N  
LONG 123°05'16.09" W

AREA BURNED  
9-2020

Comp. Decline. 14 1/2° E  
Agency \_\_\_\_\_  
Party Chief S. FIAUSE  
Note keeper \_\_\_\_\_  
Witnesses J. LORSUNG

REGISTERED  
PROFESSIONAL  
LAND SURVEYOR

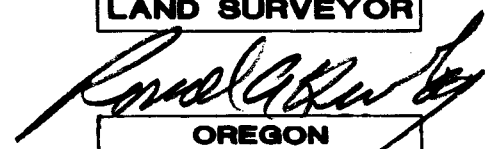

OREGON  
JULY 14, 1978  
RONALD A. QUMBY  
1054

CS 67/52-3

Expires: 12/31/2022

1/5/22

T25S, R03W, 200600

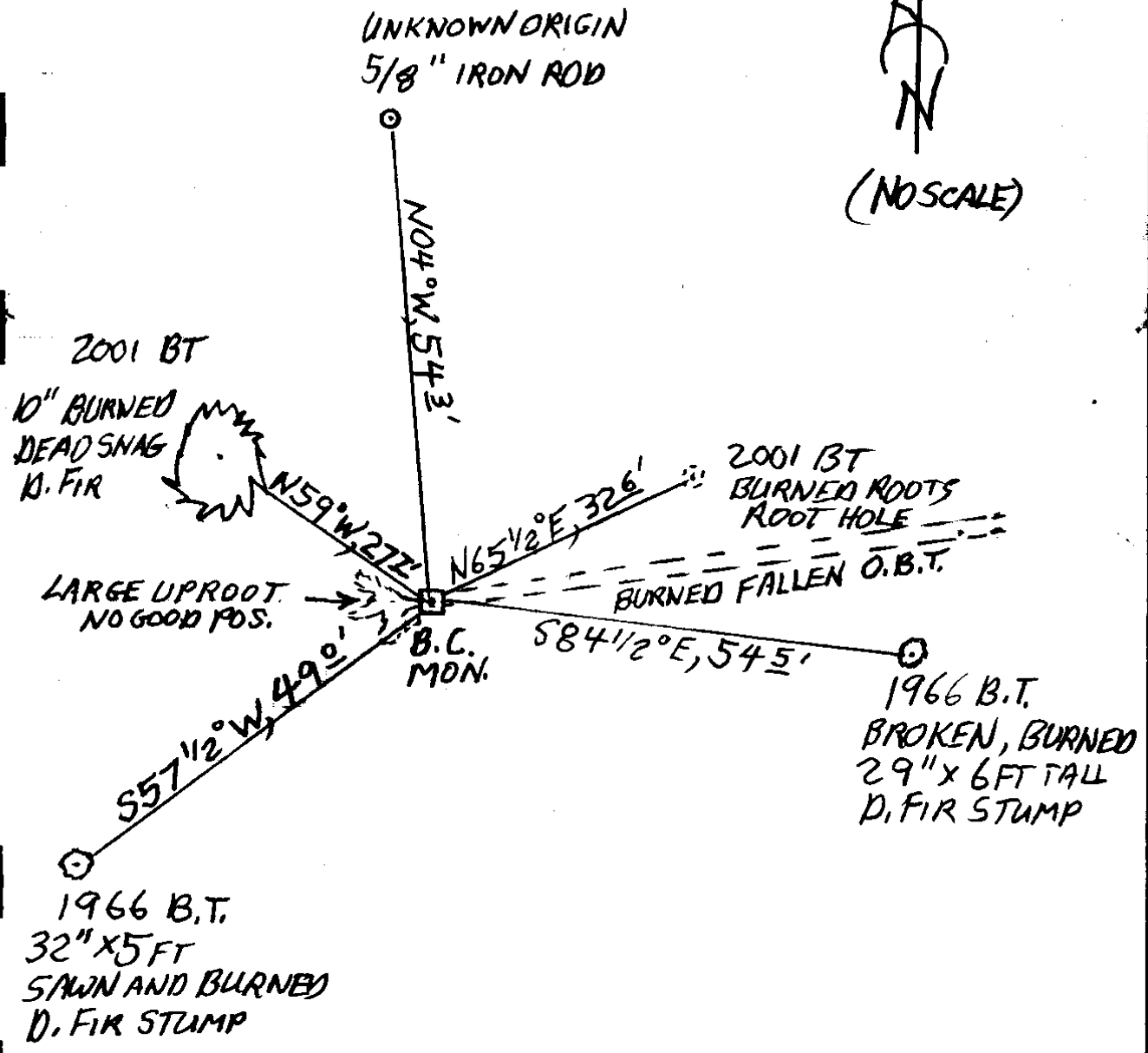
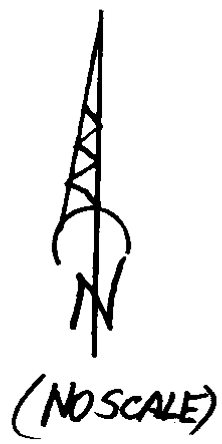

CS 67/52-3 3/5

1/5/22

TOWNSHIP 25 RANGE 03 POINT IDENTIFIER # 200600

PRIMARY CORNER DESCRIPTION Sec. Cor. 5, 6, 7 and 8

Alias	Description

Found - GLO brass cap mkd. 1944 with steel fence post alongside.  
 Orig. 18" now 20" Fir S.73½°W., 9.9 ft., shows old scar. Do not open. (Rescribe "T25S R3W S7 CS BT".  
 All other BTs now stumps.  
 New BTs - 16" D.Fir S.59°W., 49.3 ft. mkd. T25S R3W S7 CS BT.  
 18" D.Fir S.84°E., 55.3 ft. mkd. T25S R3W S8 CS BT.  
 No other trees available.  
 This corner lies on steep SE slope, cut off in Sec. 8.

Found OK by D. Edwards, Jan. 2001 - M136-33

Greg Lang - For: Seneca Jones Timber Co. - April 2001 - M 138-6 & C.S. File 65/37-5G

*54 5 124" MAG CGS*  
*FND BURIED 6"*  
 Found - 1944 BLM brass cap properly mkd. *NOW PROT. 5"*  
*BROKEN BURNED STMP 29" x 6 FT.* 30½" Fir bears S.84½°E., 54.9 ft. Tracy. Set spike *EVID GONE*  
*FALLEN BURNED, OUT OF ROOT* at the base of the tree & placed new tag *FACE BURNED*  
 12" bears S.72½°W., 10.7 ft. Wheeler. Set spike *BLAZE BURNED OUT*  
*SAWN BURNED 32' x 5'* in the base of the tree & placed new tag. *IND E. 10.*  
 26" Fir bears S.5V½°W., 49.0 ft. Tracy. Set spike in the base of the tree & placed new tag. *IND E. 10.*  
 New BTs - 9½" D.Fir bears N.65½°E., 32V6 ft. scribed "T25S R3W S5" "BT" Set spike in the base of the tree & placed new tag. *EVID GONE MELTED TAG*  
*NEW ROTTED FIR ROOTS & HOLE*  
*10" (DEAD) BURNED SNAG* 8½" D.Fir bears N.59°W, 27V7 ft. scribed "T25S R3W S6" *FULLY HEALED*  
 "BT" Set spike in the base of the tree & placed new tag. *TAG GONE*  
 Set Alum. post at corner. *3 STEEL POSTS N, E, S*  
 Note - Corner is on steep SE Slope approx. 200 ft. easterly of ridge road

MMGPS 1/5/22  
START - 9:55  
H.I. - 2.000M

NEW UNRECORDED REF  
5/8" I.R PROT 8" - 1104°W, 54 3/4 FT.  
WITH METAL LATH  
≈ 1' NORTH

TOWNSHIP 25 RANGE 03 POINT IDENTIFIER # 200600

PRIMARY CORNER DESCRIPTION Sec. Cor. for 5, 6, 7 and 8

Alias \_\_\_\_\_ Description \_\_\_\_\_  
Alias \_\_\_\_\_ Description \_\_\_\_\_  
Alias \_\_\_\_\_ Description \_\_\_\_\_  
Alias \_\_\_\_\_ Description \_\_\_\_\_

Original, Laban H. Wheeler, Under Contract #467 dated April 7, 1883 (DCSO Records, Volume 9 Pages 3724-25)

-----  
Set Cedar post 4" sq., 4 ft. long, 24" in the ground for sec. cor. to secs. 5, 6, 7 and 8, mkd. T25S S5 on NE., R3W S8 on SE., S7 on SW., and S6 on NW. faces, with 5 notches on E. edges, from which

- A Dogwood 6" dia., bears N.30°E., 40 lks. dist., mkd. T25S R3W S5 BT.
- A Fir 20" dia., bears S.41°E., 13 lks. dist., mkd. T25S R3W S8 BT.
- A Fir 18" dia., bears S.74°W., 15 lks. dist., mkd. T25S R3W S7 BT.
- A Fir 18" dia., bears N.26°W., 16 lks. dist., mkd. T25S R3W S6 BT.

GLO Dependent Resurvey by Norman D. Price, Under Special Instructions dated April, 5, 1940. (DCSO records, Volume 27 Page 11601)

-----  
Point for original cor. of secs. 5, 6, 7, and 8, determined by reference to the record measurements from the old SE., SW., and NW. bearing trees.

At point for corner, set an iron post, 3 ft. long, 2" dia., 28" in the ground for cor., with brass cap mkd. T25S R3W

S6	S5
S7	S8
1944	

from which

- A Fir 40" dia., bears S.40°E., 13 lks. dist., with blaze healed. I re-blaze and re-mark this old bearing tree T25S R3W S8 BT.
- A Fir 18" dia., bears S.73½°W., 15 lks. dist., with blaze healed. (Old BT)
- A Fir 18" dia., bears N.18°W., 16 lks. dist., with partial scribe marks visible on portion of old blaze which has been previously uncovered. (Old BT)
- A Fir 30" dia., bears N.2 3/4°E., 74 lks. dist., mkd. T25S R3W S5 BT. (New BT)

Doug. County Surveyors Office - Vernon Tracy; Jack Heritage August 1966 - C.S. File 54/27-46

-----  
(Cont. Next Page)

CS 67/52-3 5/5