

TOWNSHIP 265 RANGE 2W SEC. \_\_\_\_\_ PLSS # 500560

Date: 4/12/2022 By: X  
This survey consists of:

DOUGLAS COUNTY OREGON

DATE 12-08-21

Map: \_\_\_\_\_

Narrative: \_\_\_\_\_

Corner Rpt: CS 67/52-2

Corner Designation

N 1/16 S10/S11

DOUGLAS COUNTY  
SURVEYOR

Monument(s) Found: (Condition and Source)

\_\_\_ Condition report

\_\_\_ Not Found

Renewed

\_\_\_ Unrecorded

\_\_\_ Surveyed In

3/4" BLM BRASS CAP ON

Iron pipe Projecting 6" IN

Previous Renewals Rough stone mound

SET by Rogers 1969 M 38-25

BLM Resurvey 1993 Vol 53

pg 19752

MONUMENT DETAIL

Accessories Found

24" x 4' TALL BURNED D. FIR STUMP N 34<sup>3</sup>14° W  
15 1/2 FT ADD 4" MAG NAIL RT SIDE CENTER

22" x 3 FT TALL BURNED FIR STUMP S 55° E 48.2 FT  
To Added 4" MAG NAIL RT SIDE CENTER WITH  
FULLY HEATED BLAZE

A 1/2" Iron pipe with Alum CAP MARKED  
PROPERTY CORNER M 16-68 by Lecklider IN  
1969 BEARS S 7 1/2° E 9.8 FT FROM WHICH A  
28" x 9 FT PIPE SNAG N 45 1/2° E 29° FT  
W/S SCRIBES E 40 1/16 S11 THIS SAME SNAG  
BEARS N 64'14° E 24.4 FT FROM 1993 BRASS  
CAP

C.S. File 67/52-2

Monument Set (Procedure and Description)

MONUMENT DETAIL

---



---



---



---



---



---

New Accessories

---



---



---



---



---



---



---



---



---



---



---



---



---



---



---



---



---



---



---



---



---



---

Sketch of Monument, Accessories, and General Area

Location & Comments

See attached sheet

Area burnt  
9-2020

LAT 43° 19' 29.00" N

LONG 122° 54' 45.69" W

Comp. Decline. 14 1/2° E  
 Agency DCSO  
 Party Chief S. F. House  
 Note keeper \_\_\_\_\_  
 Witnesses J. Korsunov

**REGISTERED  
 PROFESSIONAL  
 LAND SURVEYOR**

*Ronald A. Qumby*

**OREGON  
 JULY 14, 1978  
 RONALD A. QUMBY  
 1654**

CS 67/52-2

Expires: 12/31/2022

T26 S, R 2 W, 500560

12/8/21

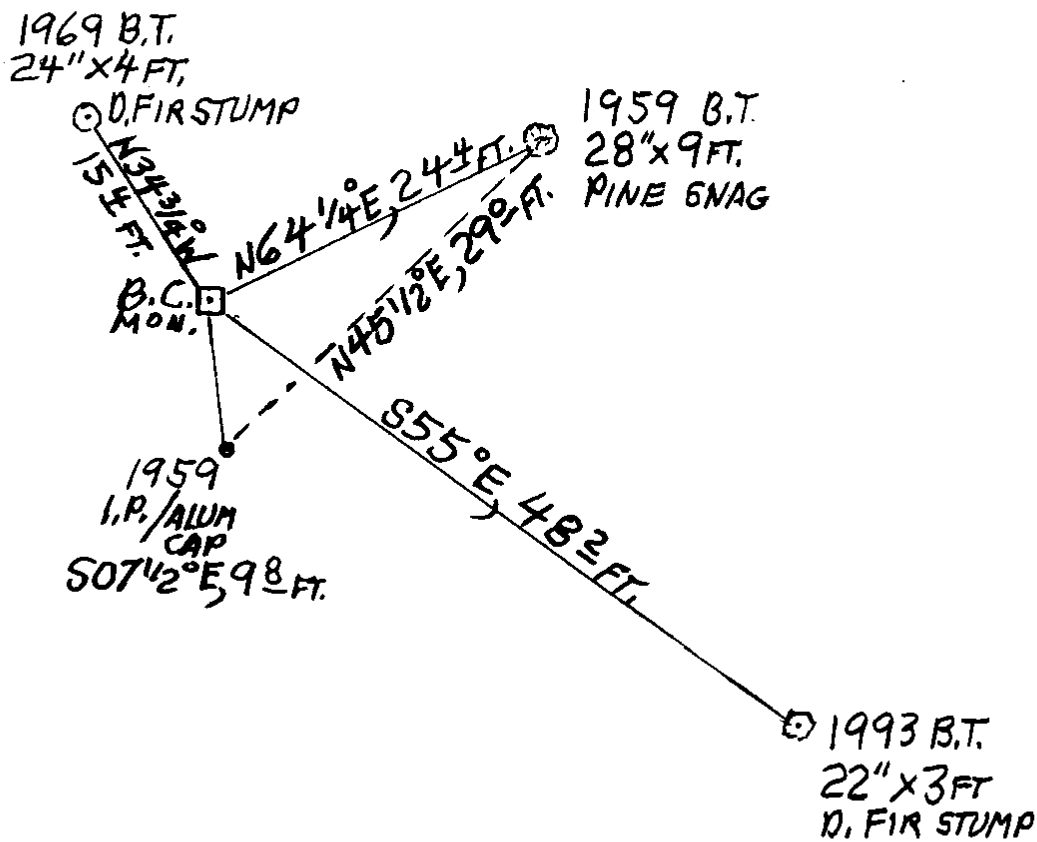
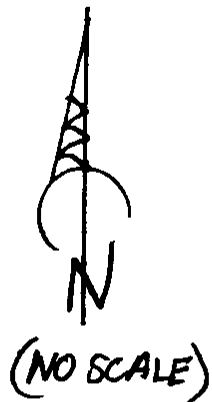

CS 67/52-2  
314

DECLINATION 14 1/2° E

MM GPS

TIME - 10:05

H.I. - 0.8200M

Dependent Resurvey of a Portion of the Subdivisional Lines,  
T. 26 S., R. 2 W., Willamette Meridian, Oregon

CHAINS	
20.080	<p>The N 1/16 sec. cor. of secs. 10 and 11, established by Bruce R. Rogers, Registered Land Surveyor No. 660, in 1969, recorded in the Douglas County Surveyors Office map file No. M38-25, and is accepted as the corner; monumented with an iron rod, 3/4 in. diam., firmly set, projecting 8 ins. above ground, from which the remains of bearing trees mkd. by Rogers:</p> <p><b>NOT SEEN</b> roothole, bears N. 29° E., 44 lks. dist.</p> <p><b>NOW A BURNED D. FIR STUMP</b> fir, 15 ins. diam., bears N. 34 3/4° W., 23 lks. dist., with a healed blaze. <b>ADD RSC 4" MAG NAIL</b></p> <p><b>24" X 4 FT TALL</b></p> <p>At the corner point</p> <p>Set a stainless steel post, 28 ins. long, 2 1/2 ins. diam., 24 ins. in the ground, with brass cap mkd.</p> <p style="text-align: center;">3 1/4" B.C. N 1/16 S 10   S 11 1993</p> <p style="text-align: right;"><b>MARKED AS DESCRIBED</b> <b>PROT. 6" IN ROUGH STONE MOUND.</b></p> <p>from which a new bearing tree</p> <p><b>NOW A SAWN, BURNED BUT SOLID</b> A fir, 15 ins. diam., bears S. 55° E., 73 lks. dist., mkd. N 1/16 S11 BT. <b>NOW FHSB</b></p> <p><b>22" X 3 FT. TALL D. FIR STUMP</b></p> <p style="text-align: right;"><b>48 3/4 FT.</b> <b>ADD RSC 4" MAG NAIL</b></p> <p>Deposit a white "DEEP-1" magnetic marker at base and iron rod inside of stainless steel post.</p> <p>From this point, a point established as the N 1/16 sec. cor. of secs. 10 and 11, by G. R. Lecklider, Registered Engineer No. 4079, in 1959, recorded in the Douglas County Surveyors Office Map File No. M16-68, bears S. 7° 36' 00" E., 0.149 chs. dist., monumented with <u>an iron pipe, 1/2 in. diam., firmly set, projecting 8 ins. above ground, with an aluminum cap mkd. Property Corner, from which the remains of bearing trees mkd. by Lecklider:</u></p> <p><b>VERY BURNED</b> A pine, 38 ins. diam., bears N. 45 1/2° E., 44 lks. dist., with healed blaze. <b>FACE NOW EXPOSED</b></p> <p><b>28" X 9 FT. PINE SNAG</b></p> <p style="text-align: right;"><b>29 1/2 FT.</b> <b>ALSO BEARS</b></p> <p><b>GONE</b> — A sawed fir stump, 17 ins. diam., bears S. 83 1/2° W., 45 lks. dist., with fragmentary scribe marks visible on open upper blaze and healed lower blaze.</p> <p style="text-align: right;"><b>N 64 1/4° E 24 1/2 FT FROM 1993 I.S.C. MON.</b> <b>AGREES WITH COMPUTED LOCATION</b></p> <p>This point is not properly positioned and is not utilized in this survey.</p> <p style="text-align: center;">_____</p> <p>N. 0° 22' 30" E., beginning new measurement.</p> <p>Ascend over a SE. slope.</p>
20.075	<p>The cor. of secs. 2, 3, 10, and 11, monumented with an iron post, 2 1/2 ins. diam., firmly set, projecting 4 ins. above ground, and in a collar of stone, 3 feet diam., with brass cap mkd.</p>