

GOVERNMENT CORNER RESTORATION FORM

TOWNSHIP 25S RANGE 2W SEC. 526 PLSS # 520200

FILED
Date: 4/11/2022 By: X
This survey consists of:

DOUGLAS COUNTY OREGON

DATE 12-7-21

Map: _____

Narrative: _____

Corner Rpt: CS 67/51-38

Corner Designation

W 1/16 526
535

DOUGLAS COUNTY
SURVEYOR

Monument(s) Found: (Condition and Source)

___ Condition report

___ Not Found

Renewed

___ Unrecorded

___ Surveyed In

2 1/2" BRASS CAP ON

I. Pipe

Previous Renewals

Set by JULIANO 1973

M 51-27

BLM Resurvey pg 15117

MONUMENT DETAIL

T25S R2W

W 1/16 526
535

1973

Accessories Found

15" X 12' FIR SWAG N 21 1/2 E 3.6 FT TO SPIKE

20" X 7' BURIED FIR SWAG S 10 W 10.3 TO SPIKE

(REC 10.4)

10" X 6' BURNT STUMP N 33 1/2 E 22.1 FT

19" BURNT FIR SWAG S 23 1/2 W 18.5 FT HEALED

SCAR

C.S. File 67/51-38

14

New Accessories

5/8" IR inside 3/4" I.D. x 23" Iron pipe in Rough mound of stone bears
S 60°E 58.0 ft.

Burnt 8" Dead Hemlock, healed Hi-Lo blaze S 85 1/4° W 11.4 ft
June 2010 BLK Tag

9" x 6 ft burnt Fir snag not blazed or scribed S. 36° E 11.4'

21" burned dead D. Fir Possible healed blaze N 80° W 2.2 ft

Sketch of Monument, Accessories, and General Area

Location & Comments

See Attached Sheet

LAT 43° 21' 28.66" N

LONG 122° 54' 30.23" W

AREA burnt

9 - 2020

Comp. Decline. 14 1/2° E

Agency DC SO

Party Chief S. F. AUSE

Note keeper

Witnesses J. LORSUNOY

**REGISTERED
PROFESSIONAL
LAND SURVEYOR**

Ronald A. Gumbly

**OREGON
JULY 14, 1978
RONALD A. GUMBY
1654**

Expires: 12/31/2022

CS 62151-38

T25S, R2W, 520200

12/7/21

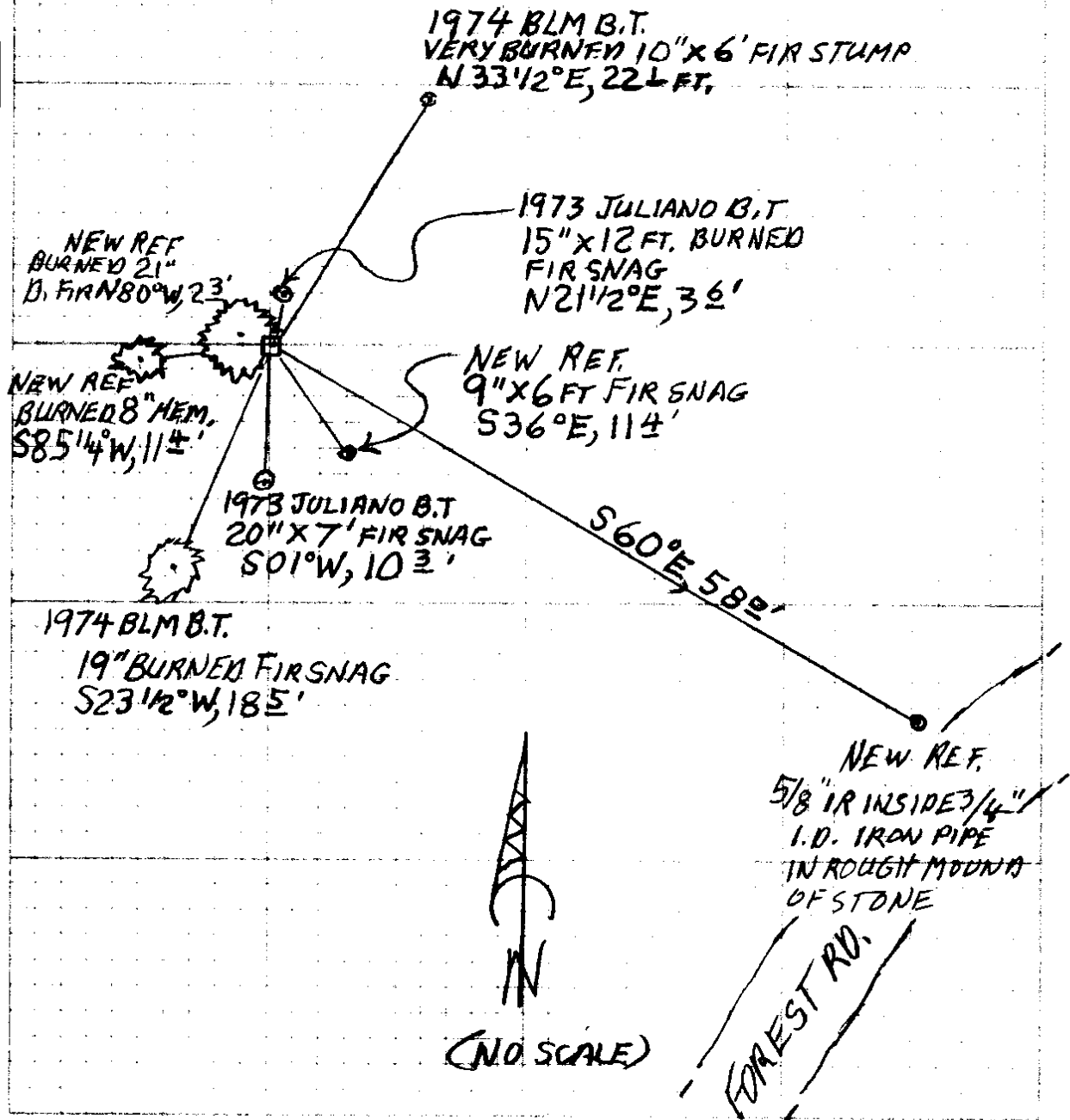

CS 67/51-38
3/8

bears S. 11 1/2° W., 15 lks. dist., with brass cap mkd. T25S R2W S35 RM 1974, and an arrow pointing to the corner.

N. 89° 33' W., beginning new measurement.

Descend 65 ft. over NW. slope, through heavy timber and light undergrowth.

12/7/21

- 9.05 Bottom of descent, slopes N.; asc. 25 ft. along N. slope.
- 18.05 Top of ascent, slopes N.; desc. 20 ft. over NW. slope.
- 18.50 Gravelled road, 15 lks. wide, bears N. 65° E. and S. 35° W., in curve.
- 20.04 The W 1/16 sec. cor. of secs. 26 and 35, established by Nick Juliano, Registered Logging Engineer, No. 3449, in 1973, monumented with an iron post, 2 ins. diam., firmly set, protruding 6 ins. above ground, with brass cap mkd.

NOW PROT 10" BY GROUND T 25 S R 2 W
 IN ROUGH MOUND OF STONE W 1/16 S 26 V 2' 2" BLZ
 S 35
 1973

from which bearing trees mkd. by Juliano

15" x 12" FT BURNED SNAG A fir, 13 ins. diam., bears N. 21 1/2° E., 5 1/2 lks. TO SPIKE
 dist., with a railroad spike driven into base.

20" x 7" FT BURNED SNAG A fir, 18 ins. diam., bears S. 1° W., 16 lks. 103 TO NAIL
 dist., with a railroad spike driven into base.

and new bearing trees

VERY BURNED STUMP 10" x 6" FT A fir, 15 ins. diam., bears N. 33 1/2° E., 33 1/2 lks. 22 L V
 dist., mkd. W 1/16 S26 BT. POSS BURNED WOOD

19" BURNED DEAD SNAG A fir, 15 ins. diam., bears S. 23 1/2° W., 28 lks. 103 V
 dist., mkd. W 1/16 S35 BT. FH BLZ

N. 89° 33' W., beginning new measurement.

Descend 250 ft. over NW. slope, through heavy timber and dense undergrowth.

- 11.91 Ravine, drains. N. 30° E.; asc. 10 ft. over NE. slope.
- 13.56 Spur, slopes N. 10° E.; desc. 135 ft. over NW. slope.
- 20.04 The cor. of secs. 26, 27, 34, and 35.

Land, mountainous.

Soil, rocky clay and loam.

Timber, fir, hemlock, cedar, yew, madrone, maple, and alder; undergrowth, vine maple, hazel, arrowwood, salal, Oregon grape, rhododendron, blackberry, and fern.

From the cor. fo secs. 26, 27, 34, and 35.

DECLINATION 14 1/2°

N. 3° 52' W., bet. secs. 26 and 27.

8" BURNED DEAD HEMLOCK HEALD HI TO BLZ S 85 1/4° W, 11 1/2 FT

9" x 6" FT BURNED FIR SNAG NOT BLZD OR SCRED S 36° E, 11 1/2 FT

21" BURNED D. FIR POSSIBLE HEALD BLZ N 80° W, 2 3/4 FT DEAD

CS 62/51-3A
15/2/21
4/14

BLM
JUNE 2010 TAG

MMA GPS
TIME = 9:45
H.I. = 0.3605

NEW REFS - 5/8" I.R. INSIDE 3/4" I.D. x 23" IRON PIPE IN ROUGH MOUND STONE