

RENEWAL

Monument Set (Procedure and Description)

MONUMENT DETAIL

Reference ORIG BRASS CAP
ON I. PIPE Bent ESE 0.5.
Feet. Remove AND Reset
IN EXACT LOCATION PLUM
Projecting 8"

New Accessories

18" x 1 1/2' TALL Solid burnt SAWN FIR
with 4" MAG NAIL Top Center S71°E 29.0 FT

48" x 1' TALL Solid burnt SAWN Hemlock STUMP
4" MAG NAIL Top Center N45°W 55.2 FT

Sketch of Monument, Accessories, and General Area

Location & Comments

See Attached Sheet

CORNER IS APPROX
200' EAST OF ROAD
COURSE N-5 AND
APPROX 100' SOUTH OF
BAMC RD.
AREA BURNT 9-20

Lat: 43° 25' 59.49" N

Long: 123° 01' 07.99" W

CS 67/51-27 P9 3/13

Comp. Decline. 19 1/2° E
Agency DCSO
Party Chief S. FLAUSC
Note keeper
Witnesses J. LORSUNG

REGISTERED
PROFESSIONAL
LAND SURVEYOR



OREGON
JULY 14, 1978
RONALD A. QUMBY
1654

Expires: 12/31/2022

CS 67/51-33
2/4

T24S, R3W, 54100
540100

11/15/21

NEW REF.
4" MAG NAIL
TOP CNTR.
48" x 1 FT
SAWN HEMLOCK STMP.

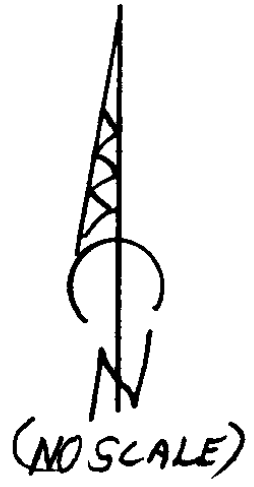

1966
RENEWAL BT
20" x 2' BURNED
HEM. STMP.

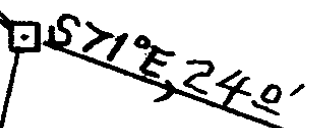
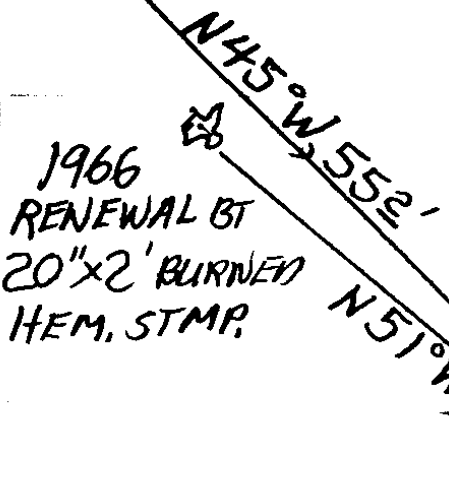

NEW REF.
4" MAG NAIL
TOP CENTER
18" x 1 1/2 FT
SAWN FIR STMP.



O.B.T
35" x 5'
BURNED
FIR STMP.

CS 67/51-33

MM GPS START 13:00
HI = 0.9115M

11/15/21

TOWNSHIP 24 RANGE 03 POINT IDENTIFIER # 540100

PRIMARY CORNER DESCRIPTION 1/4 Cor. for Sec. 35; & 2 of T25-3

Alias _____	Description _____
Alias _____	Description _____
Alias _____	Description _____
Alias _____	Description _____

Original - W.H. Byars, Under Contract #152 dated June 3, 1871 (DCSO records, Volume 7 Page 2946)

Set 1/4 sec. post, from which
A Cedar 12" dia., bears N.60°E., 84 lks. dist.
A Fir 24" dia. bears S.5°W., 52 lks. dist.

GLO Dependent Resurvey by Norman D. Price Under Special Instructions dated April 5, 1940 (DCSO records, Volume 27 Page 11537)

Point for original 1/4 sec. cor., determined at record bearing and distance from old SW bearing tree.

*2 1/2" BC PROT. 18" TOP BENT 05' ESE
REF. OUT REMOVE STRAIGHTEN
REPLACE AT REF POSITIO NOW PROT, 8 INCHES*

At point for corner, set an iron post, 3 ft. long, 1" dia., 28" in the ground, for 1/4 sec. cor., with brass cap marked

1/4 S 35 ✓
S 2 ✓
1944 *34 32* from which
A Fir 44" dia. bears S.5°W., 52 lks. dist., mkd.
SEE BELOW on bark of S B T. I reblaze and remark this old bearing tree 1/4 S 2 BT.
NO EVID A Hemlock 6" dia. bears N.16°W., 46 lks. dist., mkd. 1/4 S 35 BT. (New BT) *30 35*

Douglas Co. Surveyors Office - Vernon Tracy; Jack Heritage Joe Brady - July/Aug. 1966 - C.S. File 54/27-130

Found - 1944 GLO brass cap mkd., with steel fence post alongside.

BURNED OUT STUMP 20" x 2" SW BT, now stump and NW BT down, scribe visible
New BT - *12"* Hemlock N.51°W., 39 1/2 ft. mkd. 1/4 S 35 CS BT. *FACE BRND OFF*
35" x 5" BRND STUMP Rerscribe Orig. BT to SW: *S 9°W 36 2* 44" D. Fir stump S.5°W., *34.3* ft. mkd. 1/4 S 2 CS BT. *FACE BRND OFF*
Corner lies approx. 200 ft. E. of road, course N & S., curving to east passing approx. 100 ft. north of corner.

Fd. OK, by DCSO, Sept. 11, 1967 - C.S. File 54/27-86

18" x 1 1/2' TALL SOLID BURNED SAWN FIR STUMP TOP CNTR 4" MAG S 71° E, 24°
48" x 1' TALL " " " HEMLOCK " " N 45° W, 55°

6 FT STEEL POST NORTH 2° FT CS 07/51-33 4/4