

GOVERNMENT CORNER RESTORATION FORM

FILED

TOWNSHIP 24S RANGE 3W SEC. 25 PLSS # 600200

Date: 4/7/2012 By: JK

This survey consists of:

DOUGLAS COUNTY OREGON

DATE 11-10-21

Map: \_\_\_\_\_

Narrative: \_\_\_\_\_

Corner Rpt: CS 67/51-32

DOUGLAS COUNTY  
SURVEYOR

Corner Designation

SEC COR 526/525  
535/536

Monument(s) Found: (Condition and Source)

\_\_\_ Condition report

\_\_\_ Not Found

Renewed

\_\_\_ Unrecorded

\_\_\_ Surveyed In

1 1/2" I.D. IRON PIPE Proj. 21"

BRASS CAP MISSING

Previous Renewals

DCSD 1968 CS 54/27-1A7

Ness 1993 M117-35

MONUMENT DETAIL

Accessories Found

1968 BT'S

30" D. FIR STUMP N58°55'W 19.5 FT BURNT TO GROUND

36" X 3 FT BURNT D. FIR STUMP S28°10'E 8.3 FT

34" X 3 FT BURNT D. FIR STUMP S52°10'W 6.16 FT

28" X 2 1/2 FT BURNT D. FIR STUMP N44°15'W 9.1 FT

NO TRACE OF W NAILS

1993 BT'S

22" X 12' D. FIR N36°17'E 27.3 FT (REC 27.1 FT)

21" X 2' BURNT D. FIR STUMP S48°26'E 28.3 FT

21" X 5' BURNT D. FIR STUMP S50W 23.8 FT (REC S49°45'W  
23.9 FT) TO MAG NAIL RSC

22" X 9' SAWN D. FIR STUMP N26°14'W 40.5 FT (REC 40.2 FT)  
TO MAG NAIL RSC

C.S. File 67/51-32

Drive Pipe To Project 8"  
Built Rough Stone mound  
AROUND BASE

New Accessories

21" X 4 BURNT FIR STUMP N 71 1/2° E 32.5 FT  
4" MAG NAIL TOP CENTER

Sketch of Monument, Accessories, and General Area

Location & Comments

See Attached Sheet.

AREA BURNT BADLY  
9-2020

LAT. 43° 26' 42.94" N  
LONG 123° 00' 44.15" W

Comp. Decline. 14 1/2° E  
Agency DCSO  
Party Chief S. F. AUSE  
Note keeper  
Witnesses J. LORSUNG

REGISTERED  
PROFESSIONAL  
LAND SURVEYOR

*Ronald A. Quimby*

OREGON  
JULY 14, 1978  
RONALD A. QUIMBY  
1954

Expires: 12/31/2022

CS 67151-32

11/10/21

T24S, R03W, 600200



(NO SCALE)

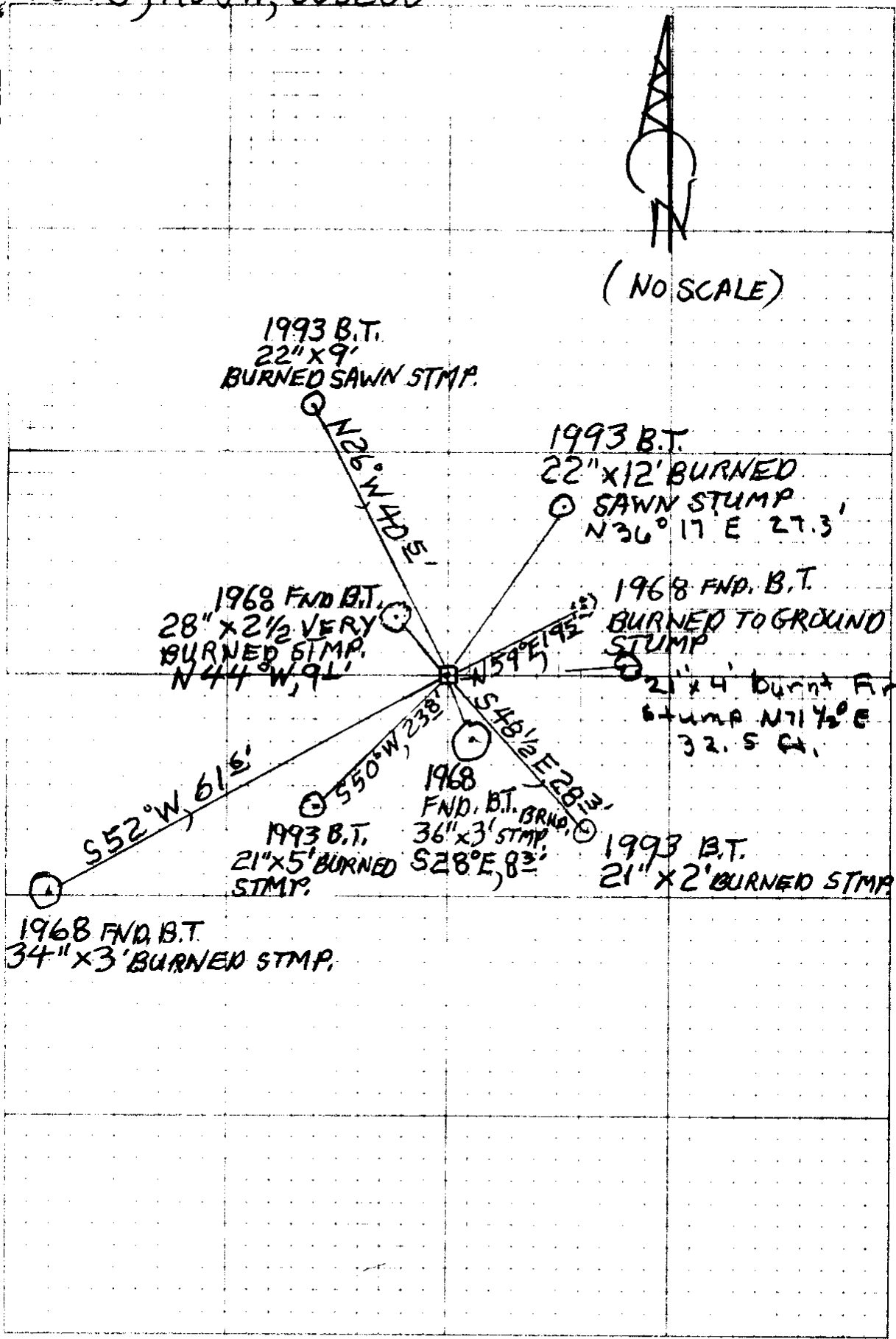

11/10/21

TOWNSHIP 24 RANGE 03 POINT IDENTIFIER # 600200

PRIMARY CORNER DESCRIPTION Cor. Secs. 25, 26, 35, & 36

Alias	Description
Alias	Description
Alias	Description
Alias	Description

GLO survey by L.H. Wheeler under Contract No. 467 dated April 7, 1883 (DCSO records Vol. 7 Page(s) 2971)

-----

Set cedar post 4 ft. long, 4" sq., 24" in the ground for cor. to secs. 25 & 36, 26 & 35 marked T 24 S S 25 on NE., R 3 W S 36 on SE., S 26 on NW., & S 35 on SW. faces with 1 notch on S & E edges from which

A fir, 24" dia. bears N.50°E. 27 lks. mkd: T24S R3W S25 BT <sup>178</sup>

A fir, 36" dia. bears S.28°E., 9 lks. mkd: T24S R3W S36 BT <sup>S.9</sup>

A fir, 20" dia. bears S.33°W. 57 lks. mkd: T24S R3W S35 BT <sup>37.6</sup>

A fir, 40" dia. bears N.50°W. 11 lks. mkd: T24S R3W S26 BT <sup>7.3</sup>

Doug. Co. Surveyors Office - V.R.Tracy - 3/1968 - C.S. 54/27-147

-----

Unrecorded ren. at sec. cor?

Found - 1 1/2" IP & 8" mkr. pipe & "W" method BTs.

46" Fir stump S.30°E., 6.5 ft. "W" nail & tag <sup>orig</sup>

44" Fir stump N.46°W., 7.2 ft. "W" nail & tag. <sup>orig</sup>

36" Fir stump N.60°E., 18.2 ft. "W" nail & tag. <sup>orig</sup>

52" Fir stump S.50°W., 55.7 ft. "W" nail & tag. No scribe fd.

Steve Ness - For: Weyerhaeuser Co. - July 1993 - M 117-35

-----

Found - 1 1/2" Iron Pipe?

<sup>1980</sup> ~~30" D. Fir stump, N.58°55'E., 18.5 ft. to center, 18.02 ft. to 'W' nail, (N.60°E., 18.3 ft.)~~

<sup>BURNED TO GRND</sup> ~~38" D. Fir stump, S.28°10'E., 8.3 ft. to center, no measure to 'W' nail, (S.34°E., 6.5 ft.)~~

<sup>36" x 3 FT BURNED FIR STMP</sup> ~~48" D. Fir stump, S.52°10'W., 61.6 ft. to center, 60.68 ft. to 'W' nail, (no record of this stump on Weyco report)~~

<sup>34" x 3 FT BURNED FIR STMP</sup> ~~27" D. Fir stump, N.44°15'W., 9.1 ft. to center, 7.42 ft. to 'W' nail, (N.46°W., 7.2 ft.)~~

<sup>28" x 2 1/2 FT VERY BURNED FIR STMP</sup> Set - Cemented a ~~2 1/2" Brass Cap~~ to top of found 1 1/2" iron pipe marked: T24S R3W

~~BRASS CAP GONE~~ ~~S26 S25 S35 S36~~

<sup>DRIVE IN NEW PROT. 8" AND SET ROUGH STONE MOUND AROUND BASE</sup>

<sup>FOUND 1 1/2" I.D. PIPE PROT 2 1/2" 1993 RLS 811 27 3 TO RSC MAG NAIL</sup>

<sup>BURNED BARK STMP</sup> ~~22" x 12 FT - 15" D. FM, N.36°17'E., 27.1 ft. to center, 26.27 ft. to 'W' nail. Scribed "T24S R3W S25 BT"~~

<sup>21" x 2 FT BURNED FIR STMP</sup> ~~14" D. Fir, S.48°26'E., 28.3 ft. to center, 27.36 ft. to 'W' nail. Scribed "T24S R3W S36 BT"~~

<sup>21" x 5 FT BURNED STMP</sup> ~~16" D. Fir, S.49°45'W., 23.9 ft. to center, 23.13 ft. to 'W' nail. Scribed "T24S R3W S35 BT"~~

<sup>22" x 9 FT SAWN STMP</sup> ~~16" D. Fir, N.26°14'W., 40.2 ft. to center, 39.29 ft. to 'W' nail. Scribed "T24S R3W S26 BT"~~

<sup>40 5 TO RSC MAG NAIL</sup>

NO W NAILS FOUND

MARKS AND W NAILS HEALED OVER ON ALL TO RSC MAG NAIL 15

NEW 21" x 4 FT BURNED FIR STMP N 71 1/2° E, 32 5 FT TO 4" MAG NAIL TOP CENTER

CS 67151-32 414

7974 M1