

TOWNSHIP 255 RANGE 3W SEC. 16

PLSS # 300400

Date: 4-7-2022 By: X
This survey consists of:

DOUGLAS COUNTY OREGON

DATE 6-15-21

Map: _____

Narrative: _____

Corner Rpt: CS 67/51-31

DOUGLAS COUNTY
SURVEYOR

Corner Designation

See COR 17/16
20/21

Previous Renewals _____
Monument(s) Found: (Condition and Source)

- ___ Condition Report
- ___ Not Found
- ___ Renewed
- ___ Unrecorded
- ___ Surveyed In

MONUMENT DETAIL

BLM Resurvey 1940
DCSD 1966 CS 54/27-41
BURTON HOLT 1980 CS 58/163
MARK SMALLEY CS 65/42-1

2" IP WITH 2 1/2" BRASS CAP
U.S. GLO 1943
Projects 10"

Accessories Found

BURPT 40" x 2 1/2' D. FIR STUMP N 29° E 23 1/2 FT
26" x 7' D. FIR STUMP S 39° W 14 1/2 FT (REC
S 35° W 15 3/4 FT)
11" x 6' D. FIR ^{5 1/2" DIA} N 61° E 22 1/2 FT (REC N 64° E 22° FT)
11" x 6' D. FIR ^{5 1/2" DIA} S 37° E 12° FT (REC S 41° E 12 1/2 FT)
14" x 7' D. FIR STUMP N 22° W 8 1/2 FT (REC N 20° W 7 1/2 FT)

All stumps show good scars but
BURPT

New Accessories

Metal Fence Post North 2KT

GPS LAT. LONG - 43° 23' 39.50" N, 123° 04' 11.07" W

<u>Sketch of Monument, Accessories, and General Area</u>	<u>Location & Comments</u>
--	--------------------------------

AREA BURN T
9/2020

Comp. Decline. 14 3/4° E
 Agency DCSO
 Party Chief S. KLAUSE
 Note keeper J. LORSUNG
 Witnesses _____

Surveyor's Seal

CS 67/51-31

2/5

T25S, R03W, PLSS 300400

JUNE 15, 2021

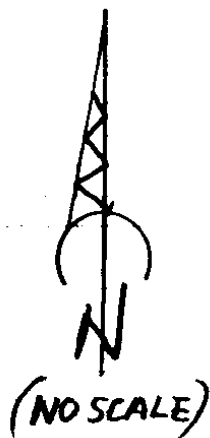

ALL BT'S
ORIGINALLY
DESCRIBED
AS D. FIRS

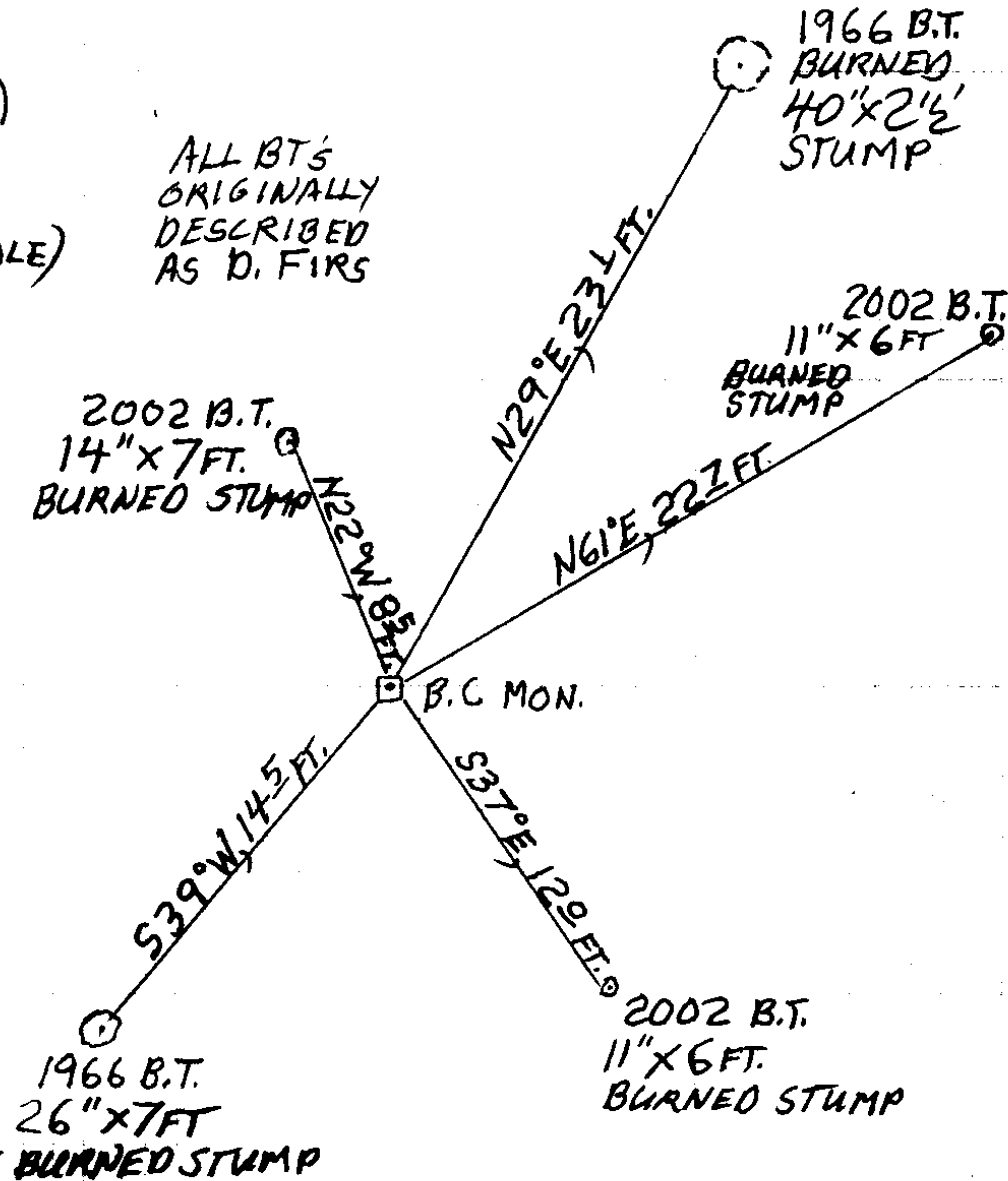

CS 67/51-31
315

PRIMARY CORNER DESCRIPTION Sec. Cor. for 16, 17, 20 and 21

Alias _____ Description _____
 Alias _____ Description _____
 Alias _____ Description _____
 Alias _____ Description _____

Original, Laban H. Wheeler, Under Contract #467 dated April 7, 1883 (DCSO Records, Volume 9 Page 3706)

Set Yew post 4 ft. long, 4" sq., 24" in the ground for Cor. to secs. 16, 17, 20 and 21, mkd. T25S S16 on NE., R3W S21 on SE., S20 on SW., and S17 on NW. faces, with 3 notches on S. and 4 notches on E. edges, from which

- ✓ A Fir 40" dia., bears N.60°E., 35 lks. dist. mkd. T25S R3W S16 BT.
- ✓ A Fir 36" dia., bears S.20°E., 24 lks. dist., mkd. T25S R3W S21 BT.
- ✓ A Hemlock 10" dia., bears S.50°W., 18 lks. dist., mkd. T25S R3W S20 BT.
- ✓ A Cedar 24" dia., bears N.21°W., 11 lks. dist., mkd. T25S R3W S17 BT.

GLO Dependent Resurvey by Norman D. Price, Under Special Instructions dated April, 5, 1940. (DCSO records, Volume 27 Paged 11580-81)

Point for original cor. of secs. 16, 17, 20 and 21, determined at the record distance from each of the original bearing trees At point for corner, set an iron post, 3 ft. long 2" dia., 28" in the ground, for cor. of secs., with brass cap mkd.

✓	T25S R3W	PROJ 12" LEANS ~ N30°E. 09
	S17 S16	
	S20 S21	STRAIGHTEN PROJ 10" 2
	1943	from which

- ✓ A Fir 50" dia., bears N.29°E., 35 lks. dist., mkd. on bark BT T25S R3 S16. (Old BT)
- ✓ A Fir 40" dia., bears S.68°E., 24 lks. dist., mkd. on bark T25 R3 S21 BT. (Old BT)
- ✓ A Hemlock 16" dia., bears S.29¼°W., 18 lks. dist., with blaze healed. (Old BT)
- ✓ A Red Cedar 28" dia., bears N.74°W., 11 lks. dist., with blaze healed. I re-blaze and re-mark this old bearing tree T25S R3W S17 BT.
- ✓ A Fir 54" dia., bears N.74°E., 57 lks. dist., mkd. T25S R3W S16 BT. (New BT)
- ✓ A Yew 6" dia., bears S.15½°E., 33 lks. dist., mkd. T25S R3W S21 BT. (New BT)

This sec.. cor. is located on top of a ridge, bears NW. and SE.

CS 67/51-31 415

TOWNSHIP 25 RANGE 03 POINT IDENTIFIER # 300400

PRIMARY CORNER DESCRIPTION Sec. Cor. for 16, 17, 20

Alias _____ Description _____
 Alias _____ Description _____
 Alias _____ Description _____
 Alias _____ Description _____

Doug. County Surveyors Office - Vernon Tracy; Jack Heritage
 August 1966 - C.S. File 54/27-41

Found - GLO brass cap, 1943, with steel fence post set
 alongside.
 All BTs called for in field notes are now destroyed
 by logging. Stumps & snags remain.

New BTs - 6" D.Fir S.35°W., 15.3 ft. mkd. T25S R3W S20 CS BT.
 5" Chinquapin S.76°E., 9.6 ft. mkd. S21 CS BT.
 50" Fir stump N.29°E., 23.1 ft. (orig. BT) rescribed
 "T25S R3W S16 CS BT"
 No other trees suitable.

Found Brass cap and 5 BTs, Burton Holt, August 1980
 C.S. File 58/163

Mark Smalley - For: Roseburg Resources - 1/2002 - C.S. File
 65/42-1

Found - 1943 US GLO 2" IP with 2½" brass cap, properly mkd.
 BURNT STAMP 40" x 2 1/2" 50" D.Fir stump bears N.29°E., 23.1 (OBT) 39°
 26" x 7" 20" D.Fir - good condition - bears S.35°W., 15.3 14.5
 New - 11" x 6" 10" D.Fir bears N.64°E., 22.87 scribed "S16 BT"
 11" x 6" 9" D.Fir bears S.41°E. 37" 12.00 scribed "S21 BT"
 14" x 7" 12" D.Fir bears N.28°W., 7.6 scribed "S17 BT"
 22° 8.5

METAL FENCE POST N 2 FT.