

GOVERNMENT CORNER RESTORATION FORM

TOWNSHIP 29S RANGE 4W SEC. 22 PLSS # 500340

FILED
Date: 3-10-2022 By: X

DOUGLAS COUNTY OREGON

DATE 2-28-22

This survey consists of:

Map: _____

Narrative: _____

Corner Rpt: CS 67/51-28

Corner Designation

1/4 COR 22/23

DOUGLAS COUNTY
SURVEYOR

Monument(s) Found: (Condition and Source)

___ Condition report

___ Not Found

Renewed

___ Unrecorded

___ Surveyed In

Piece of I.P Flange in ground
Near monument location

Previous Renewals

DCSO 1956 CS 47/101 RM 1-8

DCSO 1971 CS 49/47

HOFFICE 9-97 M 128-12

MONUMENT DETAIL

Accessories Found

22" Apple 569°E 41.3 FT Healed SCAR

N.E CORNER OF BARN 558°W 81.8 FT THIS
CORNER OF MAIN BARN STRUCTURE CORNER
POST IS GIVE MEASUREMENT IS TO JOIST
NOTCH THAT HELD CORNER POST

C.S. File 67/51-28

RENEWAL

Monument Set (Procedure and Description)

2 3/8" BRASS CAP ON 1" I.D
Iron pipe position
Determined From Found
References. CAP is
BURIED 6" below Ground
IN FIELD

MONUMENT DETAIL

Douglas County
Surveyor
T29S R4W
1/4 522 | 523
2022

New Accessories

Most Northerly CORNER of Purpose built
Power Pole. A 6" x 6" Treated Post set in
Concrete ± 20' TALL BEARS N 76° W 22.7 FT
The East and West End of a 4-5 FT TALL
Concrete Block Wall measured to the South
Edge of the End Blocks. This wall has a
Large gap in the East half.
NAR East end bears N 60° E 113.3 FT
FAR West end bears N 43° W 77.3 FT

Sketch of Monument, Accessories, and General Area

See Attached Sketch

Location & Comments

Comp. Decline. 14 1/2° E
Agency DCSO
Party Chief S. Flouse
Note keeper
Witnesses J. LORSUNG.

REGISTERED
PROFESSIONAL
LAND SURVEYOR

Ronald A. Qumby

OREGON
JULY 14, 1978
RONALD A. QUMBY
1654

Expires: 12/31/2022

T^{29S}, R^{04W}, 500340

FEB, 28, 2022

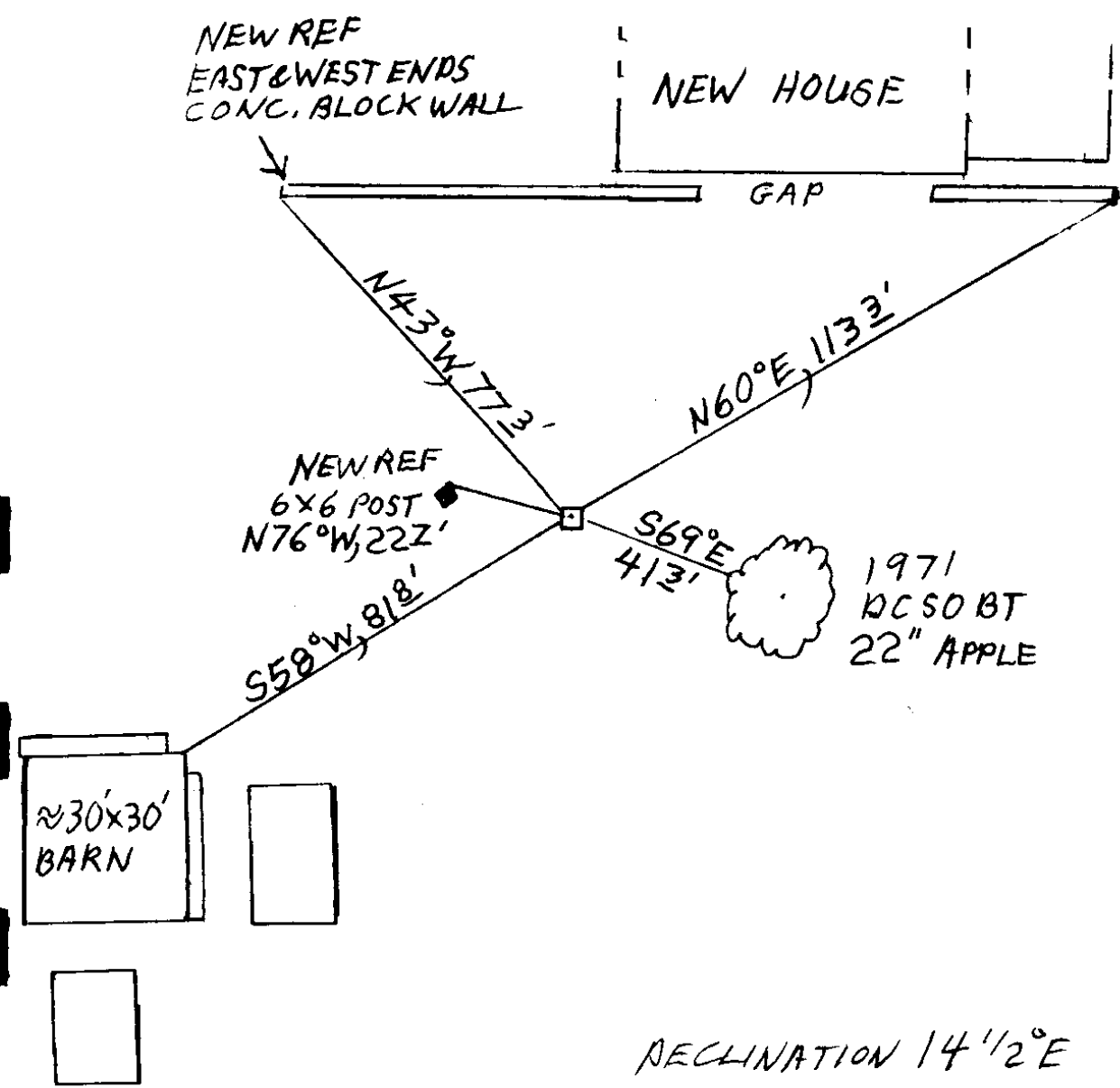
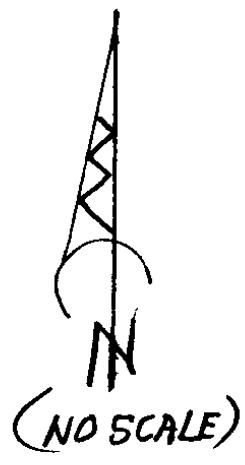

DECLINATION 14' 1/2° E

CS 67/51-20

2/28/22

TOWNSHIP 29 RANGE 04 POINT IDENTIFIER # 500340

PRIMARY CORNER DESCRIPTION 1/4 Cor. for Secs. 22 and 23

Alias _____	Description _____
Alias _____	Description _____
Alias _____	Description _____
Alias _____	Description _____

Original - Nathaniel Ford, under Contract #44 dated May 30, 1854 - (DCSO records Vol. 15 Page(s) 6368)

Set 1/4 sec. post, from which
A Red Fir 6" dia., bears N.12°W., 24 lks. dist.
A Red Fir 4" dia., bears N.66°E., 15 lks. dist.

Douglas County Surveyors Office - James W. Byron, Deputy - May 1956 - C.S. File 47/101 and RM 1-8

Corner set halfway between section corners.
Set an Iron pipe with brass cap mkd. "1/4 S22 23 County Surveyors Office 1956 T29S R4W".
Blazed and scribed two trees:
14" Apple tree, N.74°E., 14.0 ft. mkd. 1/4 S CS BT.
24" Ash, North 101.0 ft. mkd. 1/4 S CS BT.
South Myrtle Creek, 350 ft. to North.
SW. Corner of house bears N.10°E., 90 ft.

Douglas County Surveyors Office - John M. Powell and crew - Oct. 19, 1971 - C.S. File 49/67

Found - Part of 1956 DCSO brass cap, out of ground.
All BTs are gone, dead and disposed of.

HOUSE GONE (ALSO BELOW) → SW Cor. of house N.3°E., 87.3 ft. (Rec. N.10°E., 90.0 ft.) Porch may have been added.
However, remainder of brass cap is still firmly in ground. *MON. GONE FOUND PIECE OF I.P. FLANGE BURIED IN GROUND NEAR CORNER POS.*

~~Set New brass cap at the same point of 1956 cap, mkd: County Surveyors Office 1971 T29S R4W 1/4 S22 S23.~~

New BT - 14" Apple S.69°E., 41.3 ft. scribed ("1/4 S23 CS BT".)
22" → NE Corner of barn, S.58°W., 81.8 ft. (*NOW HEALED BLAZE*)
SW Corner of house, (porch) N.3°E., 87.3 ft.
GONE

Fd. Ok by K.Hoffine - 9/97 - M 128-12 DECLINATION 14 1/2°E

THIS IS CORNER OF MAIN BARN STRUCTURE, CORNER POST IS NOW GONE, MEASUREMENT IS TO JOIST NOTCH THAT HELD NE CORNER POST.

A NEW 2 3/8" BRASS CAP ON A 1" I.D. X 32" IRON PIPE IS SET AT POSITION DETERMINED BY FOUND REFERENCES 6" BELOW GROUND SURFACE. CAP IS MARKED "DOUGLAS COUNTY SURVEYOR" T295. R4W

1/4 S22 | S23
2022

CS 47/51-28

1
OVER →
NEW REFS

NEW REFERENCES

MOST NORTHERLY CORNER OF PURPOSE BUILT POWER POLE
A 6" x 6" PRESSURE TREATED POST SET IN CONC. AND STANDING
≈ 20 FT TALL; BEARS N76°W, 22³ FT. DISTANT

THE EAST AND WEST END OF AN APPROX. 4-5 FT. TALL CONCRETE BLOCK
WALL; MEASURED TO THE SOUTH EDGE OF THE END BLOCKS. THIS WALL
HAS A LARGE GAP IN THE EAST HALF.

THE FAR EAST END BEARS N60°E, 113³ FT. DISTANT.

THE FAR WEST END BEARS N43°W, 77³ FT. DISTANT.