

GOVERNMENT CORNER RESTORATION FORM

TOWNSHIP 255 RANGE 3W SEC. 19 PLSS # 140300

DOUGLAS COUNTY OREGON

DATE 10-14-21

FILED

Date: 11/23/2021 By: X  
This survey consists of:

Map: \_\_\_\_\_

Narrative: CS

Corner Rpt: 67/51-19

Corner Designation

DOUGLAS COUNTY  
SURVEYOR

$\frac{1}{4}$  COR  $\frac{19}{30}$

Previous Renewals DCSO 2 1/2" BRASS CAP  
Monument(s) Found: \_\_\_\_\_ (Condition and Source)

- \_\_\_\_ Condition Report
- \_\_\_\_ Not Found
- Renewed
- \_\_\_\_ Unrecorded
- \_\_\_\_ Surveyed In

MONUMENT DETAIL

BLO NORMAN PRICE 1940  
Vol 27 Pages 11593-94  
DCSO 1966 CS 54/27-24  
DCSO 1968 CS 54/27-126  
DCSO 1982 CS 61/30-16  
DCSO 1998 CS 64/79-11  
Hoffine 2007 M 154-16

COUNTY SURVEYORS OFFICE

T255 R3W

$\frac{1}{4}$   $\frac{519}{530}$   
1966

Accessories Found

1982  
14" X 5' SAWN FIR STUMP S26°W 46<sup>1</sup>/<sub>2</sub> FT (REC 48° FT)  
Fully Healed Double BLAZE  
X IN TOP OF 54" METAL CULVERT S36°W 3<sup>1</sup>/<sub>2</sub> FT  
(REC S26°W)  
21" R. CEDAR N89°E 24<sup>1</sup>/<sub>2</sub> FT Fully Healed Double  
BLAZE  
1998  
18" Hemlock S26<sup>1</sup>/<sub>2</sub>°W 15<sup>1</sup>/<sub>2</sub> FT (REC 16° FT) Fully  
Healed Double BLAZE  
16" D. FIR N16°E 67<sup>1</sup>/<sub>2</sub> FT Fully Healed Double  
BLAZE

C.S. File 67/51-19

RENEWAL

Monument Set (Procedure and Description)

MONUMENT DETAIL

---



---



---



---



---



---

New Accessories

5/8" X 30" IRON ROD WITH A DCSD YELLOW  
PLASTIC CAP FLUSH WITH SURFACE OF GRAVEL  
ROAD SHOULDER BEARS WEST 65° FT

---



---



---



---



---



---



---



---

Sketch of Monument, Accessories, and General Area

Location & Comments

---



---



---



---

Comp. Decline. 14 3/4  
 Agency DCSD  
 Party Chief S. F. AUSE  
 Note keeper \_\_\_\_\_  
 Witnesses J. LORSONG

**REGISTERED  
 PROFESSIONAL  
 LAND SURVEYOR**

*Ronald A. Gumbly*

**OREGON  
 JULY 14, 1978  
 RONALD A. GUMBY  
 1854**

CS 67151-19

Expires: 12/31/2022

10/14/21

T25S, R03W PLSS 140300

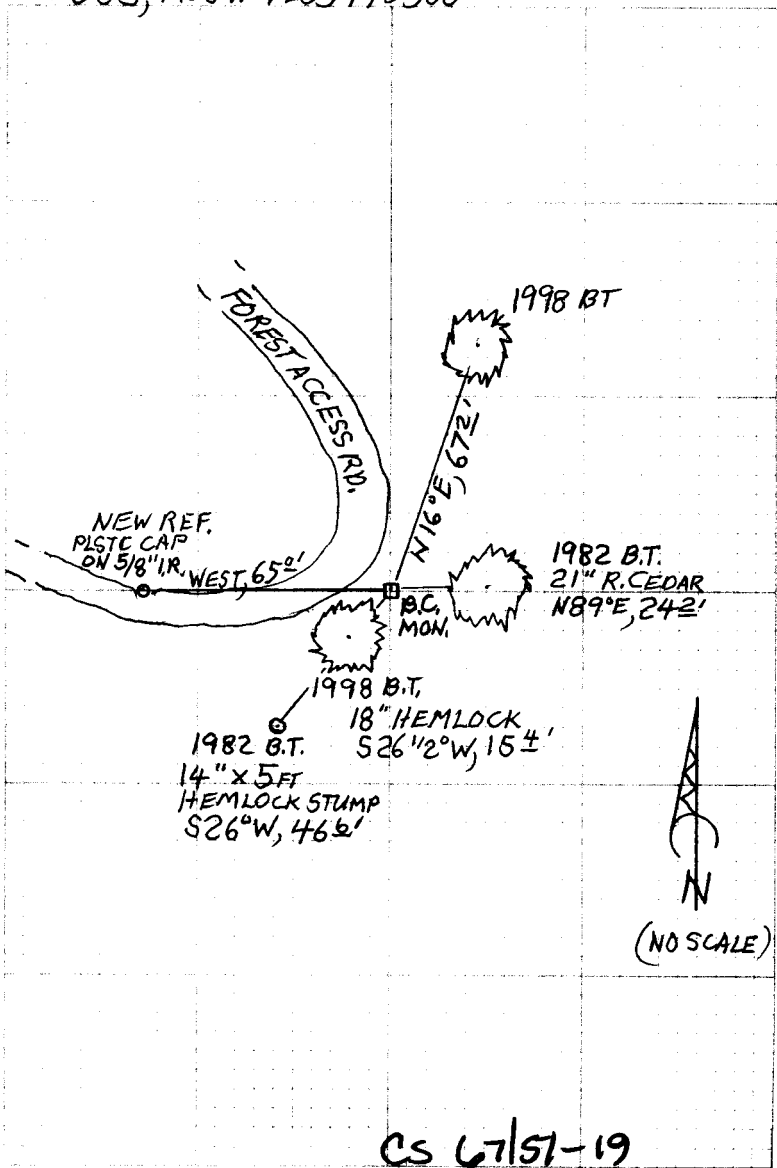

CS 67/57-19



PRIMARY CORNER DESCRIPTION 1/4 Cor. for secs. 19 and 30

|             |                   |
|-------------|-------------------|
| Alias _____ | Description _____ |
| Alias _____ | Description _____ |
| Alias _____ | Description _____ |
| Alias _____ | Description _____ |

DCSO Fd. OK, Feb. 1968 C.S. File 54/27-126; After unplugging 54" culvert we find Brass cap ok. Build mound of stone around B.C.

Doug. County Surveyors Office - Gregory Quibell, Deputy - Terrie Plouff - March 1, 1982 - C.S. 61/30-16

-----

Found - 1966 County brass cap, properly mkd., firmly set, protruding 12" out of ground.

20" Hemlock now 22" and down with scribed "1/4 S19 BT" vis. on partially healed blaze bears N.22°E. 50.5' to center of root hole. (Rec. 51.5'.)

16" Fir now 22" stump w/BT tag bears S.12°W. 19.8'.

New BTs - 12" Cedar scribed "1/4 S19 CS BT" in double blaze bears N.89°E., 25.0 ft.

9" Maple scribed "1/4 S30 CS BT" in double blaze bears S.84°E., 26.8 ft.

8" Fir scribed "1/4 S30 CS BT" in double blaze bears S.26°W., 48.0 ft.

6" Maple scribed "1/4 S30 CS BT" in double blaze bears S.37°W., 17.8 ft.

"X in top of 54" corrugated steel culvert bears S.26°W., 3.7 ft. and "1/4 cor. bears N.26°E., 3.7'" is stamped next to X.

Due to closeness of metal culvert, all bearings were taken from the tree to the brass cap.

Douglas Co. Surveyors Office - Randall W. Smith - Stephen J. Flause - 1/26/98 - C.S. File 64/79-11

-----

Found - 2 1/2" dia., brass cap on a 1 1/2" O.D. iron pipe with approx. 6" of loose soil on top. 1966

*FOUND AS DESCRIBED* 8" now 13" dia., 1 1/2" ft. high D.Fir stump with a previously opened blaze illegible scribing visible, bears S.51°W., 11.9 ft. (Agrees with rec.) 1940

*GONE* 1940 NE BT now gone.

*GONE* 16" now 22" dia., 1 1/2 ft. high D.Fir Stump with a healed blaze, bears S.12°W., 18.8 ft. (Rec. S.12°W., 19.8 ft) 1966

*GONE* 6" now 10" dia., 2 ft. high Maple stump with scribing "1/4 S30 CS" visible on an open blaze, bears S.37°W., 17.8 ft. (Agrees w/rec.) 1982

*1982 14" x 5 FT SAWN STUMP* 8" Fir, now 13" dia., Hemlock with a fully healed double blaze, bears S.26°W., 46.6 ft. (Rec. S.26°W., 48.0 ft) 1982

(Cont. next page)

10/14/21

TOWNSHIP 25 RANGE 03 POINT IDENTIFIER # 140300

PRIMARY CORNER DESCRIPTION 1/4 Cor. for Secs. 19 & 30

|             |                   |
|-------------|-------------------|
| Alias _____ | Description _____ |
| Alias _____ | Description _____ |
| Alias _____ | Description _____ |
| Alias _____ | Description _____ |

✓  
 "X" in top of 54" dia., metal culvert bears  
 S.36°W, 3.7 ft. (Rec. S.26°W., 3.7 ft) 1982  
 GONE 9" now 9" dia., 4 ft. high Maple stab, with  
 scribing visible on a open blaze "1/4 S30 CS  
 BT" bears S.84°E., 26.3 ft. (Rec. S.84°E.,  
 26.8 ft.) 1982  
 21" 12" now 16" dia., R.Cedar with a fully healed  
 double blaze, bears N.89°E., 24.2 ft. (Rec. ~~N.89°E., 25.0 ft~~ **FHDB**)  
 New BTs - 18" 11" dia., Hemlock, double blazed and scribed "1/4 ~~S30 CS BT", bears S.26 1/2°W., 16.0 ft.~~ **FHDB**  
 16" 7" dia., D.Fir, double blazed and scribed "1/4 ~~S19 CS BT", bears N.16°E., 6 1/2 ft.~~ **FHDB**  
 See sketch in file.

FD. by Ken Hoffine, 8/2007 - M154-16

**NEW REFERENCE**  
 A DC90 YELLOW PLASTIC CAP ON A 5/8" x 30" IRON ROD SET FLUSH  
 WITH SURFACE IN GRAVEL ROAD SHOULDER; BEARS WEST, 65.0 FT.