

T23S, R10W, S13 ^{1/4}
S14 | S13

Pkss: 600440
DATE: 8/5/19
Filed 11/18/2021

CREW:

PARTY CHIEF — S. J. FLAUSE
TECHNICIAN — J. A. LORSUNG

MONUMENT:

FROM THE 1958 DCSD RENEWAL A
2 1/2" DIA. BRASS CAP ON A 1" I.P. IRON PIPE.
CAP IS MARKED AS DESCRIBED. MONUMENT
IS UNDER EAST EDGE OF SMALL FIR
STUMP, SAWN FLUSH WITH GROUND.

PROJ.: MONUMENT IS
20" BELOW SURFACE.

REFERENCES FOUND:

FROM THE 1933 CCC SURVEY, EVID.
OF 1 B.T. A 43" DIA. X 4 FT. TALL
HEMLOCK STUMP, WHICH IS OPENED TO
FIND THE RESCRIBE "1/4 S"; BEARS
S65°E, 22° FT. DISTANT (AS PER 1958
RENEWAL RECORD).

FROM THE 1958 DCSD RENEWAL EVID.
OF THE RENEWAL TREE; NOW A ROOT DE-
PRESSION FOUND AT RECORD POS.

NEW REF'S:

A MULTI TRUNK ALDER, THE MOST
CS 67/50-36

OVER →

T23, SR10W, S13 PLSS 600440

SW'LY 11" DIA. TRUNK WHICH IS SCRIBED
"1/4 S13" "CS13T" ON A DOUBLE BLAZE;
CENTER OF ROOT CROWN BEARS
N42°2'E, 13° FT. DISTANT.

A 32" DIA. R. CEDAR, SCRIBED
"1/4 S13" "CS13T" ON A DOUBLE BLAZE;
BEARS S81°W, 21° FT. DISTANT.

A 9" DIA. D. FIR, SCRIBED "1/4 S14CS"
"BT" ON A DOUBLE BLAZE; BEARS
S68°W, 8° FT. DISTANT.

DECLINATION 15° E
1958 BT
NOW ROOT DEPR.

SKETCH:

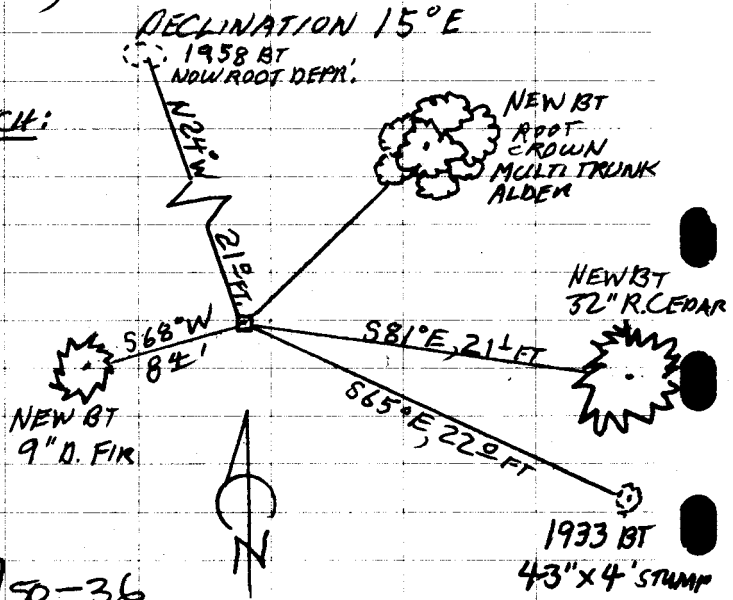

CS 67/50-36

(NO SCALE)

TOWNSHIP 23 RANGE 10 POINT IDENTIFIER # 600440

PRIMARY CORNER DESCRIPTION 1/4 Cor Secs. 13 & 14

8/5/19

Alias _____	Description _____
Alias _____	Description _____
Alias _____	Description _____
Alias _____	Description _____

GLO survey by W.H. Byars under contract #292, dated August 7, 1878 - (DCSO recs. Vol. 7 Page(s) 2705-6)

Set a Fir post, 5 ft. long, 5 ins. dia., 20" in ground for the 1/4 sec. cor. between secs. 13 & 124, from which

A Fir, 8" dia., bears S.45°E., 29 lks.

A Fir, 6" dia., bears S.38°W., 27 lks.

Elliott State Forest Corner Records by Federal Civilian Conservation Corp (CCC) 8/1933 - FB 119 Pg47

Could find no trace of 1/4 cor. or BTs so set a 4"x4" Red Cedar post 2' in ground from which

A 15" Hemlock bears S.25°E., 22' dist.

A 10" Alder bears N.72°E., 21' dist.

Set corner post at 26+02 ⁰² on true line between sec. cors. 13, 14, 23, 24 and 11, 12, 13, 14. True line being 69.5 ft. West of our line.

Douglas Co. Surveyors Office - James W. Byron, Deputy - M. Godfrey - S. Bilow - Feb. 11, 1958 - C.S. File 49/63

Found - 4"x4" sq. & scribed stake at corner & both BTs as scribed by State. No trace of orig. BTs can be found.

This corner proportioned by State.

Find State's 15" now 30" Hemlock, open face shows good scribing, bears S.65°E., 22.0 ft. (State S.25°E., 22.0 ft.)

10" now 18" Alder snag, checks State's bearing & 2 1/2" dist.

Set - Brass cap alongside sq. stake, mkd: County Surveyors Office, 1958, 1/4 S14/S13 T23S R10W

I reblaze & rescribe 30" Hemlock S.65°E., 22.0 ft.

1/4 S13 CS BT. *OPEN FIND RESCRIBE 1/4 S*

I blaze & scribe 10" Hemlock N.24°W., 21.0 ft. 1/4 S14/S13 CS BT.

ROOT DEPRESS

SAW 4 1/2" x 4" TALL HEM STAMP

COUNTY SURVEYORS OFFICE
T23S
44 S/S
13/14
R10W
1958

Fd. & used on BLM Resurvey by Donald Beck, Cadastral Surveyor, under Group #658, surveyed Oct/Nov. 1967 (DCSO records Vol. 36 Page(s) 14606)

Fd. Ok by A. Gibson, 12/1972 M 49-20
 Fd. Ok by G. Miller 9/1983 M 95-55
 Fd. Ok by R. Ward 12/1997 M 128-25

20" BELOW SURFACE AND UNDER EAST EDGE SMALL SAWN OFF FLUSH FIR STAMP

continued next page

CS 67/50-36

1

TOWNSHIP 23 RANGE 10 POINT IDENTIFIER # 600440

PRIMARY CORNER DESCRIPTION 1/4 Cor. Secs 13 & 14

Alias _____	Description _____
Alias _____	Description _____
Alias _____	Description _____
Alias _____	Description _____

Fd. & used on BLM dependent resurvey by Harvey E. Wofford, Cadastral Surveyor, under Group # 1459, surveyed Aug.. 1988 - (DCSO records Vol. 49 Page(s) 18732)

NEW BT'S

MULTI TRUNK ALDER 11" SWLY TRUNK SCR BBO "1/4 S13" "CSBT N42 1/2° E, 13 1/2 FT

32" R. CEDAR "1/4 S13" "CSBT"

S81° E , 21 1/2 FT.

9" D. FIR "1/4 S14 CS" "BT"

S68° W , 8 1/2 FT

CS 67150-36