

File # 11812021 DATE: 4/9/19
PLSS#: 600640

T255 ROB W S1 N4
S27S1

CREW:

CREW CHIEF - S. J. FLAUSE
TECH - J. A. LORSUNG

MONUMENT:

A 3 1/4 BLM BRASS CAP MARKED AS PREV.
DESCRIBED ON A 2" I.D. IRON PIPE
SET PLUMB IN AN 18" PROJ: 1 INCH
DIAM. FIELD, POURED ABOVE GROUND
CONCRETE COLLAR AND CONC COLLAR

FOUND:

NO EVIDENCE OF O.B.T.'S FOUND. FROM 1977/
1979 BLM DEPENDENT RESURVEY TWO B.T.'S

A 24" DIA. GRAND FIR WITH A FHSB; BEARS
S86 1/2° E, 16 1/2 FT. DIST. (AS PER REC.)

A 23" DIA. D. FIR WITH A FHSB; BEARS
S89° W, 20 1/2 FT. DIST (AS PER RECORD)
GREEN AND WHITE "T" POST NORTH, 20 FT OVER
CS 67/50-24 →

DIETZGEN NO. 388-B

(2)

SET: New TBY'S

9" DIA. G. FIR, SCRIBED "1/4 S2" "CSBT"
ON A DOUBLE BLAZE; BEARS S26°W, 29⁰ FT. DIST.

17" DIA D. FIR, SCRIBED "1/4 S2 C5" "BT"
ON A DOUBLE BLAZE; BEARS N41°W, 45³ FT. DIST.

CS 67/50-24

SKETCH: T25 SR8W600640

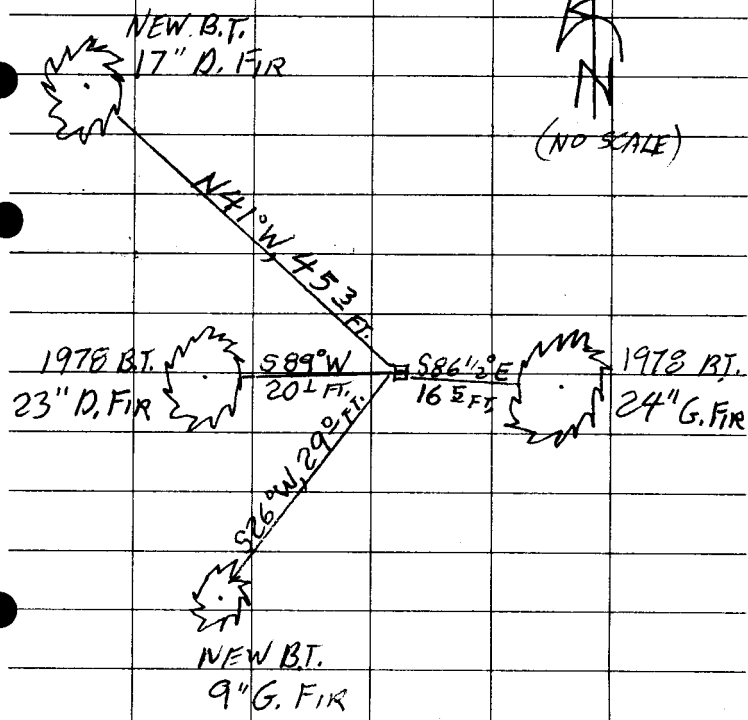

DIETZEN NO. 385-8

DECLINATION = 14 3/4° E

CS 67 | 50 - 24

TOWNSHIP 25 RANGE 08 POINT IDENTIFIER # 600640

PRIMARY CORNER DESCRIPTION 1/4 Cor. Secs. 1 & 2

Alias _____	Description _____
Alias _____	Description _____
Alias _____	Description _____
Alias _____	Description _____

GLO Survey by - A.R. & S.C. Flint, Under Contract #392, dated May 26, 1881 (DCSO records Vol. 9 Page(s) 3942)

 Set fir 1/4 post 3 ft. long & 3" sq. from which
 A W. Fir, 8" dia., bears N.50°E., 9 lks. 544
 A fir, 24" dia., bears N.80°W., 15 lks. 990

BLM Dependent resurvey by James E. Jelley, Harvey E. Wofford Wayne L. Rogers, Cadastral Surveyors under Group #926 & 958, surveyed Aug. 1977/April 1979 - (DCSO records Vol. 42 Page(s) 16441-2)

 Point for the 1/4 sec. cor. of secs. 1 & 2, at proportionate distance; there is no remaining evidence of the orig. corner. Set an iron post, 28" long, 2 1/2" dia., 24" in the ground with brass cap marked: T25S R8W

1/4
 . S 2 | S 1
 1978

from which
24 A fir, 9" dia., bears S.86 1/2°E., 16 50 lks., mkd: 1/4 S1 BT FSB
23 A fir, 6" dia., bears S.89°W., 20 13 lks., mkd: 1/4 S2 BT " "

9" G-FIR 1/4 S 2 "CS BT" S 26° W, 292 FT
 17" D. FIR " 1/4 S 2 CS " BT N 41° W, 453 FT.

CS 67/50-24