

PLSS: 600440

T245 ROB W S13

DATE: 3/18/19

S14 | S13, Filed 11/18/2021

CREW:

CREW CHIEF: S. J. FLAUSE

TECH: J. A. LORSUNG

MONUMENT:

FROM 1960 DCSO RENEWAL, A 2 1/2" DIA. BRASS

CAP ON A 1" "COUNTY SURVEYORS OFFICE"

I.D. IRON PIPE.

T245 RBW

PROJ:

ADDED 18" x 1" TALL 1/4 S14 | S13

17" ABV

FOUND: STONE MOUND 1960

GROUND
IS PLUMB

ONE O.B.T.

NOW 5"

A 31" DIA. 18 FT. TALL D. FIR SNAG WITH A PREVIOUSLY OPENED BLAZE; BEARS S 28° E 7⁹ FT. DIST. (PER REC.)

TWO B.T.'S FROM 1960 DCSO RENEWAL.

A 17" DIA. D. FIR WITH FHD B; BEARS S 32° E, 29° FT. DIST. (PER REC.). A 23" DIA. 6 FT TALL

SOLID D. FIR STUMP WITH FHD B; BEARS N 48° W, 45^Z (REC. S 45° W, 45^Z)

NEW ACCESSORIES:

10" DIA. D. FIR, SCRIBED "1/4 S13 CS" "BT" ON A DOUBLE BLAZE; BEARS N 0 1/4° E, 60⁴ FT. DISTANT.

17" MADRONE, SCRIBED "1/4 S13" "CSBT" ON A DOUBLE

CS 67/50-17

OVER



NEW ACCESSORIES CONT'D:

BLAZE; BEARS N85¹/₄°E, 38³ FT. DIST.

BC MON. IS 50 FT EAST FROM GRAVEL
FOREST ACCESS ROAD.

BC MON. IS ON N-S CUTLINE WITH VERY OLD
SECOND GROWTH TO EAST AND NEW CLEARCUT
TO WEST.

CS 67/50-17

SKETCH 285 K04W 600440

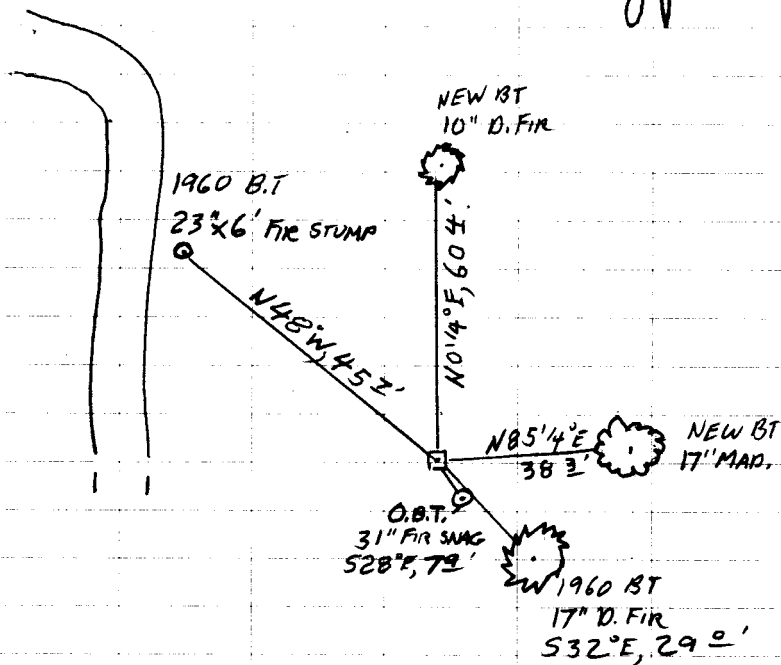

CS 67/50-17 DECLINATION:

TOWNSHIP 24 RANGE 08 POINT IDENTIFIER # 600440 3/18/19

PRIMARY CORNER DESCRIPTION 1/4 Cor. for Secs. 13 and 14

Alias _____	Description _____
Alias _____	Description _____
Alias _____	Description _____
Alias _____	Description _____

GLO Survey by Henry L. Chandler, U.S. Deputy Surveyor, under Contract #619, dated June 5, 1893 - (DCSO records Vol. 8 Page(s) 3320)

Set a post 3 1/2" ft. long, 3" sq., 24" in the ground for 1/4 sec. cor., marked 1/4 S on W. face, from which

31" x 18" A Fir 36" dia., bears S.28°E., 12 lks. dist. mkd. 1/4 S BT ON POBLZ
 ROTTEN SNAG A Fir 18" dia., bears N.32 1/2°W., 72 lks. dist. mkd. 1/4 S BT
 NO EVID. 47 52

Douglas Co. Surveyors Office - James Byron, Deputy - Milo Godfrey; C. Putman, crew - Nov. 7, 1960 - C.S. File 49/84

Found - ABOVE Orig. 36" now 40" Fir snag, S.28°E., 7.9 ft. I open and find good scribing "1/4"
 NF Orig. 18" now 30" Fir, N.32 1/2°W., 47.5 ft., shows good scars.

Set Brass cap at cor. mkd: County Surveyors Office ✓ PROJ 17"
 T 24 S R 8 W PLUMB
 1/4 S14 S13
 1960

17" D. New BTs- 8" R. Fir bears S.32°E., 29.0 ft. scribed 1/4 S13 CSBT FHDB
 11" R. Fir bears S.45°W., 45.7 ft. scribed 1/4 S14 CSBT FHDB
 23" x 6 FT SOLID D. FIR STMP N 48

MON NOW PROJ. 5" ABOVE ROUGH 18" DIAM. 12" TALL ROUGH STONE MOUND

NEW BT

10" D. FIR "1/4 S13 CS" BT N 0 1/4 E, 60 1/4 FT.

17" MARRON "1/4 S13" CSBT N 85 1/4 E, 38 3/4 FT

MON 50' EAST FROM GRAVEL FOREST ACCESS RD.

MON ON N-S CUTLINE VERY OLD SECONDARY GROWTH TO EAST NEW CLEAR CUT TO WEST

3.5
28

CS 67/50-17