

GOVERNMENT CORNER RESTORATION FORM
DOUGLAS COUNTY SURVEYOR

TOWNSHIP 29S RANGE 03W SECTION 20

PLSS/GCDB No. 29-03-037040

CORNER DESIGNATION: ESE Corner of Daniel T. Craig DLC 37

Date:	11/10/2021	FILED
By:	SC	
Corner Form:	67/49-25	
Field Notes:	3pgs total	
DOUGLAS COUNTY SURVEYOR		

CORNER HISTORY, PREVIOUS RENEWALS OR SURVEYS:

- See DCSO Survey & Corner records for PLSS 29-03-037040 the DLC Corner was restored by James Byron for DCSO in 1962 per C.S. file 52/126.

DATE: October, 26, 2018

- Condition Report Only
- Not Found
- Renewed
- Unrecorded
- Surveyed In
- Referenced Out

MONUMENT FOUND (CONDITION AND SOURCE):

- A 1" Diam. Iron Pipe with 2 1/2" brass cap firmly set and projecting 6" marked as follows:

MONUMENT DETAIL

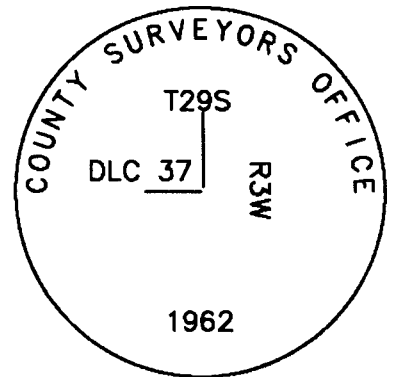

ACCESSORIES FOUND (CONDITION, SOURCE & RECORD):

Bearing Trees by James Byron in 1962:

- A 32" x 4' tall D. Fir Stump bears S 36 1/2° W, 225.6 ft. with a healed blaze
- A 31" I. Cedar bears N 58° W, 35.0 ft with healed blaze
- A 3/4 I.R. Flush with the ground bears N 25° W, 56.8 ft.

NEW ACCESSORIES (PROCEDURES AND DESCRIPTION):

- A 11" I. Cedar bears N 36° E, 16.6 ft. scribed "SEDLC37", "CSBT"
- A 6" D. Fir bears S 2 3/4° W, 104.8 ft. scribed "SEDLC37CS", "BT"
- The SE corner of metal barn bears N 12 1/2° W, 178.5 ft.

LOCATION & COMMENTS:

All bearing trees have BT tags attached. All new bearing trees have double blazed faces with bearings measured to the center of the tree at the root crown and distances measured to the side and center of the root crown to a 2 1/2" PK nail.

GEODETIC COORDINATES

LATITUDE:

LONGITUDE:

ELLIPSOID HEIGHT:

DATUM: NAD 83

SOURCE:

COMPASS DECLINATION: 15° E.

AGENCY:DCSO

PARTY CHIEF: S. J. FLAUSE

WITNESSES: J. LORSUNG

NOTES: ATTACHED

C.S. FILE 67/49-25

10-26-18

T295, R03W, SE DLC 37

~~1962~~ 2' 2" BC on 1" ID IP,
PROT. 6"

"COUNTY SURVEYORS OFFICE"
• T295

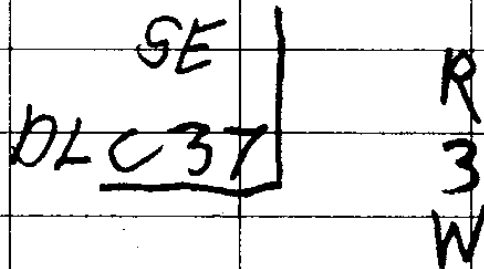

1962

END REFS

32" x 4 FT TALL D. FIR. FHOB S36[✓] 2[✓] W, 225[✓] 6[✓] FT

31" I. CEDAR POB N58[✓] W, 35[✓] 0 (BLM)

3/4" IR R/W FLUSH/GROUND 4x4 POST N45[✓] W, 0[✓] 75[✓]
N 25[✓] 1/2[✓] W, 56[✓] 9[✓] FT.

NEW BT'S SE COR METAL CLAD
BARN N 12[✓] 1/2[✓] W, 178[✓] 5[✓] FT

11" I. CED. SE DLC 37 "CSBT" N 36[✓] E, 16[✓] 58[✓] FT

6" D. FIR SE DLC 37 C5 "BT" S 02[✓] 3/4[✓] W, 104[✓] 8[✓] FT

10-26-18

TOWNSHIP 29 RANGE 03 POINT IDENTIFIER # 037040

PRIMARY CORNER DESCRIPTION ESE. Cor. Daniel T. Craig DLC #37

Alias	_____	Description	_____
Alias	_____	Description	_____
Alias	_____	Description	_____
Alias	_____	Description	_____

<p>Surveys of Donation Land Claims by - Dennis Hathorn, Deputy, dated June 8, 1857 (DCSO records, page 524, DLC Volume)</p> <p>-----</p> <p>A Fir 18" dia., SE. cor., from which A Fir 36" dia., bears N.15°W., 44 lks.</p>
<p>M. B. Germond - Sept. 1908 - Field Book 19, Pg. 44</p> <p>-----</p> <p>Set Cedar post 4" x 4" x 3 ft. for corner. Marked R.B. Cedar 6" dia., N.57°45'W., 53 lks. R.B. Cedar 5" dia., S.59°35'W., 102 lks.</p>
<p>Douglas Co. Surveyors Office - James Byron, Deputy - John Powell; Wm. Stoffel, crew - Oct. 1962 - C.S. File 52/126</p> <p>-----</p> <p>Found - 6" now 24" Cedar N.57°W., 35.0 ft. We open and find good scribe marks. SW. BT, not found. Set Brass cap at cor. mkd: County Surveyors Office T 29 S R 3 W S.E. DLC 37 1962</p> <p><i>25' RT</i></p> <p>3/4" I.R. at South R/W line of Co. Rd. Sta. 567+59.96 P.T. bears N.25°W., 56.8 ft. from DLC corner. Also, top of West bank of Myrtle Creek is 20 ft. East of corner. New BT - 23" R.Fir bears <u>S.36½°W.</u>, 225.8 ft. scribed SE DLC 37 CS BT. This BT is at top of North bank of Myrtle Creek.</p>

S. Myrtle Co. Rd No. 18

Add Crew to Field Notes