

GOVERNMENT CORNER RESTORATION FORM
DOUGLAS COUNTY SURVEYOR

TOWNSHIP 27 SOUTH RANGE 3 WEST SECTION 13 PLSS/GCDB No. 27-03-600440

CORNER DESIGNATION: 1/4 Corner of Sections 13 & 14

CORNER HISTORY, PREVIOUS RENEWALS OR SURVEYS:

- SEE DCSO SURVEY & CORNER RECORDS FOR PLSS 27-03-600440

MONUMENT (CONDITION AND SOURCE):

- Found a 1" i.d. iron pipe by Vernon Tracy, Douglas Co. Surveyor's Office, in 1968, firmly set, projecting 5" above the ground in a 12" diam. x 6" buried mound of stone with a 2 1/2" diam. brass cap marked as noted:
- The monument was found leaning 0.4 feet, ESE and was straightened to a plumb position.

ACCESSORIES (CONDITION, SOURCE & RECORD):

Original Bearing Trees by Flint in 1882:

- A 42" diam. x 3' tall D. fir stump with a metal cap bears S. 55° E., 21.3 ft. (Rec. S.50°E., 29 lks. to face)
- A 48" diam. x 25' tall D.fir snag bears N. 45° W., 19.8 ft. with illegible bark scribing.

Bearing Trees by Tracy in 1968:

- A 20" diam. W. fir bears S. 27° W., 10.5 ft. with a healed blaze.
- A 13" diam. W. fir bears N. 63° W., 7.0 ft. with a healed blaze. (Rec. N.57°W.)

New Bearing Trees:

- A 5" diam. D. fir bears N. 15 1/2° E., 15.8 ft. scribed "X" & "BT" on a double blaze.

LOCATION & COMMENTS:

The corner falls on a moderate SW slope approximately 200 ft. south of USBLM Wolf Creek Access Road.

All bearing trees have BT Tags attached. All new bearing trees have double blazed faces . All bearings are measured to the center of the trees at the root crown and distances measured to a 4" MAGHUB nail in the side and center of the root crown.

FILED
Date: 6/2/2024
By: SC
Corner Form & Field Notes:
C.S. File: 67/49-12
4 Pgs
DOUGLAS COUNTY SURVEYOR

DATE: February 7, 2019

Condition Report Only
 Not Found
 Renewed
 Unrecorded
 Surveyed In
 Referenced Out

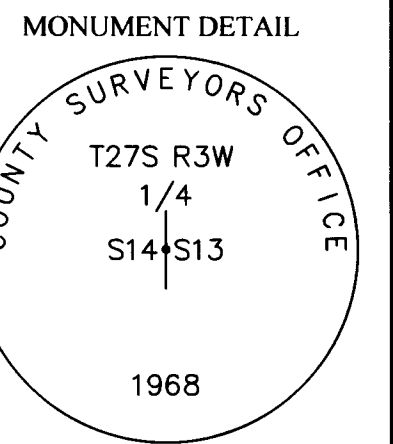

GEODETIC COORDINATES
LATITUDE: NO GPS SIGNAL AVAIL.
LONGITUDE:
DATUM: NAD 83
SOURCE: GeoXT6000
OREGON SOUTH-ZONE3602:
FILE PATH: \\DCNAS\Surveyor\SurShared\TraversePC\Corner Renewal DCSO\2019

COMPASS DECLINATION: 14 3/4° E.
AGENCY: DCSO
PARTY CHIEF: S. J. Flause
WITNESSES: J. Lorsung
NOTES: ATTACHED

CS 67/49-12
(.)

REGISTERED
PROFESSIONAL
LAND SURVEYOR

OREGON
JULY 17, 1981
KRISTIAN O. DEGROOT
1941
RENEWAL DATE: 12-31-2021

T 27 R 3 S 13

PL35: 600440

DATE: 2-7-19

CREW:

S. J. FLAUSE

J. LORSUUG

PROJ. 5 IN. S

(LEANING ESE 0 1/4 FT.)

MONUMENT FOUND:

2 1/2" DIA. BC / 1" ID. I.P. IN ROUGH BURIED MOUND OF STONE

"COUNTY SURVEYORS OFFICE"

T 27 S R 3 W

1/4 S 1/4 S 13

1968

ACC. FOUND:

OBT'S:

48" DIA 25' TALL D. FIR SNAG, ILL. BARK SCAB. N 45° W, 198'

42" DIA. 3' TALL D. FIR STUMP, METAL CAP S 55° E, 213'

NEW IN 1968 NOW:

(ORIG DIST TO FACE)

20" W. FIR, FHDB S 27° W, 10 1/2 FT.

13" W. FIR, FHDB N. 63° W, 7 1/2 FT.

NEW:

5" D. FIR SRBD. "X" "BT" N 15° 2' E, 15 1/2 FT.

NO GPS SIGNAL
THUS NO COORDINATES

671 49-12

(2)

SKETCH

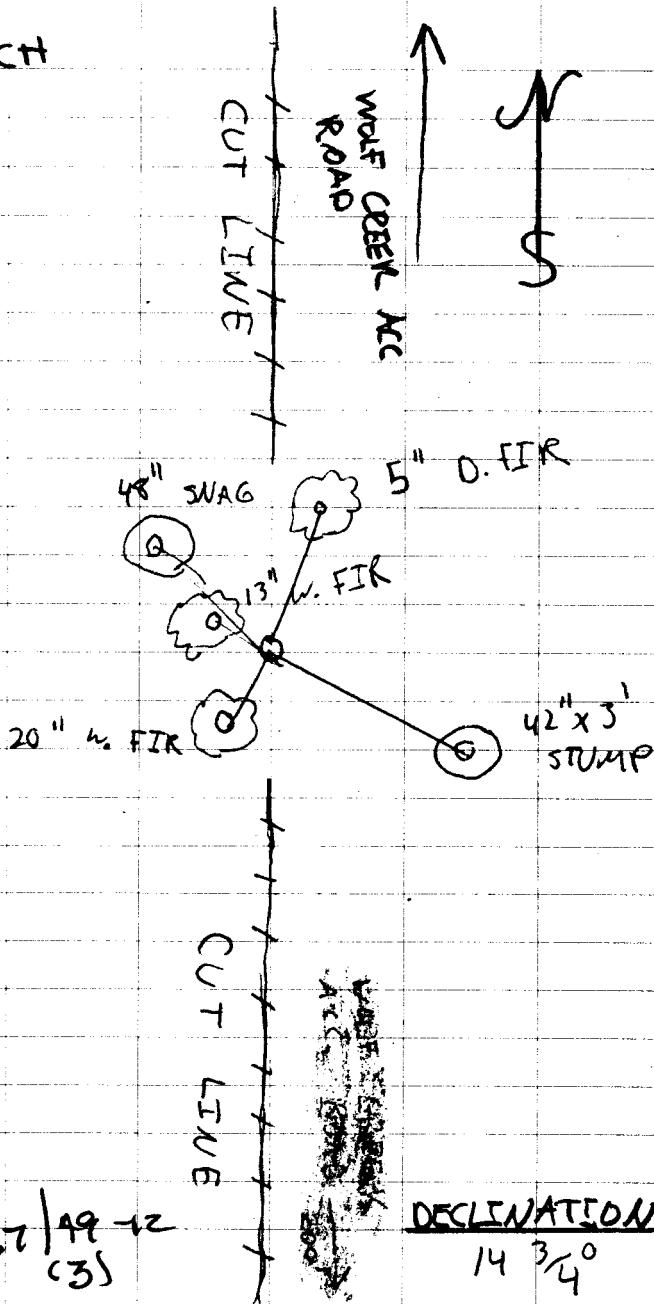

CS 67/19-12
(3)

DECLINATION:
14 3/4°

TOWNSHIP 27 RANGE 03 POINT IDENTIFIER # 600440

PRIMARY CORNER DESCRIPTION 1/4 Cor. Secs. 13 & 14

Alias _____	Description _____
Alias _____	Description _____
Alias _____	Description _____
Alias _____	Description _____

GLO Survey by Sam C. Flint, Under Contract #454, dated June 19, 1882 (DCSO Records Vol. 12 Page(s) 4991)

Set oak post, 3 ft. long, 4" sq., firmly in the ground for 1/4 sec. cor. mkd 1/4 S on E & W faces, from which
 A fir, 32" dia., bears N.45°W., 30 lks., mkd: 1/4 S BT.
 A fir, 36" dia., bears S.50°E., 29 lks., mkd: 1/4 S BT.

Douglas Co. Surveyors Office - Ben B. Irving, County Surveyor - Witnesses: H.C. Carey & R.C. Kerchner - March 29, 1945 - C.S. File 38/46

Set stone 8x14x24" marked 1/4 S on face. Remarkd OBT.

Douglas Co. Surveyors Office - Vernon "Ray" Tracy - Jack Heritage - E. West - 11/6/1968 - C.S. File 54/40

Found - Mound of Stone but no marked stone as called for in 1945 Ren.
 Orig. 32", now 48" Fir, alive, N.45°W. 19.8 ft., bark scribed.
 Orig. 36", now 52" Fir, alive, S.50°E. 19.1 ft., frag. bark scribe.

Set - Brass Cap at Cor. mkd: County Surveyors T27S R3W Office, 1968 1/4 S14|S 13

New BTs- 8" R.Fir S.27°E., 10.5 ft. mkd: 1/4 S13 CS BT
 8" R.Fir N.57°W., 7.0 ft. mkd: 1/4 S14 CS BT

This corner lies on moderate SW slope approx. 200 ft. S. of Wolf Creek access road.

Fd. BC W. Rogers, 8/2001 - 2001-0092A&B

CS 67/49-12
(+)

8" D. FIR N E 152

1