

GOVERNMENT CORNER RESTORATION FORM
DOUGLAS COUNTY SURVEYOR

FILED
Date: 6/2/2021

By: JC

TOWNSHIP 23 SOUTH RANGE 8 WEST

PLSS/GCDB No. 23-08-600539

CORNER DESIGNATION: East 1/4 of Section 11 Only

Corner Form & Field Notes:

C.S. File: 671 49-11

DOUGLAS COUNTY SURVEYOR

CORNER HISTORY, PREVIOUS RENEWALS OR SURVEYS:

- SEE DCSO SURVEY & CORNER RECORDS FOR PLSS 23-08-600539

DATE: February 4, 2019

- Condition Report Only
- Not Found
- Renewed
- Unrecorded
- Surveyed In
- Referenced Out

MONUMENT (CONDITION AND SOURCE):

- Found a 2 1/2" o.d. iron pipe by Peter Peterson, Cadastral Surveyor, in 1967 per a 1971 USBLM Dependent Resurvey, firmly set, projecting 4" above the ground with a 3 1/4" diam. brass cap marked as noted:

MONUMENT DETAIL

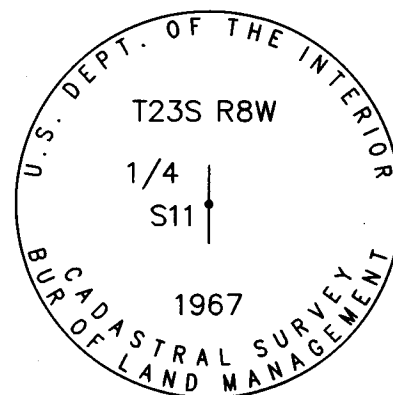

ACCESSORIES (CONDITION, SOURCE & RECORD):

Original Bearing Trees by Peterson in 1967:

- A 20"x 2' tall very rotted W.fir stump bears S. 71° W., 26.5 ft. with a healed blaze. (Rec. S. 69° W.)
- A 31" diam. W. fir bears N. 89° W., 66.0 ft. with a healed blaze as per record.

New Bearing Trees:

- A 12" diam. maple bears N. 22 1/4 E., 66.7 ft. scribed "1/4 S11 CS" & "BT" on a double blaze.
- A 30" diam. D. fir bears S. 44 1/2° E., 10.9 ft. scribed "1/4 S11" & "CSBT" on a double blaze.
- A 15" diam. maple bears N. 7° W., 64.4 ft. scribed "1/4 S11" & "CSBT" on a double blaze.

Steel fence post approximately 2 ft. South

LOCATION & COMMENTS:

The corner falls on a North slope in mixed timber approximately 50 feet south of Mehl Creek County Road No. 11.

All bearing trees have BT Tags attached. All new bearing trees have double blazed faces with bearing measured to the center of the tree at the root crown and distances measured to a 4" MAGHUB nail in the side and center of the root crown.

GEODETIC COORDINATES
 LATITUDE: 43°35'04.00" N.
 LONGITUDE: 123°36'15.51" W.
 DATUM: NAD 83
 SOURCE: GeoXT6000
 OREGON SOUTH-ZONE3602:
 FILE PATH:\DCNAS\Surveyor\SurShared\TraversePC\Corner Renewal DCSO\2019

COMPASS DECLINATION: 14 3/4° E.
 AGENCY:DCSO
 PARTY CHIEF: S. J. Flause
 WITNESSES: J. Lorsung
 NOTES: ATTACHED

CS 671 49-11 (2)

REGISTERED
 PROFESSIONAL
 LAND SURVEYOR

Kristian O. Degroot

OREGON
 JULY 17, 1981
 KRISTIAN O. DEGROOT
 1941

RENEWAL DATE: 12-31-2021

PLSS: 60053A

T 23 R 8 S 11

DATE: 2/4/2019

CREW:

S. J. FLAUSE

J. LORSUNG

PROS: 4 INGS

MONUMENT FOUND: 3 1/4" BC ON 2" I.D. I.P.

"U.S. DEPT OF THE INTERIOR"

PLUMB & FIRMLY SET

1/4"

S 11

(STEEL FNC POST)

≈ 2 FT SOUTH

1967
BUREAU OF LAND MANAGEMENT

ACC FOUND:

- 20" X 2' TALL FIR STUMP S 71° W

26[±] FT (REC 56° W)

- 31" W. FIR N 89° W, 66° FT

NEW:

- 12" MAPLE BEARS N 22 1/4° E, 66.2 FT

SCRIBED "1/4 S 11 CS" "BT"

- 30" D. FIR BEARS S 41 1/2° E, 109 FT

"1/4 S 11" "CSBT"

- 15" MAPLE BEARS, N 70° W, 64[±] FT

"1/4 S 11" "CSBT"

CS 67/49 "CS"

SKETCH

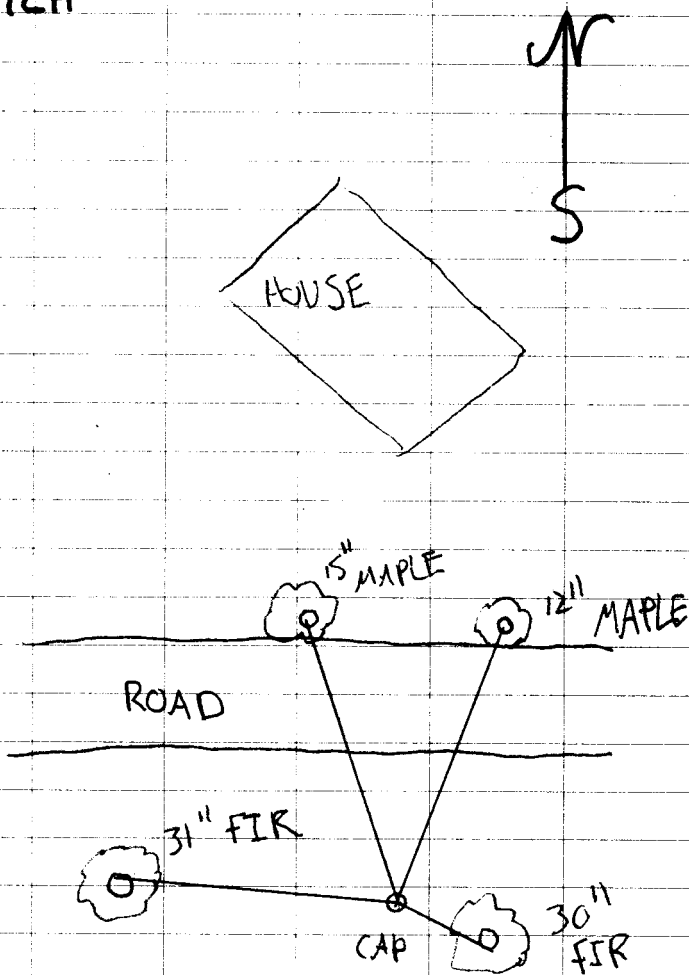

○ PROJECTED
1/4 of 12

CS 67 / 49-11
(3)

DECLINATION:

TOWNSHIP 23 RANGE 08 POINT IDENTIFIER # 600539

PRIMARY CORNER DESCRIPTION East 1/4 cor. for Sec. 11 only

Alias _____	Description _____
Alias _____	Description _____
Alias _____	Description _____
Alias _____	Description _____

BLM resurvey by Peter A. Peterson, Cadastral Surveyor, under Group #640, surveyed July 1967/April 1968 (DCSO records Vol. 35 Page(s) 14431)

Point for the 1/4 sec. cor. of sec. 11 only, at midpoint latitudinally, on the E. bdy. of the section.

Set an iron post 28" long, 2 1/2" dia., 25" in the ground with brass cap mkd:

1/4	
S 11	
T 23 S R 8W	
1967	

from which

31" A W. Fir 15" dia., bears N. 89° W., 100 lks. dist., mkd. 1/4 B/L NOT VIS.

S11 BT.

20" x 2" TALL A W. Fir 6" dia., bears S. 69° W., 42 lks. dist. mkd. 1/4 S11 FHSB
VERY ROTTED STAMP BT. 26 5

Fd. BC, 1 BT & 1 BT stump by C. Sweden, 11/2008 - 2009-0015A

12" MAPLE "1/4 S11 CS" "BT", N 22 1/4° E, 66 7

30" D. FIR "1/4 S11" "CSB" S 44 1/2° E, 10 9

15" MAPLE "1/4 S11" "CSBT", N 07° W, 64 4

CS 62/49-11
(41)

42
6
252
25