

GOVERNMENT CORNER RESTORATION FORM
DOUGLAS COUNTY SURVEYOR

TOWNSHIP 24S RANGE 05W SECTION 11 PLSS/GCDB No. 24-05-660540
CORNER DESIGNATION: CE 1/16 SECTION 11

FILED
Date: 4-13-2021

By: SC

Corner Form & Field Notes:

C.S. File: 67/49-4

DOUGLAS COUNTY SURVEYOR

DATE: DEC. 18, 2014

Condition Report Only
 Not Found
 Renewed
 Unrecorded
 Surveyed In
 Referenced Out

CORNER HISTORY, PREVIOUS RENEWALS OR SURVEYS:

- CORNER WAS ESTABLISHED IN OCTOBER, 1885 BY WILLIAM THIEL, DOUGLAS COUNTY SURVEYOR, PER SURVEY NO. 232, VOL. 1, PAGE 66.

MONUMENT DETAIL

MONUMENT FOUND (CONDITION AND SOURCE):

11" DIAM. x 5 FT. TALL FENCE POST, LEANING NORTHERLY, AT THE INTERSECTION OF ANCIENT EAST, WEST AND NORTH FENCE LINES. THIS FENCE POST VERY CLOSELY MATCHES THIEL'S RECORD TO THE FOUND NW BEARING TREE AND IS ACCEPTED AS THE VOL. 1, PG. 66 CORNER.

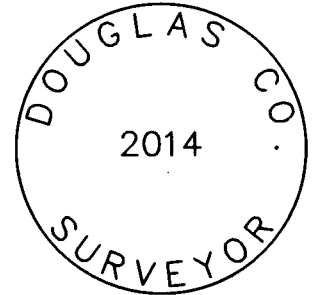

ACCESSORIES FOUND (CONDITION, SOURCE & RECORD):

BEARING TREES BY THIEL IN 1885:

- A 10" DIAM. x 48" TALL, SAWED AND PARTLY ROTTED W. OAK STUMP BEARS N.35 3/4°W., 88.2 FT. WITH SCRIBED MARKS "BT" AND A CHAINING NOTCH VISIBLE. (REC. N.34 1/2°W., 88.4 FT.)
- A DISTINCT ROOT HOLE BEARS S.12 1/2°E., 109.6 FT.

MONUMENT SET (PROCEDURES AND DESCRIPTION):

NONE

NEW ACCESSORIES:

NEW REFERENCE MONUMENT:

- A 5/8" x 30" IRON ROD SET 30" IN THE GROUND WITH A 1 1/2" ALUMINUM CAP MARKED AS NOTED, BEARS S.49°W., 2.0 FT.

NEW BEARING TREES:

- A 14" DIAM. D. FIR BEARS S.81°E., 11.7 FT. SCRIBED "CS BT" ON A LOW SINGLE BLAZE.
- A 15" DIAM. D. FIR BEARS N.15 1/4°W., 25.1 FT. SCRIBED "CS" & "BT" ON A DOUBLE BLAZE.

COMPASS DECLINATION: 15 1/4° E.

LOCATION & COMMENTS:

AGENCY:DCSO

ALL BEARING TREES HAVE BT TAGS ATTACHED. ALL NEW BEARING TREES HAVE DOUBLE BLAZED FACES WITH BEARINGS MEASURED TO THE CENTER OF THE TREE AT THE ROOT CROWN AND DISTANCES MEASURED TO THE SIDE AND CENTER OF THE ROOT CROWN UNLESS OTHERWISE NOTED.

PARTY CHIEF: S. J. FLAUSE

WITNESSES: M. KOCH

NOTES: ATTACHED

CORNER FALLS ON A GENTLE N-NW SLOPE, 5.8 FT. NORTH OF A NEWER EAST-WEST FENCE LINE. THE NE QUADRANT IS MIXED OAK AND FIR FOREST AND THE NW, SE, & SW QUADRANTS ARE OPEN GROUND.

GEODETIC COORDINATES

LATITUDE:
LONGITUDE:
ELLIPSOID HEIGHT:
DATUM: NAD 83
SOURCE:

REGISTERED
PROFESSIONAL
LAND SURVEYOR

Kristian O. Degroot

OREGON
JULY 17, 1981
KRISTIAN O. DEGROOT
1941

RENEWAL DATE: 12-31-2021

CS 67/49-4

(1)

GOVERNMENT CORNER RESTORATION FORM

FILED

TOWNSHIP 24S RANGE 5W SEC. 11 PLSS # _____

Date: _____ By: _____

DOUGLAS COUNTY OREGON

DATE DEC. 18, 2014

This survey consists of: _____

Map: _____

Narrative: _____

Corner Rpt: _____

Corner Designation

24-05-660540

DOUGLAS COUNTY SURVEYOR

Previous Renewals NONE (ESTB. 1885 D.C.S.O. OLD VOL.1, PG. 66)
Monument(s) Found: (Condition and Source)

- _____ Condition Report
- _____ Not Found
- Renewed
- _____ Unrecorded
- _____ Surveyed In
- _____ Referenced Out

~~NONE~~
11" DIAMETER 5 Foot Tall Fence
Post at SW intersection
of old fallen E-W-N Fence Lines

N/A

MONUMENT DETAIL

LEARNING NORTHERLY

Accessories Found

EVIDENCE OF THE TWO O.B.T.'S.

A WH. OAK 6" IN DIA. NOW A SAWED AND PARTLY ROTTEN 10 INCH DIAMETER, 4 FOOT
TALL WHITE OAK STUMP WHICH IS OPENED TO FIND THE SCRIBING "BT" AND THE
CHAINING NOTCH. THIS STUMP IS ON THE EAST EDGE OF A CLUMP OF SEVERAL SMALLER
ROTTED AND SAWED OAK STUMPS. THE SCRIBED STUMP BEARS N 34 1/2° W, 88 1/2 FEET
DISTANT (AS PER RECORD)
N 35 3/4° W, 88 1/2 FEET
(REC N 34 1/2° W)

A WH. OAK 8" IN DIA. NOW A DISTINCT ROOT-HOLE; BEARS S 12 1/2° E, 109 1/2 FEET DISTANT
(AS PER RECORD).

C.S. File CS 67/49-6

(2)

RENEWAL

Monument Set (Procedure and Description)

MONUMENT DETAIL

DOUGLAS CO. SURVEYOR

2014

New Accessories Bearing & distances from reference Monument

A 14 INCH DIA. DOUGLAS FIR SCRIBED "CS BT" ON A SINGLE LOW BLAZE; BEARS $S 87 \frac{3}{4}^{\circ} E, 13 \frac{1}{2}$ FEET DISTANT. $S 81^{\circ} E, 11.7$ FT

A 15 INCH DIA. DOUGLAS FIR SCRIBED "CS" "BT" ON A DOUBLE BLAZE; BEARS $N 11 \frac{1}{4}^{\circ} W, 26 \frac{1}{2}$ FEET DISTANT. $N 15 \frac{1}{4}^{\circ} W, 25.1$ FT

A 5/8" IRON ROD WITH ALUM CAP STAMPED "DOUGLAS COUNTY SURVEYOR 2014" BEARS $S, 49^{\circ} W, 2.0$ FT.

Sketch of Monument, Accessories, and General Area

Location & Comments

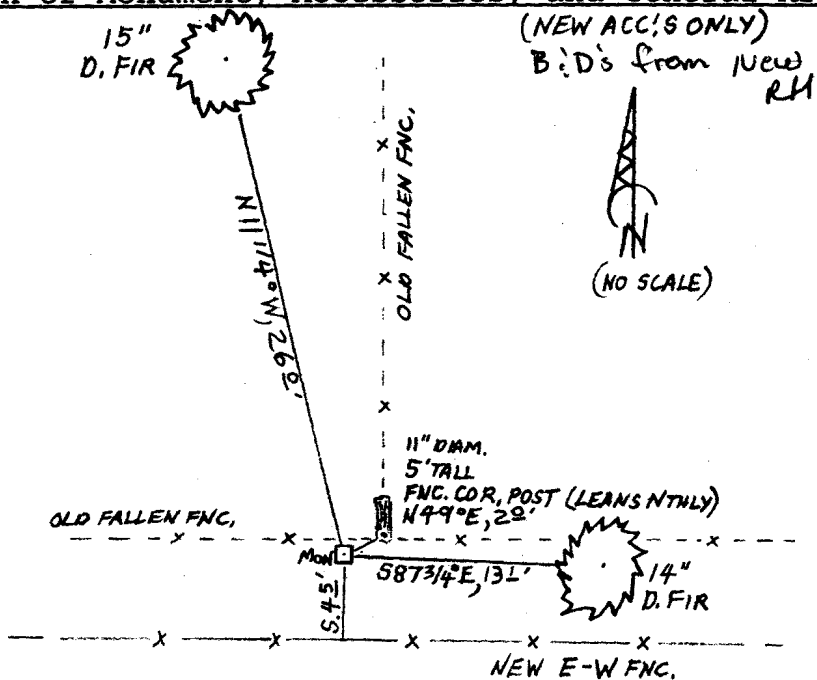

MONUMENT IS ON GENTLE NNW SLOPE. NE QUADRANT IS MIXED OAK AND FIR WOODS. OTHER QUADRANTS ARE OPEN GROUND.

Comp. Decline. $15 \frac{1}{4}^{\circ} E$
Agency D. C. S. D.
Party Chief STEPHEN JOHN FLAISE
Note keeper Stephen John Flaese
Witnesses MIKE S. KOCH

Surveyor's Seal

From NE corner (a rock) of sect 16.
 S 89° 50' E 19.56 chns intersect, move temp. post East 22 lbs, plowshare buried.
 North Var. 19° 30' E 40.00 chns set post, with plowshare and 3 stones.
 80.05 chns. intersect sect line.
 S 89° 10' E Var. 19° 20' E to corner opposite ~~48~~ as set by me febr. 26th 84.
 (Northline measures 79.53 instead of U.S. 79.71;
 (Southline " 39.56 + 39.62 = 79.18 " " 79.46)
 (distance 20 chns W. of NE corner to 20. W. of SE corner is 79.76 chns)

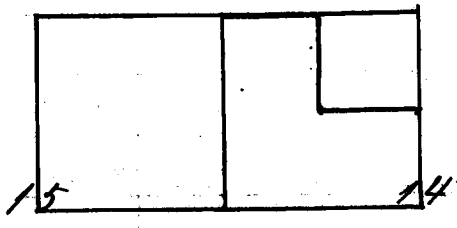

T. 28 S. R. 6 W.

From the post between 15 & 14 (a rock) Var. 19° 20'
 S 89° 47' E 20.10 chns set post from which
 a bl. oak 36" in dia. bears S 86 1/2° E 3.94 chns. dia.
 South Var. 19° 35' 20.00 chns, set post from which
 a wh. oak 16" in dia. bears S 32° E 1.35 chns.
 S 89° 45' E Var. 19° 40' 20.15 chns, set post from which
 a laurel 3" in dia. bears N 37 1/2° E 41 lbs dist.
 " " 4" " " S 22 1/2° W. 71 "

Harvey et al. Oct. 27th 85.

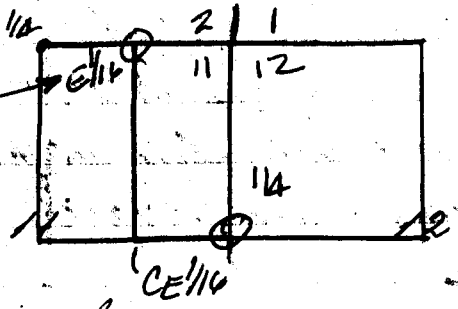

T. 24 S. R. 5 W.

William Thiel

24-05-660540

Set the post between 11 & 12, Var. 18° 45' E.
 Post 20.00 chns. set post, from which
 a wh. oak 6" in dia. bears N 84 1/2° W 1.34 chns } CELL 16
 " " 8" " " S 12 1/2° E 1.66 " } 1098
 North Var. 19° 10' E. 40.05 chns. intersect section line, set post, from which
 a bl. oak 24" in dia. bears N 22° W 0.11 lbs dist. (7 2/3) } E 116
 " " 36 " " N 45° E 0.23 " (15 1/2) } 82
 Var. 19° 25' E. } 511

1855 BT
6" W. Oak
Stamp

N 35° 45' W, 1.141
N 34° 12' W, 1.141
BT
BT
BT

24-05-600540 - 1/4 S 11 | S 12
M 57-17 - Proportioned
M 167-77



10" Diam
Fence CORNER

N 49° E 120

CS 67/49-6
(5)

(2)
T24S, R05W, PLSS 560540 (CONT'D)

- MONUMENT SET: NOW RM per KOD
ATA POINT DETERMINED FROM THE
FOUND O.B.T. EVIDENCE AND AN OLD FENCE
- CORNER WE REESTABLISH A MONUMENT
FOR THE CE $\frac{1}{16}$ SECTION 11 LOCATION AS
DETERMINED BY WILLIAM THIEL IN 1885.
- THE NEW MONUMENT IS A $1\frac{1}{2}$ " DIA. ALUM-
INUM CAP, STAMPED "DOUGLAS CO.
SURVEYOR 201" ON A $\frac{5}{8}$ " x 30" IRON
ROD SET PROTRUDING 4" ABOVE GROUND.

NEW ACCESSORIES:

- A 14" DIA. DOUGLAS FIR SCRIBED
"CSBT" ON A SINGLE LOW BLAZE; BEARS
S 81 E, 117 FT. DISTANT.

- A 15" DIA. D. FIR SCRIBED "CS" "BT"
ON A DOUBLE BLAZE; BEARS N $15\frac{1}{4}$ W, 25 $\frac{1}{2}$
FT. DISTANT.

- After examining the found
evidence, I accept the fence
corner as a perpetuation of
Thiel's 1885 corner KOD

CS 60/49-6

(6)

3/31/2021

T24S, R05W, CE 1/16 S11, PLSS 560540

MONUMENT FOUND:

NO ACTUAL CORNER MONUMENT REMAINS BUT AN OLD FENCE CORNER WITH MOSTLY FALLEN FENCES RUNNING EAST, WEST AND NORTH INFORMS THE SEARCH FOR THE ORIGINAL BEARING TREES.

Fence Corner is Accepted KOD

ACCESSORIES FOUND:

EVIDENCE OF THE TWO ORIGINAL BEARING TREES.

A WH. OAK 8 IN. DIA. NOW A DISTINCT ROOT-HOLE; BEARS S $12\frac{1}{2}^{\circ}$ E, 1096 FT. DISTANT.

A WH. OAK 6 IN DIA. NOW A SAWN AND PARTLY ROTTED 10" DIA., 4 FT. TALL WHITE OAK STUMP WHICH IS OPENED TO REVEAL THE SCRIBING "BT" AND THE CHAINING NOTCH AT THE CORRECT DIAMETER. THIS STUMP IS ON THE EAST EDGE OF A CLUMP OF SEVERAL ROTTED AND SAWN OAK STUMPS. THE SCRIBED STUMP BEARS N $35\frac{3}{4}^{\circ}$ W, 884 FT. DISTANT. (REC N $34\frac{1}{2}^{\circ}$ W, 834 FT.)

CS 67/49-6 (T) KOD

FRED SKEELS

CELL - 430-3383

TRAILER - 391-4715

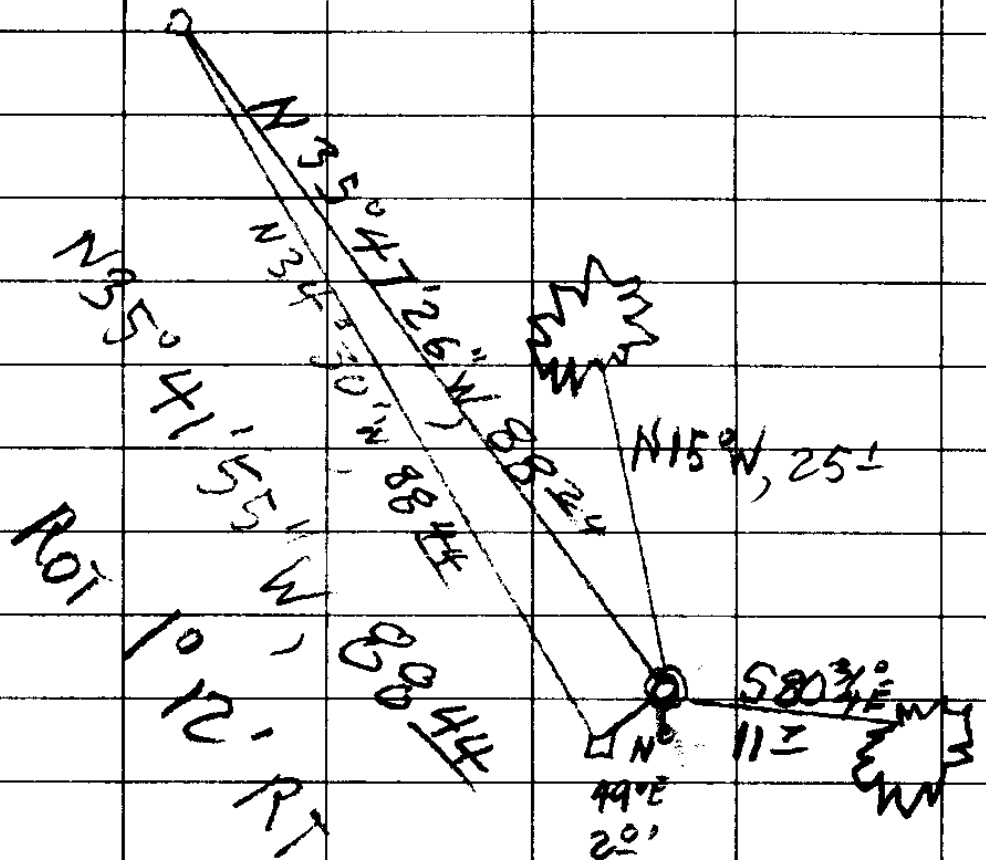

5 25
 N 54° 52' 03\"/>

CORRECTED
 NEW BT'S

SE BT S 81° 02' 10\"/>

NW BT N 13° 52' 57\"/>

A N 33° 42' 50\"/>

≈ 5 1/2' NORTH FROM NEW E-W FNC

CS 67149-6 (8)

12/18/14

~~1/15/15~~ CE 1/16 S W T245 R5W

1/15/15 N 25° 24' 15" W, 83.45

S 20° 42' 49" E, 111.09

S 78 54 34 E, 15.87

S 19° 27' 24" E, 107.3

1/2" ALC / 1/8" IR "DOUGLAS CO. SURVEYOR" PROT 6"

NEW B.T.S (IN ERROR MOVED S 34 1/2° E, 40')
(CORRECTED FOR NEW I.R./ALC POS.) 87 3/4 13 L

14 D. FIR "CS BT" S 76° E, 158
SINGLE 11 1/4° 26°

15" N. FIR "CS" "BT" N 7 1/4° W, 22 1/2
DOUBLE

(FROM NEW I.R. POS)

BASE OF OLD 11" DAM, 5 FT TALL FNC POST

(LEANS NORTHLY) BEARS ~~91~~ 49° E, 2

FROM OLD MOSTLY FALLEN FNCs RUN E-W AND N

NEW E-W FNC IS SOUTH 4 1/2

CS 67/49-6 (9)

6" W, OAK N 34' 1/2" W, 88 ~~44~~

8" W, OAK S 12' 1/2" E, 109 56

$\Delta = S 22^{\circ} 18' 44'' E, 194 40$

FRED SKEELS

From NE corner (a rock) of sect 16.
 S 89° 50' E 19.56 chns intersect, on or temp. post East 22 lbs, plowshare found.
 North Var. 19° 30' E 40.00 chns set post, with plowshare and 3 stones.
 80.05 chns. intersect sect line.
 S 89° 10' E Var. 19° 26' E. to corner opposite was set by me Feb. 26th 84.
 (North line measures 79.83 instead of U.S. 79.71.)
 (South line " 39.56 + 39.62 = 79.18 " 79.46)
 (distance 20 chns W. of NE corner to 20. W. of SE corner is 79.76 chns.)

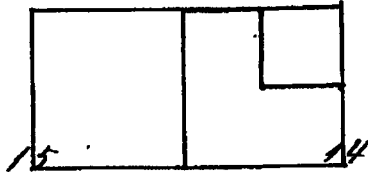

T. 28. S. R. 6. 3/4

From 14 post between 15 & 14 (a rock) Var. 18° 20'
 S 89° 47' E 20.10 chns set post, from which
 a bl. oak 36" in dia. bears S 86 1/2° E 3.94 chns. dia.
 South Var. 19° 35' 20.00 chns, set post from which
 a wh. oak 16" in dia. bears S 32° E 135 chns.
 S 87° 45' E Var. 19° 46' 20.15 chns, set post from which
 a laurel 3" in dia. bears N 37 1/2° E 11 lbs dia.
 " " 4" " " S 22 1/2° W. 71 "

18-232

Harvey et al Oct 27th 85

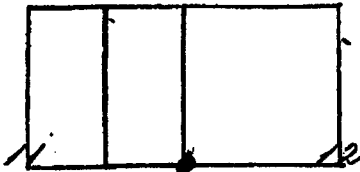

T. 24 S. R. 5 N.

CE 1/6 S 11

Set 14 post between 11 & 12. Var. 18° 45' E.
 West 20.00 chns. set post, from which
 a wh. oak 6" in dia. bears N 84 1/2° W 1.34 chns
 " " 8" " " S 12 1/2° E 1.66
 North Var. 19° 10' E. 40.05 chns. intersect section line, set post, from which
 a bl. oak 24" in dia. bears N 22° W 0.11 lbs dia.
 " " 36" " " N 45° E 0.23
 Var. 19° 25' E.

N 22° 30' W, 190 E

CS 67149-6 (10)