

GOVERNMENT CORNER RESTORATION FORM
DOUGLAS COUNTY SURVEYOR

Date: 3/29/2021 FILED

By: SC

TOWNSHIP 30 RANGE 04 SECTION 8 PLSS/GCDB No. 30-04-039120

CORNER DESIGNATION: NE CORNER OF CHAPMAN DLC #43 AND A PT. ON SE BODY OF BECKWORTH DLC #39

Corner Form & Field Notes:

C.S. File: 67/49-3

DOUGLAS COUNTY SURVEYOR

CORNER HISTORY, PREVIOUS RENEWALS OR SURVEYS:

- SEE DCSO SURVEY & CORNER RECORDS FOR PLSS 30-04-039120

DATE: 12 December 2018

- Condition Report Only
- Not Found
- Renewed
- Unrecorded
- Surveyed In
- Referenced Out

MONUMENT (CONDITION AND SOURCE):

- FOUND A 2 1/2" O.D. STAINLESS STEEL POST BY B. SEIBOLD, USBLM CADASTRAL SURVEYOR, UNDER A 1993-1995 USBLM DEPENDENT RESURVEY, FIRMLY SET, BURIED 8" BELOW THE GROUND WITH A 3 1/4" DIAM. BRASS CAP MARKED AS NOTED:

MONUMENT DETAIL

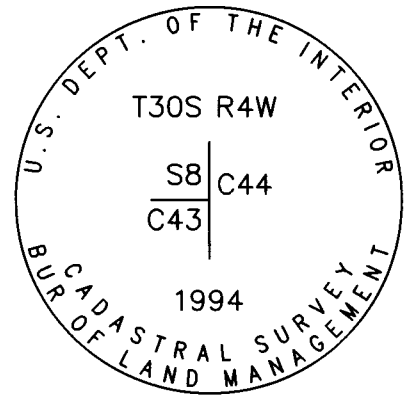

ACCESSORIES (CONDITION, SOURCE & RECORD):

BEARING TREES BY B.B. IRVING IN 1940 PER C.S FILE 16/55:

- A 91" DIAM. MAPLE BEARS S. 01° W., 87.1 FT. WITH A HEALED BLAZE. (REC. S. 2 1/4° W.)
- A 32" D. FIR STUMP BEARS (REC. N.54 1/2°E., 126.7 FT.) TIPPED OUT OF POSITION WITH NO CLEAR POSITION TO MEASURE

A BEARING TREE BY B. SEIBOLD IN 1995:

- A 19" DIAM. MAPLE BEARS N. 54° E., 120.5 FT. WITH A HEALED BLAZE. (REC. 182 LKS.)

ACCESSORIES BY S.J. FLAUSE, DCSO, IN 2005 PER C.S. FILE 67/13-8:

- A 3 3/4" DIAM. BRASS DISC SET IN CONCRETE, US COAST & GEODETIC SURVEY BENCHMARK "U 499 1949" BEARS S. 57° 22' W., 33.65 FEET (REC. S.60°W., 33.8 FT.)
- A 43" DIAM. D. FIR BEARS N. 75 3/4° W., 134.9 FEET WITH A HEALED BLAZE (REC. N.74°E.)

BASIS OF BEARINGS: 1998 USBLM DEPENDENT RESURVEY. S. 71° 21' 33" W. AS THE COMPUTED INVERSE BETWEEN THE NE CORNER OF DLC 43 AND THE NE CORNER OF DLC 42

LOCATION & COMMENTS:

THE CORNER FALLS 13 FT. SOUTH OF THE CENTERLINE OF SOUTH UMPQUA CO. RD. NO. 1 (OR 227) AND JUST SOUTH OF AND 8" BELOW THE EDGE OF PAVEMENT.

ALL BEARING TREES HAVE BT TAGS ATTACHED. ALL NEW BEARING TREES HAVE DOUBLE BLAZED FACES WITH BEARING MEASURED TO THE CENTER OF THE TREES AT THE ROOT CROWN AND DISTANCES MEASURED TO A 4" MAG HUB IN THE SIDE AND CENTER OF THE ROOT CROWN.

GEODETIC COORDINATES

LATITUDE: Not Available

LONGITUDE:

DATUM: NAD 83

SOURCE: GeoXT6000

FILE PATH: "\\DCNAS\Surveyor\SurShared\TraversePC\Corner Renewal DCSO\2019"

COMPASS DECLINATION: 14 3/4° E.

AGENCY:DCSO

PARTY CHIEF: S. J. Flause

WITNESSES: J. Lorsung

NOTES: ATTACHED

REGISTERED
PROFESSIONAL
LAND SURVEYOR

Kristian O. Degroot

OREGON
JULY 17, 1981
KRISTIAN O. DEGROOT
1941

RENEWAL DATE: 12-31-2021

6567/49-3

T30S R04W58

PLSS: 039120

DATE: 12/12/18

CREW:

PARTY CHIEF: S.J. FLAUSE

TECH: JEFF LORSUNG

MONUMENT:

FOUND AS DESCRIBED
IN 2005 RENEWAL

PROJ: - 8 INCH_s

FOUND:

1940 BT 24" NOW 91" DIA. MAPLE BEARS
S01°W, 87¹/₂ FT. DIST. HEALED BLAZE

1940 BT 20" FIR, NOW TIPPER OUT 32"
STUMP, NO CLEAR POSITION TO MEAS.

BLM 1993-1995 16" NOW 19" MAPLE BEARS
N54°E, 120⁵/₈ FT. DIST, HEALED DOUBLE BLAZE
NEW: CONT'D NEXT PG.

J.L. DARLING CORP TACOMA WA 98424-1017
www.RiteintheRain.com

Rite in the Rain

CS 67/49-3

T305 R04 W S 8

P255: 039120
DATE: 12/12/18
CONT'D

FOUND: CONT'D

REFERENCE FROM 2005 DCSD RENEWAL
BM U499 BEARS S 57°22'W, 33⁶⁵ FT.

2005 NEW BT 38" NOW 4" DIA. D. FIR
FHDB BEARS N 75^{3/4}°W, 134⁹ FT.

BASIS OF BEARING 1998 BLM DEPENDENT
RESURVEY: COMPUTED BEARING
NE DLC 43 - NE DLC 42: S 71°21'33"W

CS 67/49-3

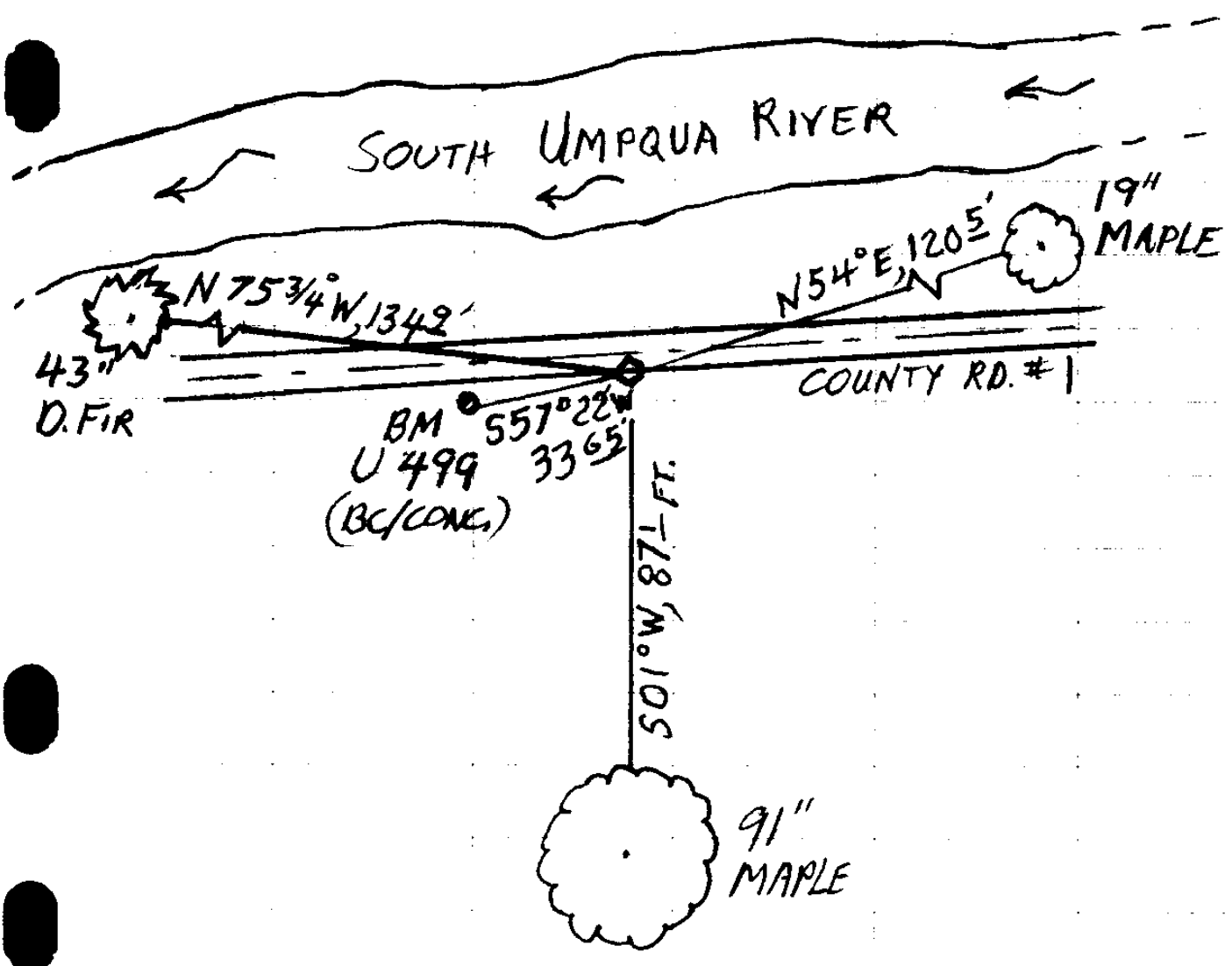

BASIS OF BEARING

1998 BLM DEPENDENT RESURVEY
COMPLETED BEAR. NE DLC 43 - NE DLC 42

DEC 14 3/4 E

CS 67.1A2-3

4

TOWNSHIP 30 RANGE 04 POINT IDENTIFIER # 039120

PRIMARY CORNER DESCRIPTION Pt. on SE Bdy Beckworth DLC #39

Alias 043010 Description NE Cor. Andrew Chapman DLC #43
Alias _____ Description _____
Alias _____ Description _____
Alias _____ Description _____

Original - GLO survey by Bowman and Burnett, under Contract dated Sept. 1855 (DLC survey) Page 598 and 605, DLC Volume)

(Page 598) Set a post marked, from which
No EVID A B.Oak 12" dia., bears N.10°W., 161 lks. 106 26
(Page 605)
Set a post marked a quadrangular trench and stone in the center.

GLO survey by Wm. Thiel, Deputy Surveyor, under Contract #535, dated Feb. 5, 1889 (DCSO records DLC Volume Page 703)

At the NE. Cor., the old post is gone, but the stump of a B.Oak on Claim No. 39, and corresponding in size and direction with the description in field notes of survey of Claim 39 (being the same corner) furnished me, is still standing. I restore this cor. by setting a basalt stone 12" *NO EVID* x 8 x 8 ins., 8" in the ground mkd 43 on SW. face, from which
NO EVID A B.Oak 36" dia., bears N.77 3/4°W., 196 lks. dist. mkd.
T30S R4W W.C. 39 BT. 129 36

Douglas Co. Surveyors Office - Ben B. Irving - Wit: N.E. Richardson and R.L. Irving - Feb. 26, 1940 - C.S. File 16/55

Location identified by a rock with X chiseled on the top. While I was on the ground, a State Highway Dept. grader cut the top off of this rock, which is located in the edge of the road. Underneath this rock was another rock marked with an X with top dimensions of 8" x 10". A bottle was buried alongside. The rock which was on top was turned over and placed with its top flush with ground and marked with cross. This rock is 8x10x18".

Now 91" - A Maple 24" dia., bears S. ~~2°45'~~ ^{501°W} W., ~~86.0~~ ^{87.1} ft. *DIST AGREES BLM HEARD BLZ.*
An Oak 54" dia., bears N.83°35'W., 161.0 ft.
A Fir 20" dia., bears N.55°15'E., 126.2 ft.
All blazed and scribed "N.E. D.L.C 43 C.S. B.T."

Douglas Co. Surveyors Office - James W. Byron - Dale McFarland and John Powell, crew - Feb. 1962 - C.S. File 49/67

Found - 1/2" I.R. at corner and at edge of black top, 1" under surface. Fir BT shows good bark scribing. Maple BT shows good scar. Both check record. Oak BT, not found.
USBM mkd. U499 bears S.60°W., 33.8 ft.
1949

continued next page

CS 67/49-3

1

5

TOWNSHIP 30 RANGE 04 POINT IDENTIFIER # 039120

PRIMARY CORNER DESCRIPTION Pt on SE Bdy Beckworth DLC #39

Alias <u>043010</u>	Description <u>NE Cor Andrew Chapman DLC #43</u>
Alias _____	Description _____
Alias _____	Description _____
Alias _____	Description _____

BLM dependent resurvey by Bryan S. Seibold, Cadastral Surveyor, and Robert Browning, Surveying Technician, under Group #1686, surveyed May 1993 thru April. 1995 - (DCSO records Vol. 52 Page(s) 20133)

The NE. cor. of DLC 43, on the W. bdy. of DLC 44, perpetuated by Irving, in 1940, further perpetuated by Byron, in 1962, and is accepted as a careful and faithful determination of the original corner based on use; monumented with an iron rod, 1/2" diam., firmly set 4" below ground, from which the remains of bearing trees mkd. by Irving:

A fir snag, 32" diam., bears N.54 1/2° E., ^{126 72} 192 lks., with fragmentary scribe marks visible on the bark.

A maple, 81" diam., bears S.2 1/4° W., 132 lks., with healed blaze.

At the corner point

Set a stainless steel post, 28" long, 2 1/2" diam., 33" in the ground directly over the iron rod, with brass cap mkd.

	T30S	R4W	
	S 8	C 44	MARKED
	C 43		1994 AS AT LEFT

and a new bearing tree
now 19" - A maple, 16" diam., bears N.54° E., 182 lks., mkd. X BT. Deposit a white "DEEP-1" magnetic marker at base of stainless steel post.

The corner is located South, 0.25 chs. dist. from the center of County Road No. 1 (Tiller Trail Highway), asphalt-surfaced, 45 lks. wide, bears N. 85° E. and S. 80° W.

Douglas Co. Surveyors Office - Stephen J. Flause - John Pike - 9/14/2005 - C.S. File 67/13-8

Found - 3" brass cap, markings are illegible. Lies slightly under edge of road 8" below surface of asphalt, 13 ft. from centerline.

16" Maple now 17" measured at 2 ft. above ground (split trunk) high & low fully healed blazes visible on most westerly trunk.

Fir snag now tipped out stump (rec. N.55 1/4° E., 126.2 ft.) 1940 BT

81" Maple now 90" no markings evident. Tree is now multi trunked & split down the middle & is to be removed in future.

3 1/2" brass disc. set in concrete "US COAST & GEODETIC SURVEY BENCHMARK U499 1949" bears S. 60° W., 33.8 ft. (agrees with record)

Trace continued next page 557° 22' W, 33 65

TOWNSHIP 30 RANGE 04 POINT IDENTIFIER # 039120

PRIMARY CORNER DESCRIPTION Pt. on SE Bdy. Beckworth DLC #39

Alias 043010 Description NE Cor. Andrew Chapman DLC #43

Alias _____ Description _____

Alias _____ Description _____

Alias _____ Description _____

New - ^{N75³¹W}43" 38" D. Fir, double blazed scribed "DLC 39 CS BT"
bears ~~N.74°E.~~, 134.9 ft. FHDB

Note - Compass decl. 16³/₄°E.

BASIS OF BEARING BLM SURVEY COMPUTED BEARING NE43-NE42
S 71° 21' 33" W

CS 67/49-3³
7