

GOVERNMENT CORNER RESTORATION FORM
DOUGLAS COUNTY SURVEYOR

TOWNSHIP 31 RANGE 1 SECTION 33 PLSS/GCDB No. 31-01-400100 (32-01-342700)

CORNER DESIGNATION: Section Corner for 32 & 33 only

CORNER HISTORY, PREVIOUS RENEWALS OR SURVEYS:

- SEE DCSO SURVEY & CORNER RECORDS FOR PLSS 31-01-400100
- The section corner and all accessories that fall in Elk Creek are washed away by the creek and obliterated.
- This is a renewal of the Witness Corner set by J.M. Powell, Douglas County Surveyors Office, 1968 per C.S. File No. 54/71-26.

MONUMENT (CONDITION AND SOURCE):

- Found a 1" i.d. iron pipe by J.M. Powell, Douglas County Surveyors Office in 1968 per C.S. File 54/71-26, firmly set, projecting 15" above the ground with a 2 1/2" dia. brass cap marked as noted:

ACCESSORIES (CONDITION, SOURCE & RECORD):

Bearing Trees by Powell in 1968 per C.S. File 54/71-26:

- A 12" dia. ash bears S 6 1/2° W, 11.4 feet with scribe marks visible on a partially healed blaze.
- A 15" dia. ash bears N 66° W, 16.8 feet with a healed blaze.

(All other accessories were washed away by the stream)

A new Bearing Tree:

- A 34" dia. w. oak bears North, 170.8 feet, scribed "WC T31S R1W S33" & "CS BT" on a double blaze.

LOCATION & COMMENTS:

The Witness Corner falls on the high bank of Elk creek in open pasture land approximately 250 ft South Westerly of the ranch house and 300 feet South of the ranch road.

All bearing trees have BT Tags attached. All new bearing trees have double blazed faces with bearing measured to the center of the tree at the root crown and distances measured to a 4" Mag Hub in the side and center of the root crown.

GEODETIC COORDINATES
LATITUDE: 42°49'43.29" N.
LONGITUDE: 122°49'24.62" W.
DATUM: NAD 83
SOURCE: GeoXT6000
OREGON SOUTH-ZONE3602:
FILE PATH:

COMPASS DECLINATION: 14 3/4° E.
AGENCY:DCSO
PARTY CHIEF: S. J. Flause
WITNESSES: J. Lorsung
NOTES: ATTACHED

FILED
Date: 1/28/2021
By: JC
Corner Form: 67/48-20
Field Notes: 6 PGs
DOUGLAS COUNTY SURVEYOR

DATE: June 3, 2019

- Condition Report Only
- Not Found
- Renewed
- Unrecorded
- Surveyed In
- Referenced Out

MONUMENT DETAIL

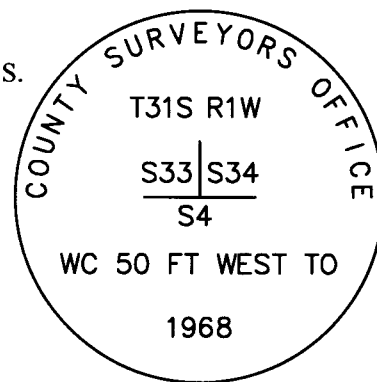

REGISTERED
PROFESSIONAL
LAND SURVEYOR

OREGON
JULY 17, 1981
KRISTIAN O. DEGROOT
1941

RENEWAL DATE: 12-31-2021

CS 67/48-20

(1)

Filed 1-28-2021

T 31 R 1 S 33 + 34

PLSS: 342700

DATE: 6-3-2019

MONUMENT:

2.5" COUNTY BC ON 1" I.D. I.P.
FIRMLY SET IN PLUMB POSITION.

PROJ: 15"

FOUND:

- 12" ASH S 62° W, $11\frac{1}{4}$ FT. PARTIAL
SCRIBE VISIBLE. (REC. 10")
 - 15" ASH N 66° W, $16\frac{1}{2}$ FT. FHDB. (REC 9")
- ALL OTHER OBJECTS WASHED
AWAY BY CREEK, NOT FOUND.

NEW:

34" W. OAK BEARS NORTH, $170\frac{8}{8}$
SCRIBED "WC T315RIWS33"
"CSBT".

CONTINUED ON BACK

CS 67/48-20

(2)

CORNER LIES NEAR OLD FENCE
CORNER ON SOUTH EDGE OF PASTURE
ON THE HIGH BANK OF ELK CREEK.
APPROX 250 FT SOUTH WESTERLY
OF RANCH HOUSE.

CS 67/48-20

(3)

RANCH ROAD

PASTURE

OLD FENCE

34" W. OAK

PASTURE

15" ASH

12" ASH

HIGH BANK

CREEK

CS 67/48-20 (A)

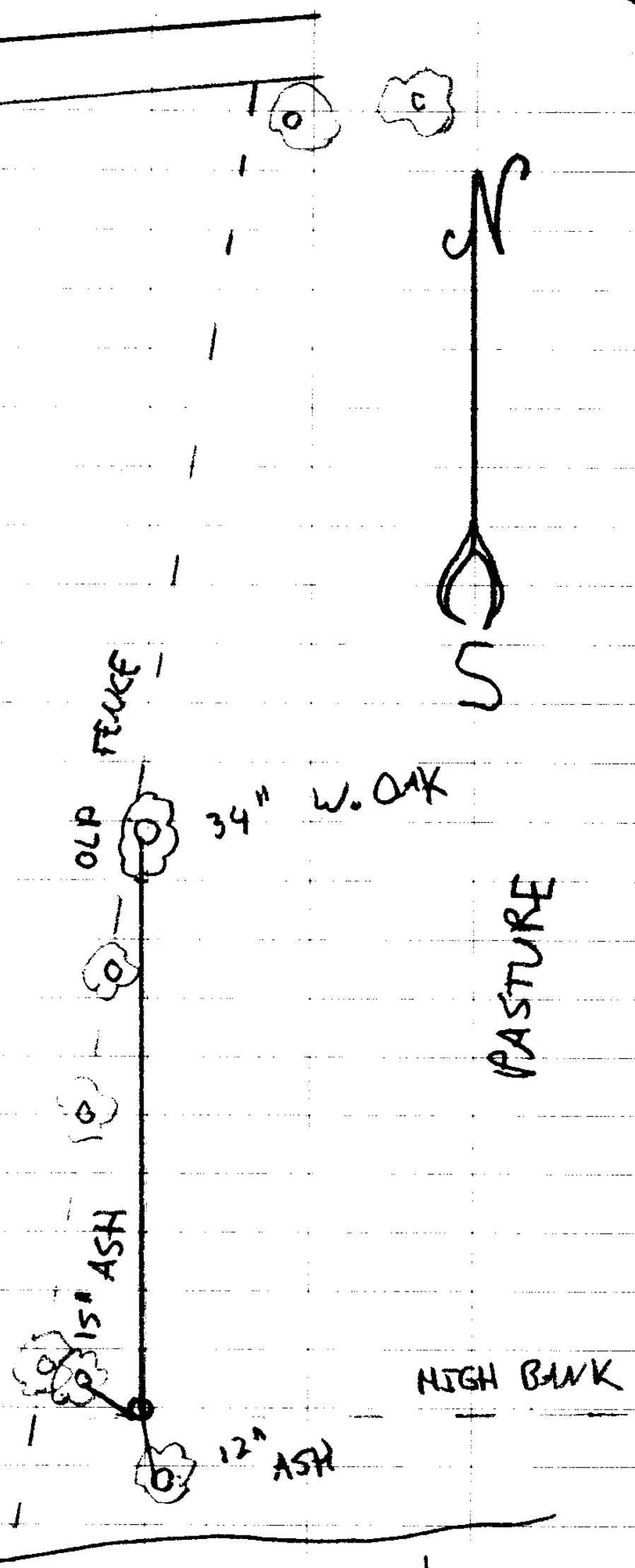

TOWNSHIP 31 RANGE 01 POINT IDENTIFIER # 400100
~~32~~ ~~342700~~

PRIMARY CORNER DESCRIPTION Sec. Cor. for 33 & 34 only, T31-1

Alias _____ Description _____
 Alias _____ Description _____
 Alias _____ Description _____
 Alias _____ Description _____

GLO survey by Dennis Hathorn, Deputy Surveyor under Contract #73, dated June 8, 1857 - (DCSO records Vol. 18 Page(s) 7461)

 Set post cor. secs. 33, 34, 3 and 4, from which
 An Alder 36" dia., bears S.50°W., 50 lks. dist.
 A Maple 12" dia., bears N.25°W., 30 lks. dist.
 A Fir 15" dia., bears N.45°E., 45 lks. dist.
 A Fir 24" dia., bears S.40°E., 45 lks. dist.

GLO Survey by Rufus S. Moore, Deputy Surveyor, under Contract #475, dated July 3, 1883 - (DCSO records Vol. 18 Page(s) 7487-88)

 The old sec. cor. to secs. 33 and 34, which is a decayed post with 3 BTs still standing. I destroyed this post and replaced it with a basalt stone, 18x9x7 ins., 12" in the ground for cor. to sec. 33 and 34 mkd. with 3 notches on E. and W. edges, from which
 A Fir 28" dia., bears N.45°E., 45 lks. dist. mkd. T31S R1W S34 BT.
 A Maple 12" dia., bears N.25°W., 30 lks. dist. mkd. T31S R1W S33 BT.
 A Fir 40" dia., bears S.40°E., 45 lks. dist. mkd. T32S R1W S4 BT.
 An Alder described in field notes or original survey has fallen. The three bearing trees were newly marked.

Arthur Boyer, Surveyor - Wit: Ted Schattenkerk - Sept. 1949 -C.S. File 40/214

 Found rock in place for this sec. corner; all four recorded trees are alive and all are as given in the recorded field notes except, the 40" Fir tree which is recorded as being S.40°E., 45 lks., which measures from the corner rock 36 lks. This tree is mkd. or scribed distinctly "S3". It is in sec. 4 not 3. This corner is of course for secs. 33 & 34 only and not for either 3 or 4.

Douglas Co. Surveyors Office - John M. Powell, and crew - July 25, 1968 - C.S. File 54/71-26

 Found - No trace of corner stone.
 28" now 32" D.Fir, almost dead, N.45°E., 39.7 ft., 29.7 ft shows good scar.
 40" D.Fir, now burnt stob, S.40°E., faint burnt scribe visible.
 (Cont. Next Page)

WASHED AWAY

CS 67/48-20

(5)

6/2/19

TOWNSHIP 32 RANGE 01 POINT IDENTIFIER # 342700

PRIMARY CORNER DESCRIPTION Sec. Cor. for 33 & 34 only, T31-1

Alias _____	Description _____
Alias _____	Description _____
Alias _____	Description _____
Alias _____	Description _____

~~GONE~~ 12" Maple, now dead, N.25°W., 19.8 ft., rotten face, old axe work and faint marks.
 This corner now lies on East edge of Elk Creek in dangerous place, therefore, SET WITNESS Corner 50.0 ft. East of Tree corner, mkd: County Surveyors Office 1968
 W.C. 50.0' West to T31S R1W *PROJ 15"*
 S33 | S34
 S 4
 T32S *VIS* *PKDB* T32S 1968
 New BTs ¹² 10" Ash S.64°W., 11.4 ft. mkd. W.C. (T32S R1W S4) CS
 BT.
^{15"} 9" Ash N.68°W., 16.8 ft. mkd. W.C. T31S R1W S34 CS *FKDB*
 BT.
 This cor. lies on top of ^{HIGH} creek bank 2.50 ft. South of fence _{FENCE} line.

WC 50'
 WEST TO
 T31S R
 S33 | S34 |
 S4 W
 T32S
 1968

NEW BT
 34" W OAK ^{WEST} T31S R1W S33 "CS BT" NORTH 170 E

CS 67 / 198-20 (6)